

1A
A1B

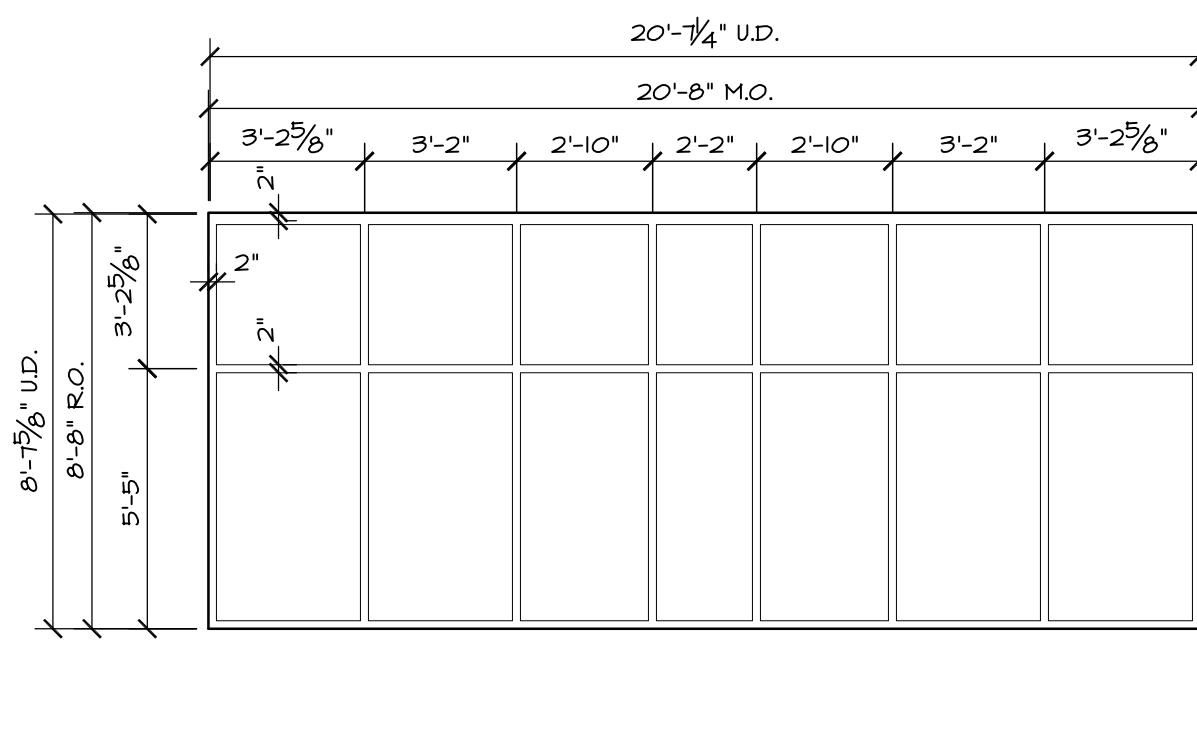

1B
A1B

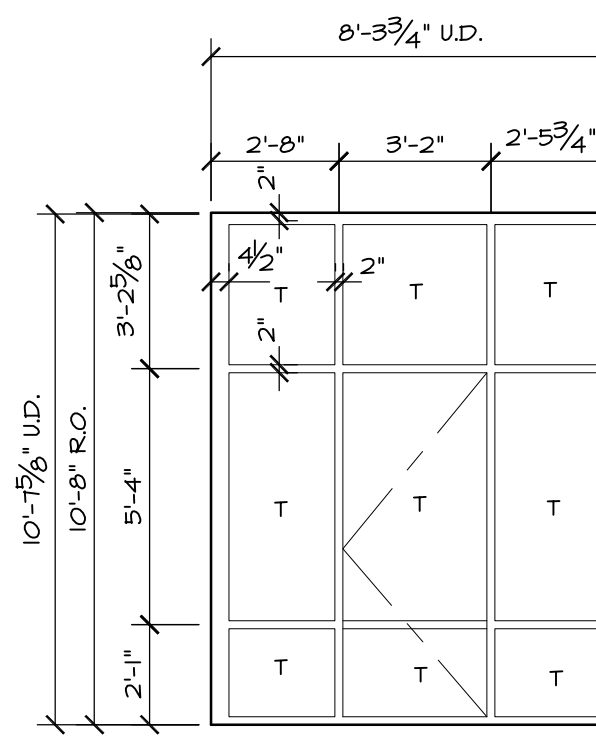

1C
A1B

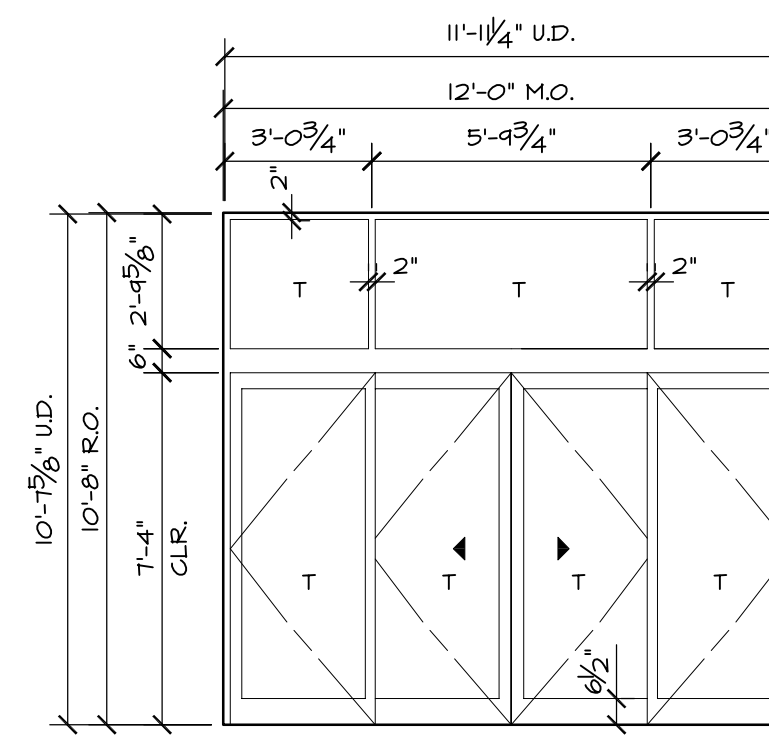

3A
A1B

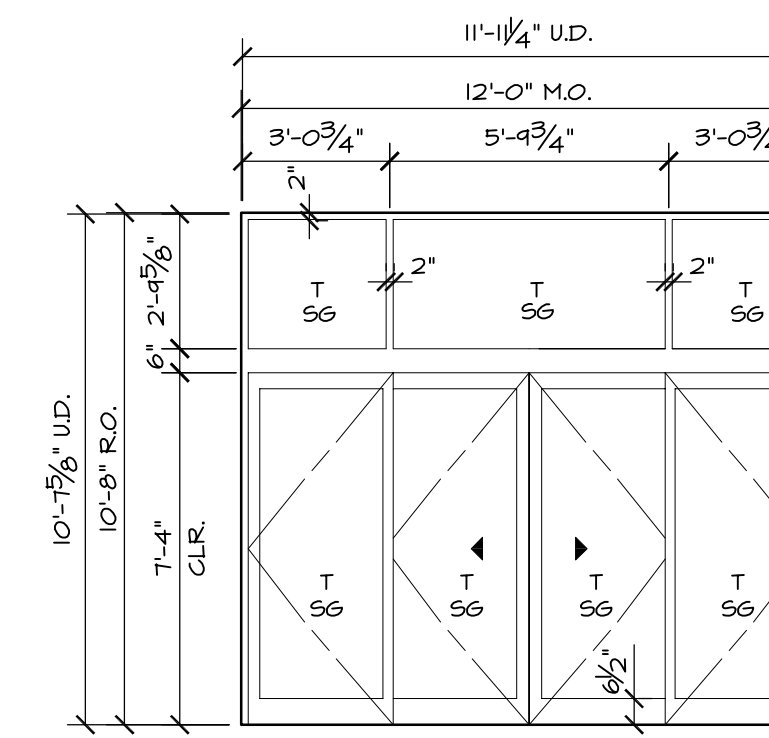

3B
A1B

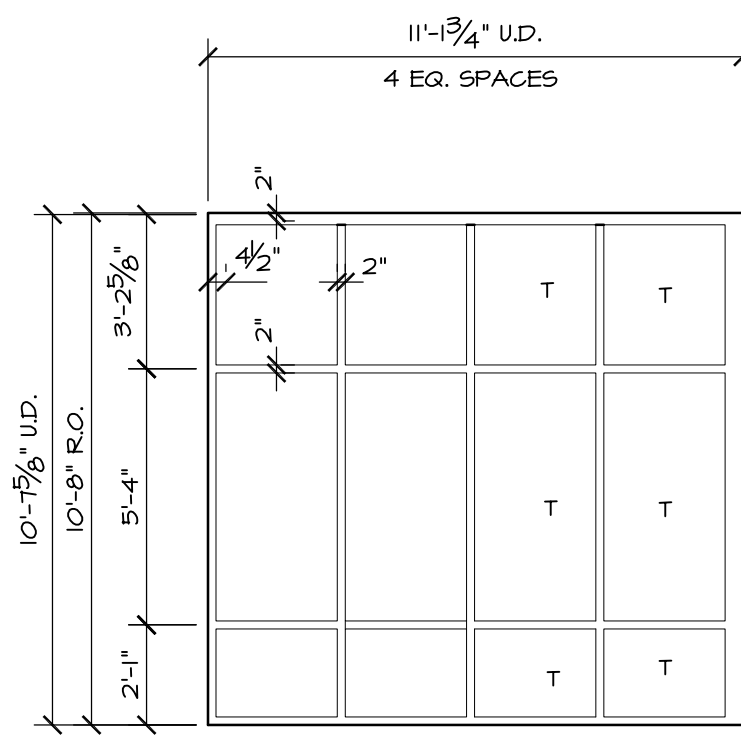

1D
A1B

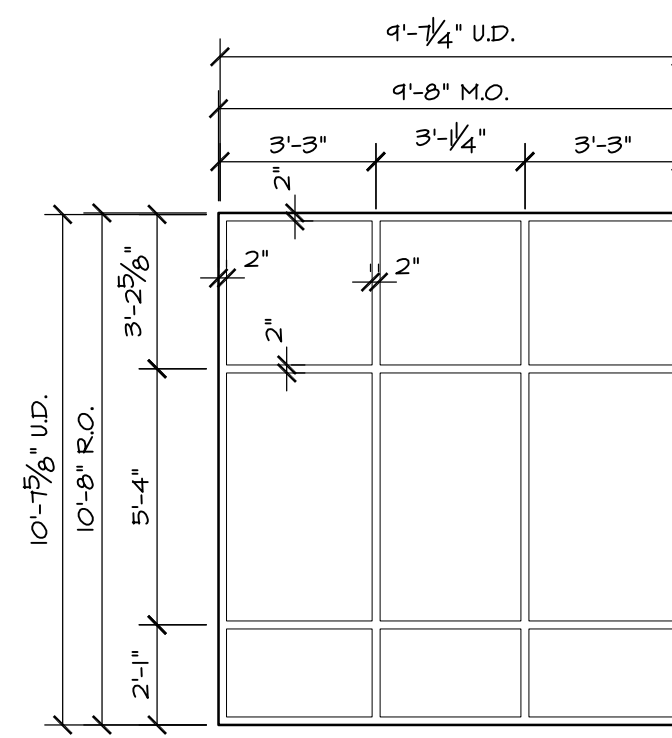

1E
A1B

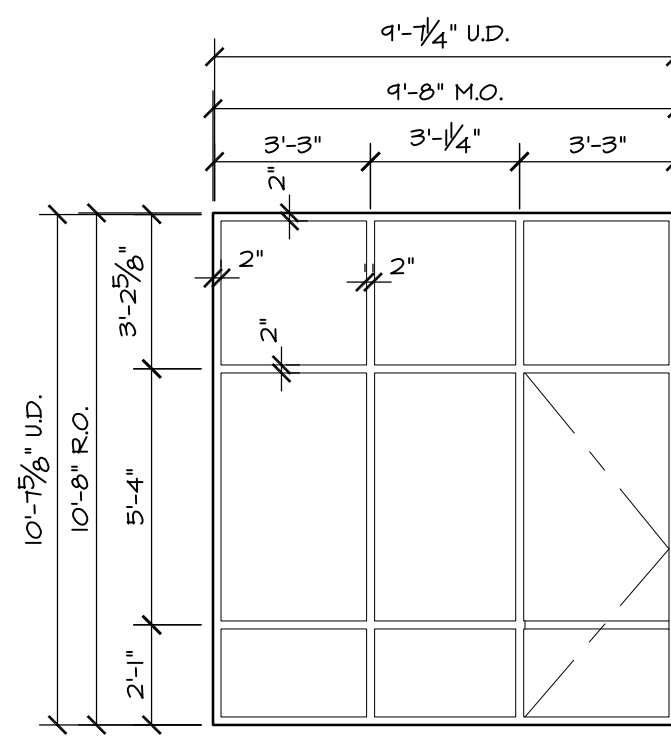

1F
A1B

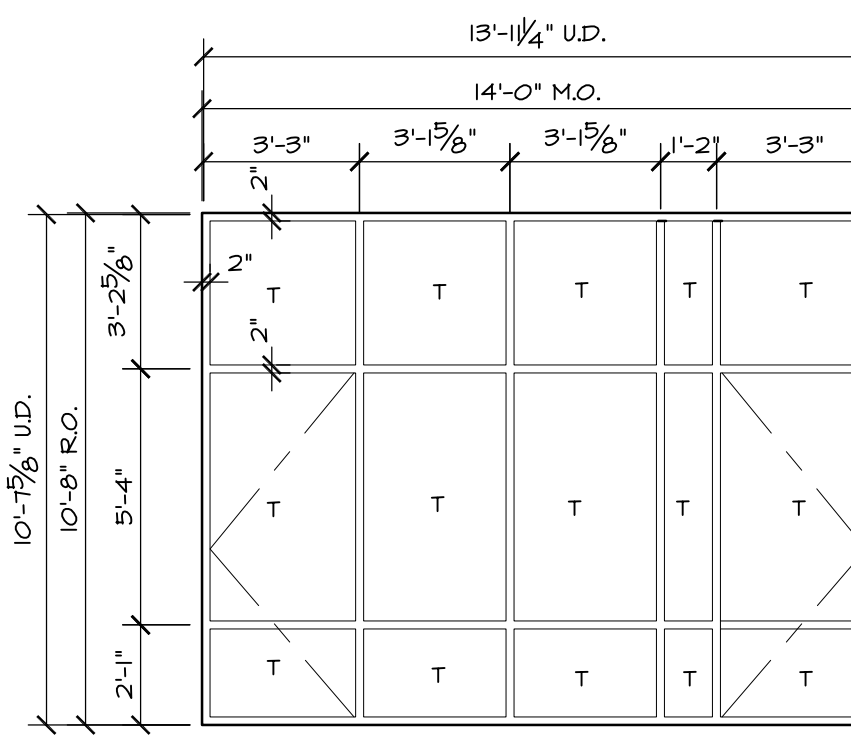

1G
A1B

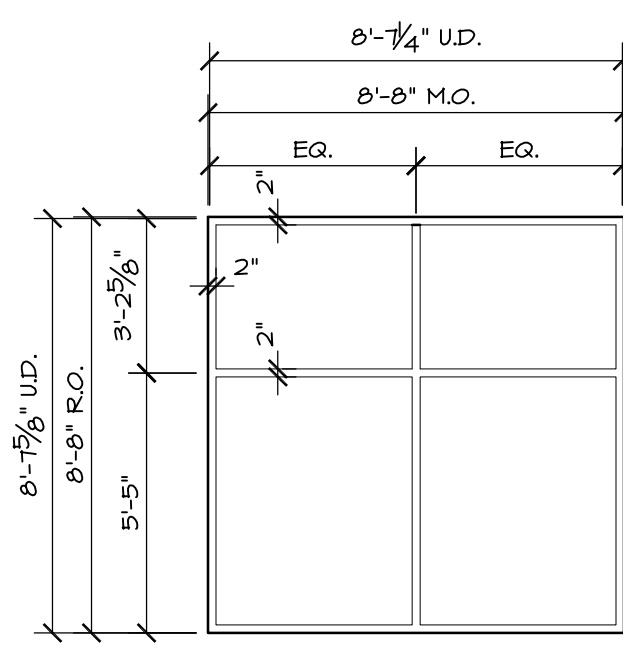

1H
A1B

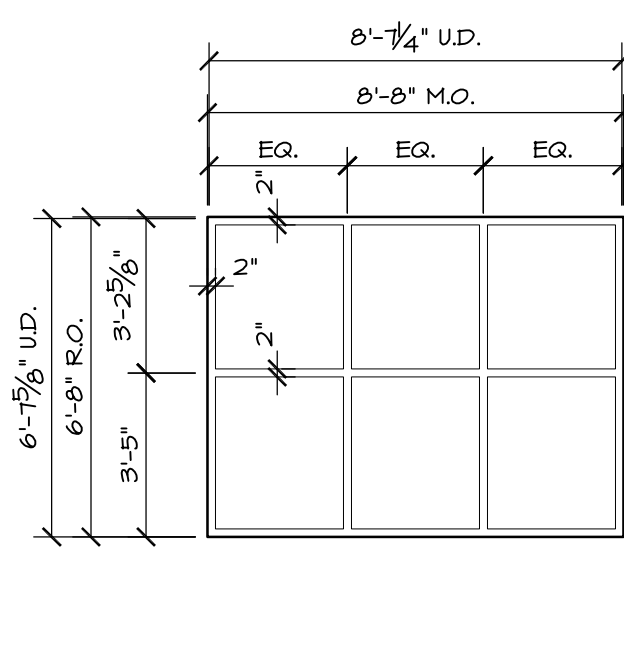

1K
A1B

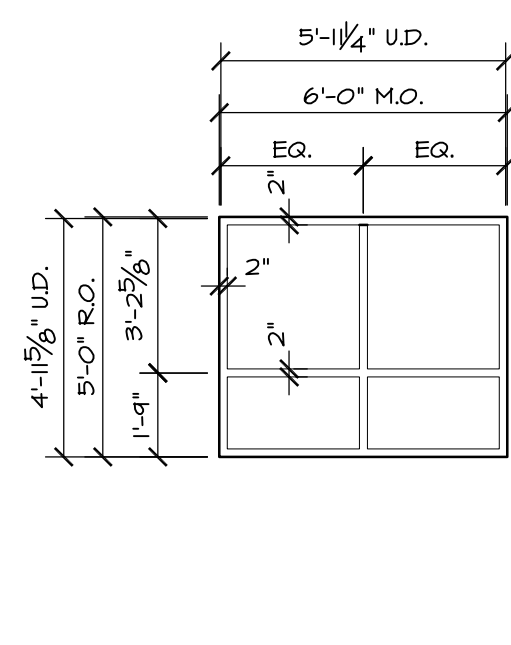

1L
A1B

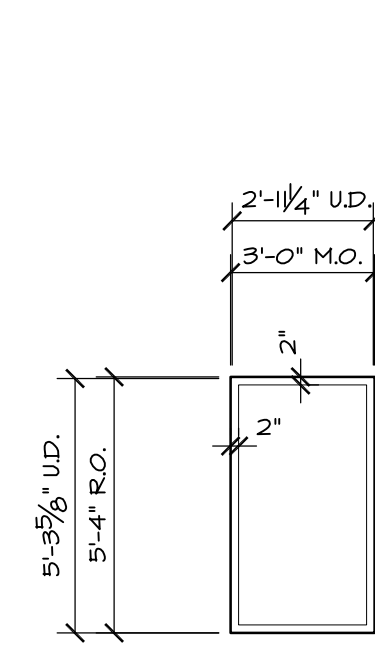

1M
A1B

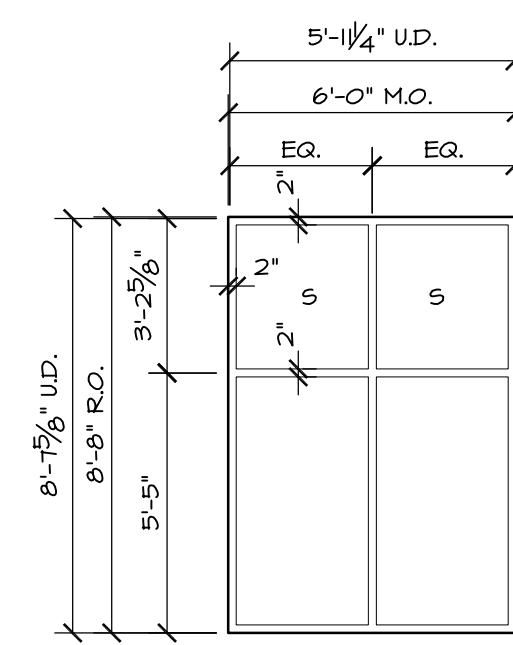

1N
A1B

1J
A1B
SAME AS 1H BUT WITH SPANDREL GLASS

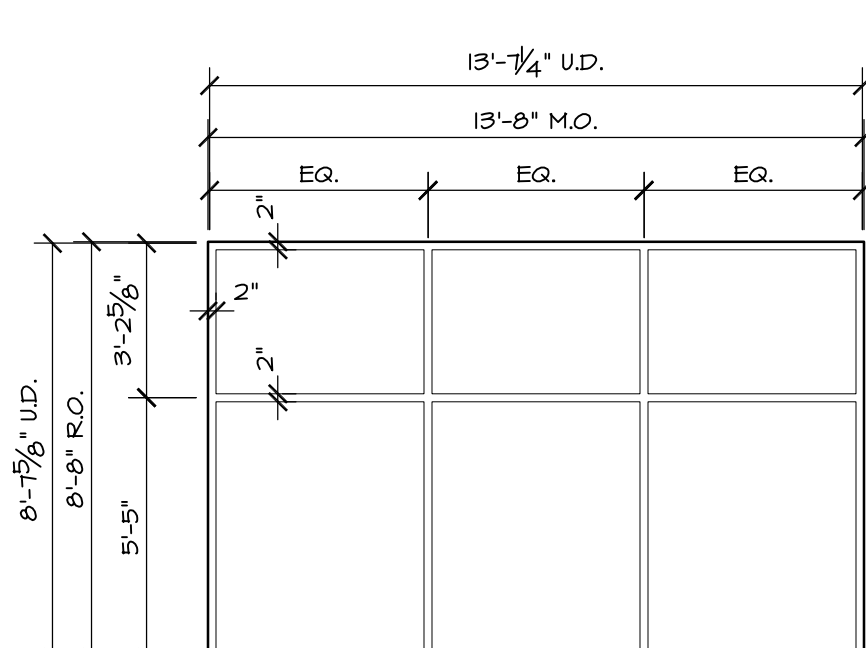

1O
A1B

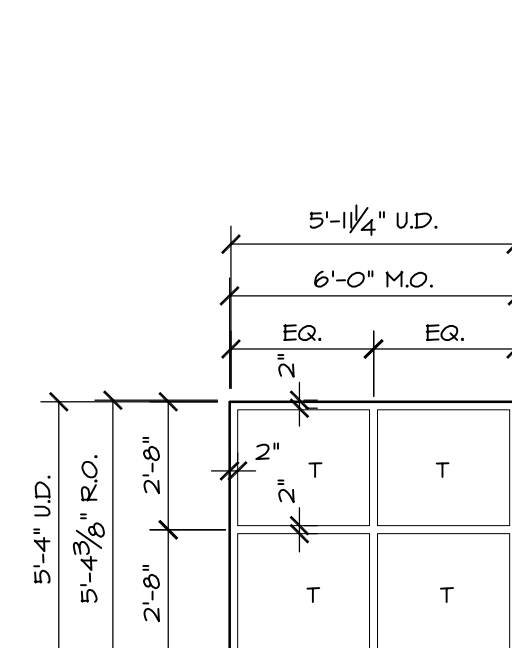

1P
A1B

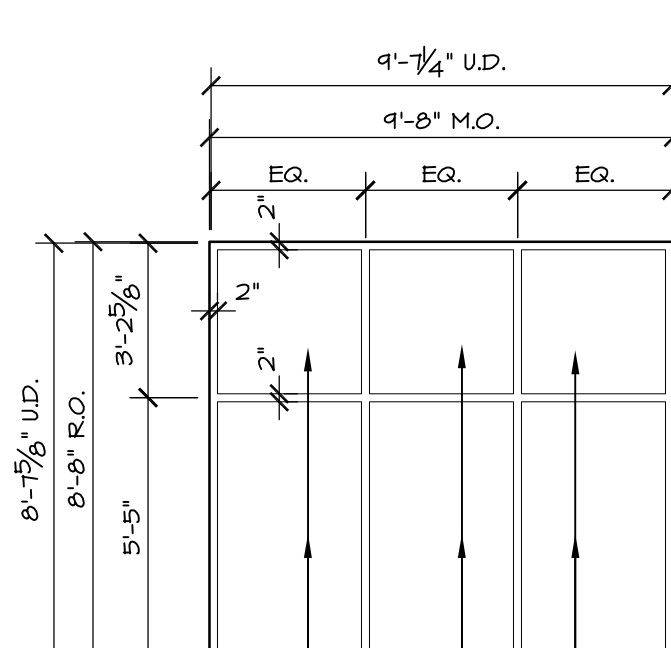

1Q
A1B

OPEN FRAME WITHOUT GLAZING

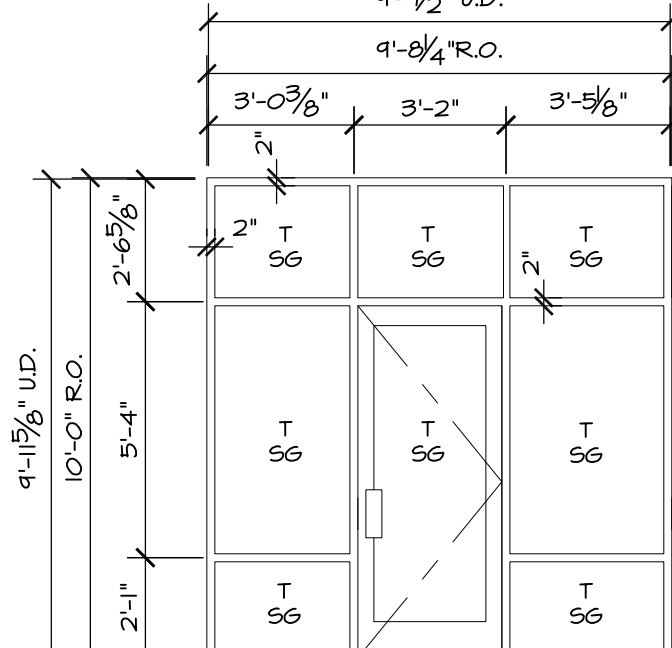

1R
A1B

3 ALUMINUM AUTOMATIC SLIDING ENTRANCE DOOR ELEVATIONS
1/4" = 1'-0"

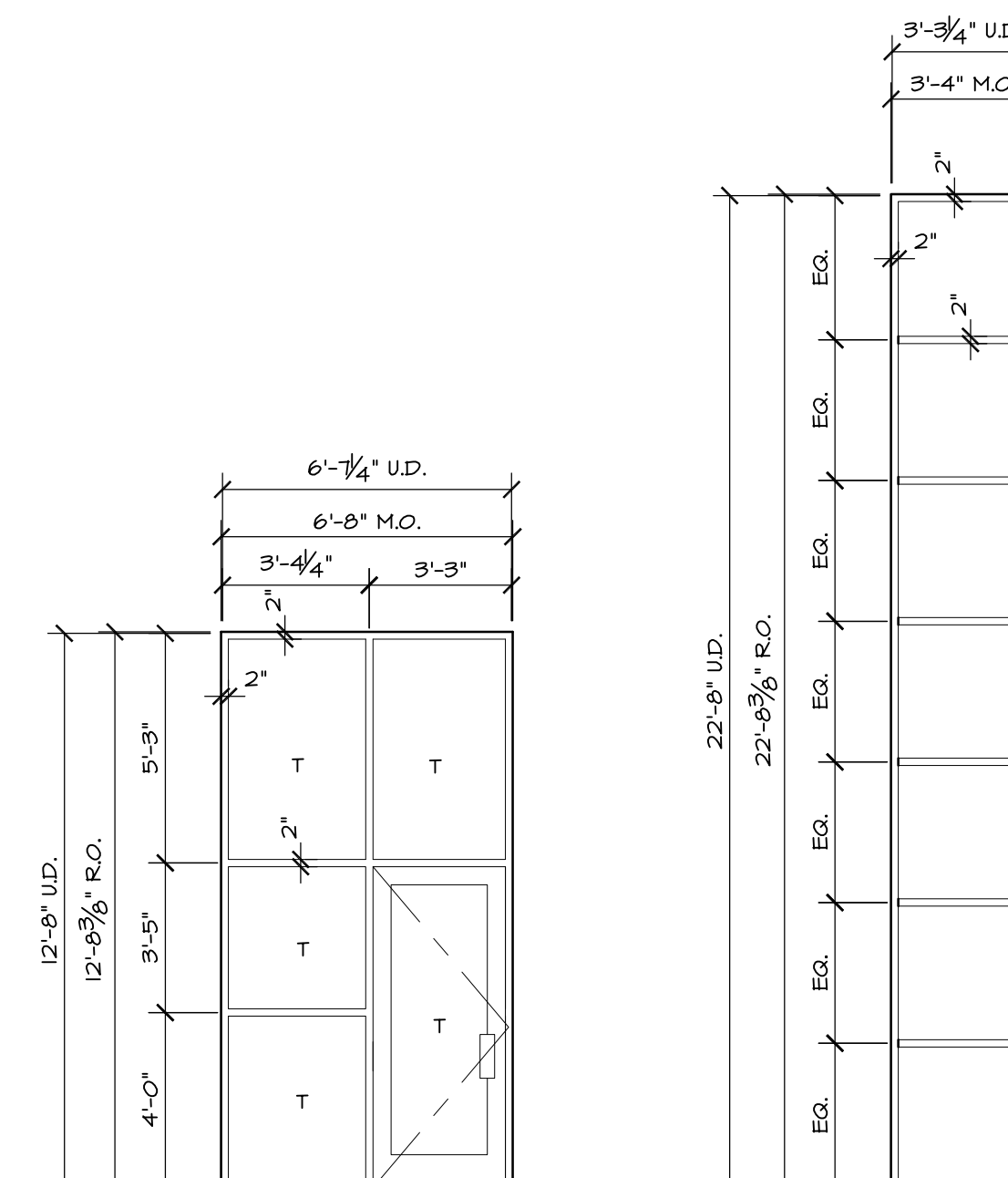

2C
A1B

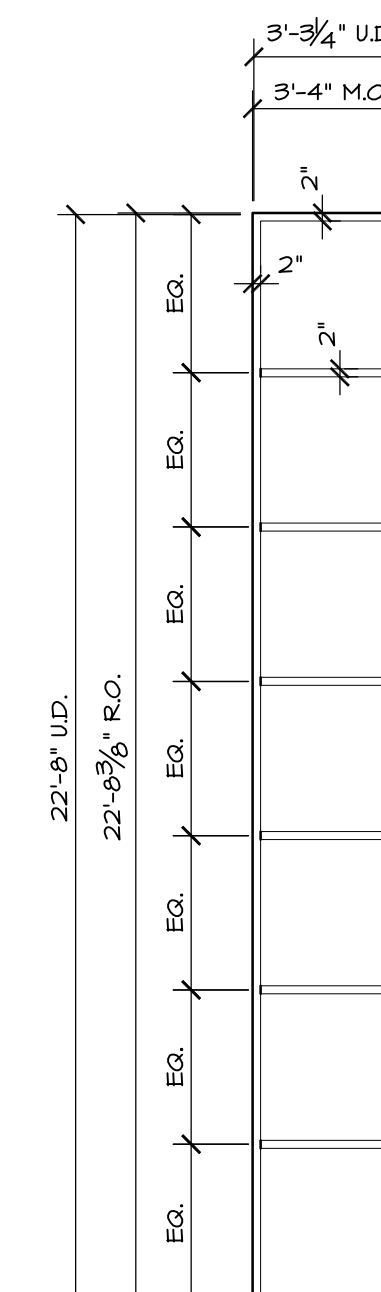

2D
A1B

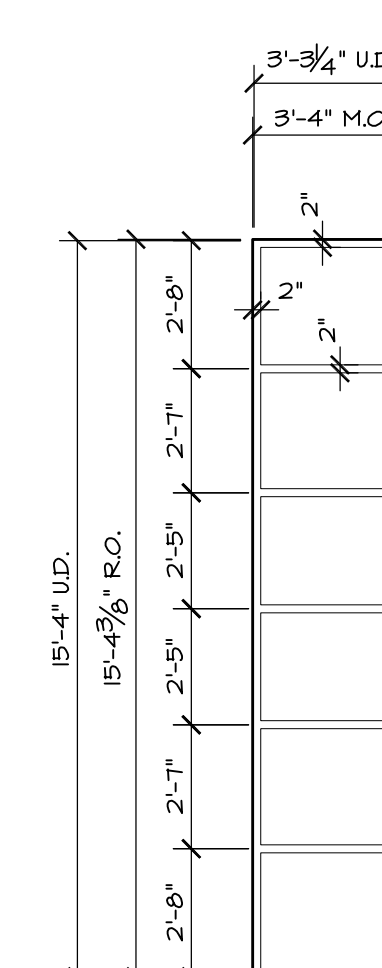

2E
A1B

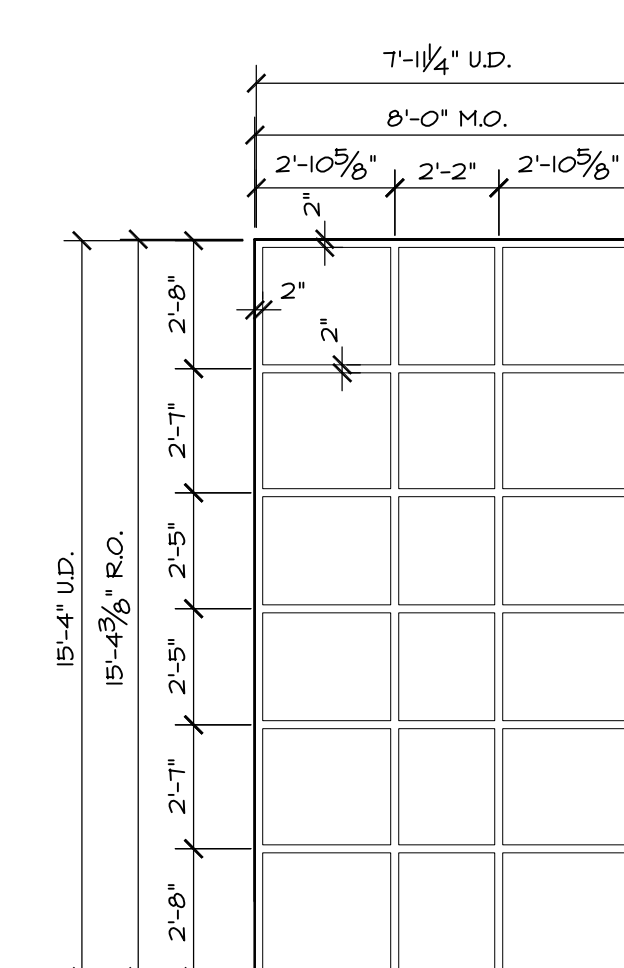

2F
A1B

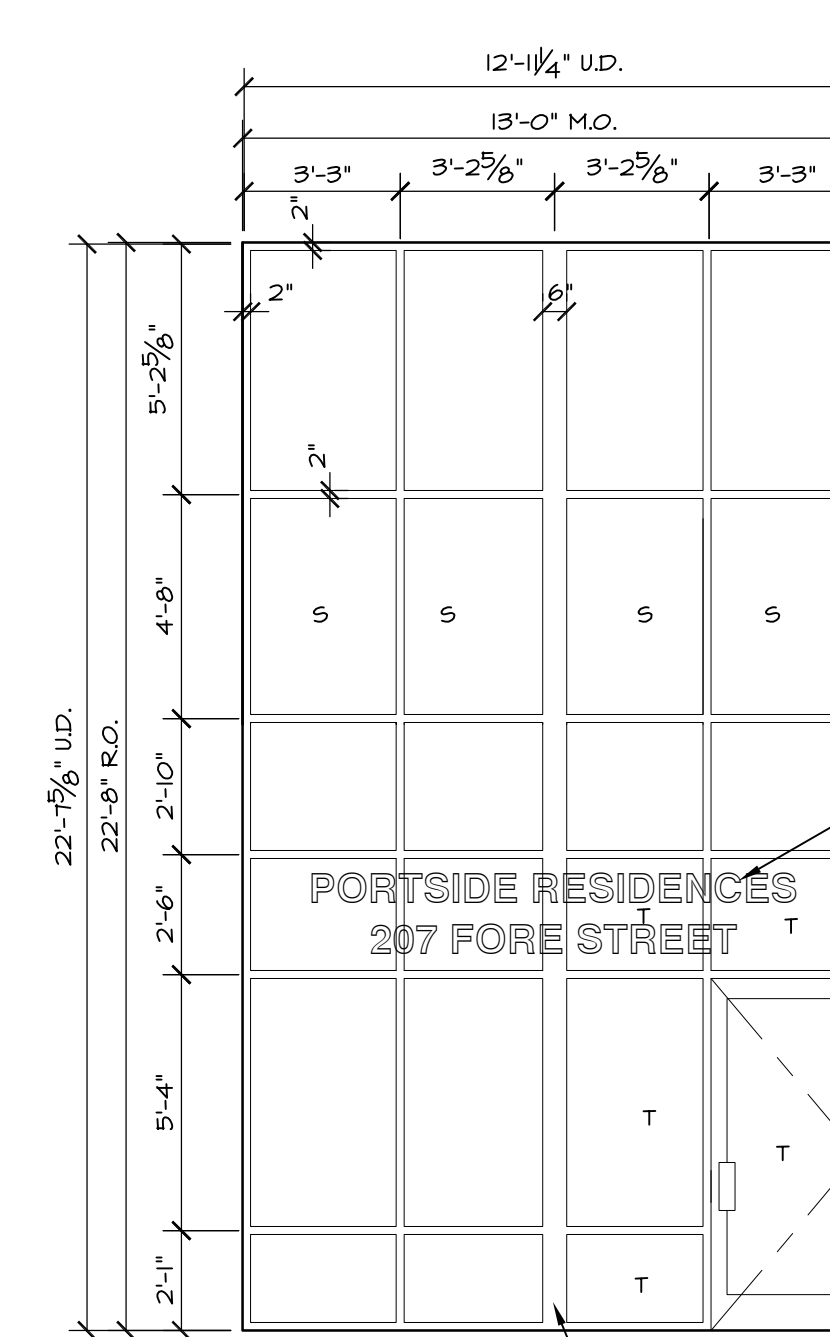

2A
A1B

NOTE: CANOPY SUPPORT PENETRATES ALUMINUM COLUMN COVER AND SHALL BE SEALED WEATHERTIGHT (REFER TO ARCH. ELEV.)

ALUMINUM SIGNAGE TO BE MOUNTED TO CURTAIN WALL. COORDINATE WITH SIGN MANUFACTURER

WRAP HSS TUBE COLUMN. CURTAIN WALL CANNOT USE HSS TUBE FOR LATERAL RESTRAINT - SPAN CURTAIN WALL VERTICALLY FLOOR TO FLOOR. (SEE STRUCT. DRAWINGS)

2 ALUMINUM CURTAIN WALL ELEVATIONS
1/4" = 1'-0"

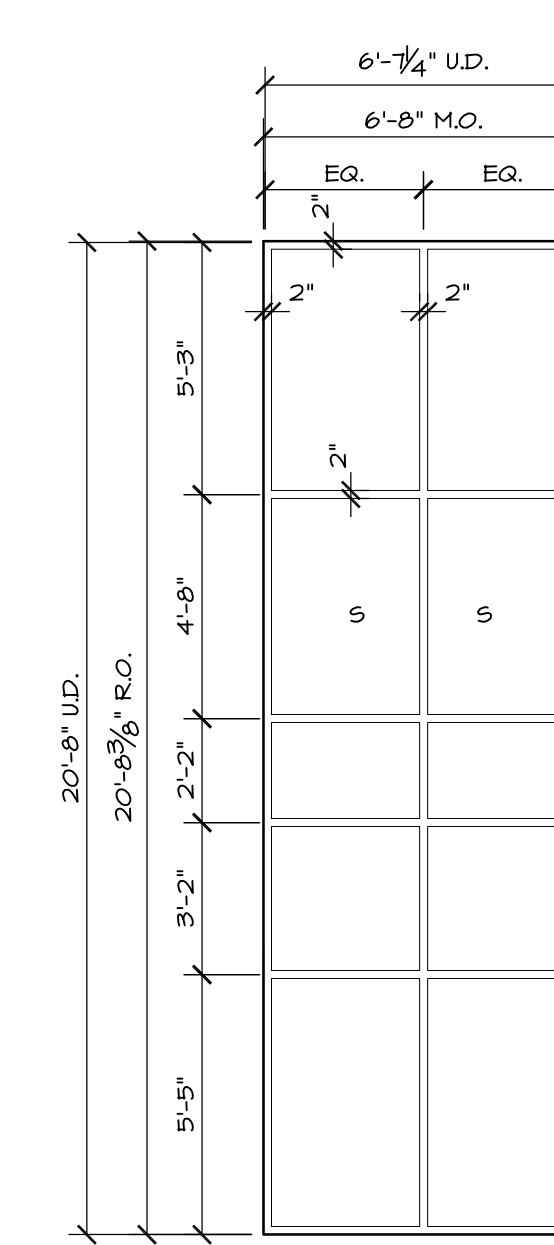

2B
A1B

1 ALUMINUM STOREFRONT ELEVATIONS
1/4" = 1'-0"

REVISION SCHEDULE	REVISION DESCRIPTION	DATE	BY
08-06-10	REVISE FOR PRECAST CONCRETE		dwb

LOPECHED
CONSTRUCTION CORPORATION
11 CORPORATE DRIVE, BELMONT, NH 03320
PHONE: (603) 321-7000 FAX: (603) 321-5151

STOREFRONT & CURTAIN WALL ELEVATIONS

PROJECT: Hotel, Restaurant, & Portside Residences
Portland ME

DATE: 05-28-10
SCALE: 1/4" = 1'-0"
DRAWN BY: dwb

A18
SHEET

