



209 Fore Street
Portland, Maine 04101
PH: 207-775-1454, Fax: 207-775-1383



THESE DRAWINGS WERE PREPARED TO INCORPORATE HILTON'S STANDARD 'FOREVER YOUNG' SCHEME, IMPLEMENTED BY JULI RUSSELL INTERIOR DESIGN GROUP. THEY ARE ONLY TO BE USED AS AUTHORIZED BY JULI RUSSELL INTERIOR DESIGN GROUP.

GUESTROOM: PLANS
FILE NAME: HAMPTON INN: PORTLAND DOWNTOWN - WATERFRONT
OWNER: "FOREVER YOUNG" SCHEME
REVISION DATE:
DECOR:

NOT FOR CONSTRUCTION
THIS PACKAGE IS REPRESENTATIVE OF DESIGN CRITERIA AND IS NOT FOR CONSTRUCTION. THE OWNER/FRANCHISEE'S CONSULTING ARCHITECT AND ENGINEERS SHALL BE RESPONSIBLE FOR VERIFYING AND COMPLYING WITH ALL APPLICABLE LAWS (I.E. ADA), CODES, ORDINANCES, RULES, REGULATIONS AND OTHER LEGAL REQUIREMENTS OF ADMINISTRATIVE AUTHORITIES HAVING JURISDICTION.

QUEEN QUEEN
GUESTROOM PLANS

ID4.01

WALL FINISH LEGEND		
WC-01	GUEST HEADBOARD WALL VINYL.....	
WC-02	GUEST BATH WALL VINYL.....	
WC-03	MAIN GUESTROOM WALL VINYL.....	

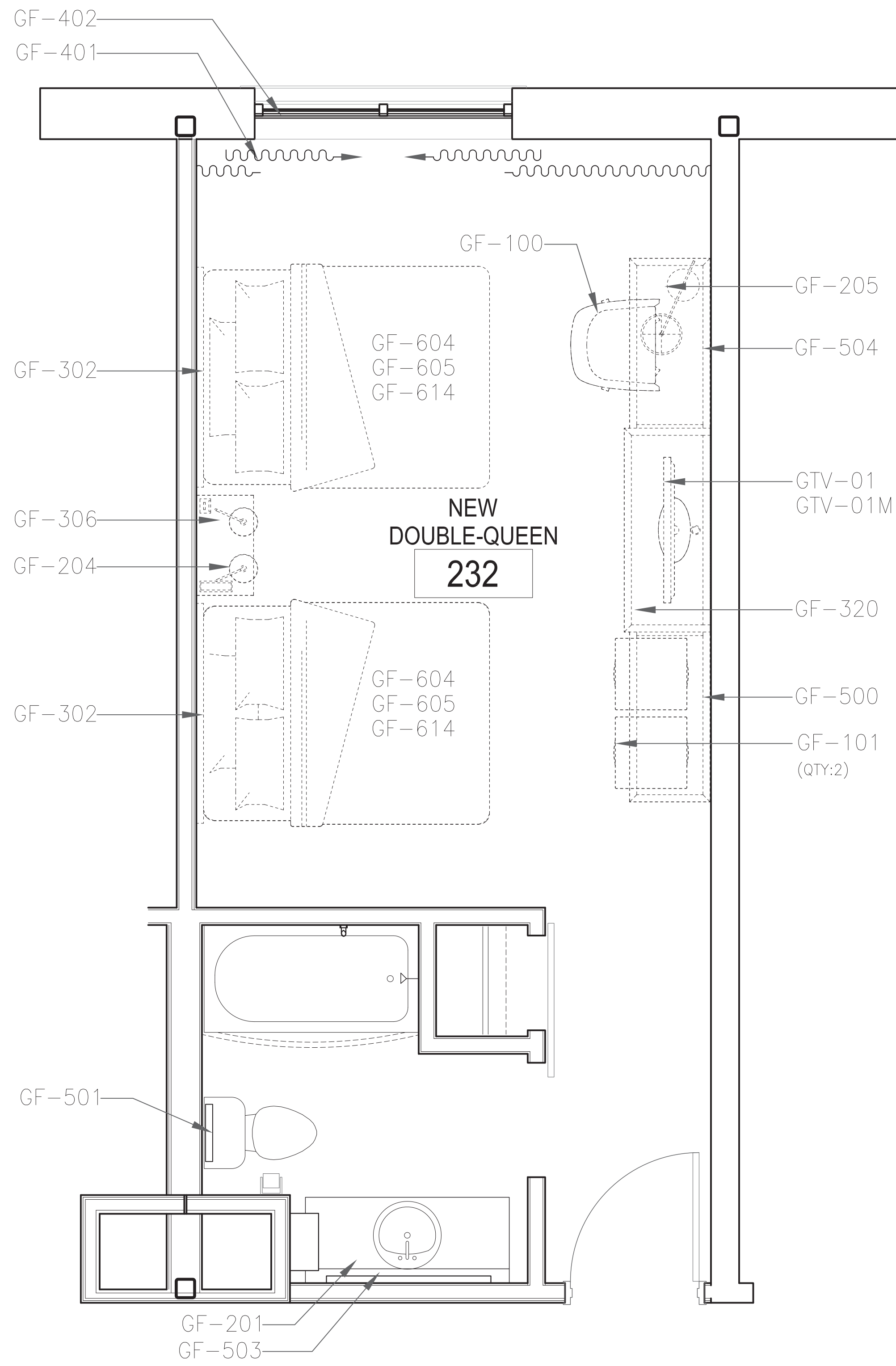

1 TYP. QUEEN/QUEEN
ID4.01 SCALE: 1/2" = 1'-0"

FOREVER YOUNG SCHEME

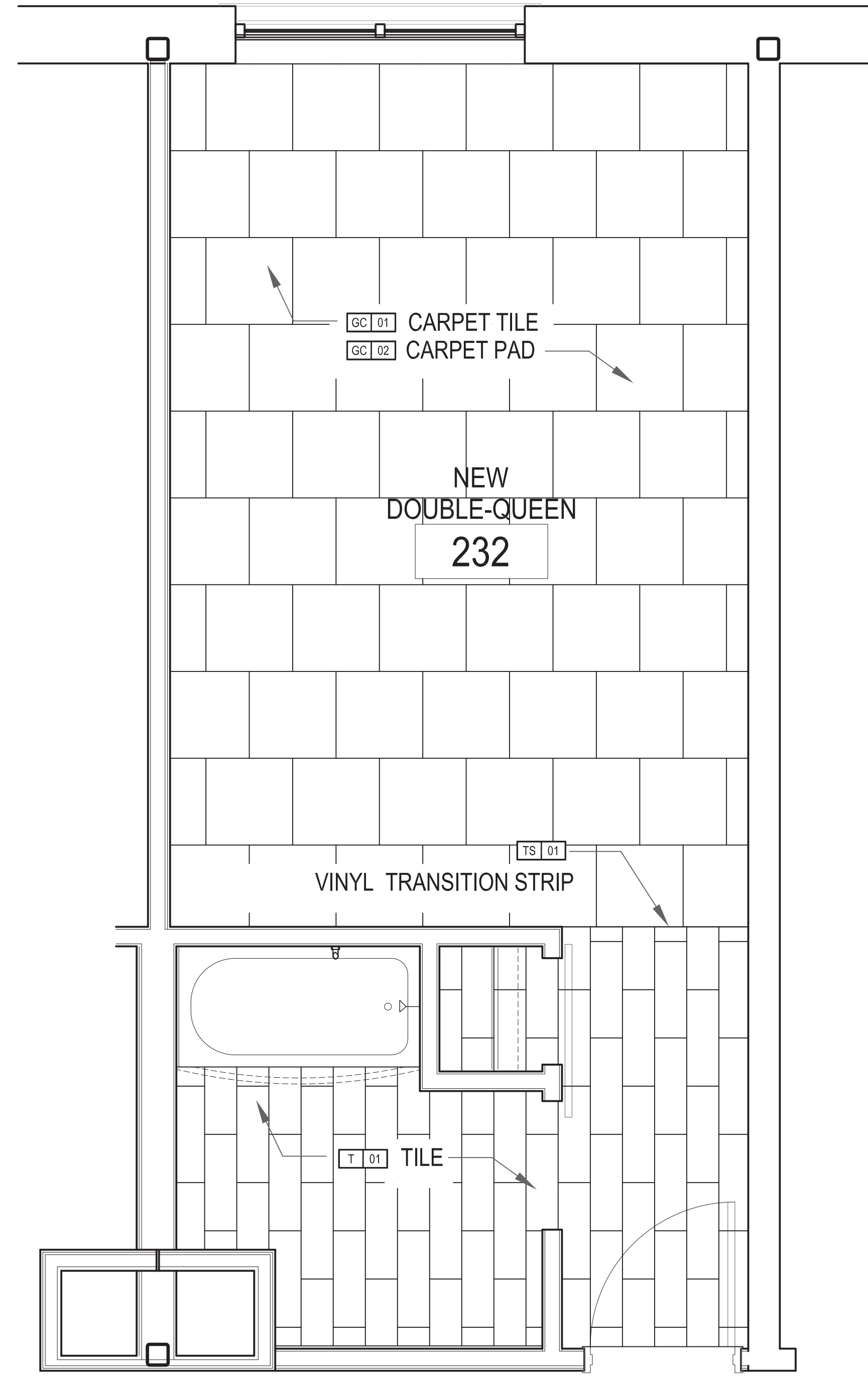

2 TYP. QUEEN/QUEEN FLOOR FINISH PLAN
ID4.01 SCALE: 1/2" = 1'-0"

FOREVER YOUNG SCHEME

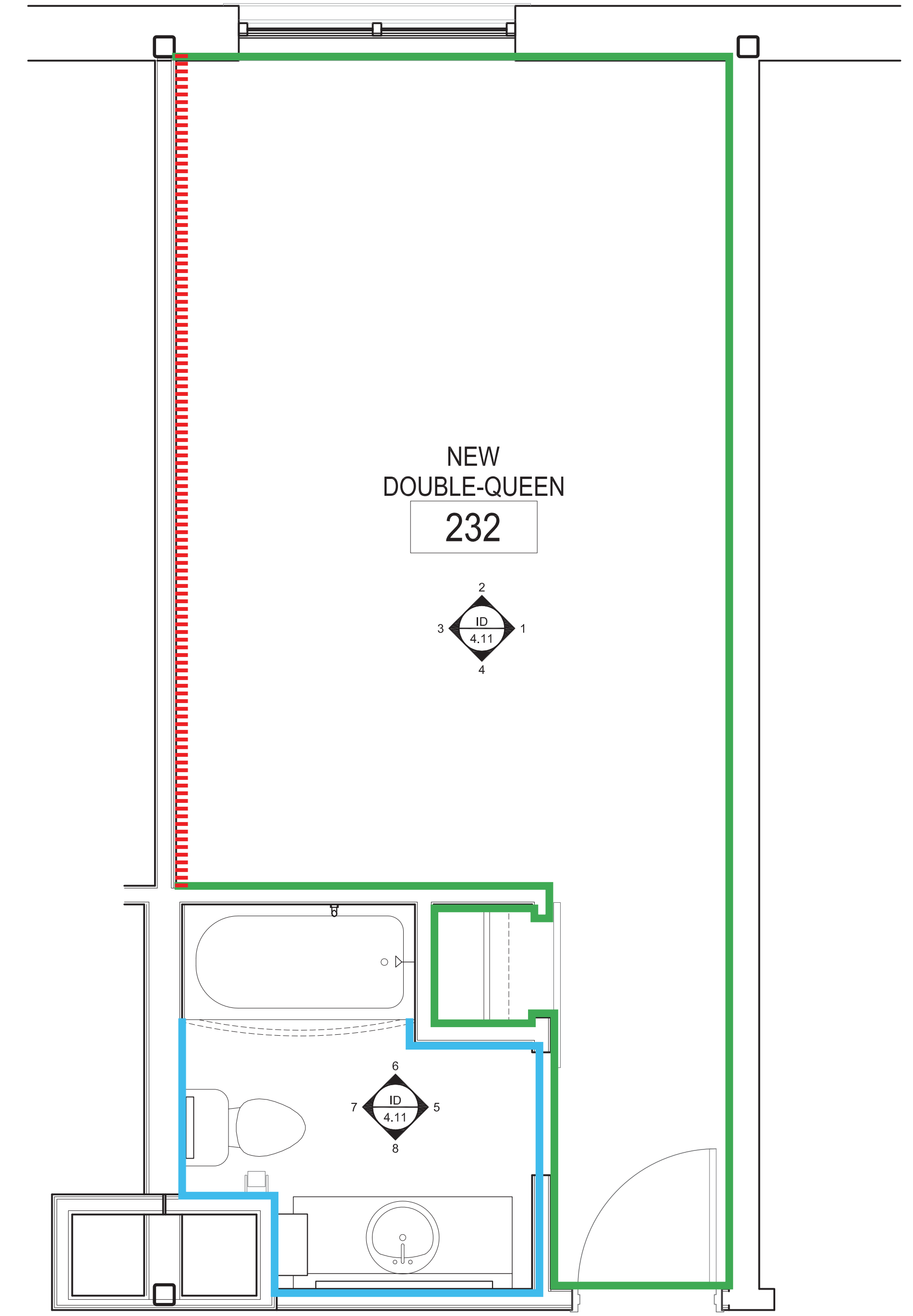

3 TYP. QUEEN/QUEEN WALL FINISH PLAN
ID4.01 SCALE: 1/2" = 1'-0"

FOREVER YOUNG SCHEME