

DISPLAY THIS CARD ON PRINCIPAL FRONTAGE OF WORK

CITY OF PORTLAND

BUILDING DEPARTMENT

PERMIT

Please Read Application And Notes, If Any, Attached

Permit Number: 041515

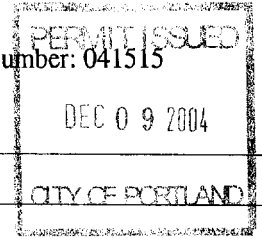

This is to certify that Olympia Equity Investors V-llc /Neol
has permission to install a 9.2 sf illuminated sign and a 54.0 sf illuminated sign
AT 284 Fore St 029 K005001

provided that the person or persons, firm or corporation accepting this permit shall comply with all of the provisions of the Statutes of Maine and of the Ordinances of the City of Portland regulating the construction, maintenance and use of buildings and structures, and of the application on file in this department.

Apply to Public Works for street line and grade if nature of work requires such information.

Notification of inspection must be given and written permission procured before this building or part thereof is loaded or closed-in. **HEAVY NOTICE IS REQUIRED.**

A certificate of occupancy must be procured by owner before this building or part thereof is occupied.

OTHER REQUIRED APPROVALS

Fire Dept. _____
Health Dept. _____
Appeal Board _____
Other _____
Department Name

[Signature]
Director - Building & Inspection Services

PENALTY FOR REMOVING THIS CARD

City of Portland, Maine - Building or Use Permit Application

389 Congress Street, 04101 Tel: (207) 874-8703, Fax: (207) 874-8716

Permit No: 04-1515	Issue Date: 11/15/04	CBL: 029 K005001
-----------------------	-------------------------	---------------------

Location of Construction: 284 Fore St	Owner Name: Olympia Equity Investors V-p Llc	Owner Address: 50 Monument Sq	Phone:
Business Name:	Contractor Name: NeoKraft Signs	Contractor Address: 686 Main St. Lewiston	Phone: 2077829654
Lessee/Buyer's Name	Phone:	Permit Type: Signs - Permanent	Zone: B3

Past Use: commercial	Proposed Use: commercial install 2 illuminated signs	Permit Fee: \$192.68	Cost of Work: \$192.68	CEO District: 1
Proposed Project Description: install a 9.2 sf illuminated sign and a 54.64 sf illuminated sign		FIRE DEPT: <input type="checkbox"/> Approved <input type="checkbox"/> Denied	INSPECTION: Use Group: U Type:	
		Signature:	Signature: <i>[Signature]</i>	
PEDESTRIAN ACTIVITIES DISTRICT (P.A.D.) Action: <input type="checkbox"/> Approved <input type="checkbox"/> Approved w/Conditions <input type="checkbox"/> Denied Signature: Date:				

Permit Taken By: dmartin	Date Applied For: 10/07/2004	Zoning Approval
-----------------------------	---------------------------------	------------------------

Special Zone or Reviews	Zoning Appeal	Historic Preservation
<input type="checkbox"/> Shoreland <input type="checkbox"/> Wetland <input type="checkbox"/> Flood Zone <input type="checkbox"/> Subdivision <input type="checkbox"/> Site Plan Maj <input type="checkbox"/> Minor <input type="checkbox"/> MM <input type="checkbox"/>	<input type="checkbox"/> Variance <input type="checkbox"/> Miscellaneous <input type="checkbox"/> Conditional Use <input type="checkbox"/> Interpretation <input type="checkbox"/> Approved <input type="checkbox"/> Denied	<input type="checkbox"/> Not in District or Landmark <input type="checkbox"/> Does Not Require Review <input type="checkbox"/> Requires Review <input type="checkbox"/> Approved <input checked="" type="checkbox"/> Approved w/Conditions <input type="checkbox"/> Denied
Date: <i>ok 11/5/04</i>	Date:	Date: <i>see form to Deb</i>

*D. Andrews
11/28/04*

CERTIFICATION

I hereby certify that I am the owner of record of the named property, or that the proposed work is authorized by the owner of record and that I have been authorized by the owner to make this application as his authorized agent and I agree to conform to all applicable laws of this jurisdiction. In addition, if a permit for work described in the application is issued, I certify that the code official's authorized representative shall have the authority to enter all areas covered by such permit at any reasonable hour to enforce the provision of the code(s) applicable to such permit.

SIGNATURE OF APPLICANT	ADDRESS	DATE	PHONE
RESPONSIBLE PERSON IN CHARGE OF WORK, TITLE		DATE	PHONE

Color profile: Generic CMYK printer composite Default screen

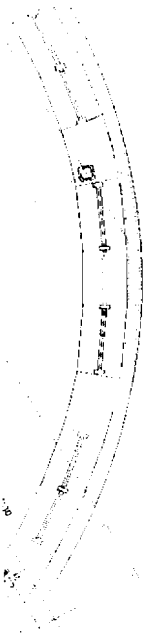

PARTIAL TOP VIEW

SCALE: 1/8"=1'-0"±

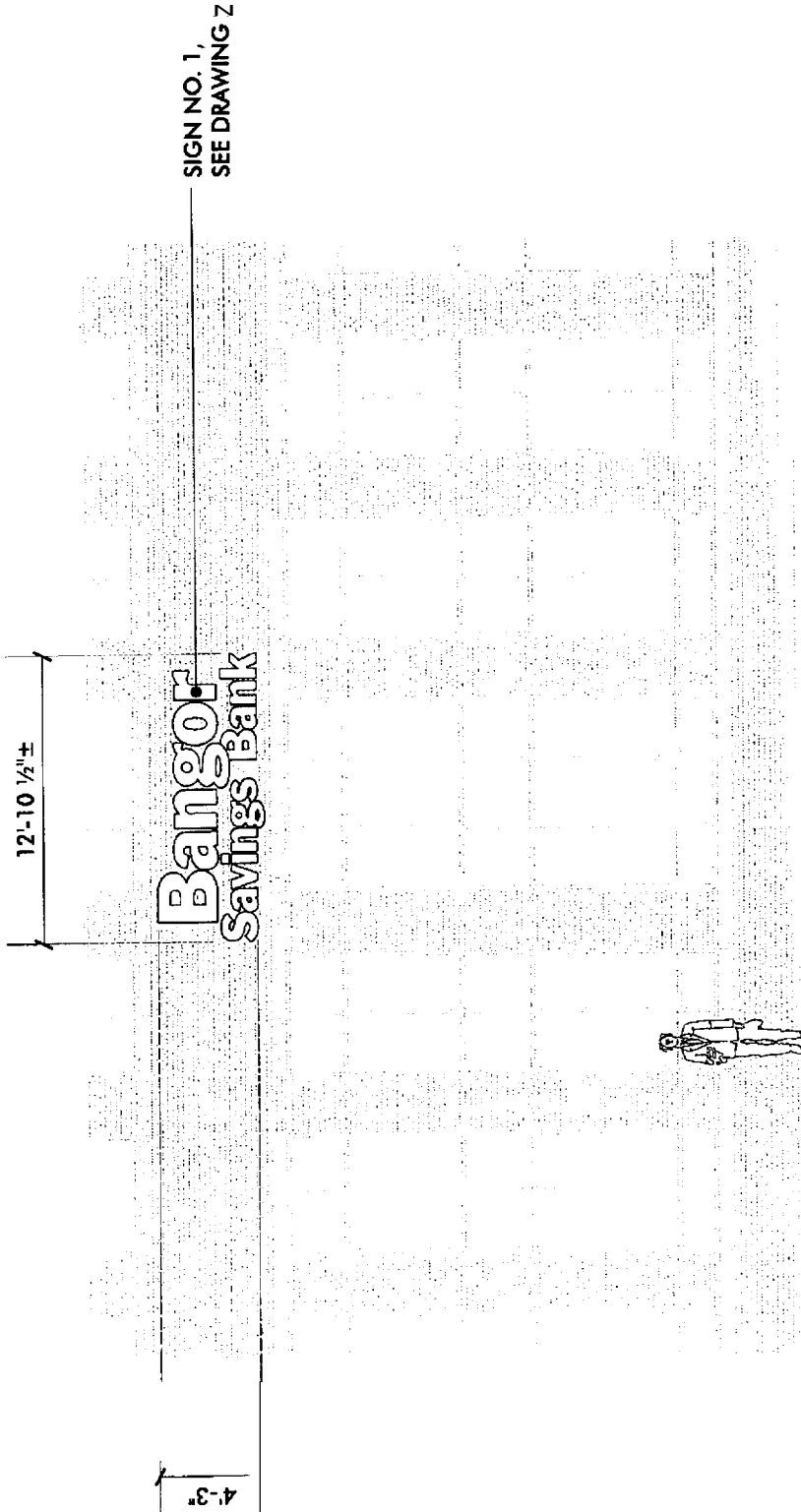

FLAT VIEW—PARTIAL ELEVATION

SCALE: 1/8"=1'-0"±

FAX TO: LANEY
COMPANY: CITY OF PORTLAND
NO. OF PAGES: 1 OF 5
REF: 2612
DATE: 12.02.2004
JOB NAME: BANGOR SAVINGS BANK
280 FORE ST.
PORTLAND, ME

Neokraft Signs Inc.
 686 Main Street
 Lewiston, Maine 04240
 Telephone: 207.782.9654
 Facsimile: 207.782.0009
 1.800.339.2258
<http://www.neokraft.com>

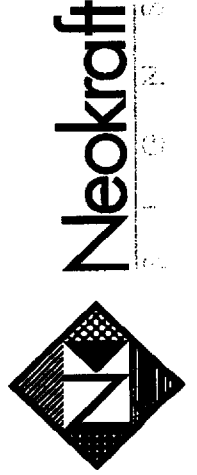

COLOR PROFILE: Generic CMK pf d r profile
Composite Default screen

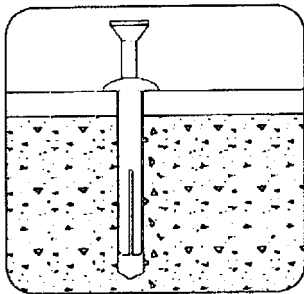

1/2" x 2" ZAMAC HAMMER SCREW™ DRIVE ANCHORS AS MFG. BY POWERS FASTENERS, NEW ROCHELLE, NY

ZAMAC ALLOY WITH CARBON OR STAINLESS STEEL, ONE-STEP DRIVE ANCHOR FEATURING A PHILLIPS TYPE HEAD AND A SCREW THREAD FOR USE IN CONCRETE, BLOCK, BRICK OR STONE

SEE PRODUCT LITERATURE OR http://www.powers.com/product_02843.html

SECTION ABOVE WINDOW

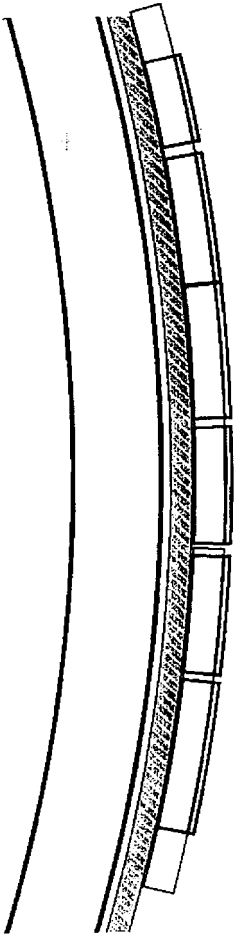

DRIVE-ANCHOR MOUNTING DETAIL

NOT TO SCALE

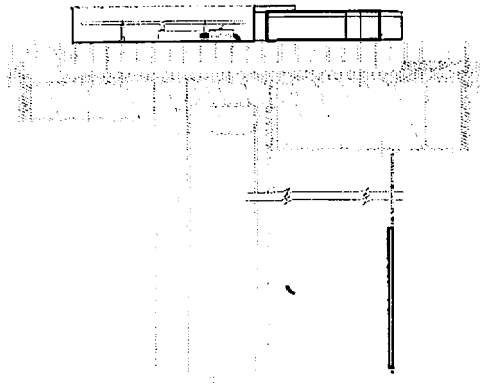

12'-10 1/2" ±

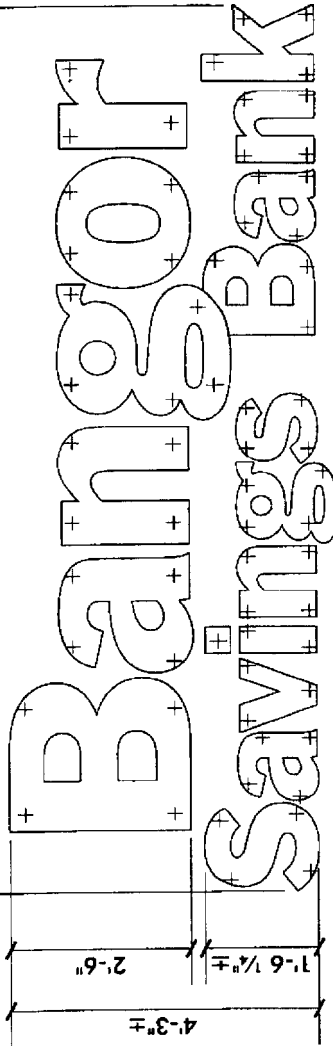

(1) DRIVE ANCHOR AT EACH MARKED LOCATION INTO BRICK—SEE DETAIL

WALL SECTION

SIGN NO. 1 FRONT VIEW—MOUNTING INFORMATION

SCALE: 3/8"=1'-0"

DATE: 12.02.2004
REF: 2612

JOB NAME: BANGOR SAVINGS BANK
280 FORE ST.
PORTLAND, ME

FAX TO: LANEY
COMPANY: CITY OF PORTLAND
FAX: 207.874.8716
NO. OF PAGES: 2 OF 5

REPLY TO: PAUL LESSARD
TEL.: 207.782.9654
207.782.0009

Neokraft Signs Inc.
686 Main Street
Lewiston, Maine 04240
Telephone: 207.782.9654
Facsimile: 207.782.0009
1.800.339.2258
<http://www.neokraft.com>



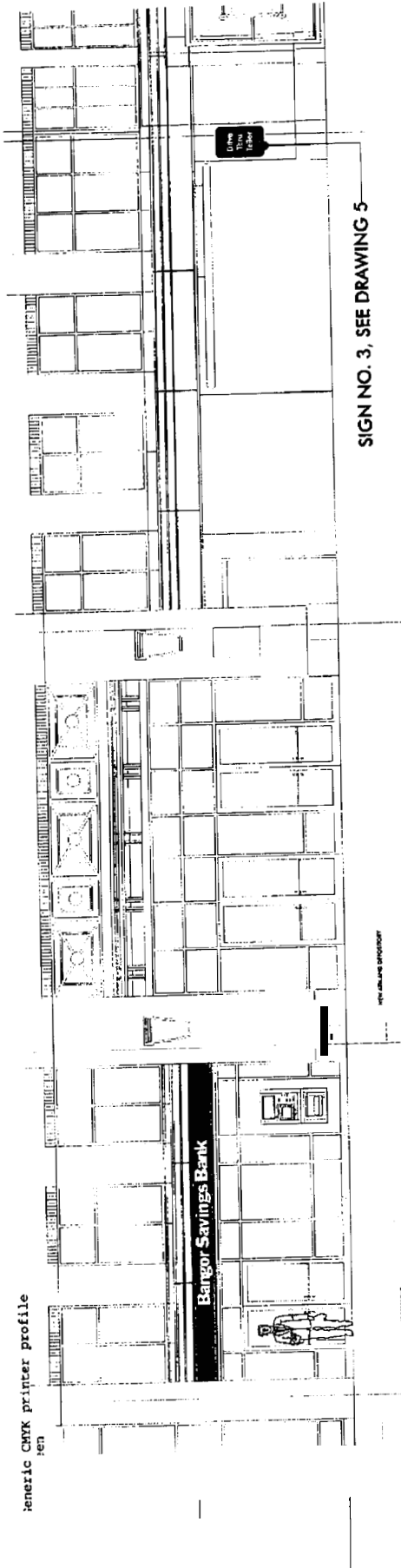

PARTIAL ELEVATION
SCALE: 3/32" = 1'-0" ±

SECTION 4 - ELEVATION

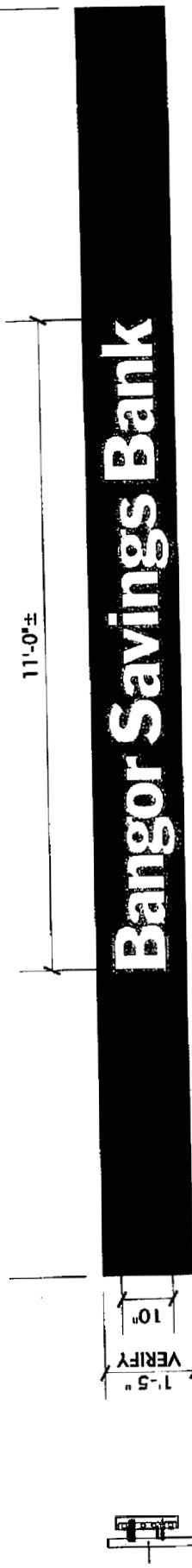

2" DEEP REVERSE-CHANNEL FOAM LETTERS ATTACHED TO FABRICATED ALUMINUM BACKGROUND WITH NUTTED STUD MOUNTING—SEE DETAIL, DRAWING 4

FABRICATED ALUMINUM BACKGROUND ATTACHED TO METAL CLAD WOOD FRAMING WITH WOOD SCREWS

SIGN NO. 2 FRONT VIEW—MOUNTING DETAILS

SCALE: 3/8" = 1'-0"

SECTION
NTS

DATE: 12.02.2004
 REF: 2612

FAX TO: LANEY
 COMPANY: CITY OF PORTLAND
 FAX: 207.874.8716
 NO. OF PAGES: 3 OF 5

JOB NAME: BANGOR SAVINGS BANK
 280 FORE ST.
 PORTLAND, ME

REPLY TO: PAUL LESSARD
 TEL.: 207.782.9654
 207.782.0009

Neokraft Signs Inc.
 686 Main Street
 Lewiston, Maine 04240
 Telephone: 207.782.9654
 Facsimile: 207.782.0009
 1.800.339.2258
 http://www.neokraft.com



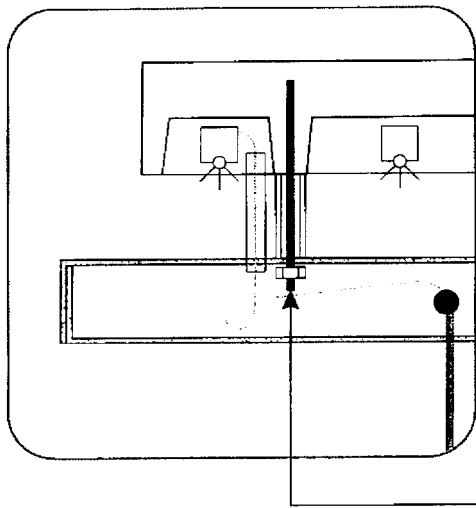

ALUMINUM STUDS, NUTTED ON BACK OF ALUMINUM BACKGROUND PANEL

STUD-MOUNTING DETAIL

NOT SCALE

Wind Load Calculations on Letters with 5:1 ht:depth ratio

Size	Wind Face Load lbs. Force	Wind Side Load lbs. Force	Screw Shear Strength lbs. Force
6	13	5	720
10	35	15	960
12	50	20	960
14	68	25	960
18	112	40	960
24	199	70	1440
36	447	150	1920

Letter Data

Height in.	Face Area sq.in.	Side Area sq.in.	Screws each	Screw Area psi	Total Screw sq. in.
	6	21.6	7.2	3	0.015
10	60	20	4	0.015	0.06
12	86.4	28.8	4	0.015	0.06
14	117.6	39.2	4	0.015	0.06
18	194.4	64.8	4	0.015	0.06
24	345.6	115.2	6	0.015	0.09
36	777.6	259.2	8	0.015	0.12

Assumptions and Facts

The point of failure will be the aluminum screws in shear at the minor thread diameter.

144 mph wind speed is equal to 82.7 lbs./sq. ft. (0.574 lbs./sq.in.).

Tensile strength at break for 3003 Aluminum is 16,000 psi.

Minor thread area in shear of a 10-24 aluminum screw is .015 sq. in. at 2 threads depth.

Therefore, each screw has a holding force in shear of 240 lbs.. Average face area of a sign letter is 0.6 x height squared.

DATE: 12.02.2004
REF: 2612

JOB NAME: BANGOR SAVINGS BANK
280 FORE ST.
PORTLAND, ME

FAX TO: LANEY
COMPANY: CITY OF PORTLAND
FAX: 207.874.8716
NO. OF PAGES: 4 OF 5

REPLY TO: PAUL LESSARD
TEL.: 207.782.9654
207.782.0009

G:\DESIGN\02612\BANGOS\Portland\280 Fore St\mounting.cdr
Friday, December 03, 2004 10:56:35 AM



Neokraft
S I G N S

Neokraft Signs Inc.
686 Main Street
Lewiston, Maine 04240
Telephone: 207.782.9654
Facsimile: 207.782.0009
1.800.339.2258
http://www.neokraft.com

Color profile: Generic CMYK printer profile
Composite Default screen

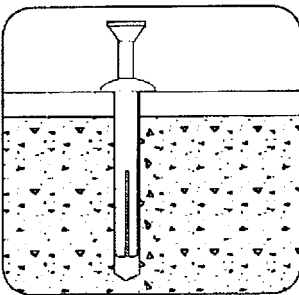

1/4" x 2" ZAMAC HAMMER SCREW™ DRIVE ANCHORS AS MFG BY POWERS FASTENERS, NEW ROCHELLE, NY

ZAMAC ALLOY WITH CARBON OR STAINLESS STEEL, ONE-STEP DRIVE ANCHOR FEATURING A PHILLIPS TYPE HEAD AND A SCREW THREAD FOR USE IN CONCRETE, BLOCK, BRICK OR STONE

SEE PRODUCT LITERATURE OR http://www.powers.com/product_02843.html

DRIVE-ANCHOR MOUNTING DETAIL

NOT TO SCALE

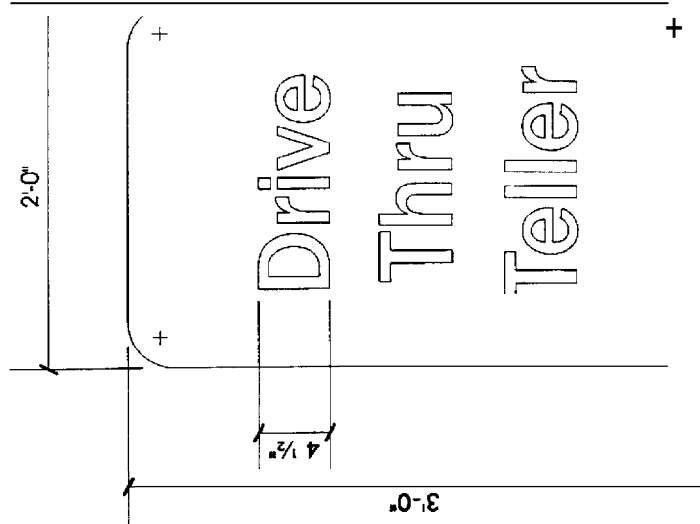

NARROW PROFILE ALUMINUM CONSTRUCTION WITH ROUTED ALUMINUM FACE, PUSH-THRU FLUSH ACRYLIC COPY

I.E.D. INTERNAL ILLUMINATION

MOUNT SIGN FLUSH TO WALL

(1) DRIVE ANCHOR AT EACH MARKED LOCATION INTO BRICK—SEE DETAIL

END VIEW

NTS

SIGN NO. 3 FRONT VIEW—INT. ILLUM. WALL SIGN

(1) REQUIRED

SCALE: 1"=1'-0"

FAX TO: LANEY
COMPANY: CITY OF PORTLAND
FAX: 207.874.8716
NO. OF PAGES: 5 OF 5

REPLY TO: PAUL LESSARD
TEL.: 207.782.9654
207.782.0009

DATE: 12.02.2004
REF: 2612

JOB NAME: BANGOR SAVINGS BANK
280 FORE ST.
PORTLAND, ME

Neokraft Signs Inc.
686 Main Street
Lewiston, Maine 04240
Telephone: 207.782.9654
Facsimile: 207.782.0009
1.800.339.2258
<http://www.neokraft.com>



City of Portland, Maine - Building or Use Permit

389 Congress Street, 04101 Tel: (207) 874-8703, Fax: (207) 874-8716

Permit No: 04-1515	Date Applied For: 10/06/2004	CBL: 029 K005001
------------------------------	--	----------------------------

Location of Construction: 284 Fore St	Owner Name: Olympia Equity Investors V-p Llc	Owner Address: 50 Monument Sq	Phone:
Business Name:	Contractor Name: NeoKraft Signs	Contractor Address: 686 Main St. Lewiston	Phone (207) 782-9654
Lessee/Buyer's Name	Phone:	Permit Type: Signs - Permanent	

Proposed Use: commercial install 2 illuminated signs	Proposed Project Description: install a 9.2sf illuminated sign and a 54.64 sf illuminated sign
--	--

Dept: Historical **Status:** Approved with Conditions **Reviewer:** Deborah Andrews **Approval Date:** 11/23/2004
Note: **Ok to Issue:**

1) * Sign specifications to be consistent with Historic Preservation Board approvals.

Dept: Zoning **Status:** Approved **Reviewer:** Marge Schmuckal **Approval Date:** 11/05/2004
Note: **Ok to Issue:**

Dept: Building **Status:** Pending **Reviewer:** Mike Nugent **Approval Date:**
Note: **Ok to Issue:**

Comments:

11/24/2004-mjn: need structurals

Table 2.8 Sign Regulations by Zone

Downtown Business (B-3), Urban Commercial (B-5), Waterfront Central (WC) and Waterfront Special Use (WSU) Zones

* Signs located on individual landmark properties or within historic districts, P.A.D. overlay districts or P.A.D. encouragement areas shall, in addition to the provisions herein, be subject to article IX of this Code or the downtown urban design guidelines, as applicable. Where the design guidelines are more restrictive than these regulations, the design guidelines shall supercede the otherwise applicable dimensional standards.

* Freestanding signs shall be allowed only if the front facade of the building (or individual tenant's/tenant's frontage in the case of a multi-tenant building) is set back a distance of at least 20 feet from either of the front facades of the abutting buildings (or other tenants' frontage in the same multi-tenant building).

Freestanding Signs * See restrictions on Penn State

	Single & Multi-tenant Buildings
Area	16 sq. ft.
Height	6 ft.
Minimum Setback	5 ft.
# Freestanding signs per lot	1 per abutting street

Building Signs

	Single Tenant Buildings	Multi-Tenant Buildings	
		Bldg. ID Sign and/or Upper Floor Tenant Signs	Ind. Ground Floor Tenant Signs
Maximum cumulative permitted, area of all building signs	na	na	na
Sq. ft. per linear ft. of bldg. facade on which sign will be placed	2 sq. ft.	na	2 sq. ft. per ft. of tenant's building frontage
Maximum % of wall area on which sign(s) is(are) to be placed	na	5%	na
# bldg. signs permitted per lot	1 per facade + 1	1 per facade + 1 per tenant	1 per tenant (a)

(a) If individual tenant fronts on more than one street, one additional building sign is permitted for each additional frontage.

ALOKU CERTIFICATE OF LIABILITY INSURANCE

PRODUCER (2 07) 989-7381 FAX (2 07) 989-7383
Sargent, Tyler & West
 100 S. Main Street
 P.O. Box 188
 Brewer, ME 04412-0188

INSURED Bangor Savings Bank/

 P.o. Box 930
 Bangor, ME 04402-0930

THIS CERTIFICATE IS ISSUED AS A MATTER OF INFORMATION ONLY AND CONFERS NO RIGHTS UPON THE CERTIFICATE HOLDER. THIS CERTIFICATE DOES NOT ALTER OR CHANGE THE COVERAGE AFFORDED BY THE POLICIES BELOW.

INSURERS AFFORDING COVERAGE	NAIC #
INSURER A: Acadia Insurance Co.	
INSURER B: Maine Employers' Mutual Ins.Co	
INSURER C:	
INSURER D:	
INSURER E:	

COVERAGES

THE POLICIES OF INSURANCE LISTED BELOW HAVE BEEN ISSUED TO THE INSURED NAMED ABOVE FOR THE POLICY PERIOD INDICATED. NOTWITHSTANDING ANY REQUIREMENT, TERM OR CONDITION OF ANY CONTRACT OR OTHER DOCUMENT WITH RESPECT TO WHICH THIS CERTIFICATE MAY BE ISSUED OR MAY PERTAIN, THE INSURANCE AFFORDED BY THE POLICIES DESCRIBED HEREIN IS SUBJECT TO ALL THE TERMS, EXCLUSIONS AND CONDITIONS OF SUCH POLICIES. AGGREGATE LIMITS SHOWN MAY HAVE BEEN REDUCED BY PAID CLAIMS.

INSR ADD'L LTR	TYPE OF INSURANCE	POLICY NUMBER	POLICY EFFECTIVE DATE (MM/DD/YY)	POLICY EXPIRATION DATE (MM/DD/YY)	LIMITS
A	GENERAL LIABILITY <input checked="" type="checkbox"/> COMMERCIAL GENERAL LIABILITY <input type="checkbox"/> CLAIMS MADE <input checked="" type="checkbox"/> OCCUR GEN'L AGGREGATE LIMIT APPLIES PER: POLICY <input type="checkbox"/> PRO-JECT <input type="checkbox"/> LOC	CPP1001608-14	11/01/2003	11/01/2005	EACH OCCURRENCE \$ 1,000,000 DAMAGE TO RENTED PREMISES (Ea occurrence) \$ 250,000 MED EXP (Any one person) \$ 5,000 PERSONAL & ADV INJURY \$ 1,000,000 GENERAL AGGREGATE \$ 2,000,000 PRODUCTS - COMP/OP AGG \$ 2,000,000
	AUTOMOBILE LIABILITY <input checked="" type="checkbox"/> ANY AUTO <input type="checkbox"/> ALL OWNED AUTOS <input type="checkbox"/> SCHEDULED AUTOS <input type="checkbox"/> HIRED AUTOS <input type="checkbox"/> NON-OWNED AUTOS	CAP1001609-15	11/01/2003	11/01/2005	COMBINED SINGLE LIMIT (Ea accident) 1,000,000 BODILY INJURY (Per person) \$ BODILY INJURY (Per accident) \$ PROPERTY DAMAGE (Per accident) \$
	GARAGE LIABILITY <input type="checkbox"/> ANY AUTO				AUTO ONLY - EA ACCIDENT \$ OTHER THAN AUTO ONLY: EA ACC \$ AGG \$
A	EXCESS/UMBRELLA LIABILITY <input type="checkbox"/> OCCUR <input type="checkbox"/> CLAIMS MADE DEDUCTIBLE RETENTION \$	CUA1001610-14	11/01/2003	11/01/2005	EACH OCCURRENCE \$ 10,000,000 AGGREGATE \$ 10,000,000 \$ \$ \$
B	WORKERS COMPENSATION AND EMPLOYERS' LIABILITY ANY PROPRIETOR/PARTNER/EXECUTIVE OFFICER/MEMBER EXCLUDED? If yes, describe under SPECIAL PROVISIONS below OTHER	1810048560	11/01/2003	11/01/2005	WC STATU-TORY LIMITS OTH-ER E.L. EACH ACCIDENT \$ 100,000 E.L. DISEASE - EA EMPLOYEE \$ 500,000 E.L. DISEASE - POLICY LIMIT \$ 100,000

DESCRIPTION OF OPERATIONS / LOCATIONS / VEHICLES; / EXCLUSIONS ADDED BY ENDORSEMENT / SPECIAL PROVISIONS

CERTIFICATE HOLDER

City Of Portland
 389 Congress St
 Portland, ME 04104

CANCELLATION

SHOULD ANY OF THE ABOVE DESCRIBED POLICIES BE CANCELLED BEFORE THE EXPIRATION DATE THEREOF, THE ISSUING INSURER WILL ENDEAVOR TO MAIL 10 DAYS WRITTEN NOTICE TO THE CERTIFICATE HOLDER NAMED TO THE LEFT, BUT FAILURE TO MAIL SUCH NOTICE SHALL IMPOSE NO OBLIGATION OR LIABILITY OF ANY KIND UPON THE INSURER, ITS AGENTS OR REPRESENTATIVES.

AUTHORIZED REPRESENTATIVE

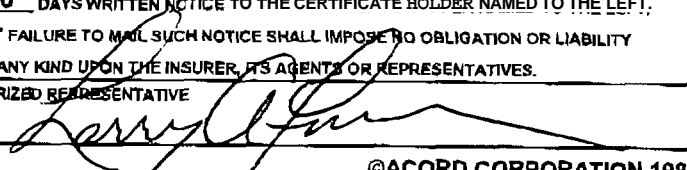

THIS IS NOT A PERMIT/CONSTRUCTION MAY NOT COMMENCE UNTIL THE PERMIT IS ISSUED

SIGNAGE APPLICATION

THIS IS NOT A PERMIT
CONSTRUCTION CANNOT NOT COMMENCE UNTIL THE PERMIT IS ISSUED

In the interest of processing your application in the quickest possible manner, please complete the Information below for Building or Use Permit.

If you or the property owner owes real estate or personal property taxes or user charges on any property within the City, payment arrangements must be made before permits of any kind are accepted.

Location/Address of Construction: 282 FORE STREET

Total Square Footage of Proposed Structure (7 signs: (1) 9.2 sq. FT. (1) 54.64 sq. FT. = 63.84 sq. FT. Square Footage of Lot 17,156 UPPER FLOORS

Tax Assessor's Chart, Block & Lot Number
Chart# Block# Lot#
Owner: OLVMA EQUITY INVESTORS
50 MONUMENT SQUARE
PORTLAND, ME 04101
Telephone #: 874-9992

Lessee/Buyer's Name (If Applicable) BANCOR SAVINGS BANK
Owner's/Purchaser/Lessee Address: BANCOR SAVINGS BANK
203 MAIN AVE
P.O. BOX 930
BANCOR, ME 04402
Total s.f of signs 63.84 x 2.00 \$ 127.68, plus \$30.00
TOTALS 157.68
192.68

Current use: COMMERCIAL Proposed use: COMMERCIAL
INSTALL (1) RETAIL SIGN AND (1) UPPER FLOOR SIGN

Project description: INDIVIDUAL LIGHTED LETTER SIGNS:
RETAIL SIGN IS REVERSE CHANNEL, UPPER FLOOR SIGN HAS
FACE LIT LETTERS.

Applicants Name, Address & Telephone: PAUL LESSARD 782-9654
NEOKRAFT SIGNS
486 MAIN ST.
LEWISTON, ME 04240

Contractor's Name, Address & Telephone: SAME

Who shall we contact when the permit is ready: PAUL LESSARD @ NEOKRAFT SIGNS
Telephone: 782-9654

If you would like it mailed, what mailing address should we use NEOKRAFT SIGNS
486 MAIN ST.
LEWISTON, ME 04240