

NOTE:

1. SEE SHEET E-001 FOR LEGEND AND GENERAL NOTES.

KEYED NOTES:

- ① MOUNT RECEPTABLE 42" AFF TO CENTER OF DEVICE
- ② PROVIDE POWER AND DISCONNECT FOR INSTANTANEOUS ELECTRIC HOT WATER HEATER MOUNTED UNDER SINK.

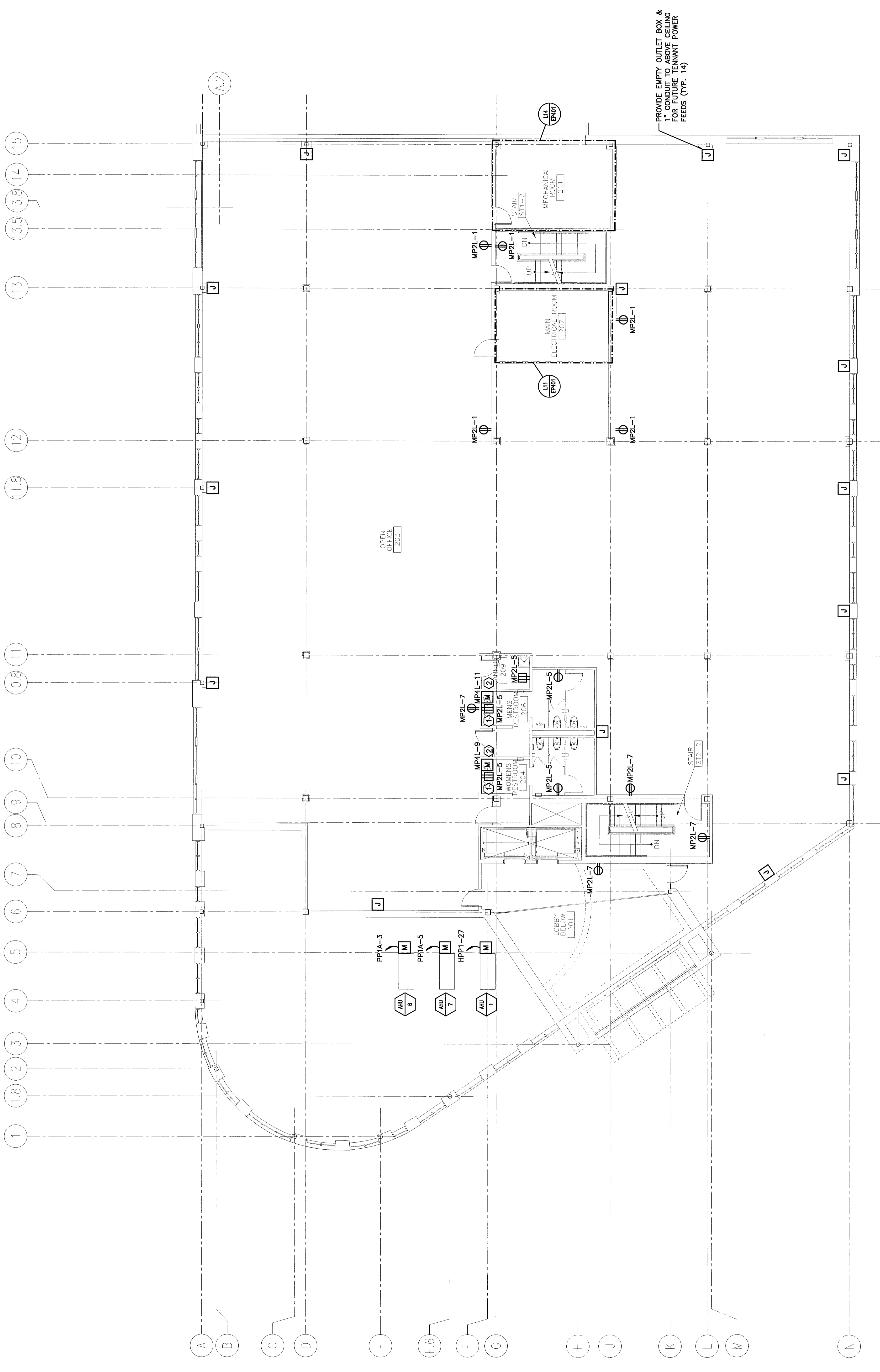

PROVIDE EMPTY OUTLET BOX &
 1" CONDUIT TO ABOVE CEILING
 FOR FUTURE TENANT POWER
 FEEDS (TYP. 14)

REV.	ISSUED FOR CONSTRUCTION	DESCRIPTION	DATE
0			12-15-03

ISSUED FOR CONSTRUCTION
12-15-03

CURRENT ISSUE STATUS:

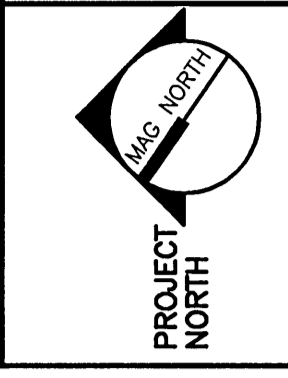

144 Fore Street, P.O. Box 618
 Portland, Maine 04104
 Tel: (603) 772-3896
 Fax: (603) 772-1090

**FORE STREET
 OFFICE BUILDING**
 PORTLAND, MAINE

**SECOND FLOOR
 POWER PLAN**

SHEET TITLE:	1/8"=1'-0"	DATE:	12-15-03
SCALE:		GRAPHIC SCALE:	0' 1'
PROJECT MANAGER:	JLJ	R/L/LAM	
JOB CAP/DRAWN:			
A/E OF RECORD:	DJT		
SMART CAD FILE:	EP102-03087	SHEET No.	EP102
PROJECT No.:	03087		

A1 SECOND FLOOR PLAN

1/8"=1'-0"