

**NOTE:**

1. SEE SHEET E-001 FOR LEGEND AND GENERAL NOTES.

**KEYED NOTE:**

- ① MOUNT RECEPTACLE 42" AFF TO BOTTOM OF DEVICE.
- ② FURNISH AND INSTALL A WALKER POKE THROUGH STYLE FLOOR BOX WITH DUPLEX RECEPTACLE AND PROVISIONS FOR VOICE/DATA WIRING.
- ③ NOT USED
- ④ COORDINATE WITH CASEWORK INSTALLER FOR MOUNTING OF RECEPTACLES. COORDINATE WITH OWNER AS TO WHETHER RECEPTACLES ARE TO BE INSTALLED INSIDE OR ABOVE CASEWORK.
- ⑤ COORDINATE WITH TENANT FOR NEMA CONFIGURATION OF RECEPTACLE REQUIRED FOR RANGE. WIRING TO BE 3 #8 AWG & #10 GND.
- ⑥ NOT USED
- ⑦ NOT USED
- ⑧ PROVIDE HARDWIRED ELECTRICAL CONNECTION FOR OWNER SUPPLIED DISHWASHER.

**ESB**  
**E.S. BOULOS CO**  
 ELECTRICAL CONTRACTORS

45 BRADLEY DRIVE  
 WESTBROOK, ME 04092  
 TEL: (207) 464-3706  
 FAX: (207) 464-1833

**SM**  
**RT**

ARCHITECTURE ENGINEERING PLANNING  
 SMART  
 144 Fore Street/P.O. Box 618  
 Portland, Maine 04104  
 tel. (207) 772-3846  
 fax. (207) 772-1070

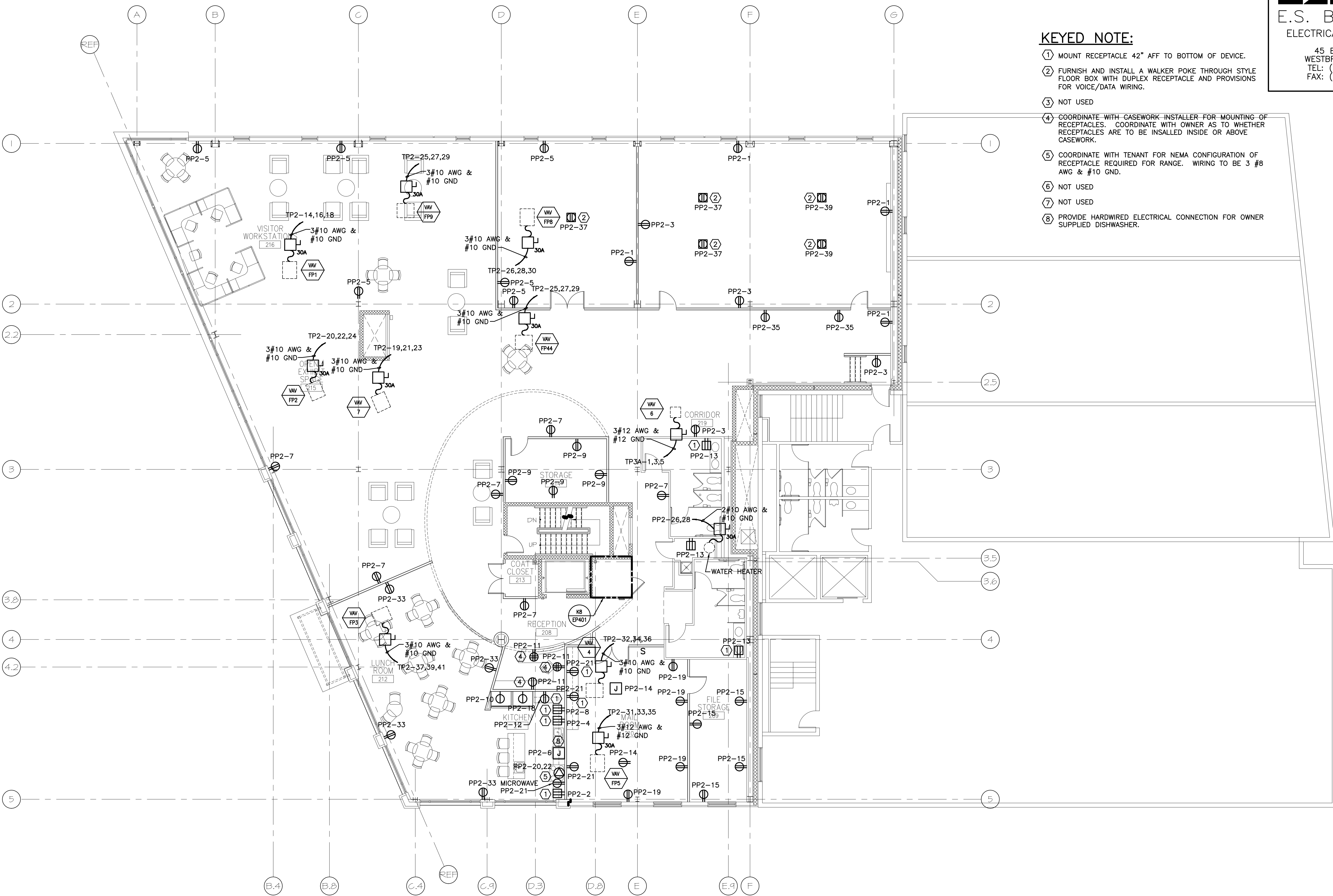

CUSTOM HOUSE SQUARE  
 FORE STREET  
 PORTLAND, MAINE

RECORD DRAWINGS  
 9-19-07

REV	DESCRIPTION	DATE
3	RECORD DRAWINGS	9-19-07
2	REVISED	5-23-07
1	ISSUED FOR REVISION	3-5-07
0	ISSUED FOR CONSTRUCTION	12-20-06

GRAPHIC SCALE:  
 0" 1"

SCALE: AS NOTED

PROJECT MANAGER: DJT  
 JC/DRAWN BY: CDS  
 A/E OF RECORD: DJT  
 CAD FILE: EP103-06068  
 PROJECT NO: 06068  
 DATE: 12-20-06

SHEET TITLE:  
 SECOND FLOOR  
 POWER PLAN

A1 SECOND FLOOR PLAN

1/8"=1'-0"