

**NOTE:**

1. SEE SHEET E-001 FOR LEGEND AND GENERAL NOTES.

**KEYED NOTE:**

- ① MOUNT RECEPTACLE 42" AFF TO BOTTOM OF DEVICE.
- ② SPLIT SYSTEM INDOOR UNIT TO BE FED FROM SAME CIRCUIT AS ROOF MOUNTED CONDENSING UNIT. PROVIDE INTERCONNECTING WIRING BETWEEN INDOOR AND OUTDOOR UNIT AS REQUIRED.



**E.S. BOULOS CO**  
ELECTRICAL CONTRACTORS

45 BRADLEY DRIVE  
WESTBROOK, ME 04092  
TEL: (207) 464-3706  
FAX: (207) 464-1833



ARCHITECTURE ENGINEERING PLANNING  
SMART  
144 Fore Street/P.O. Box 618  
Portland, Maine 04104  
tel. (207) 775-3846  
fax. (207) 775-1070

PROJECT TITLE:  
**CUSTOM HOUSE SQUARE  
FORE STREET**  
PORTLAND, MAINE

CURRENT ISSUE STATUS:  
**RECORD DRAWINGS  
9-19-07**

REV	DESCRIPTION	DATE
2	RECORD DRAWINGS	9-19-07
1	ISSUED FOR REVISION	3-5-07
0	ISSUED FOR CONSTRUCTION	12-20-06

GRAPHIC SCALE:  
0" 1"

SCALE: AS NOTED  
PROJECT MANAGER: DJT  
JC/DRAWN BY: CDS  
A/E OF RECORD: DJT  
CAD FILE: EG101-06068  
PROJECT NO: 06068  
DATE: 12-20-06

SHEET TITLE:  
**GROUNDING PLAN**

SHEET No.  
**EG101**

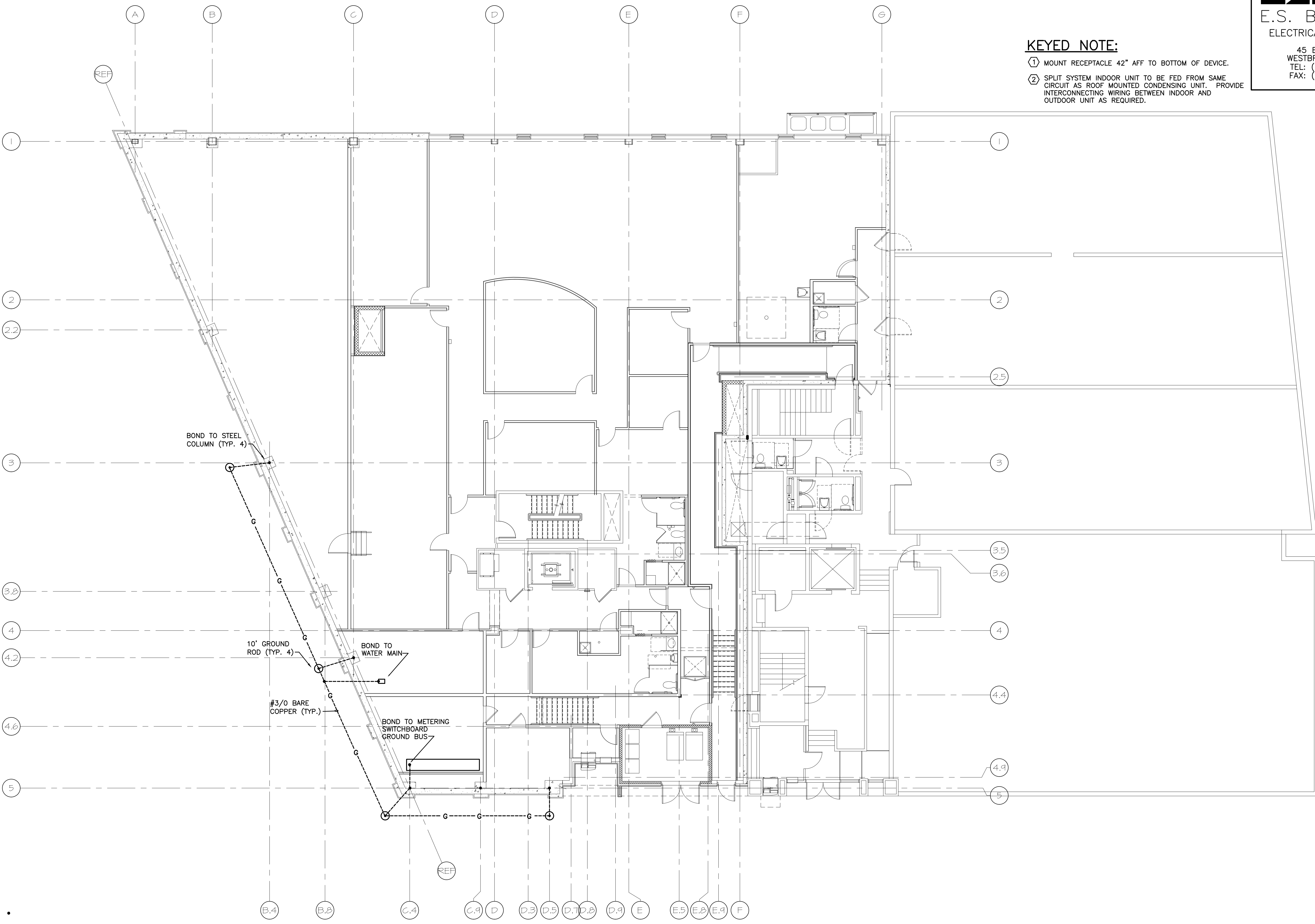

**A1 LOWER LEVEL PLAN**

1/8"=1'-0"