

# COLUMN SCHEDULE

COLUMN MARK	A-1	REF-4.5	C.4-5	C.7.5-5	C.9-5	C.6-5, C.6-4, C.6-3, C.6-2, C.6-1.3	D-5	D.5-5	E-4.9	E-5	B.6-5, E.6-4, E.6-3, E.6-2, E.6-1.3	Not Required Per #1	F-2.5	F-1	E.8-1 C.5-1	F.5-1	E-1	D-1	F.5-2	F.5-1	D.3-3.6, D.8-3.6	D-1.4 E-1.4
LEVEL																						
AVERAGE HEIGHT OF CURVED ROOF ELEV. 84'-6"																						
ROOF T.O. STEEL ELEV. = 78'-8"																						
10'-1 1/2"																						
FIFTH FLOOR ELEV. = 67'-10 1/2"																						
11'-0"																						
FOURTH FLOOR ELEV. = 56'-10 1/2"																						
11'-0"																						
THIRD FLOOR ELEV. = 45'-10 1/2"																						
11'-0"																						
SECOND FLOOR ELEV. = 34'-10 1/2"																						
12'-9"																						
FIRST FLOOR ELEV. = 22'-7 1/2"																						
10'-10 1/2"																						
BASEMENT FLOOR ELEV. = 11'-4" U.N.O. TOP OF PILE CAP = 11'-0" U.N.O.																						
BASE PLATE SIZE	14x16x1		14x20x1		14x16x1		14x16x1	16x16x1.5	13x16x1.5	13x16x1.5	13x16x1.5		14x14x1.5	16x16x1.5							12x12x1	
BASE PLATE DETAIL	1/S1.5		14/S1.5		2/S1.5		2/S1.5	3/S1.5	3/S1.5	3/S1.5	3/S1.5		8/S1.5	3/S1.5							13/S1.5	13/S1.5
BASE PLATE/ANCHOR BOLT	B/A	B-1, A-1	B-1, A-1		B-1, A-1		B-1, A-1	B-1, A-1	B-1, A-1	B-1, A-1	B-1, A-1		B-1, A-1	B-1, A-1							B-1, A-1	
PLAN CONFIGURATION																						

- COLUMN SCHEDULE NOTES:**
- COLUMNS SHOWN ON THE MOMENT FRAME ELEVATIONS ARE NOT SHOWN IN THIS SCHEDULE. SEE DRAWINGS 54.2, 54.3, AND 54.4.
  - COLUMN SPLICE LOCATIONS ARE SUGGESTED ONLY. FABRICATOR SHALL PROVIDE LONGEST MEMBERS POSSIBLE TO MINIMIZE SPLICES.
  - COLUMNS NOT SHOWN:
    - 5.5x3/8 HSS AT ENTRY AREAS
    - BASE PLATE
    - F-4.4 HS 12x12x1
    - D.9 - 4.4 HS 12x12x1
    - D.7 - 4.6 HS 12x12x3/4
    - D.7 - 4.9 12x12x3/4

**PRO CON**  
INCORPORATED  
Design and Construction Management  
ARCHITECTURE  
A Seabrook Company  
1000 Main Street, Suite 101  
Portland, ME 04101  
Tel: 603.883.8111 Fax: 603.883.2720

ISSUE: 05/26/06 - ISSUED FOR PRICING

**CUSTOM HOUSE SQUARE**  
300 FORE STREET  
PORTLAND, MAINE  
COLUMN SCHEDULE AND MOMENT FRAME ELEVATIONS

← ALL BASE PLATE/ANCHOR DESIGNATIONS PER PER #2

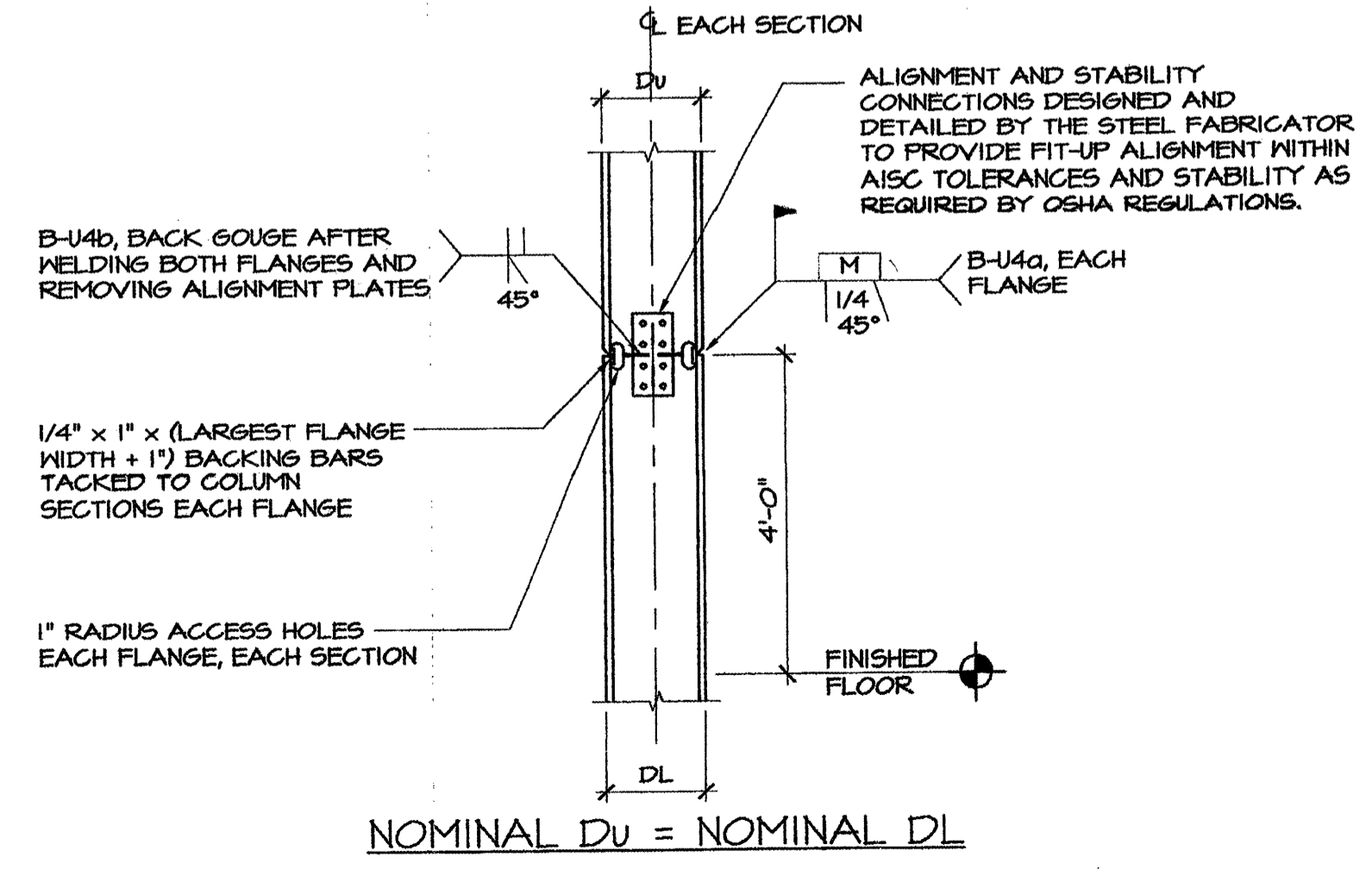
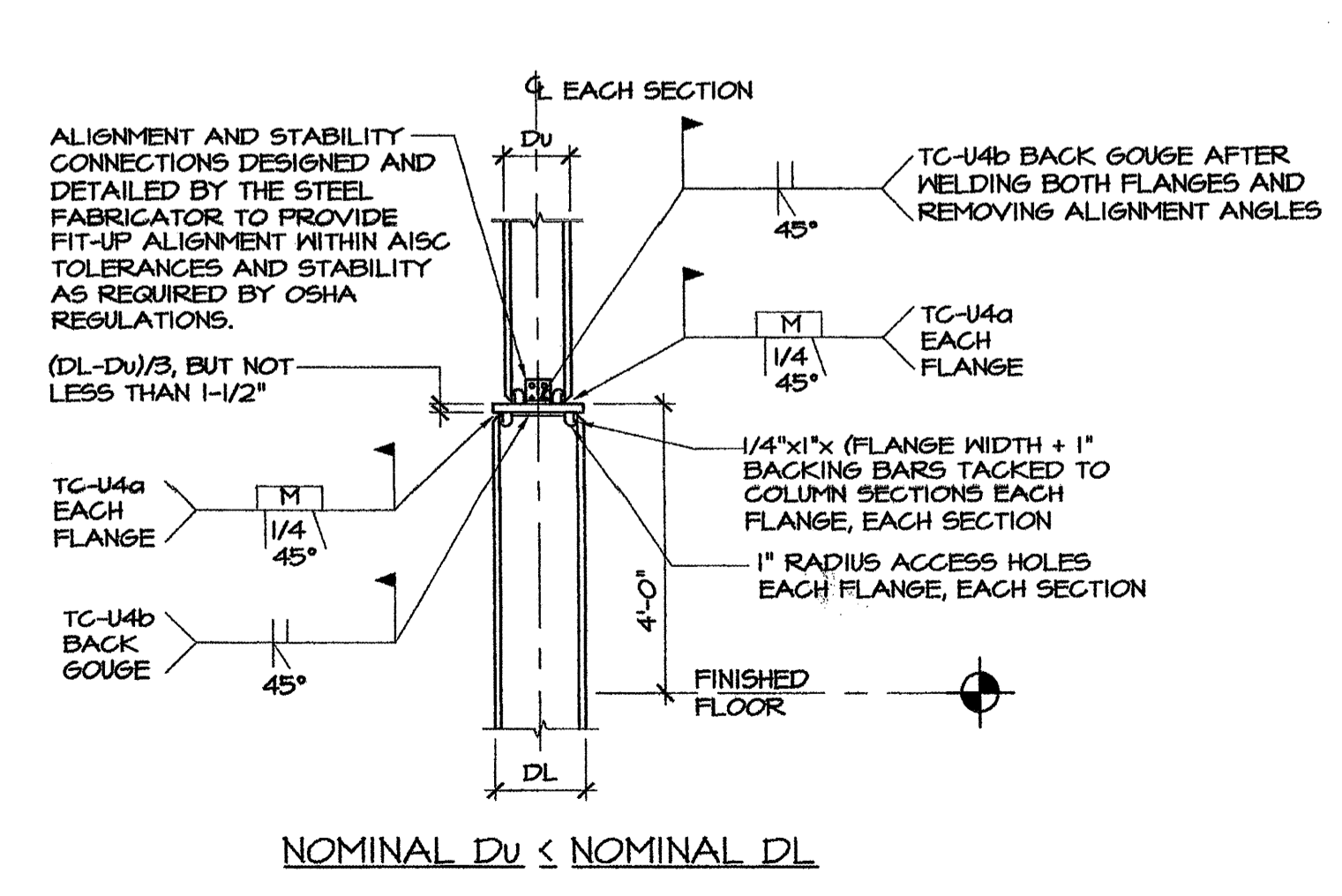

- COLUMN SPLICE NOTES:**
- THE STEEL ERECTOR SHALL NOTE WELL THAT IF THE ALIGNMENT AND STABILITY CONNECTIONS PROVIDED DO NOT PROVIDE SUFFICIENT LATERAL STABILITY TO ALLOW THE COLUMN TO CANTILEVER ABOVE THE SPLICE AS REQUIRED BY OSHA REGULATIONS, THEN THE STEEL ERECTOR SHALL DESIGN AND INSTALL SUFFICIENT TEMPORARY BRACING AND GUYING TO SUPPORT ALL DEAD, LIVE, AND CONSTRUCTION LOADS AND ECCENTRICITIES PRIOR TO SLACKING THE HOIST LINE.
  - THE STEEL ERECTOR SHALL NOTE WELL THAT THE ALIGNMENT AND STABILITY CONNECTIONS PROVIDED MAY NOT PROVIDE SUFFICIENT STRENGTH AS A LIFTING MECHANISM. THEREFORE, THE STEEL ERECTOR SHALL DESIGN AND INSTALL (OR MODIFY THE ALIGNMENT AND STABILITY CONNECTIONS PROVIDED) SUFFICIENT CONNECTIONS FOR HOISTING AND POSITIONING THE COLUMN SECTIONS.
  - NO SHOP PRIMER WITHIN 3 INCHES OF FIELD WELDS. REMOVE SHOP PRIMER (INCLUDING OVER-SPRAY) IN THE FIELD PRIOR TO WELDING.

**NOT FOR CONSTRUCTION**  
05/26/06

PROJECT ARCHITECT: MW  
DRAWN BY: ET, AC, SO  
PROJECT #: 300506

**S4.1**