

sonell - Fri, 14 Jul 2006 - 4:00pm

COLUMN SCHEDULE

COLUMN MARK	A - 1	REF - 4.5	C.4 - 5	C.7.5 - 5	C.9 - 5	C.6 - 5, C.6 - 4, C.6 - 3, C.6 - 2, C.6 - 1.3	D - 5	D.5 - 5	E - 4.9	E - 5	E.6 - 5, E.6 - 4, E.6 - 3, E.6 - 2, E.6 - 1.3	F - 2.5	F - 1	E.8 - 1, C.5 - 1	F.5 - 1	E - 1	D - 1	F.5 - 2	F.5 - 1	D.3 - 3.6, D.8 - 3.6	D - 1.4, E - 1.4
LEVEL																					
AVERAGE HEIGHT OF CURVED ROOF ELEV. = 84'-6"																					
5'-10"																					
ROOF T.O. STEEL ELEV. = 78'-8"																					
10'-1 1/2"																					
FIFTH FLOOR ELEV. = 67'-10 1/2"																					
11'-0"																					
FOURTH FLOOR ELEV. = 56'-10 1/2"																					
11'-0"																					
THIRD FLOOR ELEV. = 45'-10 1/2"																					
11'-0"																					
SECOND FLOOR ELEV. = 34'-10 1/2"																					
12'-3"																					
FIRST FLOOR ELEV. = 22'-7 1/2"																					
10'-10 1/2"																					
TOP OF PIER ELEV. = 20'-0" UNLESS NOTED OTHERWISE																					
BASEMENT FLOOR ELEV. = 11'-4" U.N.O. TOP OF PILE CAP = 11'-0" U.N.O.																					
BASE PLATE SIZE	14x16x1		14x20x1	14x16x1			14x16x1	16x16x1.5				14x14x1.5	16x16x1.5							12x12x1	
BASE PLATE DETAIL	1/S1.5		14/S1.5	2/S1.5			2/S1.5	3/S1.5	13/S1.5	13/S1.5		8/S1.5	3/S1.5							13/S1.5	13/S1.5
BASE PLATE/ANCHOR BOLT	B/A																				
PLAN CONFIGURATION																					

COLUMN SCHEDULE NOTES:

- COLUMNS SHOWN ON THE MOMENT FRAME ELEVATIONS ARE NOT SHOWN IN THIS SCHEDULE. SEE DRAWINGS 54.2, 54.3, AND 54.4.
- COLUMN SPlice LOCATIONS ARE SUGGESTED ONLY. FABRICATOR SHALL PROVIDE LONGEST MEMBERS POSSIBLE TO MINIMIZE SPLICES.
- COLUMNS NOT SHOWN:
 5x5x3/8 HSS AT ENTRY AREAS
 BASE PLATE
 F-4.4 HS 12x12x1
 D.9 - 4.4 HS 12x12x1
 D.7 - 4.6 HS 12x12x3/4
 D.7 - 4.9 12x12x3/4

PRO CON INCORPORATED
 Design and Construction Management
 ARCHITECTURE
 A. Shaban Company
 1000 Main Street, Suite 101
 Portland, ME 04108
 603.623.8811 Fax 603.623.2750

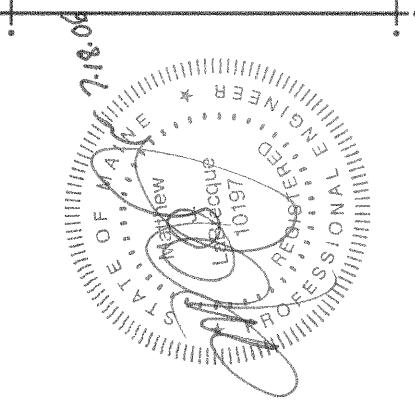

ISSUE
 05/26/2006 - ISSUED FOR PRICING
 07/11/2006 - ISSUED FOR PERMIT

CUSTOM HOUSE SQUARE
 300 FORE STREET
 PORTLAND, MAINE
 COLUMN SCHEDULE AND MOMENT FRAME ELEVATIONS

PROJECT ARCHITECT: MW
 DRAWN BY: ET, AC, SO
 PROJECT #: 300506

S4.1

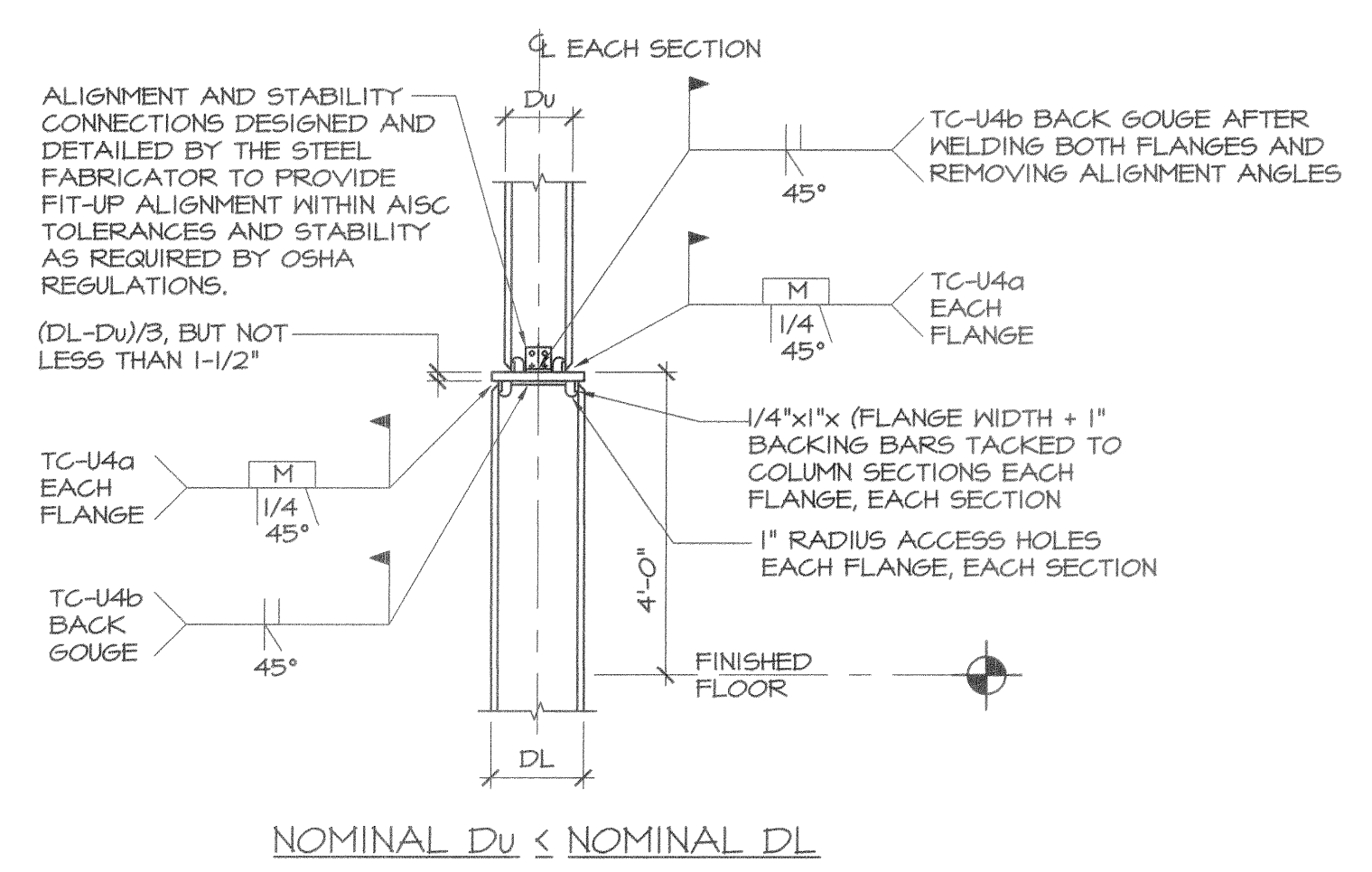

W8 TO W14 COLUMN SPLICE DETAIL
 NOT TO SCALE

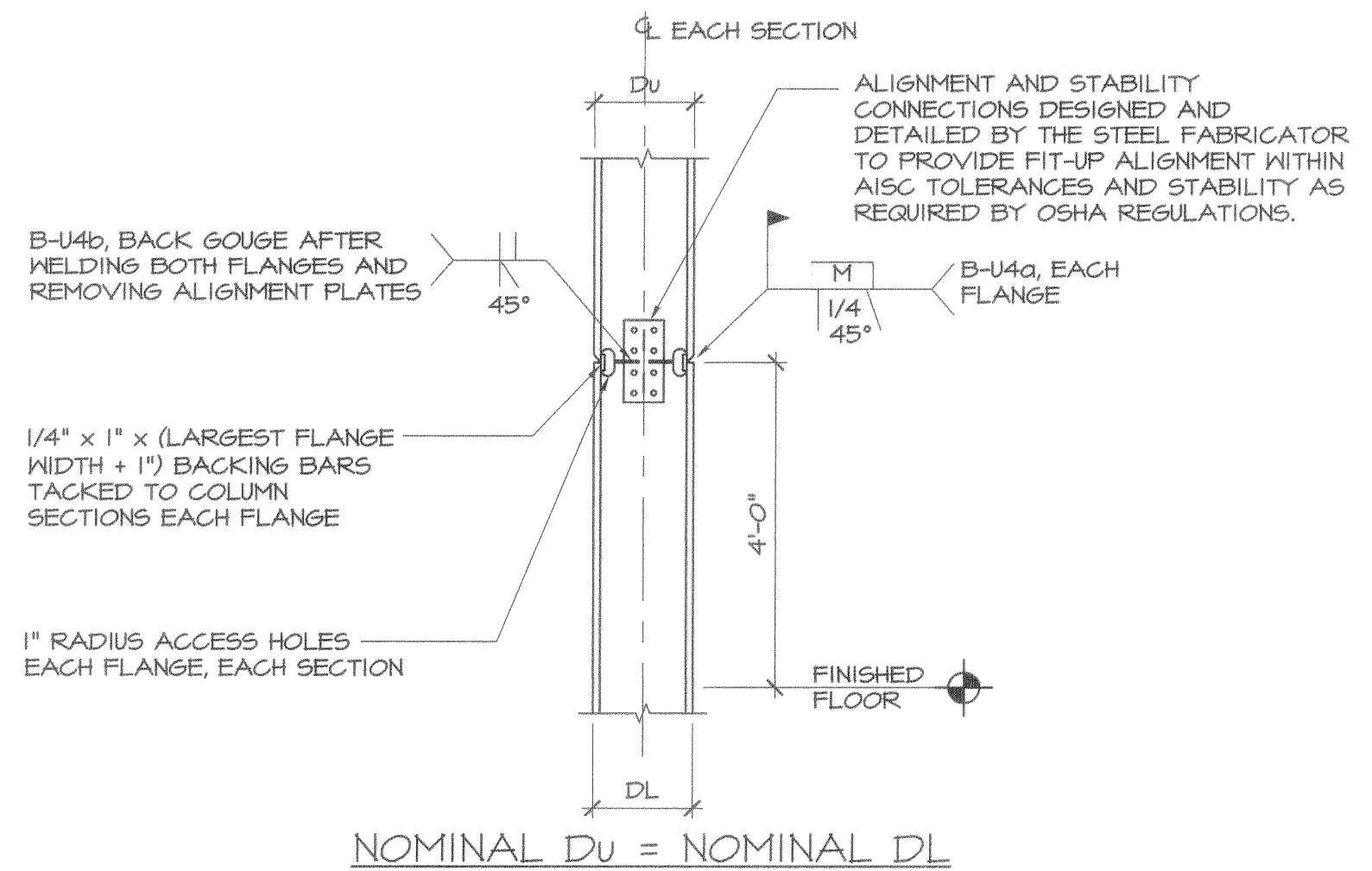

COLUMN SPLICE DETAIL
 NOT TO SCALE

COLUMN SPLICE NOTES:

- THE STEEL ERECTOR SHALL NOTE WELL THAT IF THE ALIGNMENT AND STABILITY CONNECTIONS PROVIDED DO NOT PROVIDE SUFFICIENT LATERAL STABILITY TO ALLOW THE COLUMN TO CANTILEVER ABOVE THE SPLICE AS REQUIRED BY OSHA REGULATIONS, THEN THE STEEL ERECTOR SHALL DESIGN AND INSTALL SUFFICIENT TEMPORARY BRACING AND GUYING TO SUPPORT ALL DEAD, LIVE, AND CONSTRUCTION LOADS AND ECCENTRICITIES PRIOR TO SLACKING THE HOIST LINE.
- THE STEEL ERECTOR SHALL NOTE WELL THAT THE ALIGNMENT AND STABILITY CONNECTIONS PROVIDED MAY NOT PROVIDE SUFFICIENT STRENGTH AS A LIFTING MECHANISM. THEREFORE, THE STEEL ERECTOR SHALL DESIGN AND INSTALL (OR MODIFY) THE ALIGNMENT AND STABILITY CONNECTIONS PROVIDED) SUFFICIENT CONNECTIONS FOR HOISTING AND POSITIONING THE COLUMN SECTIONS.
- NO SHOP PRIMER WITHIN 3 INCHES OF FIELD WELDS. REMOVE SHOP PRIMER (INCLUDING OVER-SPRAY) IN THE FIELD PRIOR TO WELDING.