

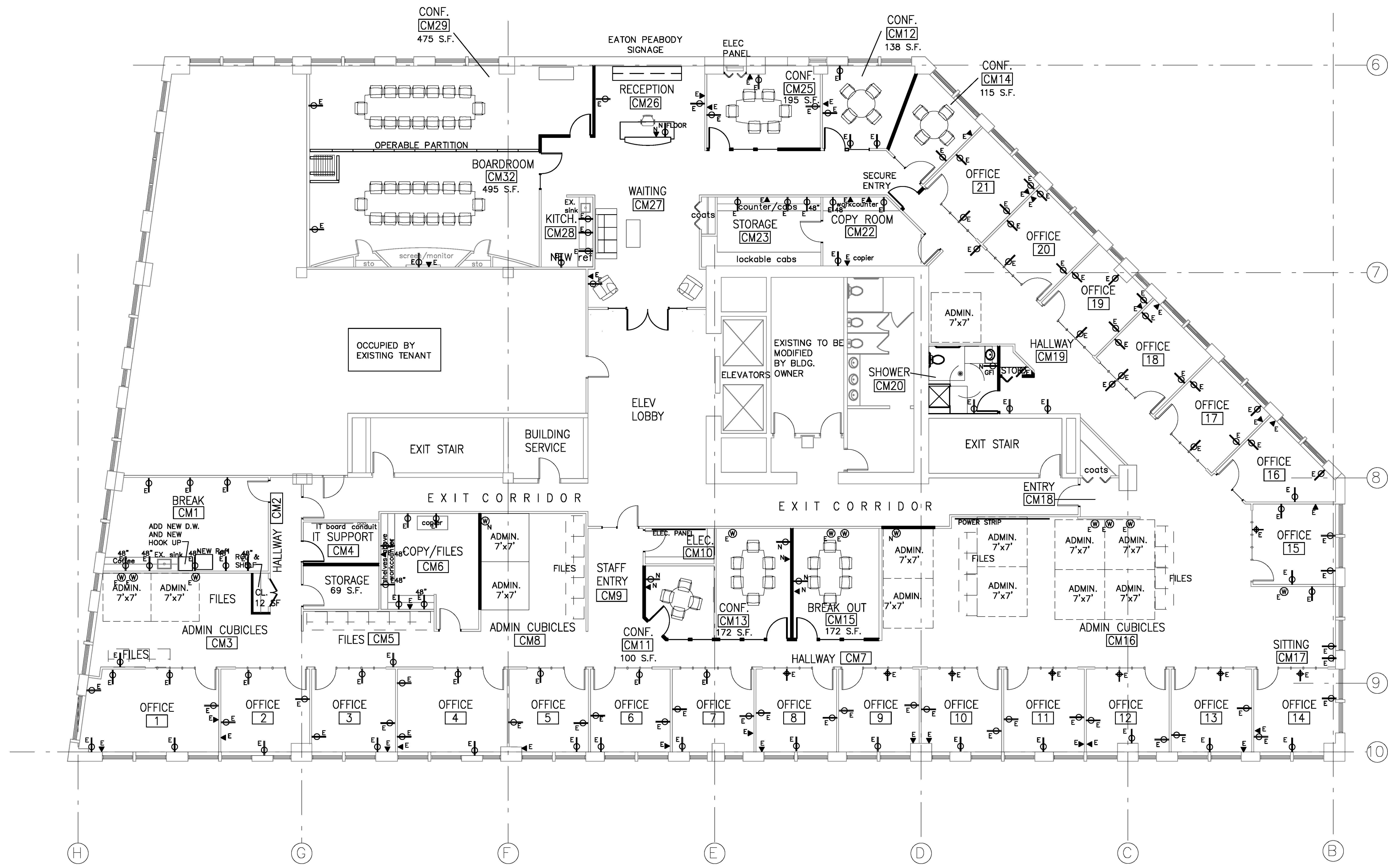

29 BLACK POINT ROAD
SCARBOROUGH, MAINE 04074
207-883-6307
WWW.GAWRONTURGEON.COM

**GAWRON
TURGEON**
ARCHITECTS, P.C.

EATON PEABODY
100 MIDDLE STREET
PORTLAND, MAINE



POWER PLAN LEGEND

- ▼ E EXISTING TEL/DATA OUTLET
- ⊕ E EXISTING DUPLEX OUTLET
- ⊕ E EXISTING QUAD OUTLET
- ⊕ N NEW DUPLEX OUTLET
- ⊕ D NEW DEDICATED DUPLEX OUTLET
- ⊕ WE ELECTRICAL WHIP CONNECTION
- N INDICATES NEW TO BE INSTALLED
- E INDICATES EXISTING - CONFIRM THAT EXISTING IS IN WORKING ORDER
- CAT6E

- NOTES:**
- ELECTRICAL CONTRACTOR SHALL COORDINATE TELEPHONE & DATA LOCATIONS WITH LOCATIONS OF OUTLETS.
 - G.C. TO COORDINATE ALL SPECIALTY EQUIPMENT WITH TENANTS VENDOR.
 - THE FINAL TERMINATION OF THE DATA AND TELEPHONE SYSTEMS SHALL BE THE RESPONSIBILITY OF THE TENANT. GENERAL CONTRACTOR TO INSTALL CAT.5e CABLE FOR THE DATA AND TELEPHONE SYSTEMS. PROVIDE 2 NETWORK DROPS PER OFFICE & WORKSTATION.
 - G.C. TO COORDINATE POWER TO TENANT SUPPLIED SYSTEM FURNITURE. POWER WILL BE HARDWIRE WHIP CONNECTIONS OR AS RECOMMENDED BY FURNITURE INSTALLER. TEL/DATA TO BE FED THROUGH SYSTEMS FURNITURE BASE.
 - PRIOR TO CATV & POWER INSTALLATIONS FOR T.V.'S CONSULT TENANT FOR MOUNTING HEIGHTS.

REVISIONS

#	DATE	DESCRIPTION

DATE:	11-29-16
PROJECT #:	080216
DRAWN BY:	DLP
CHECKED BY:	MET
DRAWING SCALE:	AS NOTED

SHEET TITLE
PROPOSED
SECOND FLOOR
POWER
PLAN
LEGEND

A201

AI SECOND FLOOR POWER PLAN
1/8"=1'-0"

A17 LEGEND
1/4"=1'-0"

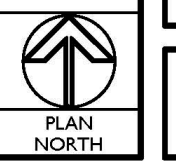

© COPYRIGHT 1985-2008
REPRODUCTION OR REUSE OF THIS
DOCUMENT WITHOUT WRITTEN
PERMISSION OF GAWRON TURGEON
ARCHITECTS & ENGINEERS