

SECTION **C** S3.1 1 1/2"=1'-0

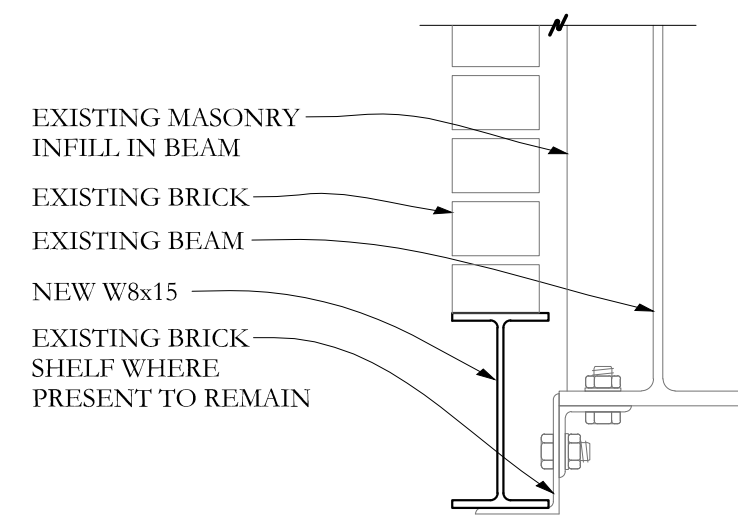

SECTION **D** S3.1 1 1/2"=1'-0

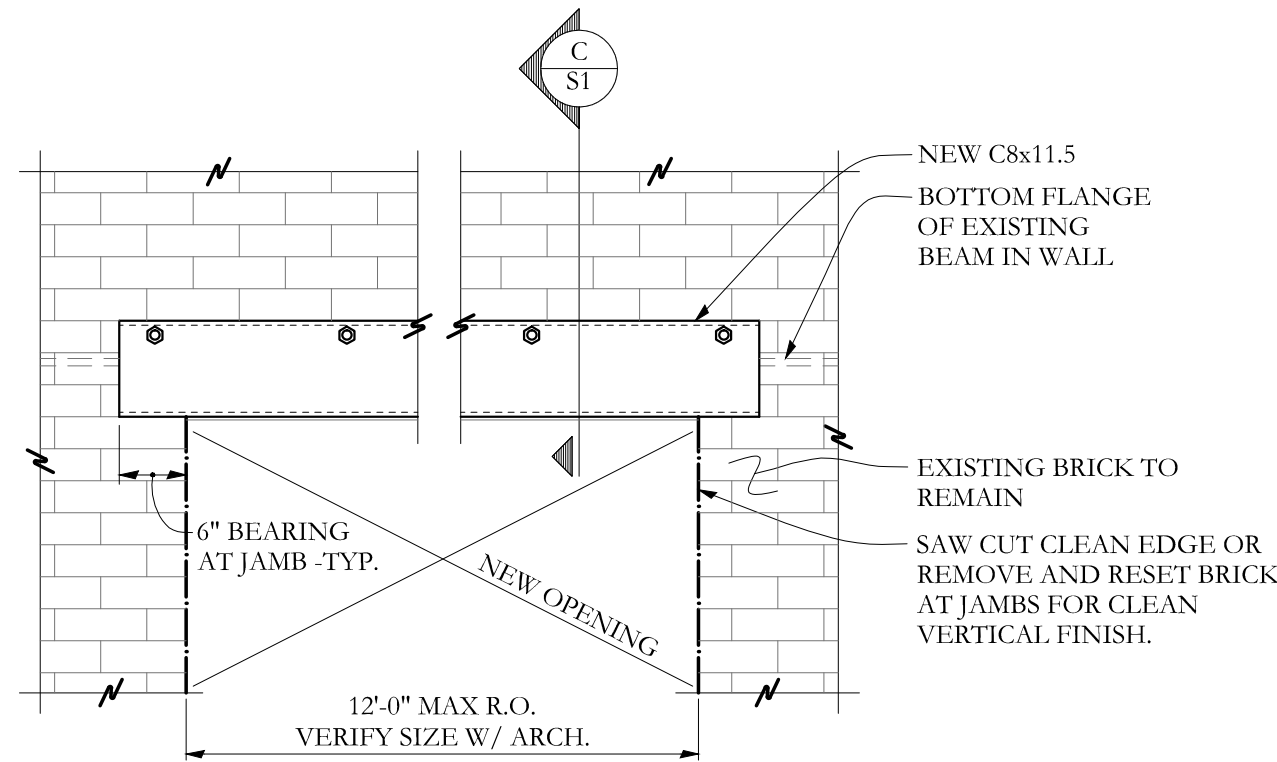

TYP. ELEVATION **A** S3.1 3/4"=1'-0

OPTION #1

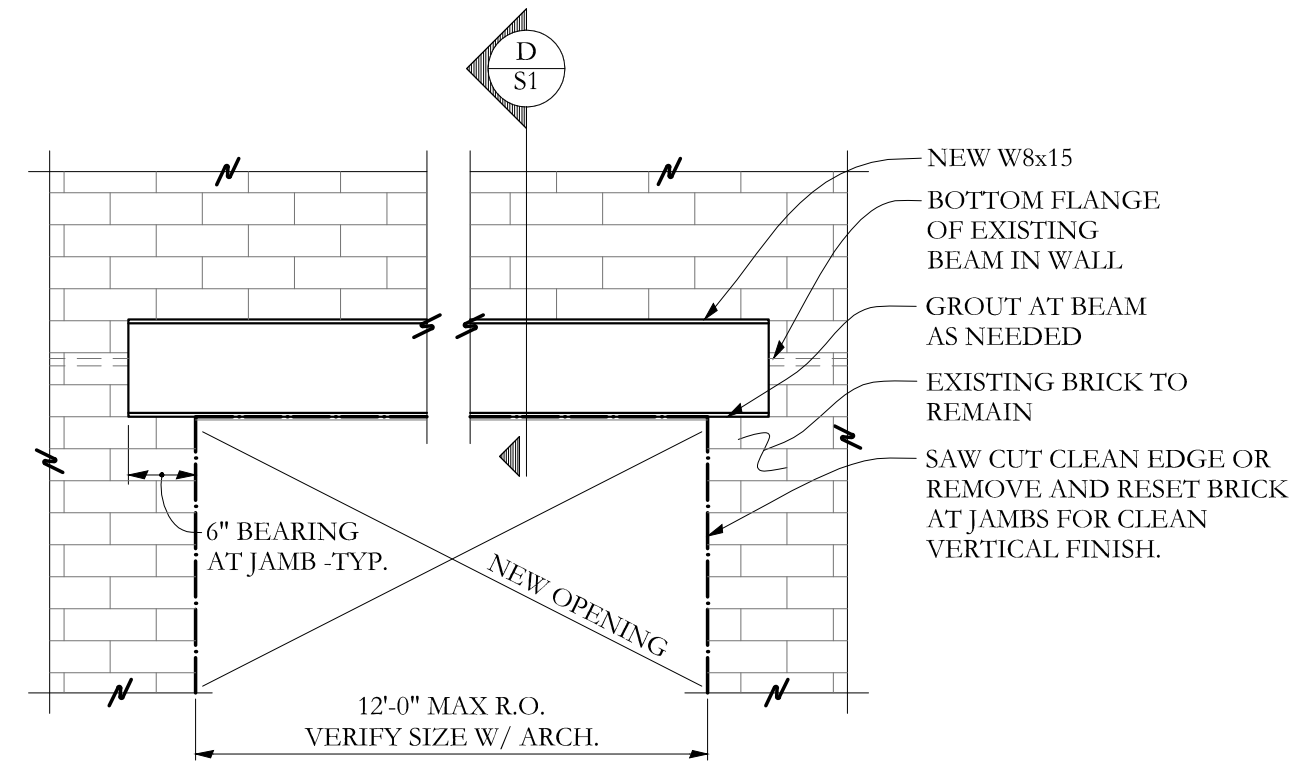

TYP. ELEVATION **B** S3.1 3/4"=1'-0

OPTION #2

ALL TEMPORARY SHORING BY G.C. -TYP.

SEE ARCH. PLAN A1.1 FOR OPENING LOCATIONS

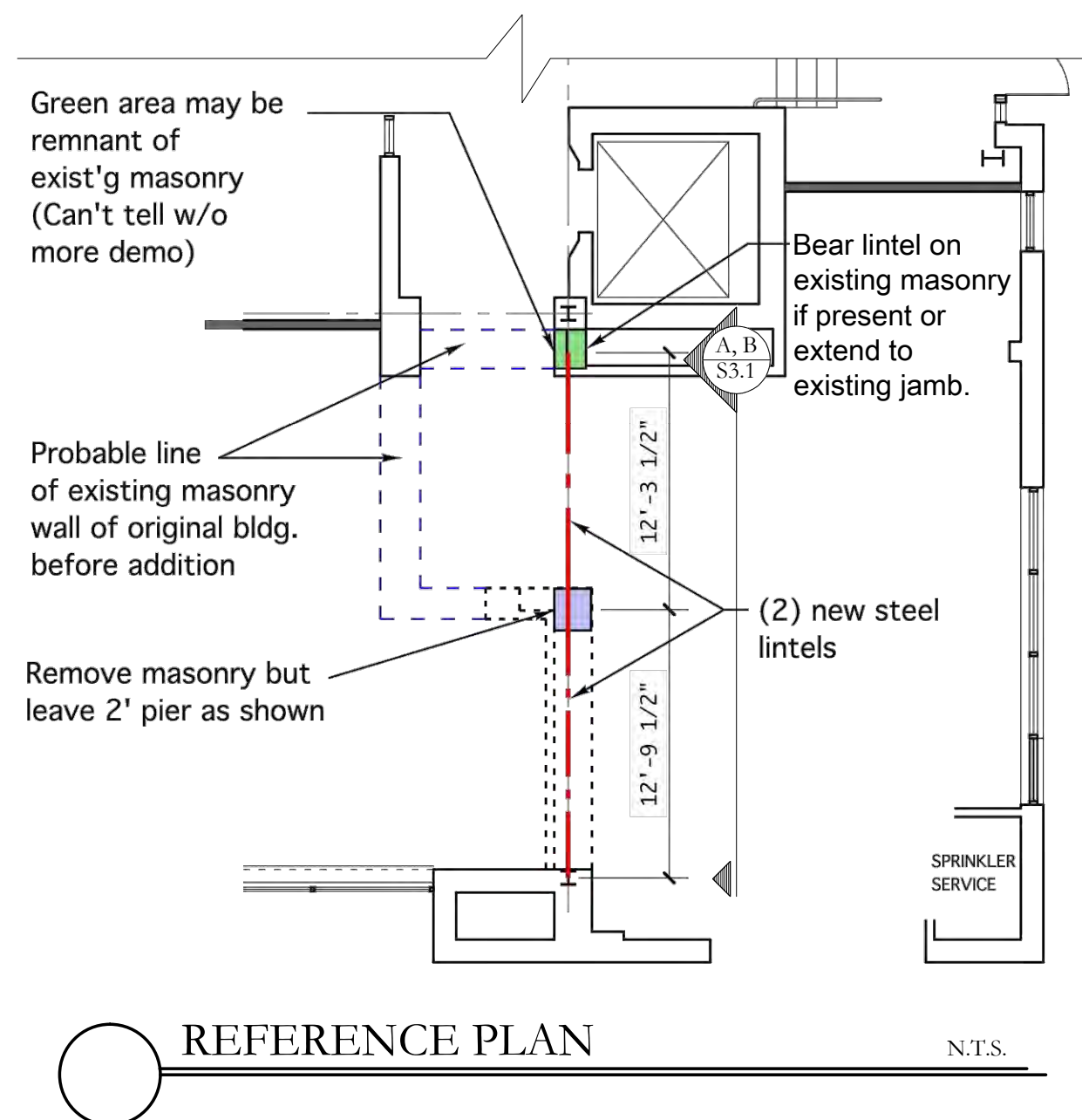

REFERENCE PLAN N.T.S.

FOR PRICING ONLY

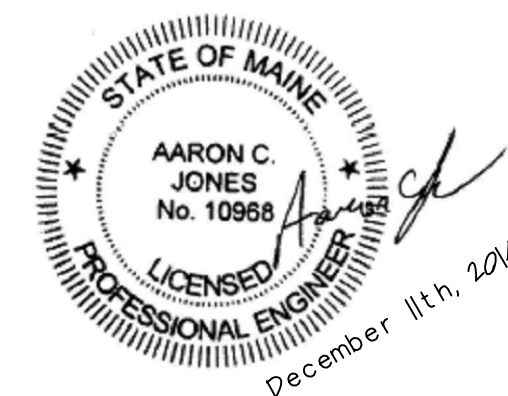

**Structural Integrity**  
Consulting Engineers, Inc.  
77 Oak Street  
Portland, ME, 04101  
p. 207-774-4614  
f. 866-793-7835  
www.structuralintegrity.com  
BUILD WITH CONFIDENCE  
© 2011 Structural Integrity Consulting Engineers, Inc.  
SIJOB# 14-0180

NORTHEAST BANK LINTELS  
PORTLAND, MAINE

Scale: AS NOTED

Date: 12/11/2014

Revisions

Sheet

S3.1