

KEYED NOTES:

- 1 FURNISH EXTERIOR CAST SURFACE BOX WITH LIQUID TIGHT CONDUIT FROM BOX TO CAMERA

NOTES:

- 1. SEE E0.0 FOR LEGEND, ABBREVIATIONS AND GENERAL NOTES.
- 2. BOXES AND CONDUITS BY DIVISION 26. WIRING AND DEVICES BY OWNERS SECURITY COMPANY.
- 3. GLASS BREAK MONITOR, CAMERAS, MOTION SENSORS: INSTALL DEVICE IN CEILING TILE(NO DIV. 26 WORK REQUIRED
- 4. PANIC BUTTONS: DIVISION 26 TO INSTALL 2"x4" BOX IN WALL WITH 1/2" EMT TO ABOVE ACCESSIBLE CEILING.
- 5. KEYPADS: DIVISION 26 TO INSTALL 2"x4" BOX IN WALL BESIDE DOOR. MOUNT 52" AFF.
- 6. SECURITY PANEL: FURNISH 120V POWER, FIRE ALARM MODULE FOR INTERFACE.

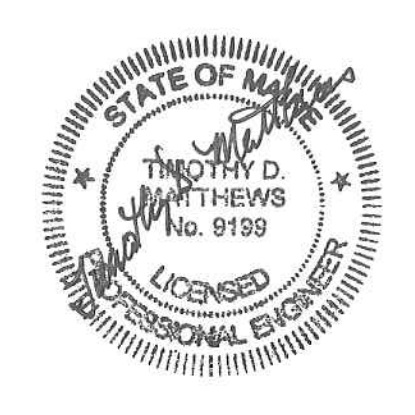

Branding / Bank Branch Interior Design:
THE ELEMENT GROUP

125 Brewery Lane
Suite #9
Portsmouth, NH 03801
T. 603.319.8951

Structural Engineering:
STRUCTURAL INTEGRITY ENGINEERS

77 Oak Street
Portland, ME 04101
T. 207.774.4614

HVAC & plumbing Engineering:
MECHANICAL SYSTEMS ENGINEERS

Royal River Center, Unit 10
10 Forest Falls Drive
Yarmouth, ME 04096
T. 207.846.1441

Electrical Engineering:
SWIFTCURRENT ENGINEERING

Royal River Center, Unit 4B
10 Forest Falls Drive
Yarmouth, ME 04096
T. 207.847.9280



Portland Branch
27 Pearl Street
1st Floor Tenant Space
Portland, Maine

ISSUED FOR REVIEW
NOT FOR CONSTRUCTION
January 30th, 2015

ELECTRICAL SECURITY PLAN

Scale: As Noted

E3.0

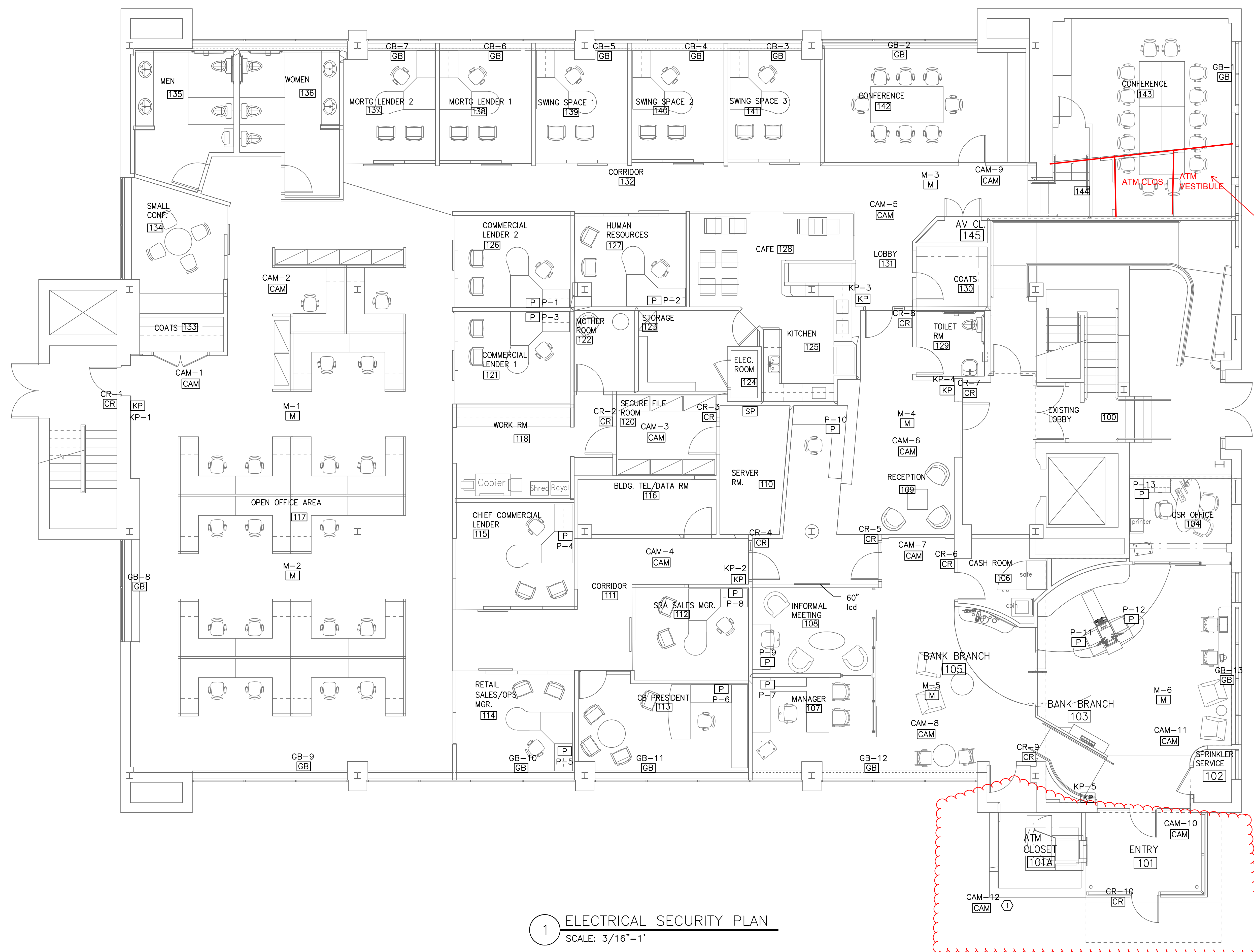

NEW ENTRY AND ATM CLOS. ADDITION TO BE DELETED. RELOCATE ALL ELECTRICAL COMPONENTS SHOWN TO NEW ATM VESTIBULE LOCATION

FINAL BID SET
FEBRUARY 4, 2015

1 ELECTRICAL SECURITY PLAN
SCALE: 3/16"=1'