

HARDWARE SPECIFICATIONS

HINGES:

Manufacturers/Products:

Provide 4 1/2" square cornered hinges by Stanley, Hager or McKinney. (3) Hinges per door at 7'-0" doors, (4) hinges at 8'-0" doors

EXIT DEVICES:

Manufacturers/Products:

- 1.) 'Olympian Series' by Precision Hardware
- 2.) '80 Series' by Sargent
- 3.) '98 Series' by Von Duprin
- 4.) Or Approved Equal

Notes:

Door pair 100.1.: Provide vertical rod exit device -labeled in accordance with NFPA 80.

CLOSERS:

Interior Surface Closers:

- 1.) '4040 Series' by LCN
- 2.) '281 Series' by Sargent
- 3.) Or Approved Equal

AUTOMATIC DOOR OPERATORS

Manufacturers/Products:

Surface Mounted at ATM Vestibule:

- 1.) Horton Automatics - 4100 LE Series - Surface
- 2.) Or Approved Equal

Concealed at Branch Entrance:

- 1.) Horton Automatics - 4800 Series - Side Access in 6"x6" Housing.
- 2.) Or Approved Equal

BORED LOCKS AND LATCHES:

Manufacturers/Products:

- 1.) Best Lock Corporation - 9K Series - 15 C Trim
- 2.) Corbin Russwin - CL3300 Series - Newport Trim
- 3.) Sargent - 10 L Line - L L Trim
- 4.) Schlage - D Series - 06 Trim
- 5.) Or Approved Equal

PUSH / PULLS:

Provide 6" x 16" Push Plates & 1" Dia. brushed chrome ADA compliant pulls - 10" center to center with 3 1/2" projection and 2 1/2" clearance at Men's Rm and Women's Rm Doors 135 & 136.

Provide 1" Dia. x 36" long stainless steel straight, square ended pull with offset mounting similar to RM3310 - MegaTek by Rockwood Manufacturing Co. at exterior side of Exterior Entrance Door 101

FINISH

Hardware finish to be brushed chrome at interior locations and stainless steel at exterior locations.

SECURITY/DOOR CONTROL

The Security System and card readers will be installed by tenant's security vendor. Coordinate electronic hardware components to assure a complete and operational system.

DOORS

Clear Finished wood doors to be plain sliced Cherry
Painted wood doors to be birch -paint grade

LOCK CYLINDERS / KEYING:

Manufacturers/Products:

Provide manufacturer's standard 6 pin tumbler type cylinders of same manufacturer as latches and locks.

Factory registered master key system . Provide 3 change keys, 5 master keys, and Key Control Cabinet.

Conduct keying conference with tenant and owner to determine keying requirements prior to installation.

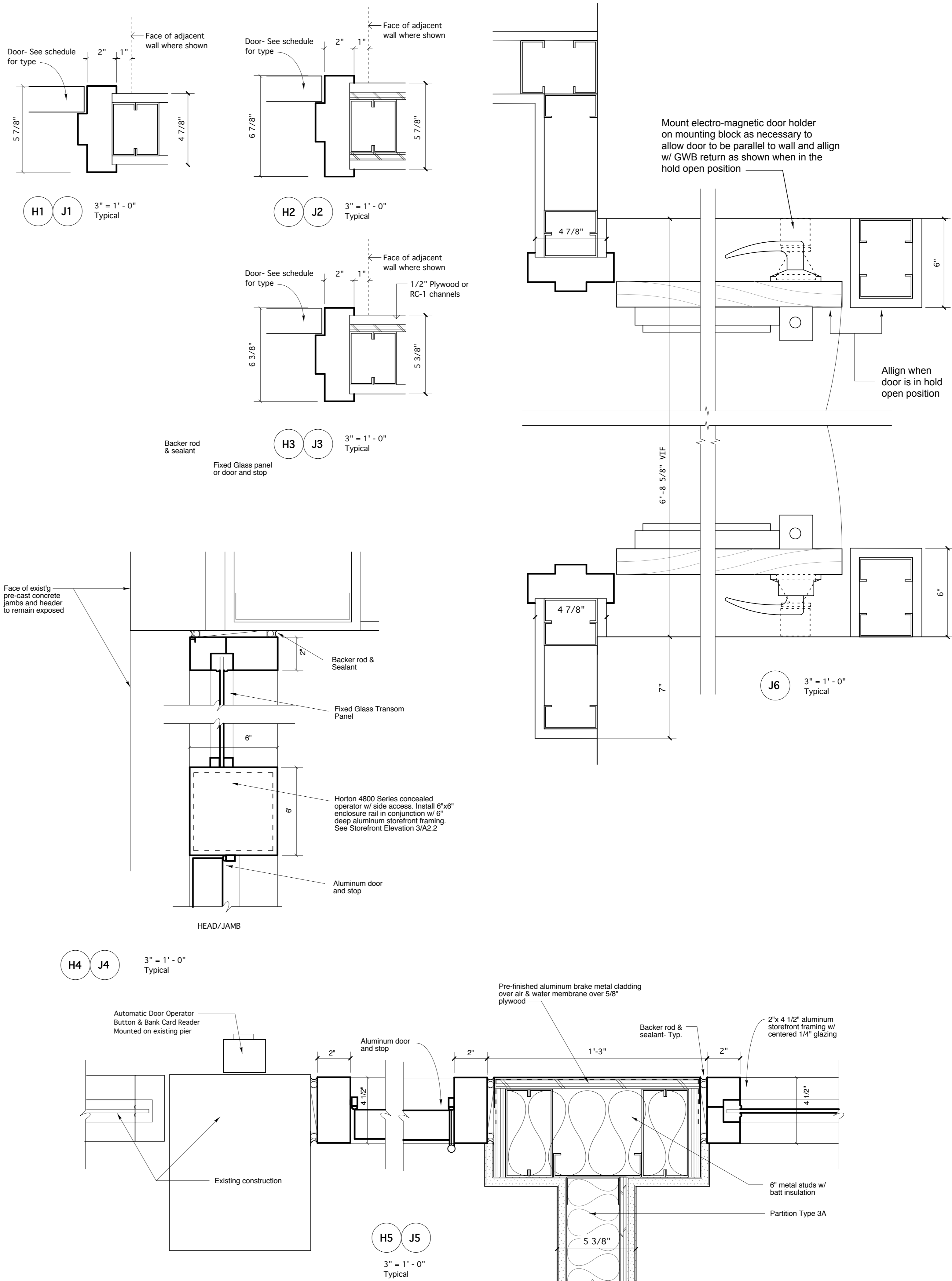

WSA
WINTON SCOTT ARCHITECTS
5 Milk Street
Portland, Maine 04101
207 774 4811
www.wintonscott.com

LICENSED ARCHITECT
STEPHEN W. WEATHERHEAD
No. 1948
STATE OF MAINE

Branding / Bank Branch Interior Design:
THE ELEMENT GROUP
125 Brewery Lane
Suite #9
Portsmouth, NH 03801
T. 603.319.8951

Structural Engineering:
STRUCTURAL INTEGRITY ENGINEERS
77 Oak Street
Portland, ME 04101
T. 207.774.4614

HVAC & plumbing Engineering:
MECHANICAL SYSTEMS ENGINEERS
Royal River Center, Unit 10
10 Forest Falls Drive
Yarmouth, ME 04096
T. 207.846.1441

Electrical Engineering:
SWIFT CURRENT ENGINEERING
Royal River Center, Unit 4B
10 Forest Falls Drive
Yarmouth, ME 04096
T. 207.847.9280

Northeast BANK

Portland Branch
27 Pearl Street
1st Floor Tenant Space
Portland, Maine

FINAL CONSTRUCTION SET
MARCH 4, 2015

DOOR DETAILS & HARDWARE SPECS
Scale: As Noted

A2.3