

Neokraft
SIGN S

Neokraft Signs Inc.
686 Main Street
Lewiston, Maine 04240
Telephone: 207.782.9654
Facsimile: 207.782.0009
1.800.339.2258
<http://www.neokraft.com>

Custom Sign Fabrication

These plans are the exclusive property of Neokraft Signs, Inc. and are the result of the original work of its employees. They are submitted to Neokraft's client for the sole purpose of consideration of whether to purchase these plans or to purchase from Neokraft a sign manufactured according to these plans.

Distribution or exhibition of these plans to anyone other than employees of said client, or use of these plans to construct a sign similar to the one embodied herein, is expressly forbidden. In the event that such exhibition or construction occurs, Neokraft expects to be reimbursed \$1500 in compensation for time and effort entailed in creating these plans.

Purdy Powers & Company
CL023339

Location: 130 Middle Street
Portland, ME
Drawing No.: 1 of 2
Drawn by: PL Rep.: PL
Date: 08.10.2015
Lead No.: CL023339
Gen Ref.:

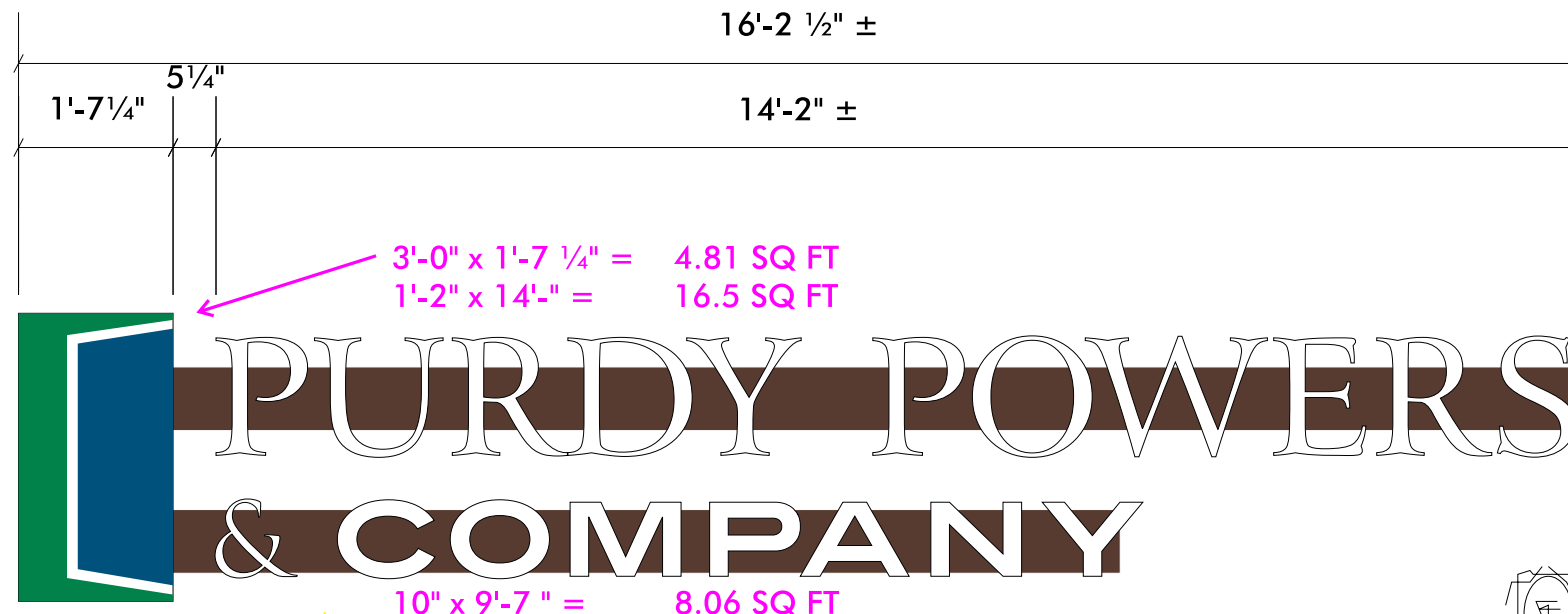

PROPOSED LIGHTED SIGN

SCALE: 1/2" = 1'-0"

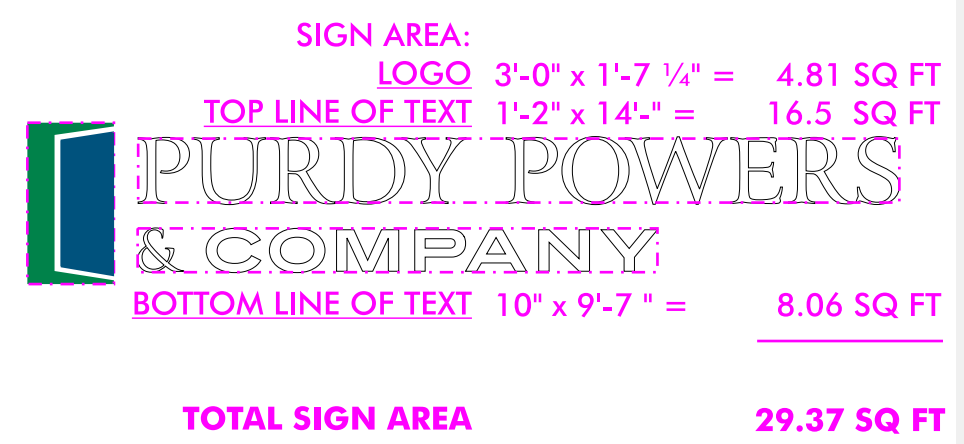
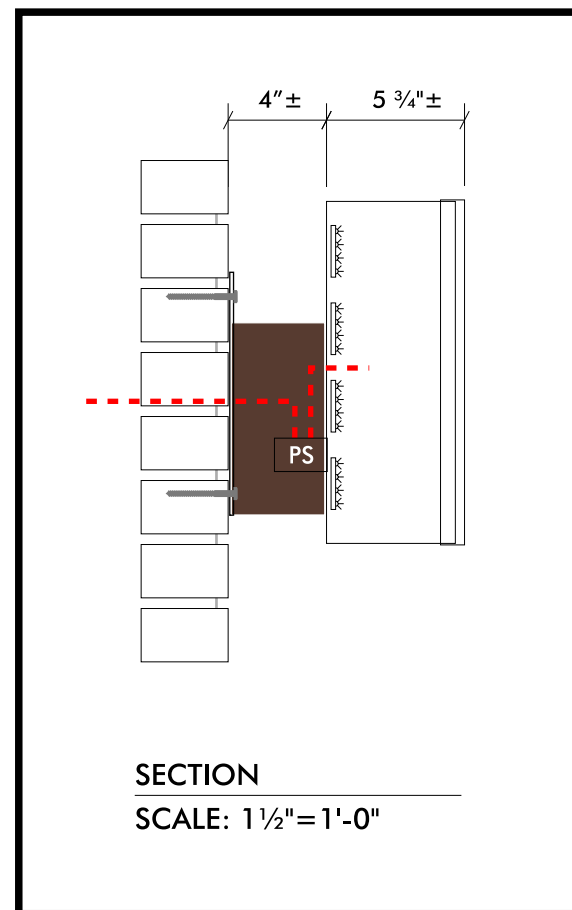

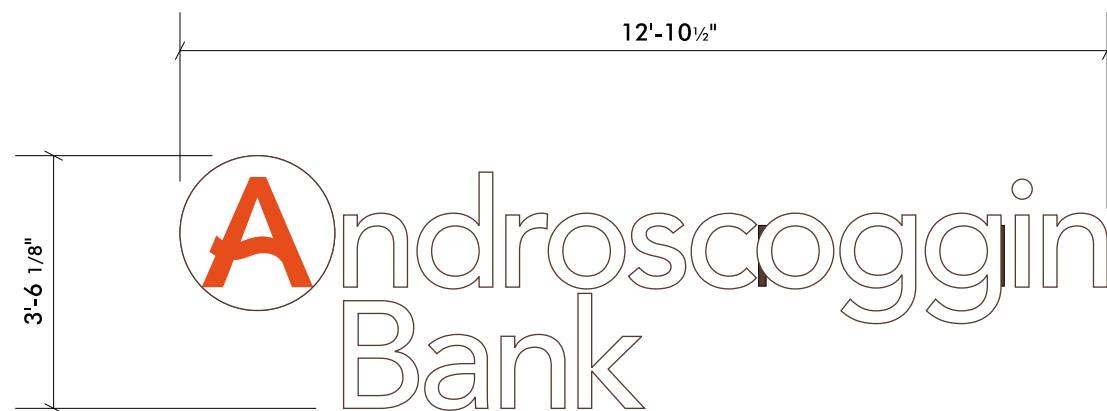
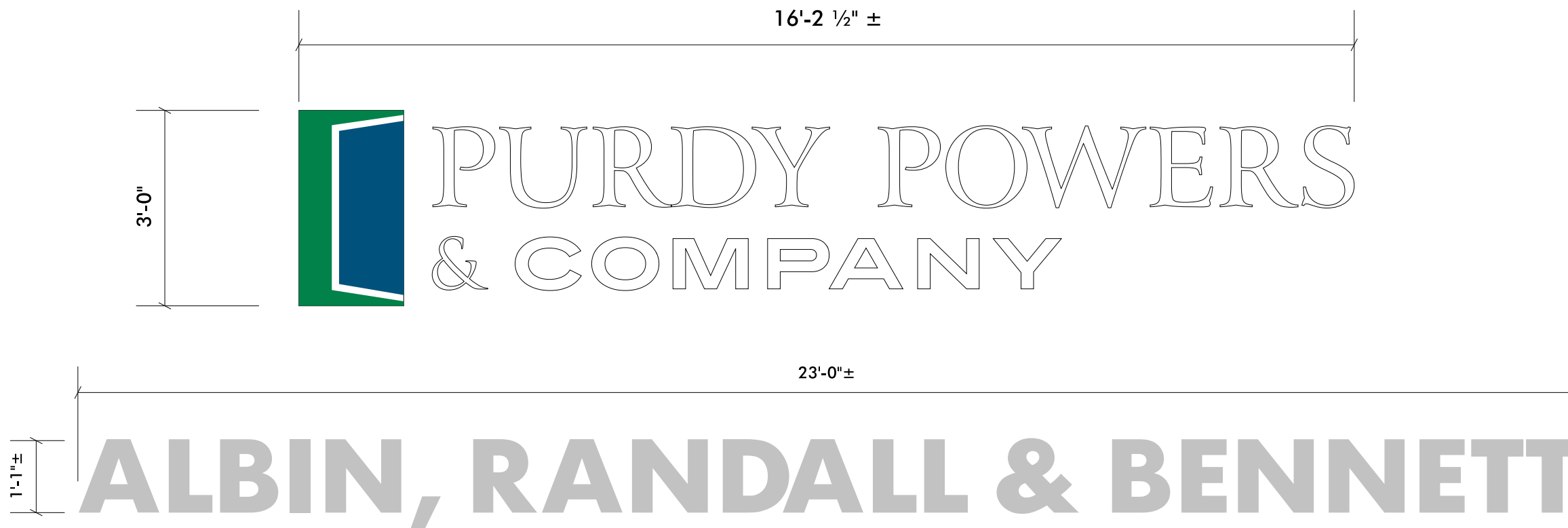

APPROXIMATE SIZES FOR
ALL NEW AND EXISTING SIGNS

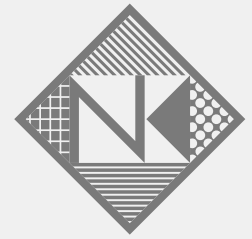

Neokraft
SIGN S

Neokraft Signs Inc.
686 Main Street
Lewiston, Maine 04240
Telephone: 207.782.9654
Facsimile: 207.782.0009
1.800.339.2258
<http://www.neokraft.com>

Custom Sign Fabrication

These plans are the exclusive property of Neokraft Signs, Inc. and are the result of the original work of its employees. They are submitted to Neokraft's client for the sole purpose of consideration of whether to purchase these plans or to purchase from Neokraft a sign manufactured according to these plans.

Distribution or exhibition of these plans to anyone other than employees of said client, or use of these plans to construct a sign similar to the one embodied herein, is expressly forbidden. In the event that such exhibition or construction occurs, Neokraft expects to be reimbursed \$1500 in compensation for time and effort entailed in creating these plans.

**Purdy Powers &
Company**
CL023339

Location: 130 Middle Street

Portland, ME

Drawing No.: 2 of 2

Drawn by: PL Rep.: PL

Date: 08.10.2015

Lead No.: CL023339

Gen Ref.: