

DISPLAY THIS CARD ON PRINCIPAL FRONTAGE OF WORK

CITY OF PORTLAND

BUILDING INSPECTION

PERMIT

Permit Number: 081455

Please Read Application And Notes, If Any, Attached

This is to certify that Rsb Limited Liability Company/LLC

has permission to Out-side seating 3 tables and 6 chairs, 56 sq. ft. of proposed seating area.

AT 129 Commercial St CBL 029 D001001

provided that the person or persons, firm or corporation accepting this permit shall comply with all of the provisions of the Statutes of Maine and of the Ordinances of the City of Portland regulating the construction, maintenance and use of buildings and structures, and of the application on file in this department.

Apply to Public Works for street line and grade if nature of work requires such information.

Notification of inspection must be given and written permission procured before this building or part thereof is lathed or otherwise closed-in. 24 HOUR NOTICE IS REQUIRED.

A certificate of occupancy must be procured by owner before this building or part thereof is occupied.

OTHER REQUIRED APPROVALS

- Fire Dept. _____
- Health Dept. _____
- Appeal Board _____
- Other _____

Department Name

[Handwritten Signature]
Director - Building & Inspection Services

PENALTY FOR REMOVING THIS CARD



CITY OF PORTLAND, MAINE
 Department of Building Inspections

Original Receipt

Nov 11 2008

Received from Ch. White & Associates

Location of Work 157 Commercial

Cost of Construction \$ _____ Building Fee: 20.00

Permit Fee \$ _____ Site Fee: 11.00

19.00

Building (IL) _____ e Plan (U2) _____

Other _____

CBL: _____

Check #: 11 insurance for auto documents 66 | \$ 19.00

No **it issued.**
 If permit is _____ and is based on _____
 \$20.00 or 2 _____

In order to _____ present the Original Receipt.

Taken by: 11/2/08 _____

WHITE - Applicant's Copy
 YELLOW - Office Copy
 PINK - Permit Copy

City of Portland, Maine - Building or Use Permit Application

389 Congress Street, 04101 Tel: (207) 874-8703, Fax: (207) 874-8716

Permit No: 08-1455	Issue Date:	CBL: 029 D001001
-----------------------	-------------	---------------------

Location of Construction: 129 Commercial St	Owner Name: Rsb Limited Liability Company	Owner Address: 37 A St	Phone: 561-306-4232
Business Name: Olive Cafe	Contractor Name: n/a	Contractor Address: n/a Portland	Phone
Lessee/Buyer's Name	Phone:	Permit Type: Outdoor Seating	Zone: B-3

Past Use: Restaurant / Olive Cafe	Proposed Use: Olive Cafe / Out-side seating 3 tables and 6 chairs, 56 sq. ft. of proposed seating area.	Permit Fee: \$192.00	Cost of Work: \$0.00	CEO District: 1
--------------------------------------	--	-------------------------	-------------------------	--------------------

Proposed Project Description: Out-side seating 3 tables and 6 chairs, 56 sq. ft. of proposed seating area.	FIRE DEPT: <input type="checkbox"/> Approved <input checked="" type="checkbox"/> Denied Signature: <i>N/A</i>	INSPECTION: Use Group: <i>U</i> Type: <i>outdoor Seating</i> Signature: <i>[Signature]</i>
PEDESTRIAN ACTIVITIES DISTRICT (P.A.D.) Action: <input type="checkbox"/> Approved <input type="checkbox"/> Approved w/Conditions <input checked="" type="checkbox"/> Denied Signature: _____ Date: _____		

Permit Taken By: gg	Date Applied For: 11/14/2008	Zoning Approval
------------------------	---------------------------------	------------------------

1. This permit application does not preclude the Applicant(s) from meeting applicable State and Federal Rules. 2. Building permits do not include plumbing, septic or electrical work. 3. Building permits are void if work is not started within six (6) months of the date of issuance. False information may invalidate a building permit and stop all work..	Special Zone or Reviews <input type="checkbox"/> Shoreland <input type="checkbox"/> Wetland <input type="checkbox"/> Flood Zone <input type="checkbox"/> Subdivision <input type="checkbox"/> Site Plan Maj <input type="checkbox"/> Minor <input type="checkbox"/> MM <input type="checkbox"/> OK w/condition Date: 11/15/08 <i>ABU</i>	Zoning Appeal <input type="checkbox"/> Variance <input type="checkbox"/> Miscellaneous <input type="checkbox"/> Conditional Use <input type="checkbox"/> Interpretation <input type="checkbox"/> Approved <input type="checkbox"/> Denied Date: _____	Historic Preservation Yes <input type="checkbox"/> Not in District or Landmark <input type="checkbox"/> Does Not Require Review <input type="checkbox"/> Requires Review <input type="checkbox"/> Approved <input type="checkbox"/> Approved w/Conditions <input type="checkbox"/> Denied Any extension work requires a separate review & approval thru Historic Preservation.
	PERMIT ISSUED DEC 18 2008 CITY OF PORTLAND		

CERTIFICATION

I hereby certify that I am the owner of record of the named property, or that the proposed work is authorized by the owner of record and that I have been authorized by the owner to make this application as his authorized agent and I agree to conform to all applicable laws of this jurisdiction. In addition, if a permit for work described in the application is issued, I certify that the code official's authorized representative shall have the authority to enter all areas covered by such permit at any reasonable hour to enforce the provision of the code(s) applicable to such permit.

SIGNATURE OF APPLICANT	ADDRESS	DATE	PHONE
RESPONSIBLE PERSON IN CHARGE OF WORK, TITLE		DATE	PHONE

City of Portland, Maine - Building or Use Permit

389 Congress Street, 04101 Tel: (207) 874-8703, Fax: (207) 874-8716

Permit No: 08-1455	Date Applied For: 11/12/2008	CBL: 029 D001001
------------------------------	--	----------------------------

Location of Construction: 129 Commercial St	Owner Name: Rsb Limited Liability Company	Owner Address: 37 A St	Phone: 561-306-4232
Business Name: Olive Cafe	Contractor Name: n/a	Contractor Address: n/a Portland	Phone:
Lessee/Buyer's Name	Phone:	Permit Type: Outdoor Seating	

Proposed Use: Olive Cafe / Out-side seating 3 tables and 6 chairs, 56 sq. ft. of proposed seating area.	Proposed Project Description: Out-side seating 3 tables and 6 chairs, 56 sq. ft. of proposed seating area.
---	--

Dept: Zoning **Status:** Approved with Conditions **Reviewer:** Ann Machado **Approval Date:** 12/05/2008
Note: **Ok to Issue:**

- 1) All outdoor seating is subject to adjustment at any time from the City's traffic engineer who ensures that the City sidewalk is open and cleared for pedestrian use.
- 2) ANY exterior work requires a separate review and approval thru Historic Preservation. This property is located within an Historic District.

Dept: Building **Status:** Approved with Conditions **Reviewer:** Tammy Munson **Approval Date:** 12/11/2008
Note: **Ok to Issue:**

- 1) The tables and chairs must not block any means of egress of any building, even during storage.
- 2) Contruction activity was not applied for or reviewed as a part of this permit. This permit authorizes outdoor dining only.

Comments:
11/21/2008-tmm: waiting for city council approval 12/06/08 - do not issue prior

BUILDING PERMIT INSPECTION PROCEDURES

Please call 874-8703 or 874-8693 (ONLY)

to schedule your inspections as agreed upon

Permits expire in 6 months, if the project is not started or ceases for 6 months.

The Owner or their designee is required to notify the inspections office for the following inspections and provide adequate notice. Notice must be called in 48-72 hours in advance in order to schedule an inspection:

By initializing at each inspection time, you are agreeing that you understand the inspection procedure and additional fees from a "Stop Work Order" and "Stop Work Order Release" will be incurred if the procedure is not followed as stated below.

A Pre-construction Meeting will take place upon receipt of your building permit.

 X **Final inspection required at completion of work.**

Certificate of Occupancy is not required for certain projects. Your inspector can advise you if your project requires a Certificate of Occupancy. All projects DO require a final inspection.

If any of the inspections do not occur, the project cannot go on to the next phase, REGARDLESS OF THE NOTICE OR CIRCUMSTANCES.

CERIFICATE OF OCCUPANICES MUST BE ISSUED AND PAID FOR, BEFORE THE SPACE MAY BE OCCUPIED.

Signature of Applicant/Designee

Date

Signature of Inspections Official

Date

Markel



Outdoor Dining Permit Application

If you or the property owner owes real estate or personal property taxes or user charges on any property within the City, payment arrangements must be made before permits of any kind are accepted.

Location/ Address of Outdoor Seating: <u>127 Commercial Street Portland, ME</u>		04101	
Total Square Footage of Proposed Seating Area ¹ 55.9 sq ft <u>(13'3" x 4'2")</u>		Square Footage of Lot <u>960 sf +/-</u>	
Tax Assessor's Chart, Block & Lot Chart# <u>029</u> Block# <u>D</u> Lot# <u>001</u>	Owner: <u>RSB Limited</u> <u>10 City Assoc. 37A</u> <u>Street Portland, ME</u>	Telephone: <u>207 774-8300</u>	
Lessee/Buyer's Name (If Applicable) <u>Rayan Elkhatis</u>	Applicant * <u>must be owner or Lessee</u> Name <u>Rayan Elkhatis</u> Address <u>260 Danforth St. Portland, ME</u> City, State & Zip <u>04102</u>	Annual Fee: <u>\$80</u> Sq Ft Fee: <u>52.50</u> <u>\$ 112</u> Total Fee: <u>\$ 192.00</u>	<u>4 x 13 = 52</u> <u>11-19-08</u> <u>SMIT</u>
Current use: <u>Restaurant</u>	Business name: <u>Olive Cafe</u>	Seating area dimensions: <u>13'3" x 50"</u>	<u>36 Sq Ft</u> <u>+ 2</u> <u>112</u> <u>+ 80</u> <u>192.00</u> <u>seating area</u>
How many chairs? <u>6</u>	How many tables? <u>3</u>	City Clerk signature for liquor license approval _____	or Pending Council Date <u>Dec. 3, 2008</u>
Who should we contact for the pre-inspection: <u>Rayan Elkhatis</u>	Mailing address: <u>260 Danforth St. Portland, ME 04102</u>	Phone: <u>561-306-4232</u>	<u>Call</u>

Please submit all of the information outlined in the Outdoor Dining Application Checklist. Failure to do so will result in the automatic denial of your permit.

In order to be sure the City fully understands the full scope of the project, the Planning and Development Department may request additional information prior to the issuance of a permit. For further information visit us on-line at www.portlandmaine.gov, stop by the Building Inspections office, room 315 City Hall or call 874-8703.

I hereby certify that I am the Owner of record of the named property, or that the owner of record authorizes the proposed work and that I have been authorized by the owner to make this application as his/her authorized agent. I agree to conform to all applicable laws of this jurisdiction. In addition, if a permit for work described in this application is issued, I certify that the Code Official's authorized representative shall have the authority to enter all areas covered by this permit at any reasonable hour to enforce the provisions of the codes applicable to this permit.

Rayan Elkhatis
Signature of Applicant

11/7/08
Date

This is not a permit; you may not commence ANY work until the permit is issued.

¹ In no instance shall the total square footage of dining area equal more than 10% of park space, unless the applicant receives a waiver from the Director of Parks and Recreation or his or her designee.

SILVER STREET

PEARL STREET

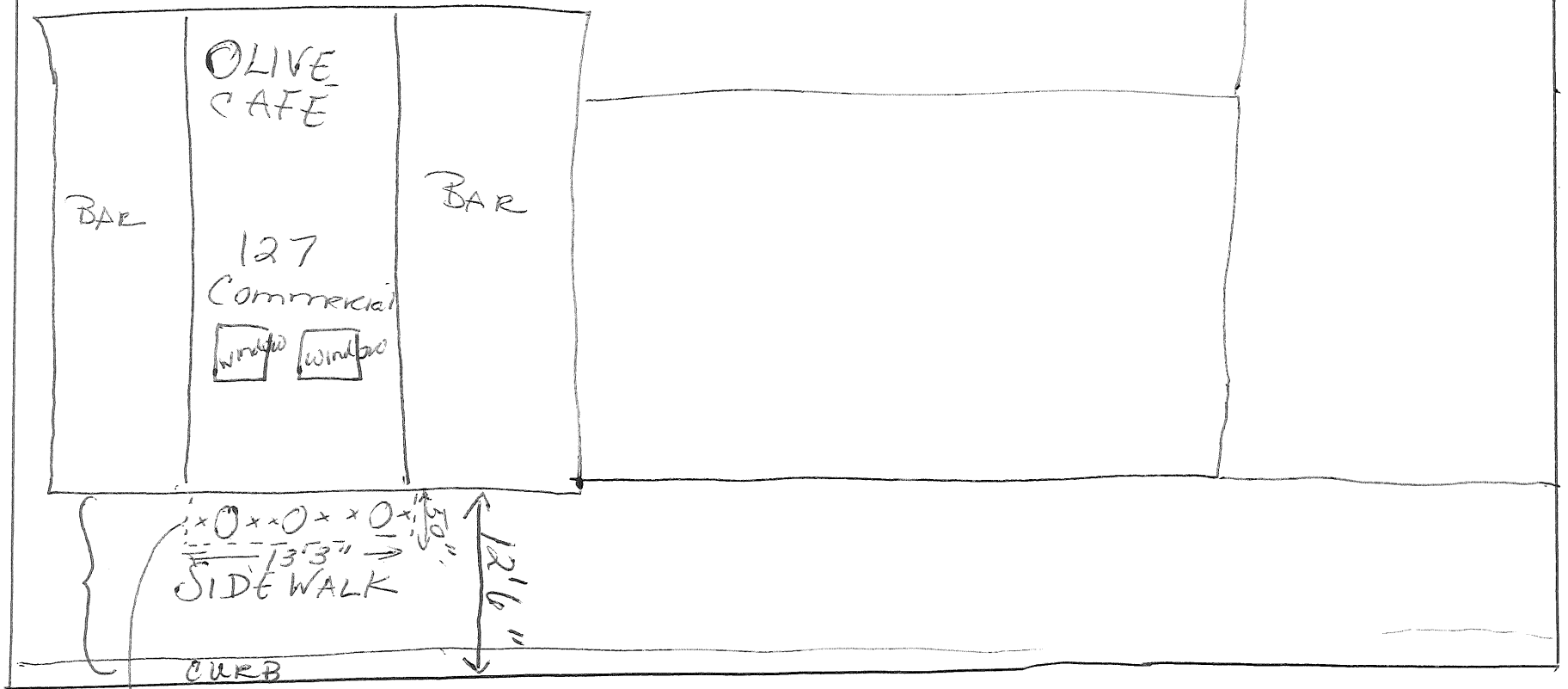

3 round/square COMMERCIAL STREET
tables w/ 2 chairs each

* Area we are requesting for tables & chairs is ~ 13'3" L x 50" W



OUTDOOR DINING PERMIT CHECKLIST

Permits are required for expanding food service establishments to the outside on City Property. The annual fee is \$80.00 plus \$2.00 per square foot of dining area on streets, sidewalks or other public ways and \$80.00 plus \$6.00 per square foot of dining area in city parks. For purposes of fee calculation, the area abutting the buildings which border Monument Square and extending ten (10) feet from the facade of said buildings shall be considered a sidewalk. The ten (10) foot area shall be measured from that portion of the facade that protrudes furthest into the sidewalk. The area beyond the ten (10) foot sidewalk shall be considered park space.

Outdoor dining is permitted year round under the permit; however, furniture must be removed in inclement weather to allow for sidewalk snow removal. **The permit must be renewed each year.**

All of the following information is required and must be submitted. You will also be required to fill out an Outdoor Dining Permit Application.

A plot plan is required and must include:

- A drawing of the lot, where the building sits on the lot along with the lot and building dimensions
- The dimensional setback from the sidewalk to the building
- The location of the street, and if it's a corner lot, the intersecting streets
- The sidewalk along with its width and curbing location
- The location of the table and chair placement, including dimensions

(NOTE: there must be a minimum of four feet of open sidewalk from the outer boundary of the seating area to the curb, and a minimum of five feet on corners, and egress from the building must be maintained free of obstruction per the building code and NFPA Life Safety Code).

Additional Requirements:

- The permit holder is required to produce, at the time of submission, and maintain public liability insurance coverage in an amount of not less than four hundred thousand dollars (\$400,000) combined single limit for bodily injury, death and property damage, naming the City as an additional insured thereon.

All permits for outdoor dining are issued subject to the following conditions:

- The tables and chairs must be placed within the permitted area on the sidewalk in such a manner as to allow the free and safe passage of pedestrian traffic. If the tables and chairs are moved and located outside of the permitted outdoor seating area, they must be relocated to within the permitted area. Failure to contain the tables and chairs to the permitted area may result in a reduced permitted area or a revocation of the permit.

- The permit holder is responsible for keeping the outdoor seating area clean. The sidewalk area where the tables and chairs are located must be kept neat and free from liter and debris.
- No food shall be prepared outside.
- If alcohol is to be served, the permit holder must notify the City's Business Licensing Office in room 203 of City Hall or by telephone at 874-8557 and obtain approval for the service of alcohol outdoors. Additionally, State law requires that any outdoor area serving alcohol be segregated from the rest of the public.
- All tables and chairs shall be removed prior to a predicted snowfall and while any snow or ice exists within the designated outdoor seating area or within four feet from the boundaries thereof. The City will not be responsible for damage to any tables, chairs or other property that is not properly removed when the City is engaged in sidewalk maintenance activities.
- The permit holder shall comply with all applicable rules and regulations implemented by the city regarding outdoor dining.

Failure to comply with any of the above conditions will result in revocation or non-renewal of the permit.

I/We fully understand that the City of Portland, its agents, officers and employees accept no responsibility and will not be liable for any injury, harm or damage to my/our person or property arising out of the establishment's occupancy of the sidewalk or park space. To the fullest extent permitted by law, I/We do hereby agree to assume all risk of injury, harm or damage to my/our person or property (including but not limited to all risk of injury, harm or damage to my/our property cause by the negligence of the City of Portland, its agents, officers or employees) arising out of the establishment's occupancy of the sidewalk or park space. I/We hereby agree, to the fullest extent permitted by law, to defend, indemnify and hold harmless the City of Portland, its agents, officers and employees, from and against all claims, damages, losses and expenses, just or unjust, including, but not limited to costs of defense and attorney's fees, arising out of the establishment's occupancy of the sidewalk or park space, provided that any such claims, damage, loss or expense (1) is attributable to bodily injury, sickness, disease, or death, or to injury to or destruction of tangible property including the loss of use there from, and (2) is caused in whole or in part by any negligent act or omission of the establishment, anyone directly or indirectly employed by it, or anyone for whose act it may be liable.

Signed and acknowledged: ~~Rayan Elkhatib~~ Date: 11/7/08
 Printed name Rayan Elkhatib
 Establishment Olive Cafe
 Location 127 Commercial St. Portland, ME

04101

D™ CERTIFICATE OF LIABILITY INSURANCE

DATE (MM/DD/YYYY)
11/5/2008

PRODUCED BY C. Hearn Insurance Agency 1087 Forest Ave Portland, Me. 04103 207-797-9400		THIS CERTIFICATE IS ISSUED AS A MATTER OF INFORMATION ONLY AND CONFERS NO RIGHTS UPON THE CERTIFICATE HOLDER. THIS CERTIFICATE DOES NOT AMEND, EXTEND OR ALTER THE COVERAGE AFFORDED BY THE POLICIES BELOW.	
INSURED Olive Cafe, LLC 127 Commercial St Portland, ME 04101		INSURERS AFFORDING COVERAGE INSURER A: Hanover Insurance Company INSURER B: INSURER C: INSURER D: INSURER E:	NAIC#

COVERAGES

THE POLICIES OF INSURANCE LISTED BELOW HAVE BEEN ISSUED TO THE INSURED NAMED ABOVE FOR THE POLICY PERIOD INDICATED. NOTWITHSTANDING ANY REQUIREMENT, TERM OR CONDITION OF ANY CONTRACT OR OTHER DOCUMENT WITH RESPECT TO WHICH THIS CERTIFICATE MAY BE ISSUED OR MAY PERTAIN, THE INSURANCE AFFORDED BY THE POLICIES DESCRIBED HEREIN IS SUBJECT TO ALL THE TERMS, EXCLUSIONS AND CONDITIONS OF SUCH POLICIES. AGGREGATE LIMITS SHOWN MAY HAVE BEEN REDUCED BY PAID CLAIMS.

INSR LTR	ADD'L INSRD	TYPE OF INSURANCE	POLICY NUMBER	POLICY EFFECTIVE DATE (MM/DD/YY)	POLICY EXPIRATION DATE (MM/DD/YY)	LIMITS
A		GENERAL LIABILITY <input checked="" type="checkbox"/> COMMERCIAL GENERAL LIABILITY <input type="checkbox"/> CLAIMSMADE <input checked="" type="checkbox"/> OCCUR	ODP 4409778 00	10/31/08	10/31/09	EACH OCCURRENCE \$ 1,000,000
		GEN'L AGGREGATE LIMIT APPLIES PER: <input type="checkbox"/> POLICY <input type="checkbox"/> PRO-JECT <input type="checkbox"/> LOC				DAMAGE TO RENTED PREMISES (Ea occurrence) \$ 300,000 MED EXP (Any one person) \$ 5,000 PERSONAL & ADV INJURY \$ 1,000,000 GENERAL AGGREGATE \$ 2,000,000 PRODUCTS - COMP/OP AGG \$ 1,000,000
		AUTOMOBILE LIABILITY <input type="checkbox"/> ANY AUTO <input type="checkbox"/> ALL OWNED AUTOS <input type="checkbox"/> SCHEDULED AUTOS <input type="checkbox"/> HIRED AUTOS <input type="checkbox"/> NON-OWNED AUTOS				COMBINED SINGLE LIMIT (Ea accident) \$ BODILY INJURY (Per person) \$ BODILY INJURY (Per accident) \$ PROPERTY DAMAGE (Per accident) \$
		GARAGE LIABILITY <input type="checkbox"/> ANY AUTO				AUTO ONLY - EA ACCIDENT \$ OTHER THAN AUTO ONLY: EA ACC \$ AGG \$
		EXCESS/UMBRELLA LIABILITY <input type="checkbox"/> OCCUR <input type="checkbox"/> CLAIMSMADE DEDUCTIBLE RETENTION \$				EACH OCCURRENCE \$ AGGREGATE \$ \$ \$ \$
		WORKERS COMPENSATION AND EMPLOYERS' LIABILITY ANY PROPRIETOR/PARTNER/EXECUTIVE OFFICER/MEMBER EXCLUDED? If yes, describe under SPECIAL PROVISIONS below OTHER				WC STATUTORY LIMITS OTH-ER E.L. EACH ACCIDENT \$ E.L. DISEASE - EA EMPLOYEE \$ E.L. DISEASE - POLICY LIMIT \$

DESCRIPTION OF OPERATIONS / LOCATIONS / VEHICLES / EXCLUSIONS ADDED BY ENDORSEMENT / SPECIAL PROVISIONS

Sign coverage: \$5,000

CERTIFICATE HOLDER

City of Portland
 389 Congress St
 Portland, ME 04101

CANCELLATION

SHOULD ANY OF THE ABOVE DESCRIBED POLICIES BE CANCELLED BEFORE THE EXPIRATION DATE THEREOF, THE ISSUING INSURER WILL ENDEAVOR TO MAIL 30 DAYS WRITTEN NOTICE TO THE CERTIFICATE HOLDER NAMED TO THE LEFT, BUT FAILURE TO DO SO SHALL IMPOSE NO OBLIGATION OR LIABILITY OF ANY KIND UPON THE INSURER, ITS AGENTS OR REPRESENTATIVES.

AUTHORIZED REPRESENTATIVE

O'Hearn Insurance Group
1087 Forest Ave.
Portland, ME 04103

Date:	<u>11/5/08</u>
Number of pages including cover sheet:	<u>2</u>

**AUTO / HOME / COMMERCIAL
LIFE / FINANCIAL SERVICES**

FAX

TO:	<u>City of Portland</u>
ATTN	<u>Lannie Dobson</u>
RE	<u>Olive Cafe</u>
Phone:	
Fax phone:	<u>874-8716</u>

FROM:	Tim McGonagle
	<u>timothy@ohearninsurance.com</u>
Phone:	<u>(207 797-9400</u>
Fax phone:	<u>(207) 347-5808</u>

REMARKS:	<input checked="" type="checkbox"/> Urgent	<input type="checkbox"/> For your review	<input type="checkbox"/> Reply ASAP	<input type="checkbox"/> Please comment
Lannie, Here is the info for The Olive Cafe. Please do not hesitate to contact me with any questions. Regards, Tim				

CITY OF PORTLAND
DEPARTMENT OF PLANNING & URBAN DEVELOPMENT
389 Congress Street
Portland, Maine 04101

INVOICE FOR PERMIT FEES

Application No: 8-1455	Applicant: Rsb Limited Liability Company
Project Name: Out-side seating 3 tables and 6 chair	Location: 129 Commercial St
CBL: 029 D001001	Development Type:
Invoice Date: 11/14/2008	

Previous Balance	-	Payment Received	+	Current Fees	-	Current Payment	=	Total Due	Payment Due Date
\$0.00		\$0.00		\$192.00		\$192.00		\$0.00	On Receipt

Previous Balance	\$0.00
-------------------------	---------------

Fee Description	Qty	Fee/Deposit Charge
Outside Seating Sidewalk	56	\$112.00
Outside Seating	1	\$80.00
		\$192.00
Total Current Fees:	+	\$192.00
Total Current Payments:	-	\$192.00
Amount Due Now:		\$0.00

Bill to: Rsb Limited Liability Company
37 A St
South Portland , ME 04106

CBL 029 D001001
Application No: 8-1455
Invoice Date: 11/14/2008
Invoice No: 33138
Total Amt Due: \$0.00
Payment Amount: \$192.00

Make checks payable to the *City of Portland*, ATTN: Inspections, 3rd Floor, 389 Congress Street, Portland, ME 04101.