

DISPLAY THIS CARD ON PRINCIPAL FRONTAGE OF WORK CITY OF PORTLAND

BUILDING INSPECTION

PERMIT

Permit Number: 091365

Please Read Application And Notes, If Any, Attached

This is to certify that Bibeau Arthur D./Sign Design Inc
has permission to Erect 2.5 x 2' wall sign
AT 340 Fore St CBL 029 C001001

provided that the person or persons, firm or corporation accepting this permit shall comply with all of the provisions of the Statutes of Maine and of the Ordinances of the City of Portland regulating the construction, maintenance and use of buildings and structures, and of the application on file in this department.

Apply to Public Works for street line and grade if nature of work requires such information.

Notification of inspection must be given and written permission procured before this building or part thereof is lathed or otherwise closed-in. 24 HOUR NOTICE IS REQUIRED.

A certificate of occupancy must be procured by owner before this building or part thereof is occupied.

OTHER REQUIRED APPROVALS

Fire Dept. _____
Health Dept. _____
Appeal Board _____
Other _____
Department Name

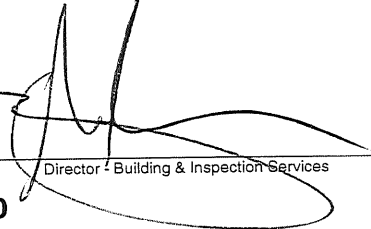
Director - Building & Inspection Services

PENALTY FOR REMOVING THIS CARD

PERMIT ISSUED

DEC 22 2009

City of Portland



CITY OF PORTLAND, MAINE
 Department of Building Inspections

Original Receipt

Nov. 24 2009

Received from Cost T. 1097

Location of Work 340 Twp St

Cost of Construction \$ _____ Building Fee: _____

Permit Fee \$ _____ Site Fee: _____

Certificate of Occupancy Fee: _____

Total: _____

Building (IL) Plumbing (I5) _____ Electrical (I2) _____ Site Plan (U2)

Other _____

CBL: 099 CC01

Check #: 665 **Total Collected \$** 500

**No work is to be started until permit issued.
 Please keep original receipt for your records.**

Taken by: [Signature]

WHITE - Applicant's Copy
 YELLOW - Office Copy
 PINK - Permit Copy



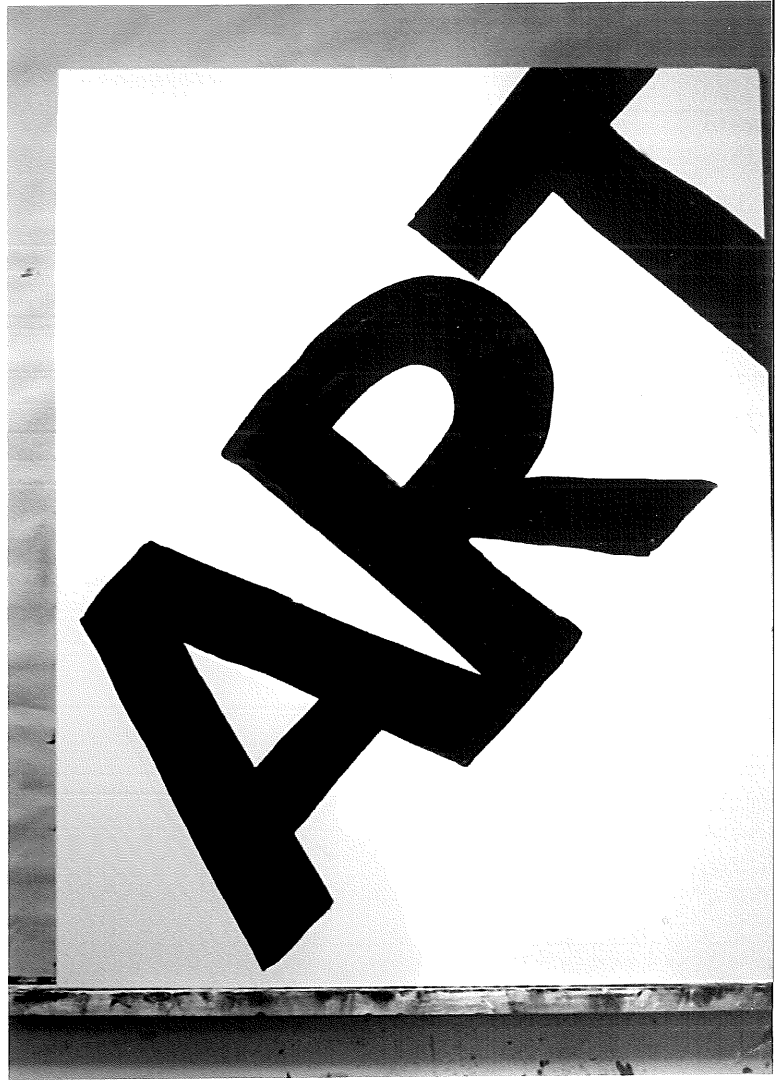



NO PARKING ANY TIME

height of sign 110" above grade

110" above grade



City of Portland, Maine - Building or Use Permit Application

389 Congress Street, 04101 Tel: (207) 874-8703, Fax: (207) 874-8716

Permit No: 09-1365	Issue Date:	CBL: 029 C001001
-----------------------	-------------	---------------------

Location of Construction: 340 Fore St	Owner Name: Bibeau Arthur D	Owner Address: 340 Fore St # 1	Phone:
Business Name:	Contractor Name: Sign Design Inc	Contractor Address: PO Box 207 Westbrook	Phone 2078562600
Lessee/Buyer's Name	Phone:	Permit Type: Signs - Permanent	Zone: B-3

Past Use: Commercial - retail - gift shop	Proposed Use: Commercial / Erect 2.5 x 2' wall sign. - retail - art gallery.	Permit Fee: \$75.00	Cost of Work: \$0.00	CEO District: 1
		FIRE DEPT: <input type="checkbox"/> Approved <input type="checkbox"/> Denied <i>N/A</i>	INSPECTION: Use Group: <i>U</i> Type: <i>Sign</i> <i>IBC 2003</i>	

Proposed Project Description: Erect 2.5 x 2' wall sign.	Signature:	Signature:
PEDESTRIAN ACTIVITIES DISTRICT (P.A.D.)		
Action: <input type="checkbox"/> Approved <input type="checkbox"/> Approved w/Conditions <input type="checkbox"/> Denied		
Signature:	Date:	

Permit Taken By: gg	Date Applied For: 11/24/2009	Zoning Approval
------------------------	---------------------------------	------------------------

<p>1. This permit application does not preclude the Applicant(s) from meeting applicable State and Federal Rules.</p> <p>2. Building permits do not include plumbing, septic or electrical work.</p> <p>3. Building permits are void if work is not started within six (6) months of the date of issuance. False information may invalidate a building permit and stop all work..</p>	<p>Special Zone or Reviews</p> <input type="checkbox"/> Shoreland <input type="checkbox"/> Wetland <input type="checkbox"/> Flood Zone <input type="checkbox"/> Subdivision <input type="checkbox"/> Site Plan <p>Maj <input type="checkbox"/> Minor <input type="checkbox"/> MM <input type="checkbox"/></p> <p><i>OK w/ conditions</i> Date: <i>12/11/09</i> <i>AM</i></p>	<p>Zoning Appeal</p> <input type="checkbox"/> Variance <input type="checkbox"/> Miscellaneous <input type="checkbox"/> Conditional Use <input type="checkbox"/> Interpretation <input type="checkbox"/> Approved <input type="checkbox"/> Denied <p>Date:</p>	<p>Historic Preservation</p> <input type="checkbox"/> Not in District or Landmark <input type="checkbox"/> Does Not Require Review <input type="checkbox"/> Requires Review <input type="checkbox"/> Approved <input checked="" type="checkbox"/> Approved w/Conditions <input type="checkbox"/> Denied <p>Date: <i>12/22/09</i> <i>D. Andrews</i></p>
---	--	--	---

PERMIT ISSUED

DEC 22 2009

City of Portland

CERTIFICATION

I hereby certify that I am the owner of record of the named property, or that the proposed work is authorized by the owner of record and that I have been authorized by the owner to make this application as his authorized agent and I agree to conform to all applicable laws of this jurisdiction. In addition, if a permit for work described in the application is issued, I certify that the code official's authorized representative shall have the authority to enter all areas covered by such permit at any reasonable hour to enforce the provision of the code(s) applicable to such permit.

SIGNATURE OF APPLICANT	ADDRESS	DATE	PHONE
RESPONSIBLE PERSON IN CHARGE OF WORK, TITLE		DATE	PHONE

City of Portland, Maine - Building or Use Permit

389 Congress Street, 04101 Tel: (207) 874-8703, Fax: (207) 874-8716

Permit No: 09-1365	Date Applied For: 11/24/2009	CBL: 029 C001001
------------------------------	--	----------------------------

Location of Construction: 340 Fore St	Owner Name: Bibeau Arthur D	Owner Address: 340 Fore St # 1	Phone:
Business Name:	Contractor Name: Sign Design Inc	Contractor Address: PO Box 207 Westbrook	Phone (207) 856-2600
Lessee/Buyer's Name	Phone:	Permit Type: Signs - Permanent	

Proposed Use: Commercial / retail - art gallery -Erect 2.5 x 2' wall sign.	Proposed Project Description: Erect 2.5 x 2' wall sign.
--	---

Dept: Historic **Status:** Approved with Conditions **Reviewer:** Deborah Andrews **Approval Date:** 12/22/2009
Note: **Ok to Issue:**

1) * Sign bracket to be installed in existing holes in granite.

Dept: Zoning **Status:** Approved with Conditions **Reviewer:** Ann Machado **Approval Date:** 12/11/2009
Note: **Ok to Issue:**

1) This property shall remain 3 commercial units & two residential units. The basement on Gold Street is used for personal service (Barber). The second half of the basement and the first floor are used as retail. The second floor is used for office space. The third floor is used as a residential unit, and the fourth and fifth floors are used for one residential unit. Any change of use shall require a separate permit application for review and approval.

2) ANY exterior work requires a separate review and approval thru Historic Preservation. This property is located within an Historic District.

Dept: Building **Status:** Approved with Conditions **Reviewer:** Tammy Munson **Approval Date:** 12/28/2009
Note: **Ok to Issue:**

1) Signage Installation to comply with Chapters 31 & 32 of the IBC 2003 building code.

Comments:

12/3/2009-gg: On hold for Scott Tubby, he will be revising the plans within 10 days. /gg Gayle has permit.

12/11/2009-gg: Scott is contracting Sign Design. Permit is now moving forward to zoning. /gg

12/23/2009-gg: received from historic as of 12/22/09. /gg

PERMIT ISSUED

DEC 22 2009

City of Portland

BUILDING PERMIT INSPECTION PROCEDURES

Please call 874-8703 or 874-8693 (ONLY)

to schedule your inspections as agreed upon

Permits expire in 6 months, if the project is not started or ceases for 6 months.

The Owner or their designee is required to notify the inspections office for the following inspections and provide adequate notice. Notice must be called in 48-72 hours in advance in order to schedule an inspection:

By initializing at each inspection time, you are agreeing that you understand the inspection procedure and additional fees from a "Stop Work Order" and "Stop Work Order Release" will be incurred if the procedure is not followed as stated below.

A Pre-construction Meeting will take place upon receipt of your building permit.

 X Final inspection required at completion of work.

Certificate of Occupancy is not required for certain projects. Your inspector can advise you if your project requires a Certificate of Occupancy. All projects DO require a final inspection.

If any of the inspections do not occur, the project cannot go on to the next phase, REGARDLESS OF THE NOTICE OR CIRCUMSTANCES.

CERIFICATE OF OCCUPANICES MUST BE ISSUED AND PAID FOR, BEFORE THE SPACE MAY BE OCCUPIED.

Signature of Applicant/Designee

Date

Signature of Inspections Official

Date

PERMIT ISSUED

DEC 22 2009

City of Portland



Signage/Awning Permit Application

If you or the property owner owes real estate or personal property taxes or user charges on any property within the City, payment arrangements must be made before permits of any kind are accepted.

Location/Address of Construction: <u>340 FORE STREET</u>		
Tax Assessor's Chart, Block & Lot Chart# <u>049</u> Block# <u>C</u> Lot# <u>001001</u>	Owner: <u>BIBEAU & GRANDIN LLC</u> <u>340 FORE ST.</u> <u>PORTLAND, ME 04101</u>	Telephone: <u>(207) 772-5161</u>
Lessee/Buyer's Name (If Applicable) <u>GEORGE ANDERSON</u> <u>ANDERSON GALLERY</u> <u>SIGN DESIGN</u> <u>PO BOX 207</u> <u>WESTBROOK, ME 04098</u>	Contractor name, address & telephone: <u>SCOTT TUBBY</u> <u>150 SOUTH KELSEY ST.</u> <u>SOUTH PORTLAND, ME 04106</u> <u>(207) 329-2586</u> <u>XX mail</u>	Total s.f. of signage x \$2.00 Per s.f. plus \$30.00/\$65.00 For H.D. signage= Total Fee: \$ _____ Awning Fee= cost of work _____ Total Fee: \$ _____
Who should we contact when the permit is ready: <u>SCOTT TUBBY</u> phone: <u>(207) 329-2586</u>		
Tenant/allocated building space frontage (feet): Length: <u>12' 7"</u> Height: <u>12' 6"</u> Lot Frontage (feet) _____ Single Tenant or Multi Tenant Lot _____		RECEIVED
Current Specific use: <u>ART GALLERY</u> If vacant, what was prior use: _____ Proposed Use: _____		NOV 24 2009
Information on proposed sign(s): Freestanding (e.g., pole) sign? Yes _____ No _____ Dimensions proposed: _____ Height from grade: <u>93"</u> Bldg. wall sign? (attached to bldg) Yes <input checked="" type="checkbox"/> No _____ Dimensions proposed: <u>H-36" W-24"</u>		Dept. of Building Inspections City of Portland, Maine $2.5 \times 2 = 5.00$ 10.00 65.00 <u>total 75.00</u>
Proposed awning? Yes _____ No <input checked="" type="checkbox"/> Is awning backlit? Yes _____ No _____ Height of awning: _____ Length of awning: _____ Depth: _____ Is there any communication, message, trademark or symbol on it? Yes _____ No _____ If yes, total s.f. of panels w/communications, message, trademark or symbol: _____ s.f.		
Information on existing and previously permitted sign(s): Freestanding (e.g., pole) sign? Yes _____ No <input checked="" type="checkbox"/> Dimensions: _____ Bldg. wall sign? (attached to bldg) Yes _____ No <input checked="" type="checkbox"/> Dimensions: _____ Awning? Yes _____ No <input checked="" type="checkbox"/> Sq. ft. area of awning w/communication: _____		
A site sketch and building sketch showing exactly where existing and new signage is located must be provided. Sketches and/or pictures of proposed signage and existing building are also required.		

Please submit all of the information outlined in the Sign/Awning Application Checklist. Failure to do so may result in the automatic denial of your permit.

In order to be sure the City fully understands the full scope of the project, the Planning and Development Department may request additional information prior to the issuance of a permit. For further information visit us on-line at www.portlandmaine.gov, stop by the Building Inspections office, room 315 City Hall or call 874-8703.

I hereby certify that I am the Owner of record of the named property, or that the owner of record authorizes the proposed work and that I have been authorized by the owner to make this application as his/her authorized agent. I agree to conform to all applicable laws of this jurisdiction. In addition, if a permit for work described in this application is issued, I certify that the Code Official's authorized representative shall have the authority to enter all areas covered by this permit at any reasonable hour to enforce the provisions of the codes applicable to this permit.

Signature of applicant: <u>Scott Tubby</u>	Date: <u>11/24/09</u>
--	-----------------------

This is not a permit, you may not commence ANY work until the permit is issued.

B-3 - multi-tenant - small floor
 $2 \times 15' \times 30' = 12'8" = 25.17'$ $24" \times 30" = 5'$ (OK)



Signage/Awning Permit Application Checklist

All of the following information is required and must be submitted. Checking off each item as you prepare your application package will ensure your package is complete and will help to expedite the permitting process.

- Certificate of Liability listing the City as additional insured if any portion of the sign abuts or encroaches on any public right of way, or can fall into any public right of way.
- Letter of permission from the owner indicating the permissions granted and the tenant/space building frontage. 12' 7"
- A sketch plan of lot indicating location of buildings, driveways and any abutting streets or rights of way, lengths of building frontages, street frontages and all existing setbacks. Please indicate on the plan all existing and proposed signs with their dimensions and specific locations. Be sure to include distance from the ground and building façade dimensions for any signage attached to the building.
- A sketch or photo of any proposed sign(s) indicating content, dimensions, materials, source of illumination, construction method as well as specifics of installation/attachment.
- Certificate of flammability required for awning or canopy.
- A UL# is required for lighted signs at the time of final inspection.
- Photos of existing signage
- Details for sign fastening, attachment or mounting in the ground.

Permit fee for signage or awning-with-signage: \$30.00 plus \$2.00 per square foot of sign.

Permit fee for awning-without-signage is based on cost of work:
\$30.00 for the first \$1,000.00, \$10.00 per additional \$1,000.00 of cost.

Base application fee for any Historic District signage is \$65.00.



Revised 10/19/09

Sidewalk Signs

GOLD STREET

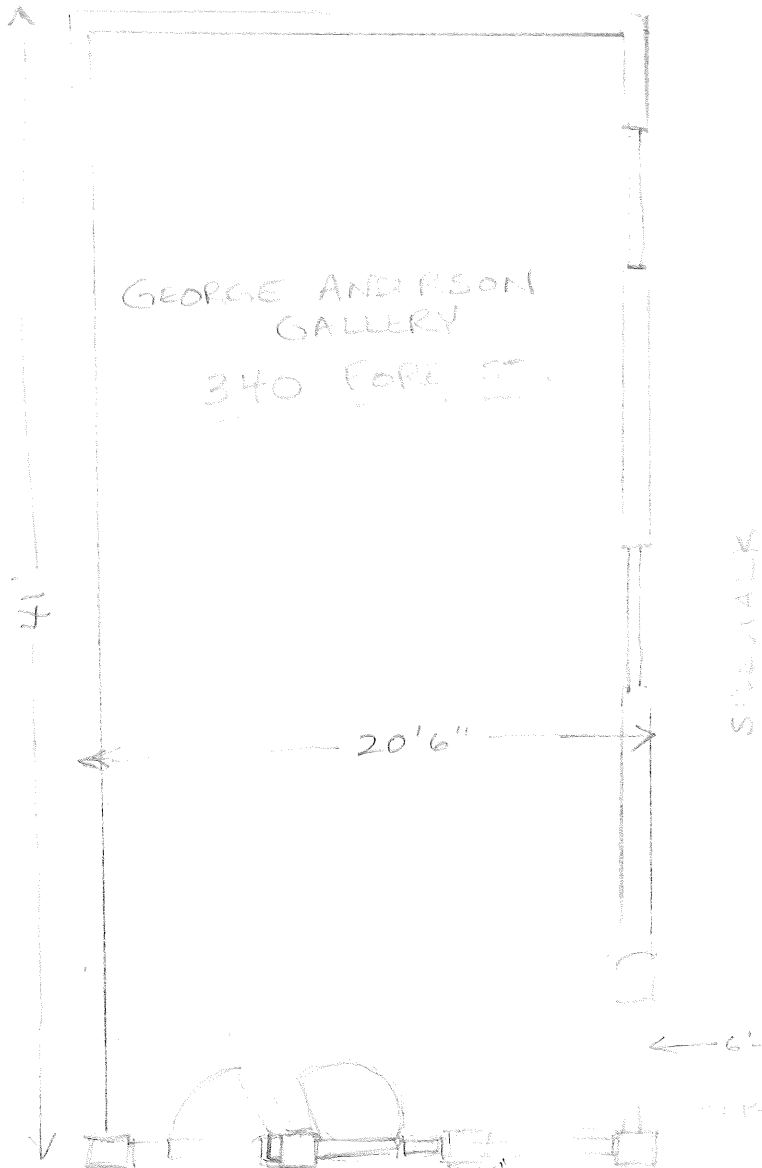

SIDEWALK

GOLD STREET

PROPOSED SIGN PLACEMENT
 (BOTTOM OF SIGN 93" FROM SIDEWALK)
 110"

30.5"

STREET SIGN

STEP

OK 96 min.

SIDEWALK (340 FORE ST)

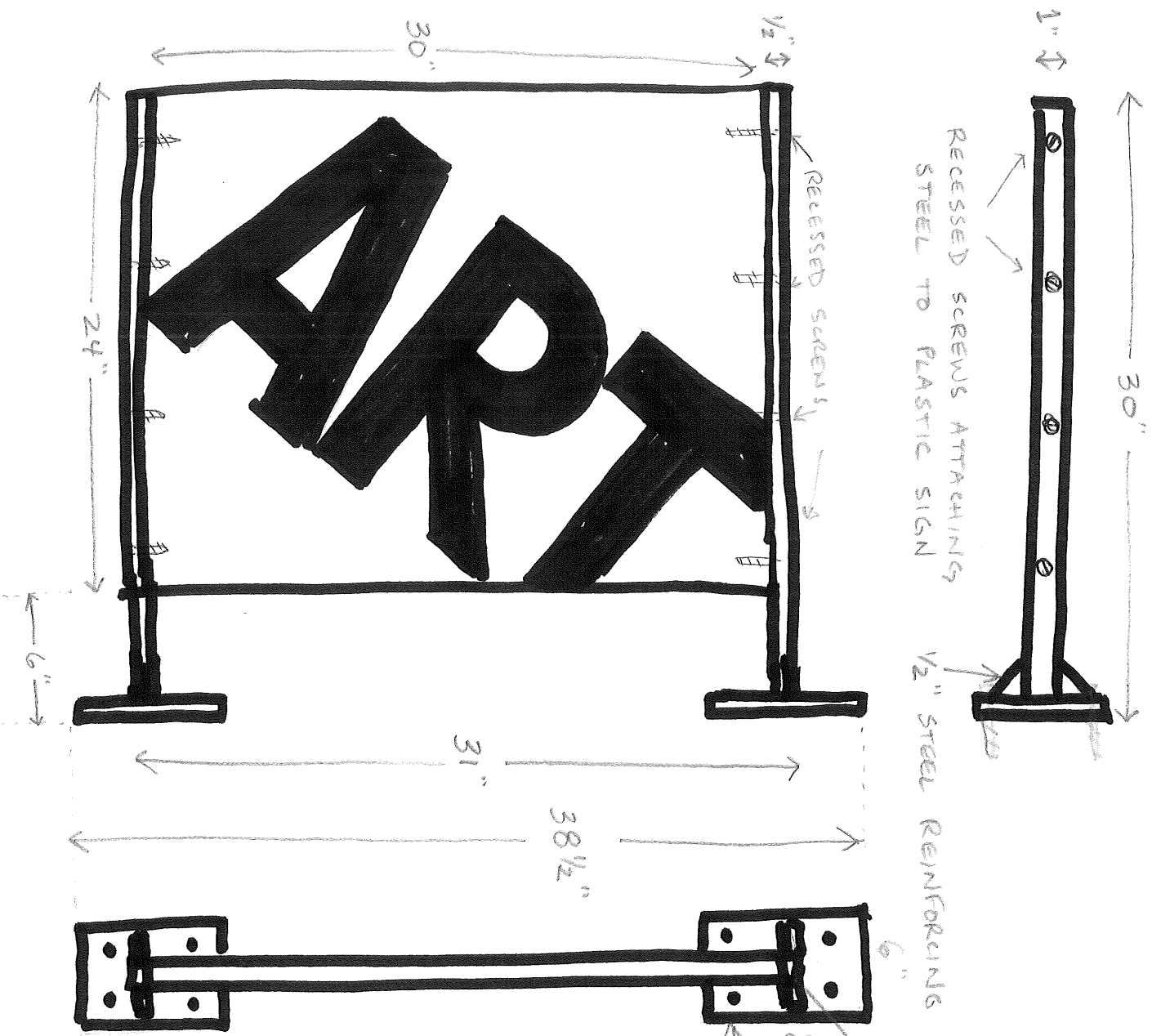

RECESSED SCREWS ATTACHING STEEL TO PLASTIC SIGN

1/2" STEEL REINFORCING

6" x 8" x 1/2" STEEL PLATE

1" x 1/2" STEEL FRAME

SIGN TO BE CONSTRUCTED OF 1" THICK WHITE PLASTIC. BLACK PRESS ON LETTERING ON BOTH SIDES SIGN WILL BE ATTACHED TO GIRPED STEEL FRAME WITH 4 2.5" SCREWS ON TOP AND 4 2.5" SCREWS ON BOTTOM STEEL FRAME. UPPER AND LOWER STEEL FRAMES WILL BE ATTACHED TO STONE FACADE USING 4 2.5" LAG BOLTS IN LEAD INNER SLEEVES.



November 24, 2009

Anderson Gallery
340 Fore Street
Portland, ME 04101

RE: Signage at 340 Fore Street

To Whom It May Concern:

Bibeau & Grondin, LLC hereby grants permission to Anderson Gallery to erect signage on the exterior of the space it leases at 340 Fore Street, Portland, Maine. Final design and location subject to Landlord approval.

Thank you,

A handwritten signature in black ink, appearing to be "A. Bibeau".

Arthur D. Bibeau
Bibeau & Grondin, LLC

BUILDING FRONTAGE = 12' 7" - ADB

ACORD CERTIFICATE OF LIABILITY INSURANCE

DATE (MM/DD/YYYY)
11/13/2009

PRODUCER (207) 774-6257 FAX: (207) 774-2994
Clark Insurance
2385 Congress Street
P O Box 3543
Portland ME 04104

THIS CERTIFICATE IS ISSUED AS A MATTER OF INFORMATION ONLY AND CONFERS NO RIGHTS UPON THE CERTIFICATE HOLDER. THIS CERTIFICATE DOES NOT AMEND, EXTEND OR ALTER THE COVERAGE AFFORDED BY THE POLICIES BELOW.

INSURED
Bibeau & Grondin LLC
340 Fore Street
Portland ME 04101

INSURERS AFFORDING COVERAGE	NAIC #
INSURER A: Travelers Insurance Co.	39357
INSURER B:	
INSURER C:	
INSURER D:	
INSURER E:	

COVERAGES

THE POLICIES OF INSURANCE LISTED BELOW HAVE BEEN ISSUED TO THE INSURED NAMED ABOVE FOR THE POLICY PERIOD INDICATED. NOTWITHSTANDING ANY REQUIREMENT, TERM OR CONDITION OF ANY CONTRACT OR OTHER DOCUMENT WITH RESPECT TO WHICH THIS CERTIFICATE MAY BE ISSUED OR MAY PERTAIN, THE INSURANCE AFFORDED BY THE POLICIES DESCRIBED HEREIN IS SUBJECT TO ALL THE TERMS, EXCLUSIONS AND CONDITIONS OF SUCH POLICIES. AGGREGATE LIMITS SHOWN MAY HAVE BEEN REDUCED BY PAID CLAIMS.

INSR ADD'L LTR INSRD	TYPE OF INSURANCE	POLICY NUMBER	POLICY EFFECTIVE DATE (MM/DD/YY)	POLICY EXPIRATION DATE (MM/DD/YY)	LIMITS
A	GENERAL LIABILITY	I6605694C460IND09	10/3/2009	10/3/2010	EACH OCCURRENCE \$ 1,000,000
	<input checked="" type="checkbox"/> COMMERCIAL GENERAL LIABILITY				DAMAGE TO RENTED PREMISES (Ea occurrence) \$ 300,000
	<input type="checkbox"/> CLAIMS MADE <input checked="" type="checkbox"/> OCCUR				MED EXP (Any one person) \$ 5,000
					PERSONAL & ADV INJURY \$ 1,000,000
					GENERAL AGGREGATE \$ 2,000,000
					PRODUCTS - COMP/OP AGG \$ 2,000,000
	GEN'L AGGREGATE LIMIT APPLIES PER: <input checked="" type="checkbox"/> POLICY <input type="checkbox"/> PROJECT <input type="checkbox"/> LOC				
	AUTOMOBILE LIABILITY				COMBINED SINGLE LIMIT (Ea accident) \$
	<input type="checkbox"/> ANY AUTO				BODILY INJURY (Per person) \$
	<input type="checkbox"/> ALL OWNED AUTOS				BODILY INJURY (Per accident) \$
	<input type="checkbox"/> SCHEDULED AUTOS				PROPERTY DAMAGE (Per accident) \$
	<input type="checkbox"/> HIRED AUTOS				
	<input type="checkbox"/> NON-OWNED AUTOS				
	GARAGE LIABILITY				AUTO ONLY - EA ACCIDENT \$
	<input type="checkbox"/> ANY AUTO				OTHER THAN EA ACC \$
					AUTO ONLY: AGG \$
	EXCESS/UMBRELLA LIABILITY				EACH OCCURRENCE \$
	<input type="checkbox"/> OCCUR <input type="checkbox"/> CLAIMS MADE				AGGREGATE \$
					\$
	<input type="checkbox"/> DEDUCTIBLE				\$
	<input type="checkbox"/> RETENTION \$				\$
	WORKERS COMPENSATION AND EMPLOYERS' LIABILITY				WC STATUTORY LIMITS OTH-ER
	ANY PROPRIETOR/PARTNER/EXECUTIVE OFFICER/MEMBER EXCLUDED?				E.L. EACH ACCIDENT \$
	If yes, describe under SPECIAL PROVISIONS below				E.L. DISEASE - EA EMPLOYEE \$
					E.L. DISEASE - POLICY LIMIT \$
	OTHER				

DESCRIPTION OF OPERATIONS/LOCATIONS/VEHICLES/EXCLUSIONS ADDED BY ENDORSEMENT/SPECIAL PROVISIONS
The City of Portland is an additional insured with respect to the general liability, for the operations of the named insured, if required by written contract.

CERTIFICATE HOLDER
(207) 874-8716
City of Portland
Planning and Development Department
Attn: Ann Machado
389 Congress Street
Portland, ME 04101

CANCELLATION
SHOULD ANY OF THE ABOVE DESCRIBED POLICIES BE CANCELLED BEFORE THE EXPIRATION DATE THEREOF, THE ISSUING INSURER WILL ENDEAVOR TO MAIL 10 DAYS WRITTEN NOTICE TO THE CERTIFICATE HOLDER NAMED TO THE LEFT, BUT FAILURE TO DO SO SHALL IMPOSE NO OBLIGATION OR LIABILITY OF ANY KIND UPON THE INSURER, ITS AGENTS OR REPRESENTATIVES.
AUTHORIZED REPRESENTATIVE
Robin Carlson/CSES 

IMPORTANT

If the certificate holder is an ADDITIONAL INSURED, the policy(ies) must be endorsed. A statement on this certificate does not confer rights to the certificate holder in lieu of such endorsement(s).

If SUBROGATION IS WAIVED, subject to the terms and conditions of the policy, certain policies may require an endorsement. A statement on this certificate does not confer rights to the certificate holder in lieu of such endorsement(s).

DISCLAIMER

The Certificate of Insurance on the reverse side of this form does not constitute a contract between the issuing insurer(s), authorized representative or producer, and the certificate holder, nor does it affirmatively or negatively amend, extend or alter the coverage afforded by the policies listed thereon.