

Form # P 04

DISPLAY THIS CARD ON PRINCIPAL FRONTAGE OF WORK CITY OF PORTLAND

Please Read
Application And
Notes, If Any,
Attached

BUILDING DEPARTMENT

PERMIT

Permit Number: 030151

This is to certify that Boothby Square Properties L.P./a
has permission to Erect 16 sq. Ft. Sidewalk Sign
AT 333 Fore St

029 B004001

*Permit Application has
been abandoned + expired,
1/14/08*

provided that the person or persons, firm or corporation accepting this permit shall comply with all of the provisions of the Statutes of Maine and of the Ordinances of the City of Portland regulating the construction, maintenance and use of buildings and structures, and of the application on file in this department.

Apply to Public Works for street line and grade if nature of work requires such information.

Notification of inspection must be given and work on permit must be completed before this building or part thereof is occupied or closed-in. 24 HOUR NOTICE IS REQUIRED.

A certificate of occupancy must be procured by owner before this building or part thereof is occupied.

OTHER REQUIRED APPROVALS

Fire Dept. _____
Health Dept. _____
Appeal Board _____
Other _____

Department Name

Director - Building & Inspection Services

PENALTY FOR REMOVING THIS CARD

City of Portland, Maine - Building or Use Permit Application

389 Congress Street, 04101 Tel: (207) 874-8703, Fax: (207) 874-8716

Permit No: 03-0151	Issue Date:	CBL: 029 B004001
-----------------------	-------------	---------------------

Location of Construction: 333 Fore St	Owner Name: Boothby Square Properties Llc	Owner Address: 12 A Portland Fish Pier	Phone:
Business Name: n/a	Contractor Name: n/a	Contractor Address: n/a Portland	Phone:
Lessee/Buyer's Name n/a	Phone: n/a	Permit Type: Signs - Side Walk	Zone: B3

Past Use: Commercial / Siam Restaurant	Proposed Use: Restaurant/ Erect 16 sq. Ft. Sidewalk Sign - 8 SQ FT DENIED	Permit Fee: \$46.00	Cost of Work: \$0.00	CEO District: 1
---	---	------------------------	-------------------------	--------------------

18 SQ FT WALL SIGN

FIRE DEPT: <input type="checkbox"/> Approved <input type="checkbox"/> Denied	INSPECTION: Use Group: Type:
Signature:	Signature: 1/14/08

Permit application has expired + been abandoned

Proposed Project Description: Erect 16 sq. Ft. Sidewalk Sign

PEDESTRIAN ACTIVITIES DISTRICT (P.A.D.)		
Action: <input type="checkbox"/> Approved <input type="checkbox"/> Approved w/Conditions <input type="checkbox"/> Denied	Signature:	Date:

Permit Taken By: gg	Date Applied For: 02/26/2003	Zoning Approval		
------------------------	---------------------------------	------------------------	--	--

<ol style="list-style-type: none"> This permit application does not preclude the Applicant(s) from meeting applicable State and Federal Rules. Building permits do not include plumbing, septic or electrical work. Building permits are void if work is not started within six (6) months of the date of issuance. False information may invalidate a building permit and stop all work.. 	Special Zone or Reviews <input type="checkbox"/> Shoreland <input type="checkbox"/> Wetland ATTACHED TO BLDG - OK 3/17/03 <input type="checkbox"/> Flood Zone <input type="checkbox"/> Subdivision <input type="checkbox"/> Site Plan <input type="checkbox"/> Minor <input type="checkbox"/> MM <input type="checkbox"/>	Zoning Appeal <input type="checkbox"/> Variance <input type="checkbox"/> Miscellaneous <input type="checkbox"/> Conditional Use <input type="checkbox"/> Interpretation <input type="checkbox"/> Approved <input type="checkbox"/> Denied Date:	Historic Preservation <input type="checkbox"/> Not in District or Landmark <input type="checkbox"/> Does Not Require Review <input type="checkbox"/> Requires Review <input checked="" type="checkbox"/> Approved <input type="checkbox"/> Approved w/Conditions <input type="checkbox"/> Denied TO D.A. 3/7/03 Date:
	Date: Issue 3/4/03	Date: 3/2/03	

CERTIFICATION

I hereby certify that I am the owner of record of the named property, or that the proposed work is authorized by the owner of record and that I have been authorized by the owner to make this application as his authorized agent and I agree to conform to all applicable laws of this jurisdiction. In addition, if a permit for work described in the application is issued, I certify that the code official's authorized representative shall have the authority to enter all areas covered by such permit at any reasonable hour to enforce the provision of the code(s) applicable to such permit.

SIGNATURE OF APPLICANT	ADDRESS	DATE	PHONE
RESPONSIBLE PERSON IN CHARGE OF WORK, TITLE		DATE	PHONE

THIS IS NOT A PERMIT/CONSTRUCTION MAY NOT COMMENCE UNTIL THE PERMIT IS ISSUED

Signage Application

If you or the property owner owes real estate or personal property taxes or user charges on any property within the City, payment arrangements must be made before permits of any kind are accepted.

Location/Address of Construction: <u>339 Fore St., Portland, ME 04101</u>		
Total Square Footage of Proposed Structure	Square Footage of Lot	
Tax Assessor's Chart, Block & Lot Chart# <u>029</u> Block# <u>B</u> Lot# <u>007</u>	Owner: <u>Larry Knutson</u>	Telephone: <u>871-1101</u>
Lessee/Buyer's Name (If Applicable) <u>Siam Restaurant</u>	Applicant name, address & telephone: <u>339 Fore St Portland, ME 04101</u>	Total s.f. of signage <u>16'</u> x 1.00 per s.f. \$ <u>16.00</u> , plus \$30.00 base fee Fee: \$ <u>46.00</u>
Current use: <u>Restaurant</u>		
If the location is currently vacant, what was prior use: <u>N/A</u>		
Approximately how long has it been vacant: <u>N/A</u>		
Proposed use: _____		
Project description: <u>Signage, during working hours, a sidewalk sign</u>		
Contractor's name, address & telephone:		
Who should we contact when the permit is ready: <u>Thomas Yordson - 773 8385</u>		
Mailing address: <u>339 Fore St Portland, ME 04103</u>		
We will contact you by phone when the permit is ready. You must come in and pick up the permit and review the requirements before starting any work, with a Plan Reviewer. A stop work order will be issued and a \$50.00 fee if any work starts before the permit is picked up. Phone:		

IF THE REQUIRED INFORMATION IS NOT INCLUDED IN THE SUBMISSIONS THE PERMIT WILL BE AUTOMATICALLY DENIED AT THE DISCRETION OF THE BUILDING/PLANNING DEPARTMENT, WE MAY REQUIRE ADDITIONAL INFORMATION IN ORDER TO APPROVE THIS PERMIT.

I hereby certify that I am the Owner of record of the named property, or that the owner of record authorizes the proposed work and that I have been authorized by the owner to make this application as his/her authorized agent. I agree to conform to all applicable laws of this jurisdiction. In addition, if a permit for work described in this application is issued, I certify that the Code Official's authorized representative shall have the authority to enter all areas covered by this permit at any reasonable hour to enforce the provisions of the codes applicable to this permit.

Signature of applicant: <u>[Signature]</u>	Date: <u>2/25/03</u>
--	----------------------

This is NOT a permit, you may not commence ANY work until the permit is issued. If you are in a Historic District you may be subject to additional permitting and fees with the Planning Department on the 4th floor of City Hall

THIS IS NOT A PERMIT/CONSTRUCTION MAY NOT COMMENCE UNTIL THE PERMIT IS ISSUED

Please check off the following indicating that you have included the below items to expedite the process of this sign application:

- ✓ Certification of Liability listing the City additionally insured if any portion of the sign abuts or encroaches on the public right of way, or can fall into the public right of way, you must be in the amount of \$400,000.00
- ✓ Letter of permission from the owner

A sketch plan indicating the following:

- ✓ Drawing of the property showing all dimensions of the lot
- ✓ Location of all buildings and property setbacks from all buildings
- ✓ Driveways and abutting streets showing street frontage and any right of ways
- ✓ Indicate on drawing the dimensions of all buildings on the lot
- ✓ Define in footage the frontage of your business front
- ✓ Indicate on drawing of existing signage and dimensions of each sign
- ✓ Indicate on drawing all proposed signage and dimension of each sign

The Provisions of Section 3102.0 of the City's Building Code "The BOCA National Building Code 1999 edition" shall govern the construction, alteration, repair and maintenance of outdoor signs together with the associated appurtenant and auxiliary devices in respect to structural and fire safety. In accordance to section 3102.4.4 of BOCA construction documents and owners consent is all follows; "Before any permit is issued for the erection of a sign, Construction Documents shall be filed with the code official showing the dimensions, materials and required details of construction, including loads, stresses and anchorage. The applications shall be accompanied by the written contract of the owner or lessees of the premises upon which the sign is to erected. NO PERMIT CAN OR WILL BE ISSUED UNLESS THIS INFORMATION IS SBUMMITTED AND APPROVED BY THE INSPECTIONS OFFICE.

ELECTRICAL SIGNAGE PERMITS/RESPONSIBILITIES

All sign companies or any persons engaged in the installation, interchange or maintenance of signage in the City of Portland must have the Electrician or Electrical Contractor who provided power to the sign(s) or associated equipment apply for an electrical permit in the Inspections Office.

It is the responsibility of your company to contact your sub-contractor or he owner to inform them of this policy. Whether your company does the final connections, which requires a valid Maine Electricians License or your sub contractor provides this service; permits and inspections shall be required.

Failure to comply with this procedure may result in the denial of sign permits by this office for your company or its representation to install or interchange any future signage in the City of Portland.

BY FILLING OUT THIS APPLICATION IS DOES NOT MEAN THAT YOU WILL BE APPROVED FOR THE AMOUNT OF SIGNAGE YOU ARE APPLYING FOR

IT IS SUGGESTED THAT YOU DO NOT ORDER ANY SIGNAGE UNTIL YOU HAVE RECEIVED YOUR SIGN PERMIT THAT HAS BEEN SIGNED BY THE BUILDING, ZONING AND POSSIBLE HISTORICAL OFFICIALS OF THE CITY OF PORTLAND

SIGNAGE PRE-APPLICATION

PLEASE ANSWER ALL QUESTIONS

ADDRESS: 339 Fore St, Portland ZONE: B-3
OWNER: Thomas Yord prom, owner
APPLICANT: Joseph Chandler, co-owner
ASSESSOR NO. N/A

PLEASE CIRCLE APPROPRIATE ANSWER

SINGLE TENANT LOT? YES NO MULTI-TENANT LOT? YES NO
FREESTANDING SIGN? (ex. Pole Sign) YES NO DIMENSIONS 2' HEIGHT 4'
MORE THAN ONE SIGN? YES NO DIMENSIONS _____ HEIGHT _____
SIGN ATTACHED TO BLDG.? YES NO DIMENSIONS 3' x 6' shown = 18'
MORE THAN ONE SIGN? YES NO DIMENSIONS _____
AWNING: YES NO IS AWNING BACKLIT? YES NO HEIGHT OFF SIDEWALK _____
IS THERE ANY MESSAGE, TRADEMARK OR SYMBOL ON IT? _____

LIST ALL EXISTING SIGNAGE AND THEIR DIMENSIONS:

ex hanging sign 1 1/2' x 5' = 1.5 x 5 = 7.5 #
15.5 #

*** TENANT BLDG. FRONTAGE (IN FEET): 56' Shuman plans x 2 = 112 # MAX
*** REQUIRED INFORMATION

AREA FOR COMPUTATION

YOU SHALL PROVIDE:

A SITE SKETCH AND BUILDING SKETCH SHOWING EXACTLY WHERE EXISTING AND NEW SIGNAGE IS LOCATED MUST BE PROVIDED. SKETCHES AND/OR PICTURES OF PROPOSED ARE ALSO REQUIRED.

SIGNATURE OF APPLICANT: [Signature] DATE: 2/25/03

Side Walk Signs Design/Location/Construction Standards

Quantity

One sign per establishment for each street frontage having a public entrance provided that all dimension and location standards are met. When standards would not otherwise permit a sign, a sign may consist of multiple listings.

Sign Dimensions

Single listing: Maximum width – 24 inches or such lesser width sufficient to retain 4 ½ feet of unobstructed sidewalk width perpendicular to major flow. Maximum height – 40 inches to top of sign in place. Minimum height 30 inches to top of sign in place.

Multiple: Maximum width – 30 inches or such lesser width sufficient to retain 4 ½ feet of unobstructed sidewalk width perpendicular to major flow. Maximum height – 4- inches to top of sign in place. Minimum height 30 inches to top of sign in place.

Location

Minimum distance between signs – 20 feet. Maximum distance of sign from public entrance of advertiser 20 feet. The City may vary these distances for exceptional physical circumstances where public safety and streetscape aesthetics will be maintained. However, under no circumstances shall signs obstruct vehicular stops, benches, fire hydrants, or other street visual amenities. Signs shall be located near the curb rather than the building face.

Materials and Graphics

All signs shall be of an A-Frame type design, shall be constructed of durable, weather-resistant materials and finish, shall have no moving parts, and shall be non-electrified. All signs shall be maintained in a clean and original appearance. Sign materials, graphics, and finish shall be of a unified design and shall be compatible with the local streetscape. All signs shall have horizontal braces spanning each side of the sign to assure rigid support. Lettering shall be legible and consistent.

Sign Removal

All signs shall be removed when the business is closed or while any snow or ice exists on the walk within eight feet of the sign in any direction.

Insurance

No permit shall be issued unless the applicant has posted in advance with the City a suitable public liability insurance certificate in an amount adequate to protect the City.

Enforcement

A sign may be removed after notice to the owner and the permit, if issued, may be revoked if the sign does not conform to the standards herein.

For permit come to City Hall 389 Congress Street room 315 with:

1. Certificate of liability insurance
2. Drawing of sign showing dimensions
3. Payment of ~~1.00~~ per sq. ft. plus \$30.00

Siam City Cafe' Placement of New Sign

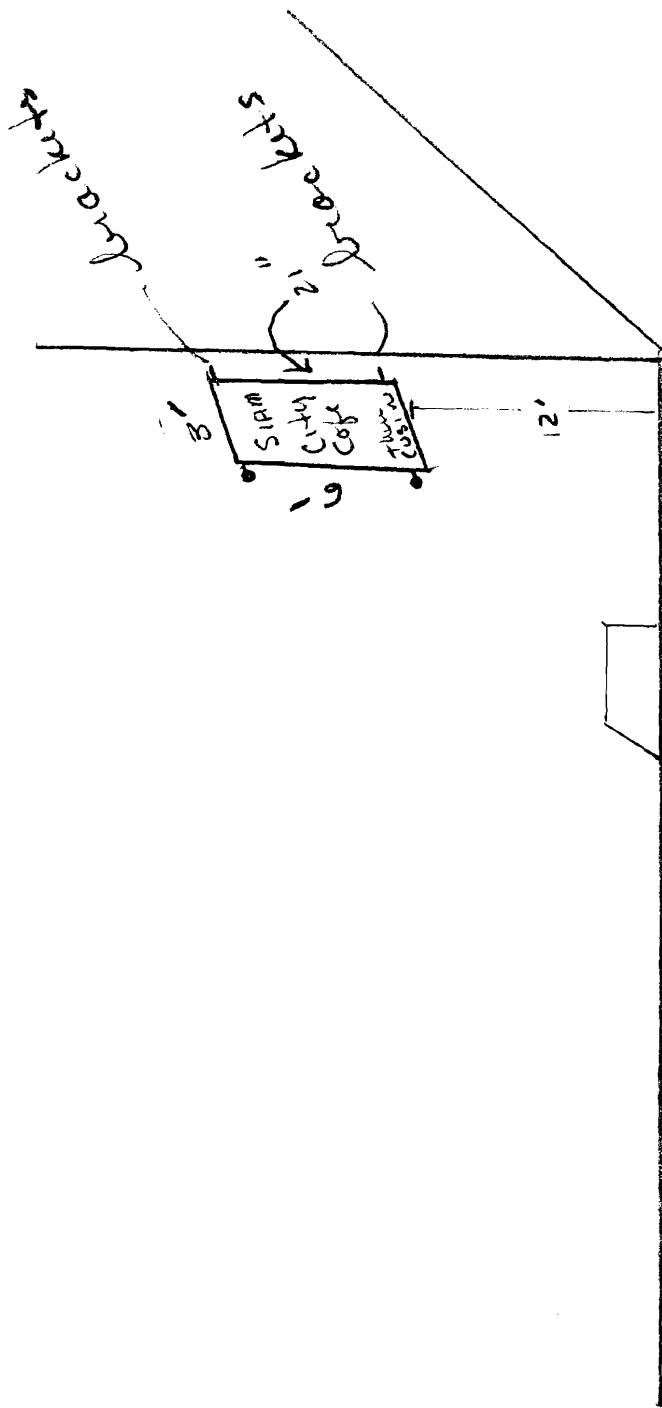

$$3 \times 6 = 18$$

Siam Restaurant
339 Fore St., Portland
Placement of Sidewalk Sandwich Board

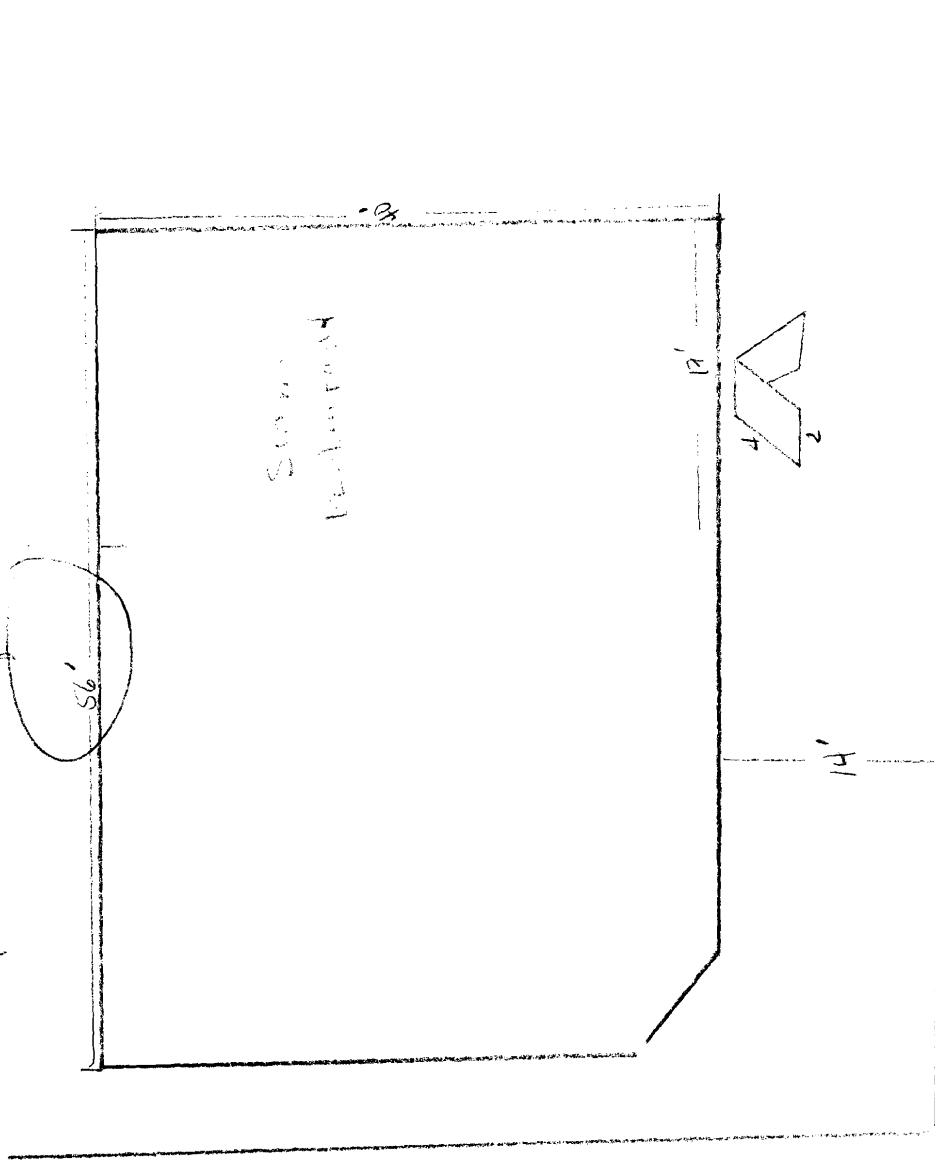

Sliver St

Fore St.

ACORD™ CERTIFICATE OF LIABILITY INSURANCE

DATE (MM/DD/YY)
09/14/2000

PRODUCER (207)774-6257 FAX (207)774-2994
Clark Associates
2331 Congress Street
P O Box 3543
Portland, ME 04104

THIS CERTIFICATE IS ISSUED AS A MATTER OF INFORMATION ONLY AND CONFERS NO RIGHTS UPON THE CERTIFICATE HOLDER. THIS CERTIFICATE DOES NOT AMEND, EXTEND OR ALTER THE COVERAGE AFFORDED BY THE POLICIES BELOW.

INSURERS AFFORDING COVERAGE

INSURED Siam City Cafe LLC
P O Box 4606
Portland, ME 04112

INSURER A United National
INSURER B
INSURER C
INSURER D
INSURER E

COVERAGES

THE POLICIES OF INSURANCE LISTED BELOW HAVE BEEN ISSUED TO THE INSURED NAMED ABOVE FOR THE POLICY PERIOD INDICATED NOTWITHSTANDING ANY REQUIREMENT, TERM OR CONDITION OF ANY CONTRACT OR OTHER DOCUMENT WITH RESPECT TO WHICH THIS CERTIFICATE MAY BE ISSUED OR MAY PERTAIN, THE INSURANCE AFFORDED BY THE POLICIES DESCRIBED HEREIN IS SUBJECT TO ALL THE TERMS, EXCLUSIONS AND CONDITIONS OF SUCH POLICIES. AGGREGATE LIMITS SHOWN MAY HAVE BEEN REDUCED BY PAID CLAIMS.

INSR LTR	TYPE OF INSURANCE	POLICY NUMBER	POLICY EFFECTIVE DATE (MM/DD/YYYY)	POLICY EXPIRATION DATE (MM/DD/YYYY)	LIMITS
A	GENERAL LIABILITY <input checked="" type="checkbox"/> COMMERCIAL GENERAL LIABILITY CLAIMS MADE <input checked="" type="checkbox"/> OCCUR	L7132972	08/07/2000	08/07/2001	EACH OCCURRENCE \$ 1,000,000
					FIRE DAMAGE (Any one fire) \$ 100,000
					MED EXP (Any one person) \$ n/a
					PERSONAL & ADV INJURY \$ 1,000,000
					GENERAL AGGREGATE \$ 2,000,000
					PRODUCTS - COM/PROP AGG \$ 1,000,000
					GEN'L AGGREGATE LIMIT APPLIES PER: <input type="checkbox"/> POLICY <input type="checkbox"/> PRO-JECT <input type="checkbox"/> LOC
	AUTOMOBILE LIABILITY <input type="checkbox"/> ANY AUTO <input type="checkbox"/> ALL OWNED AUTOS <input type="checkbox"/> SCHEDULED AUTOS <input type="checkbox"/> HIRED AUTOS <input type="checkbox"/> NON-OWNED AUTOS				COMBINED SINGLE LIMIT (Per accident) \$ BODILY INJURY (Per person) \$ BODILY INJURY (Per accident) \$ PROPERTY DAMAGE (Per accident) \$
	GARAGE LIABILITY <input type="checkbox"/> ANY AUTO				AUTO ONLY - EA ACCIDENT \$ OTHER THAN EA ACC \$ AUTO ONLY: AGG \$
	EXCESS LIABILITY <input type="checkbox"/> OCCUR <input type="checkbox"/> CLAIMS MADE <input type="checkbox"/> DEDUCTIBLE <input type="checkbox"/> RETENTION \$				EACH OCCURRENCE \$ AGGREGATE \$ \$ \$ \$
	WORKERS COMPENSATION AND EMPLOYERS' LIABILITY				WC STATU-TORY LIMITS OTHER E.L. EACH ACCIDENT \$ E.L. DISEASE - EA EMPLOYEE \$ E.L. DISEASE - POLICY LIMIT \$
	OTHER				

DESCRIPTION OF OPERATIONS/LOCATIONS/VEHICLES/EXCLUSIONS ADDED BY ENDORSEMENT/SPECIAL PROVISIONS
The certificate holder is named as additional insured with respect to sign at 339 Fore Street, Portland, ME

CERTIFICATE HOLDER	ADDITIONAL INSURED; INSURER LETTER:	CANCELLATION
City of Portland 389 Congress Street Portland, ME 04101		SHOULD ANY OF THE ABOVE DESCRIBED POLICIES BE CANCELLED BEFORE THE EXPIRATION DATE THEREOF, THE ISSUING COMPANY WILL ENDEAVOR TO MAIL 10 DAYS WRITTEN NOTICE TO THE CERTIFICATE HOLDER NAMED TO THE LEFT. BUT FAILURE TO MAIL SUCH NOTICE SHALL IMPOSE NO OBLIGATION OR LIABILITY OF ANY KIND UPON THE COMPANY, ITS AGENTS OR REPRESENTATIVES. AUTHORIZED REPRESENTATIVE Kenneth Ross <i>Kenneth Ross</i>

Siam City Cafe
339 Fore Street # Portland, ME 04101

TELEFAX TRANSMISSION

DATE: February 25, 2003 FAX No. 774-1614
TO: Gerry Knecht OF: No. Atlantic
FROM: Joseph P. Chandler CC TO: _____
Email: jchandler@mainebiotechnology.com PAGES: 1

Gerry,

Tom and I are applying to the City of Portland for additional signage for the restaurant. We would like to have a Sandwich Board that would list daily specials and announcements. The board is approximately 2' wide by 4' tall and has a simple design. It would be removed during non-working hours.

We need to get your permission for us to do this. If you approve, please sign this fax and return it to me at 797-5595. If you have any questions, please call me at work, 797-5454, ext. 11.

Thanks for your time and consideration.

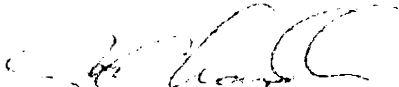
Joseph Chandler

I give my permission for Siam Restaurant to place in front of the restaurant a removable "sandwich" sign.

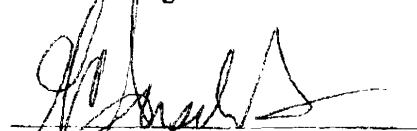
Gerald Knecht