

DISPLAY THIS CARD ON PRINCIPAL FRONTAGE OF WORK

CITY OF PORTLAND

BUILDING INSPECTION

PERMIT

Permit-Number: 090478

Please Read Application And Notes, If Any, Attached

This is to certify that WITT-T LLC /The Crooked Mile
has permission to outside seating 8 Chairs & 4 Tables
AT 37 SILVER ST CBL 029 B001001

provided that the person or persons, firm or corporation accepting this permit shall comply with all of the provisions of the Statutes of Maine and of the Ordinances of the City of Portland regulating the construction, maintenance and use of buildings and structures, and of the application on file in this department.

Apply to Public Works for street line and grade if nature of work requires such information.

Notification of inspection must be given and written permission procured before this building or part thereof is lathed or otherwise closed-in. 24 HOUR NOTICE IS REQUIRED.

A certificate of occupancy must be procured by owner before this building or part thereof is occupied.

OTHER REQUIRED APPROVALS

Fire Dept. _____
Health Dept. _____
Appeal Board _____
Other _____
Department Name

[Signature]
6/1/09
Director - Building & Inspection Services

PENALTY FOR REMOVING THIS CARD

SCANNED

City of Portland, Maine - Building or Use Permit Application
 389 Congress Street, 04101 Tel: (207) 874-8703, Fax: (207) 874-8716

| | | |
|-----------------------|-------------|---------------------|
| Permit No: 09-0478 | Issue Date: | CBL: 029 B001001 |
|-----------------------|-------------|---------------------|

| | | | |
|---|--------------------------------------|-----------------------------------|--------------|
| Location of Construction: 37 SILVER ST | Owner Name: WITT-T LLC | Owner Address: 378 LAKESIDE DR | Phone: |
| Business Name: | Contractor Name: The Crooked Mile | Contractor Address: | Phone |
| Lessee/Buyer's Name | Phone: | Permit Type: Outdoor Seating | Zone: B-3 |

| | | | | |
|--|---|---|---|--------------------|
| Past Use: Commercial "The Crooked Mile" | Proposed Use: Commercial "The Crooked Mile" - outside seating 8 Chairs & 4 Tables | Permit Fee: \$134.00 | Cost of Work: \$134.00 | CEO District: 1 |
| Proposed Project Description: outside seating 8 Chairs & 4 Tables | | FIRE DEPT: <input type="checkbox"/> Approved <input checked="" type="checkbox"/> Denied <i>N/A</i> | INSPECTION: Use Group: <input checked="" type="checkbox"/> Type: <i>outdoor seating</i> | |
| | | Signature: | Signature: | |
| PEDESTRIAN ACTIVITIES DISTRICT (P.A.D.) | | | | |
| Action: <input type="checkbox"/> Approved <input type="checkbox"/> Approved w/Conditions <input type="checkbox"/> Denied | | | | |
| Signature: _____ Date: _____ | | | | |

| | | | | |
|-----------------------------|---------------------------------|------------------------|--|--|
| Permit Taken By: Ldobson | Date Applied For: 05/20/2009 | Zoning Approval | | |
|-----------------------------|---------------------------------|------------------------|--|--|

| | | | |
|--|--|--|---|
| 1. This permit application does not preclude the Applicant(s) from meeting applicable State and Federal Rules. 2. Building permits do not include plumbing, septic or electrical work. 3. Building permits are void if work is not started within six (6) months of the date of issuance. False information may invalidate a building permit and stop all work.. | Special Zone or Reviews <input type="checkbox"/> Shoreland <input type="checkbox"/> Wetland <input type="checkbox"/> Flood Zone <input type="checkbox"/> Subdivision <input type="checkbox"/> Site Plan Maj <input type="checkbox"/> Minor <input type="checkbox"/> MM <input type="checkbox"/> Date: <i>6/1/09</i> | Zoning Appeal <input type="checkbox"/> Variance <input type="checkbox"/> Miscellaneous <input type="checkbox"/> Conditional Use <input type="checkbox"/> Interpretation <input type="checkbox"/> Approved <input type="checkbox"/> Denied Date: _____ | Historic Preservation <input type="checkbox"/> Not in District or Landmark <input checked="" type="checkbox"/> Does Not Require Review <input type="checkbox"/> Requires Review <input type="checkbox"/> Approved <input type="checkbox"/> Approved w/Conditions <input type="checkbox"/> Denied Date: <i>6/1/09</i> |
|--|--|--|---|

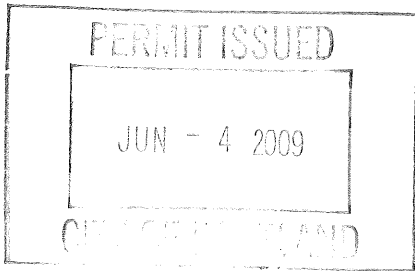

CERTIFICATION

I hereby certify that I am the owner of record of the named property, or that the proposed work is authorized by the owner of record and that I have been authorized by the owner to make this application as his authorized agent and I agree to conform to all applicable laws of this jurisdiction. In addition, if a permit for work described in the application is issued, I certify that the code official's authorized representative shall have the authority to enter all areas covered by such permit at any reasonable hour to enforce the provision of the code(s) applicable to such permit.

| | | | |
|------------------------|---------|------|-------|
| SIGNATURE OF APPLICANT | ADDRESS | DATE | PHONE |
|------------------------|---------|------|-------|

| | | |
|---|------|-------|
| RESPONSIBLE PERSON IN CHARGE OF WORK, TITLE | DATE | PHONE |
|---|------|-------|



0904730
29.B.1

Outdoor Dining Permit Application

If you or the property owner owes real estate or personal property taxes or user charges on any property within the City, payment arrangements must be made before permits of any kind are accepted.

| | | |
|--|---|--|
| <input type="checkbox"/> New Application for Outside Dining <input checked="" type="checkbox"/> Renewal Application for Outside Dining | | |
| City Clerk signature for liquor license approval: _____ or Pending Council Date _____ Location/Address of Outdoor Seating: <u>8 milk St.</u> | | |
| Total Square Footage of Proposed Seating Area ¹ <u>84sq Feet</u> | | Square Footage of Lot |
| Tax Assessor's Chart, Block & Lot Chart# Block# Lot# <u>02a B00l 00l</u> | Phone#: <u>749-7388</u> | Owner: <u>W.H. - LLC</u> |
| Applicant * must be owner or Lessee Name: <u>Joe Mcbonyl</u> Address: <u>8 milk St</u> City, State & Zip: <u>Portland ME 04101</u> | Lessee/Buyer's Name: (If Applicable) <u>Joe Mcbonyl</u> | Annual Fee: \$80 Total Sq. Ft. Sq. Ft. Fee: \$ Total Fee: \$ |
| Current use: <u>Coffee Shop / cafe</u> Business name: <u>The Crooked Mile</u> Seating area dimensions: _____ How many chairs? <u>8</u> How many tables? <u>4</u> <input type="checkbox"/> Yes Alcohol is served. <input checked="" type="checkbox"/> No Alcohol being served. | | |
| Who should we contact for the pre-inspection: <u>Joe Mcbonyl</u> Mailing address: <u>8 milk St</u> Phone: <u>749-7388</u> | | |

MAY 20 2009

Please submit all of the information outlined in the Outdoor Dining Application Checklist. Failure to do so will result in the automatic denial of your permit.

In order to be sure the City fully understands the full scope of the project, the Planning and Development Department may request additional information prior to the issuance of a permit. For further information visit us on-line at www.portlandmaine.gov, stop by the Building Inspections office, room 315 City Hall or call 874-8703.

I hereby certify that I am the Owner of record of the named property, or that the owner of record authorizes the proposed work and that I have been authorized by the owner to make this application as his/her authorized agent. I agree to conform to all applicable laws of this jurisdiction. In addition, if a permit for work described in this application is issued, I certify that the Code Official's authorized representative shall have the authority to enter all areas covered by this permit at any reasonable hour to enforce the provisions of the codes applicable to this permit.

Signature of Applicant:

Date:

5-20-09

¹ In no instance shall the total square footage of dining area equal more than 10% of park space, unless the applicant receives a waiver from the Director of Parks and Recreation or his or her designee. **This is not a permit; you may not commence ANY work until the permit is issued.**

CITY OF PORTLAND
DEPARTMENT OF PLANNING & URBAN DEVELOPMENT

389 Congress Street
 Portland, Maine 04101

INVOICE FOR PERMIT FEES

| | |
|--|-------------------------------|
| Application No: 9-0478 | Applicant: WITT-T LLC |
| Project Name: outside seating 8 Chairs & 4 Tables | Location: 37 SILVER ST |
| CBL: 029 B001001 | Development Type: |
| Invoice Date: 05/29/2009 | |

| | | | | | | | | | |
|-------------------------|---|-------------------------|---|---------------------|---|------------------------|---|------------------|-------------------------|
| Previous Balance | - | Payment Received | + | Current Fees | - | Current Payment | = | Total Due | Payment Due Date |
| \$0.00 | | \$0.00 | | \$134.00 | | \$0.00 | | \$134.00 | On Receipt |

First Billing

Previous Balance **\$0.00**

| Fee Description | Qty | Fee/Deposit Charge |
|--------------------------|--------------------------------|---------------------------|
| Outside Seating Sidewalk | 27 | \$54.00 |
| Outside Seating | 1 | \$80.00 |
| | | <hr/> \$134.00 |
| | Total Current Fees: | + \$134.00 |
| | Total Current Payments: | - \$0.00 |
| | Amount Due Now: | <hr/> \$134.00 |

 Detach and remit with payment

Bill to: WITT-T LLC
 378 LAKESIDE DR
 BOOTHBAY HARBOR, ME 04538

CBL 029 B001001
Application No: 9-0478
Invoice Date: 05/29/2009
Invoice No: 34657
Total Amt Due: \$134.00
Payment Amount:

Make checks payable to the *City of Portland*, ATTN: Inspections, 3rd Floor, 389 Congress Street, Portland, ME 04101.

CITY OF PORTLAND
DEPARTMENT OF PLANNING & URBAN DEVELOPMENT

389 Congress Street
Portland, Maine 04101

INVOICE FOR PERMIT FEES

| | | | |
|------------------------|-------------------------------------|--------------------------|--------------|
| Application No: | 9-0478 | Applicant: | WITT-T LLC |
| Project Name: | outside seating 8 Chairs & 4 Tables | Location: | 37 SILVER ST |
| CBL: | 029 B001001 | Development Type: | |
| Invoice Date: | 05/29/2009 | | |

| | | | | | | | | | |
|-------------------------|---|-------------------------|---|---------------------|---|------------------------|---|------------------|-------------------------|
| Previous Balance | - | Payment Received | + | Current Fees | - | Current Payment | = | Total Due | Payment Due Date |
| \$0.00 | | \$0.00 | | \$134.00 | | \$0.00 | | \$134.00 | On Receipt |

First Billing

| | |
|-------------------------|---------------|
| Previous Balance | \$0.00 |
|-------------------------|---------------|

| Fee Description | Qty | Fee/Deposit Charge |
|--------------------------|--------------------------------|--------------------|
| Outside Seating Sidewalk | 27 | \$54.00 |
| Outside Seating | 1 | \$80.00 |
| | | \$134.00 |
| | Total Current Fees: | + \$134.00 |
| | Total Current Payments: | - \$0.00 |
| | Amount Due Now: | \$134.00 |

Detach and remit with payment

Bill to: WITT-T LLC
378 LAKESIDE DR
BOOTHBAY HARBOR, ME 04538

CBL 029 B001001
Application No: 9-0478
Invoice Date: 05/29/2009
Invoice No: 34657
Total Amt Due: \$134.00
Payment Amount:

Make checks payable to the *City of Portland*, ATTN: Inspections, 3rd Floor, 389 Congress Street, Portland, ME 04101.



$$\begin{array}{r} 2 \\ 27 \\ 3 \\ \hline 81.50 \text{ FT} \end{array}$$
 SMH

3 FT X
 27 FT

Crowned Milk
 SMH 5/26/09

MILK ST.

- 2 chairs at each table - Total 8
- 3 tables on the Milk St side - 24 inches wide
- 1 table on the Silver St. side "

building = 41 x 58 feet
 sidewalk = 9 feet wide



MILK ST.

- 2 chairs at each table - Total 8
- 3 tables on the MILK ST side - 24 inches wide
- 1 table on the SILVER ST. side "

building = 41 x 58 feet
 sidewalk = 9 feet wide



OUTDOOR DINING PERMIT CHECKLIST

Permits are required for expanding food service establishments to the outside on City Property. The annual fee is \$80.00 plus \$2.00 per square foot of dining area on streets, sidewalks or other public ways and \$80.00 plus \$6.00 per square foot of dining area in city parks. For purposes of fee calculation, the area abutting the buildings which border Monument Square and extending ten (10) feet from the facade of said buildings shall be considered a sidewalk. The ten (10) foot area shall be measured from that portion of the facade that protrudes furthest into the sidewalk. The area beyond the ten (10) foot sidewalk shall be considered park space.

Outdoor dining is permitted year round under the permit; however, furniture must be removed in inclement weather to allow for sidewalk snow removal. **The permit must be renewed each year.**

All of the following information is required and must be submitted. You will also be required to fill out an Outdoor Dining Permit Application.

A plot plan is required and must include:

- A drawing of the lot, where the building sits on the lot along with the lot and building dimensions
 - The dimensional setback from the sidewalk to the building
 - The location of the street, and if it's a corner lot, the intersecting streets
 - The sidewalk along with its width and curbing location
 - The location of the table and chair placement, including dimensions
- (NOTE: there must be a minimum of four feet of open sidewalk from the outer boundary of the seating area to the curb, and a minimum of five feet on corners, and egress from the building must be maintained free of obstruction per the building code and NFPA Life Safety Code).

Additional Requirements:

- The permit holder is required to produce, at the time of submission, and maintain public liability insurance coverage in an amount of not less than four hundred thousand dollars (\$400,000) combined single limit for bodily injury, death and property damage, naming the City as an additional insured thereon.

All permits for outdoor dining are issued subject to the following conditions:

- The tables and chairs must be placed within the permitted area on the sidewalk in such a manner as to allow the free and safe passage of pedestrian traffic. If the tables and chairs are moved and located outside of the permitted outdoor seating area, they must be relocated to within the permitted area. Failure to contain the tables and chairs to the permitted area may result in a reduced permitted area or a revocation of the permit.

- The permit holder is responsible for keeping the outdoor seating area clean. The sidewalk area where the tables and chairs are located must be kept neat and free from litter and debris.
- No food shall be prepared outside.
- If alcohol is to be served, the permit holder must notify the City's Business Licensing Office in room 203 of City Hall or by telephone at 874-8557 and obtain approval for the service of alcohol outdoors. Additionally, State law requires that any outdoor area serving alcohol be segregated from the rest of the public.
- All tables and chairs shall be removed prior to a predicted snowfall and while any snow or ice exists within the designated outdoor seating area or within four feet from the boundaries thereof. The City will not be responsible for damage to any tables, chairs or other property that is not properly removed when the City is engaged in sidewalk maintenance activities.
- The permit holder shall comply with all applicable rules and regulations implemented by the city regarding outdoor dining.

Failure to comply with any of the above conditions will result in revocation or non-renewal of the permit.

I/We fully understand that the City of Portland, its agents, officers and employees accept no responsibility and will not be liable for any injury, harm or damage to my/our person or property arising out of the establishment's occupancy of the sidewalk or park space. To the fullest extent permitted by law, I/We do hereby agree to assume all risk of injury, harm or damage to my/our person or property (including but not limited to all risk of injury, harm or damage to my/our property cause by the negligence of the City of Portland, its agents, officers or employees) arising out of the establishment's occupancy of the sidewalk or park space. I/We hereby agree, to the fullest extent permitted by law, to defend, indemnify and hold harmless the City of Portland, its agents, officers and employees, from and against all claims, damages, losses and expenses, just or unjust, including, but not limited to costs of defense and attorney's fees, arising out of the establishment's occupancy of the sidewalk or park space, provided that any such claims, damage, loss or expense (1) is attributable to bodily injury, sickness, disease, or death, or to injury to or destruction of tangible property including the loss of use there from, and (2) is caused in whole or in part by any negligent act or omission of the establishment, anyone directly or indirectly employed by it, or anyone for whose act it may be liable.

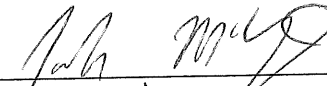
Signed and acknowledged:  Date: May 20 09
 Printed name Joseph McLaughlin
 Establishment The Clocks mile
 Location 8 mile St portland 04101

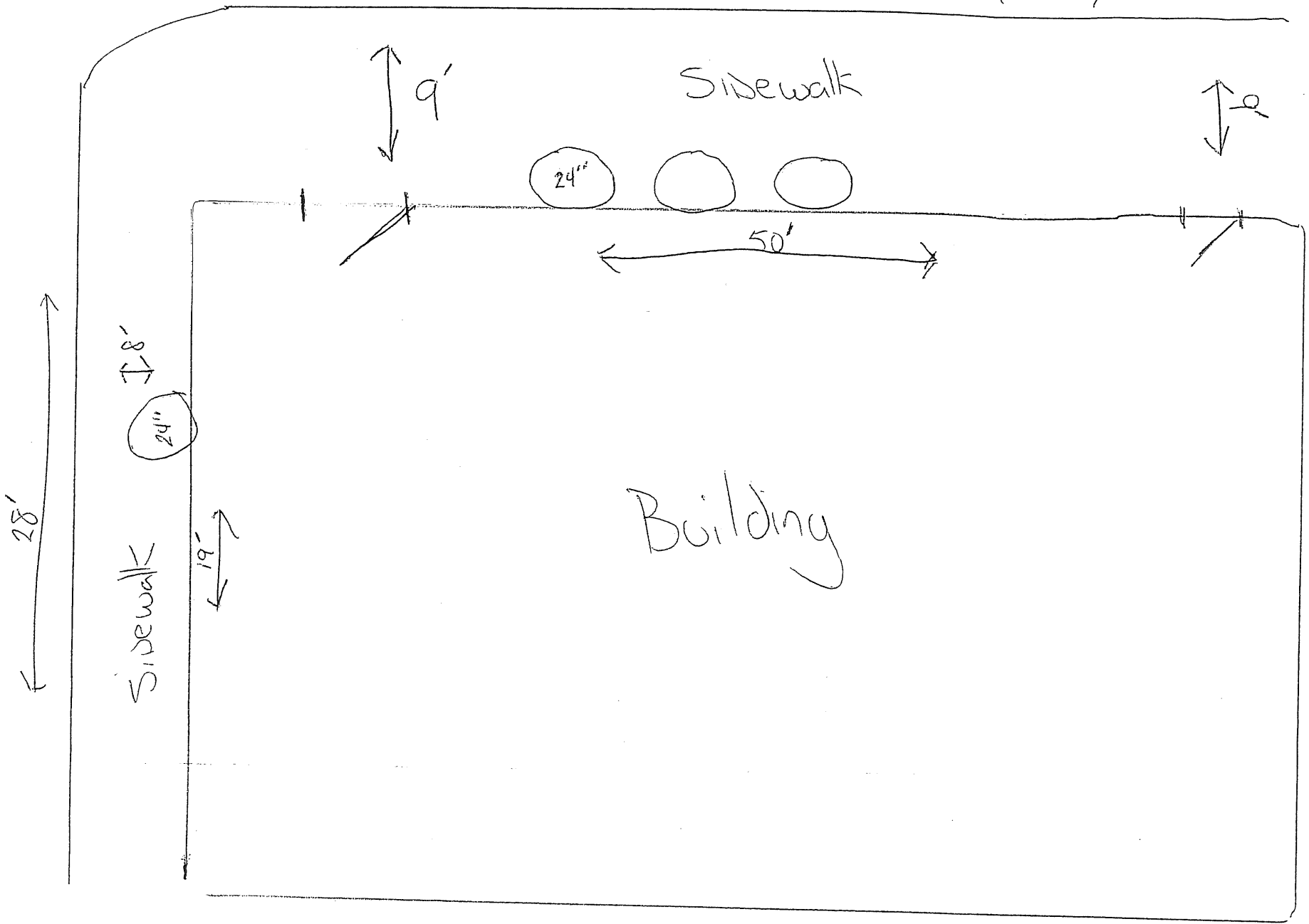

COMMERCIAL PROTECTOR COVERAGE FORM DECLARATIONS (Continued)
BUSINESSOWNERS COVERAGE FORM DECLARATIONS

LIABILITY AND MEDICAL PAYMENTS COVERAGE

Except for Fire Legal Liability, each paid claim for the following coverages reduces the amount of insurance we provide during the applicable annual period. Please refer to Paragraph D.4. of the Section II LIABILITY of the COMMERCIAL PROTECTOR COVERAGE FORM (BUSINESSOWNERS COVERAGE FORM).

| Coverage | Limits of Insurance |
|---|--|
| LIABILITY AND MEDICAL EXPENSES | \$ 2,000,000 Per Occurrence |
| MEDICAL EXPENSES | \$ 5,000 Per Person |
| DAMAGE TO PREMISES RENTED TO YOU | \$ 50,000 Any One Fire or Explosion |
| AGGREGATE LIMITS | |
| BODILY INJURY OR PROPERTY DAMAGE UNDER PRODUCTS/COMPLETED OPERATIONS HAZARD | \$ 4,000,000 |
| ALL OTHER INJURY OR DAMAGE (INCLUDING MEDICAL EXPENSES) | \$ 4,000,000 |

LIABILITY OPTIONAL COVERAGES

| Coverage | Limits of Insurance |
|--------------------------|---------------------|
| HIRED AUTO LIABILITY | I NCLUDED |
| NON-OWNED AUTO LIABILITY | I NCLUDED |

FORMS AND ENDORSEMENTS APPLICABLE TO THIS POLICY:

(Applicable Forms and Endorsements are omitted if shown in specific Coverage Part/Coverage Form Declarations)

| Form Number | Description |
|-------------|---|
| 17-98 | - 0604 EXCLUSION - ASBESTOS |
| 44-105 | - 0604 QUICK REFERENCE - COMMERCIAL PROTECTOR COVERAGE FORM |
| 44-115 | - 0604 COMMERCIAL PROTECTOR COVERAGE FORM |
| 44-139 | - 0604 ADDITIONAL INSURED GRANTOR OF FRANCHISE |
| 44-146 | - 0604 COMMERCIAL PROTECTOR EXTENSION PLUS ENDORSEMENT |
| 44-148 | - 0604 COMMERCIAL PROTECTOR LIABILITY EXTENSION ENDORSEMENT |
| 44-175 | - 0108 CAP ON LOSSES FROM CERTIFIED ACTS OF TERRORISM |
| 44-189 | - 0604 EXCLUSION OF CERTIFIED ACTS OF TERRORISM |
| 44-190 | - 0108 EXCLUSION OF PUNITIVE DAMAGES OF CERT ACTS OF TERROR |
| 44-192 | - 0604 WAR LIABILITY EXCLUSION |
| 44-200 | - 0204 EXCLUSION - SILICA |
| 44-207 | - 0305 EXCLUSION-VIOLATION OF STATUTES |
| 44-50 | - 0604 HIRED AUTO AND NON-OWNED AUTO LIABILITY |
| BP0148 | - 1002 MAINE CHANGES |
| BP0185 | - 0702 ME INS INSPECTION SVCS EXEMPTION FROM LIABILITY |
| BP0193 | - 0702 ME BUSINESSOWNERS STANDARD FIRE POLICY PROVISIONS |
| BP0417 | - 0702 EMPLOYMENT-RELATED PRACTICES EXCLUSION |
| BP0501 | - 0702 CALCULATION OF PREMIUM |
| BP0564 | - 0107 CONDITIONAL EXCLUSION OF TERRORISM |
| BP0576 | - 1102 LIMITED FUNGI OR BACTERIA COVERAGE |
| BP0577 | - 1102 FUNGI OR BACTERIA EXCLUSION |
| BP0601 | - 0107 EXCLUSION OF LOSS DUE TO BACTERIA |
| BP1212 | - 0702 MAINE EFFECTIVE TIME CHANGES/REPLACEMENT OF 12 NOON |
| IL0247 | - 0498 MAINE CHANGES-CANCELLATION AND NONRENEWAL |

44-98 (06/04)

RENEWAL



EFFECTIVE DATE: 03/24/2009

| | |
|---|--|
| Policy Number: BOP8011151 | Prior Policy: 8011151 |
| Billing Type: DIRECT BILL | |
| Coverage Is Provided In PEERLESS INSURANCE COMPANY - A STOCK COMPANY | |
| Named Insured and Mailing Address: EGBERT INC DBA THE CROOKED MILE 8 MILK ST PORTLAND ME 04101 | Agent: HOLDEN AGENCY PO BOX 10610 1085 BRIGHTON AVE PORTLAND ME 04104 Agent Code: 0310128 Agent Phone: (207)-775-3793 |

**COMMERCIAL PROTECTOR COVERAGE FORM DECLARATIONS
BUSINESSOWNERS COVERAGE FORM DECLARATIONS**

In return for the payment of premium, and subject to all the terms of this policy, we agree with you to provide the insurance as stated in this policy.

POLICY PERIOD: From: 03/24/2009 To: 03/24/2010 at 12:01 AM Standard Time at your mailing address shown above.

FORM OF BUSINESS: CORPORATION

BUSINESS DESCRIPTION: COFFEE SHOP

DESCRIPTION OF PREMISES

| Prem. No. | Bldg. No. | Location Occupancy, Construction/Fire Protection |
|-----------|-----------|--|
| 001 | 001 | 8 MILK ST PORTLAND ME 04101 DELICATESSENS - NO FRYING ON PREMISES JOISTED MASONRY |

PROPERTY COVERAGE (Business Income is included as an Additional Coverage not subject to the limits below, please refer to your policy and endorsements for coverage details and limitations)

| Prem. No. | Bldg. No. | Coverage | Limits of Insurance |
|-----------|-----------|----------------------------|---------------------|
| 001 | 001 | BUSINESS PERSONAL PROPERTY | \$ 23,877 |

DEDUCTIBLE: \$ 250 In Any One Occurrence

AUTOMATIC INCREASE: Building Coverage Shall Be Increased Annually.
Personal Property Coverage Shall Be Increased 2% Annually.

MORTGAGE HOLDERS: NONE

PROPERTY OPTIONAL COVERAGES

| Coverage | Additional Limits of Insurance |
|--|--------------------------------|
| COMMERCIAL PROTECTOR COVERAGE EXTENSION PLUS | I NCLUDED |

44-98 (06/04)

Forming a part of

| | |
|---|---|
| Policy Number: BOP 8011151 | |
| Coverage Is Provided In PEERLESS INSURANCE COMPANY - A STOCK COMPANY | |
| Named Insured: EGBERT INC DBA THE CROOKED MILE | Agent: HOLDEN AGENCY Agent Code: 0310128 Agent Phone: (207)-775-3793 |

DECLARATIONS EXTENSION

THE FOLLOWING IS ADDITIONAL INSURED - GRANTOR OF
FRANCHISE:

CITY OF PORTLAND
389 PORTLAND ST
PORTLAND, ME 04103

Date Issued:02/10/2009



Outdoor Dining Permit Application

If you or the property owner owes real estate or personal property taxes or user charges on any property within the City, payment arrangements must be made before permits of any kind are accepted.

| | |
|--|--|
| Location/Address of Outdoor Seating: <u>37 Silver St / 8 mile St</u> | |
| Total Square Footage of Proposed Seating Area ¹ <u>32</u> | Square Footage of Lot |
| Tax Assessor's Chart, Block & Lot Chart# <u>029</u> Block# <u>B001</u> Lot# <u>001</u> | Owner: <u>W.H.H. - LLC</u> |
| Lessee/Buyer's Name (If Applicable) <u>Joe Mcbonyl</u> | Applicant * must be owner or Lessee Name <u>Joseph Mcbonyl</u> Address <u>8 mile St</u> City, State & Zip <u>04101</u> |
| | Telephone: <u>749-7388</u> Annual Fee: <u>\$80</u> Sq Ft Fee: <u>84 SQ FT</u> Total Fee: \$ _____ |
| Current use: <u>Coffee shop / cafe</u> | |
| Business name: <u>The Crooked mile</u> | |
| Seating area dimensions: _____ | |
| How many chairs? <u>8</u> | How many tables? <u>4</u> |
| Alcohol to be served outside? circle one : YES <input type="radio"/> NO <input checked="" type="radio"/> | |
| Who should we contact for the pre-inspection: <u>Joe Mcbonyl</u> | |
| Mailing address: <u>8 mile St Portland</u> | Phone: <u>749-7388</u> |

3x28'
Asse
SMH

Please submit all of the information outlined in the Outdoor Dining Application Checklist. Failure to do so will result in the automatic denial of your permit.

In order to be sure the City fully understands the full scope of the project, the Planning and Development Department may request additional information prior to the issuance of a permit. For further information visit us on-line at www.portlandmaine.gov, stop by the Building Inspections office, room 315 City Hall or call 874-8703.

I hereby certify that I am the Owner of record of the named property, or that the owner of record authorizes the proposed work and that I have been authorized by the owner to make this application as his/her authorized agent. I agree to conform to all applicable laws of this jurisdiction. In addition, if a permit for work described in this application is issued, I certify that the Code Official's authorized representative shall have the authority to enter all areas covered by this permit at any reasonable hour to enforce the provisions of the codes applicable to this permit.

Joe Mcbonyl
Signature of Applicant

5-15-88
Date

This is **not** a permit; you may not commence ANY work until the permit is issued.

¹ In no instance shall the total square footage of dining area equal more than 10% of park space, unless the applicant receives a waiver from the Director of Parks and Recreation or his or her designee.

City of Portland, Maine - Building or Use Permit Application

389 Congress Street, 04101 Tel: (207) 874-8703, Fax: (207) 874-8716

| | | |
|-----------------------|-------------|---------------------|
| Permit No: 08-0537 | Issue Date: | CBL: 029 B001001 |
|-----------------------|-------------|---------------------|

| | | | |
|---|---------------------------|-----------------------------------|--------------|
| Location of Construction: 37 SILVER ST | Owner Name: WITT-T LLC | Owner Address: 378 LAKESIDE DR | Phone: |
| Business Name: | Contractor Name: | Contractor Address: | Phone: |
| Lessee/Buyer's Name | Phone: | Permit Type: Outdoor Seating | Zone: B-3 |

| | | | | |
|---|---|---|---|--------------------|
| Past Use: Commercial - The Crooked Mile | Proposed Use: Commercial - The Crooked Mile - Outside seating 4 Tables & 8 Chairs 84 Square feet | Permit Fee: \$248.00 | Cost of Work: \$0.00 | CEO District: 1 |
| Proposed Project Description: Outside seating 4 Tables & 8 Chairs, 84 Square feet. | | FIRE DEPT: <input type="checkbox"/> Approved <input type="checkbox"/> Denied | INSPECTION: Use Group: <i>A2</i> Type: <i>Outdoor Dining</i> Signature: <i>JMB 5/27/08</i> | |
| PEDESTRIAN ACTIVITIES DISTRICT (P.A.D.) Action: <input type="checkbox"/> Approved <input type="checkbox"/> Approved w/Conditions <input type="checkbox"/> Denied Signature: _____ Date: _____ | | | | |

| | |
|-----------------------------|---------------------------------|
| Permit Taken By: Idobson | Date Applied For: 05/20/2008 |
|-----------------------------|---------------------------------|

Zoning Approval

| | | | |
|---|--|---|---|
| <p>1. This permit application does not preclude the Applicant(s) from meeting applicable State and Federal Rules.</p> <p>2. Building permits do not include plumbing, septic or electrical work.</p> <p>3. Building permits are void if work is not started within six (6) months of the date of issuance. False information may invalidate a building permit and stop all work..</p> | <p>Special Zone or Reviews</p> <input type="checkbox"/> Shoreland <input type="checkbox"/> Wetland <input type="checkbox"/> Flood Zone <input type="checkbox"/> Subdivision <input type="checkbox"/> Site Plan Maj <input type="checkbox"/> Minor <input type="checkbox"/> MM <input type="checkbox"/> Date: <i>5/27/08</i> | <p>Zoning Appeal</p> <input type="checkbox"/> Variance <input type="checkbox"/> Miscellaneous <input type="checkbox"/> Conditional Use <input type="checkbox"/> Interpretation <input type="checkbox"/> Approved <input type="checkbox"/> Denied Date: _____ | <p>Historic Preservation</p> <input type="checkbox"/> Not in District or Landmark <input type="checkbox"/> Does Not Require Review <input type="checkbox"/> Requires Review <input type="checkbox"/> Approved <input type="checkbox"/> Approved w/Conditions <input type="checkbox"/> Denied Date: _____ |
|---|--|---|---|

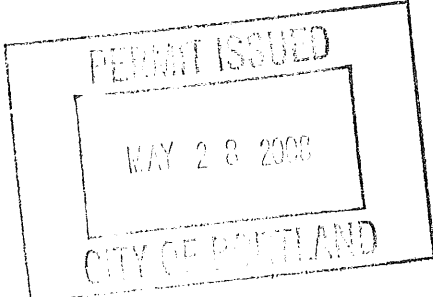

CERTIFICATION

I hereby certify that I am the owner of record of the named property, or that the proposed work is authorized by the owner of record and that I have been authorized by the owner to make this application as his authorized agent and I agree to conform to all applicable laws of this jurisdiction. In addition, if a permit for work described in the application is issued, I certify that the code official's authorized representative shall have the authority to enter all areas covered by such permit at any reasonable hour to enforce the provision of the code(s) applicable to such permit.

| | | | |
|---|---------|------|-------|
| SIGNATURE OF APPLICANT | ADDRESS | DATE | PHONE |
| RESPONSIBLE PERSON IN CHARGE OF WORK, TITLE | | DATE | PHONE |

City of Portland, Maine - Building or Use Permit

389 Congress Street, 04101 Tel: (207) 874-8703, Fax: (207) 874-8716

| | | |
|-----------------------|---------------------------------|---------------------|
| Permit No: 09-0478 | Date Applied For: 05/20/2009 | CBL: 029 B001001 |
|-----------------------|---------------------------------|---------------------|

| | | | |
|---|--------------------------------------|-----------------------------------|--------|
| Location of Construction: 37 SILVER ST | Owner Name: WITT-T LLC | Owner Address: 378 LAKESIDE DR | Phone: |
| Business Name: | Contractor Name: The Crooked Mile | Contractor Address: | Phone |
| Lessee/Buyer's Name | Phone: | Permit Type: Outdoor Seating | |

| | |
|--|--|
| Proposed Use: Commercial "The Crooked Mile" - outside seating 8 Chairs & 4 Tables | Proposed Project Description: outside seating 8 Chairs & 4 Tables |
|--|--|

Dept: Zoning **Status:** Approved with Conditions **Reviewer:** Tammy Munson **Approval Date:** 06/01/2009

Note: **Ok to Issue:**

- 1) All outdoor seating is subject to adjustment at any time from the City's traffic engineer who ensures that the City sidewalk is open and cleared for pedestrian use.

Dept: Building **Status:** Approved with Conditions **Reviewer:** Tammy Munson **Approval Date:** 06/01/2009

Note: **Ok to Issue:**

- 1) This permit approves outside seating only. Any alcohol or entertainment in this space requires licensing approvals from the City Clerk.
- 2) The outside dining permit is approved for the area delineated at the inspection and stated on the permit, and must be kept on site.
THIS PERMIT MUST BE RENEWED ANNUALLY
- 3) The tables and chairs must not block any means of egress of any building, even during storage.