

DISPLAY THIS CARD ON PRINCIPAL FRONTAGE OF WORK



CITY OF PORTLAND BUILDING PERMIT



This is to certify that

WITT-T LLC /self (lessee)

Located at

37 SILVER ST

PERMIT ID: 2013-00386

CBL: 029 B001001

has permission to **A frame sign permit; 6' total**

provided that the person or persons, firm or corporation accepting this permit shall comply with all of the provisions of the Statues of Maine and of the Ordinances of the City of Portland regulating the construction, maintenance and use of the buildings and structures, and of the application on file in the department.

Notification of inspection and written permission procured before this building or part thereof is lathed or otherwise cloed-in. 48 HOUR NOTICE IS REQUIRED.

A final inspection must be completed by owner before this building or part thereof is occupied. If a certificate of occupancy is required, it must be procured prior to occupancy.

N/A

Fire Prevention Officer

Mary Schmitt 2/28/13

Code Enforcement Officer / Plan Reviewer

**THIS CARD MUST BE POSTED ON THE STREET SIDE OF THE PROPERTY
THERE IS A PENALTY FOR REMOVING THIS CARD**

City of Portland, Maine - Building or Use Permit Application

389 Congress Street, 04101 Tel: (207) 874-8703, Fax: (207) 874-8716

Permit No: 2013-00386	Issue Date: 02/28/2013	CBL: 029 B001001
--------------------------	---------------------------	---------------------

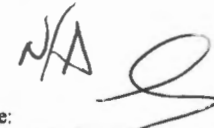
Location of Construction: 37 SILVER ST	Owner Name: WITT-T LLC	Owner Address: 378 LAKESIDE DR BOOTHBAY HARBOR, ME 04538		Phone:
Business Name: The North Point	Contractor Name: self (lessee)	Contractor Address: 35 Silver Street Portland ME		Phone (207) 831-5317
Lessee/Buyer's Name Dan Talmatch	Phone: (207) 831-5317	Permit Type: Signs - Side Walk		Zone: B3
Past Use: restaurant	Proposed Use: ISame: Restaurant	Permit Fee: \$26.20	Cost of Work: \$0.00	CEO District: 2
Proposed Project Description: A frame sign permit; 6' total		FIRE DEPT: <input type="checkbox"/> Approved <input type="checkbox"/> Denied <input checked="" type="checkbox"/> N/A		INSPECTION: Use Group: Type:
		Signature: 		Signature: 
PEDESTRIAN ACTIVITIES DISTRICT (P.A.D.)				
Action: <input type="checkbox"/> Approved <input type="checkbox"/> Approved w/Conditions <input type="checkbox"/> Denied				
Signature: Date:				

Permit Taken By: bjs	Date Applied For: 02/26/2013	Zoning Approval		
--------------------------------	--	------------------------	--	--

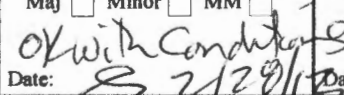
<ol style="list-style-type: none"> This permit application does not preclude the Applicant(s) from meeting applicable State and Federal Rules. Building permits do not include plumbing, septic or electrical work. Building permits are void if work is not started within six (6) months of the date of issuance. False information may invalidate a building permit and stop all work.. 	Special Zone or Reviews <input type="checkbox"/> Shoreland <input type="checkbox"/> Wetland <input type="checkbox"/> Flood Zone <input type="checkbox"/> Subdivision <input type="checkbox"/> Site Plan Maj <input type="checkbox"/> Minor <input type="checkbox"/> MM <input type="checkbox"/>	Zoning Appeal <input type="checkbox"/> Variance <input type="checkbox"/> Miscellaneous <input type="checkbox"/> Conditional Use <input type="checkbox"/> Interpretation <input type="checkbox"/> Approved <input type="checkbox"/> Denied	Historic Preservation <input type="checkbox"/> Not in District or Landmark <input type="checkbox"/> Does Not Require Review <input type="checkbox"/> Requires Review <input type="checkbox"/> Approved <input type="checkbox"/> Approved w/Conditions <input type="checkbox"/> Denied
	Date:  2/28/13	Date:	Date:

CERTIFICATION

I hereby certify that I am the owner of record of the named property, or that the proposed work is authorized by the owner of record and that I have been authorized by the owner to make this application as his authorized agent and I agree to conform to all applicable laws of this jurisdiction. In addition, if a permit for work described in the application is issued, I certify that the code official's authorized representative shall have the authority to enter all areas covered by such permit at any reasonable hour to enforce the provision of the code(s) applicable to such permit.

SIGNATURE OF APPLICANT	ADDRESS	DATE	PHONE
RESPONSIBLE PERSON IN CHARGE OF WORK, TITLE		DATE	PHONE



Sign Permit Application

If you or the property owner owes real estate or personal property taxes or any other charges on any property within the City, payment arrangement **MUST** be made before permits are accepted.

Location/Address: 35 Silver St.			Telephone:
Tax Assessor's Chart/Block/Lot (CBL)	OWNER Name/Address:		
Chart: Block: Lot:	THOMAS WITT		207-380-6940
LEASEE/BUYER Name (if Applicable)	CONTRACTOR name, address/phone	Total S.F. signage \$1.2e	
DANIEL TALMACH		(SF= 6' x \$2.00)	
4 THE NORTH POINT		Sign Fee: \$25	
		(Sidewalk=\$25)	
		(Regular = \$30)	
			(S.F. fee + Sign Fee) = TOTAL FEE: \$26.20

Who should we contact when the permit is ready: Name: DAN TALMACH Phone: 207-831-5317
Address: 35 SILVER ST. PORTLAND ME 04101

Tenant/allocated building space frontage (in feet): Length: 15' Height: 12'
Lot frontage (in feet): 20 Single Tenant or Multi-Tenant Lot: MULTI

Current Specific Use: RESTAURANT + BAR
If vacant, what was prior use: _____
Proposed Use: _____

Information on proposed sign(s)
Freestanding (e.g. pole) sign? YES NO Dimensions proposed: 8' x 8' (sf); Height from grade: _____ sf
BLDG Wall Sign (attached to bldg.)? YES NO Dimensions proposed: _____ sf

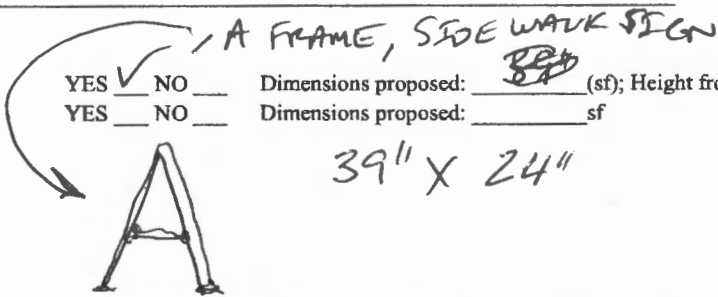

A site sketch and building sketch showing exactly where existing and proposed signage is located **MUST** be provided. Sketches and/or pictures of proposed signage and existing building are also required.

Please submit all information outlined in the Sign/Awning Application Checklist. Failure to do so may result in the denial of your permit.

In order to be sure the City fully understands the full scope of the project, the Planning and Development Department may request additional information prior to the issuance of a permit. For further information, visit us on-line at WWW.PORTLANDMAINE.GOV, stop by the Building Inspections Office, room 315 City Hall, or call 207-874-8703.

I hereby certify I am the Owner of record of the named property, or that the owner of record authorizes the proposed work and that I have been authorized by the owner to make this application as his/her authorized agent. I agree to conform to all applicable laws of this jurisdiction. In addition, if a permit for work described in this application is issued, I certify that the Code Official's authorized representative shall have the authority to enter all areas covered by this permit at any reasonable hour to enforce the provisions of the codes applicable to this permit.

Signature of Applicant: Date: 2/25/2013

EFFECTIVE DATE: 10/25/2012

Policy Number: BOP1075523 **Prior Policy:**

Billing Type: DIRECT BILL

Coverage Is Provided In PEERLESS INDEMNITY INSURANCE COMPANY

Named Insured and Mailing Address: THE NORTH POINT LLC DBA THE NORTH POINT 35 SILVER ST PORTLAND ME 04101	Agent: ANDERSON-WATKINS ASSOC INC 31 CENTRAL ST WESTBROOK ME 04092-2810 Agent Code: 8210570 Agent Phone: (207)-856-5500
--	--

**COMMERCIAL PROTECTOR COVERAGE FORM DECLARATIONS
BUSINESSOWNERS COVERAGE FORM DECLARATIONS**

In return for the payment of premium, and subject to all the terms of this policy, we agree with you to provide the insurance as stated in this policy.

POLICY PERIOD: From: 10/25/2012 To: 10/25/2013 at 12:01 AM Standard Time at your mailing address shown above.

FORM OF BUSINESS: LIMITED LIABILITY COMPANY

BUSINESS DESCRIPTION: DELI RESTAURANT SERVING LIQUOR

DESCRIPTION OF PREMISES

Prem. No.	Bldg. No.	Location Occupancy, Construction/Fire Protection
001	001	35 SILVER STREET PORTLAND ME 04101 DELICATESSENS - NO FRYING ON PREMISES JOISTED MASONRY

PROPERTY COVERAGE (Business Income is included as an Additional Coverage not subject to the limits below, please refer to your policy and endorsements for coverage details and limitations)

Prem. No.	Bldg. No.	Coverage	Limits of Insurance
001	001	BUSINESS PERSONAL PROPERTY	\$ 25,000
DEDUCTIBLE:		\$ 500 In Any One Occurrence	

AUTOMATIC INCREASE: Building Coverage Shall Be Increased Annually.
Personal Property Coverage Shall Be Increased 2% Annually.

MORTGAGE HOLDERS: NONE

PROPERTY OPTIONAL COVERAGES

Coverage	Additional Limits of Insurance
COMMERCIAL PROTECTOR COVERAGE EXTENSION	Additionally Insured : "The City of Portland" Max Benefit: \$400,000 per occurrence "Thomas Witt", Landlord Max Benefit : \$500,000 per occurrence

44-98 (06/04)

INSURED COPY



Sign Permit Application

Sidewalk Sign Permit

One sign per establishment for each street frontage having a public entrance, provided that all dimension and location standards are met. When standards would not otherwise permit a sign, a sign may consist of multiple listings.

Sign Dimensions

Single Listing: Maximum width is 24 inches or such lesser width sufficient to retain 4 ½ feet of unobstructed sidewalk width perpendicular to major flows. Maximum height is 40 inches to top of sign in place. Minimum height is 30 inches to top of sign in place.

Multiple Listings: Maximum width is 30 inches or such lesser width sufficient to retain 4 ½ feet of unobstructed sidewalk width perpendicular to major flows. Maximum height is 40 inches to top of sign in place. Minimum height is 30 inches to top of sign in place.

Location

Minimum distance between signs is 20 feet. Maximum distance of sign from public entrance of advertiser is 20 feet. The City may vary these distances for exceptional physical circumstances where public safety and streetscape aesthetics will be maintained. However, under no circumstances shall signs obstruct vehicular stops, benches, fire hydrants or other street visual amenities. Signs shall be located near the curb rather than the building face.

Materials and Graphics

All signs shall be of an A-frame type design, shall be constructed of durable, weather-resistant materials and finish, shall have no moving parts and shall be non-electrified. All signs shall be maintained in a clean and original appearance. Sign materials, graphics and finish shall be of a unified design and shall be compatible with the local streetscape. All signs shall have horizontal braces spanning each side of the sign to assure rigid support. Lettering shall be legible and consistent.

Sign Removal

All signs shall be removed when the business is closed or while any snow or ice exists on the walk within eight feet of the sign in any direction.

Insurance

No permit shall be issued unless the applicant has posted in advance with the City a Certificate of Liability listing the City as additional insured in the amount of \$400,000.00.

Enforcement

If the sign does not conform to the standards outlined, the permit may be revoked and once the owner has been notified, the sign could be removed.

Checklist

To apply for a sign permit, stop by the Inspections Division, Portland City Hall, 389 Congress Street, room 315 with:

- Certificate of liability insurance
- Drawing of sign showing dimensions and design work
- Payment of fees: twenty five dollars (\$25.00) plus twenty cents (.20) per s.f. of signage
- Complete application with pre-application questionnaire and checklist complete

THE NORTH POINT 35 SILVER ST.

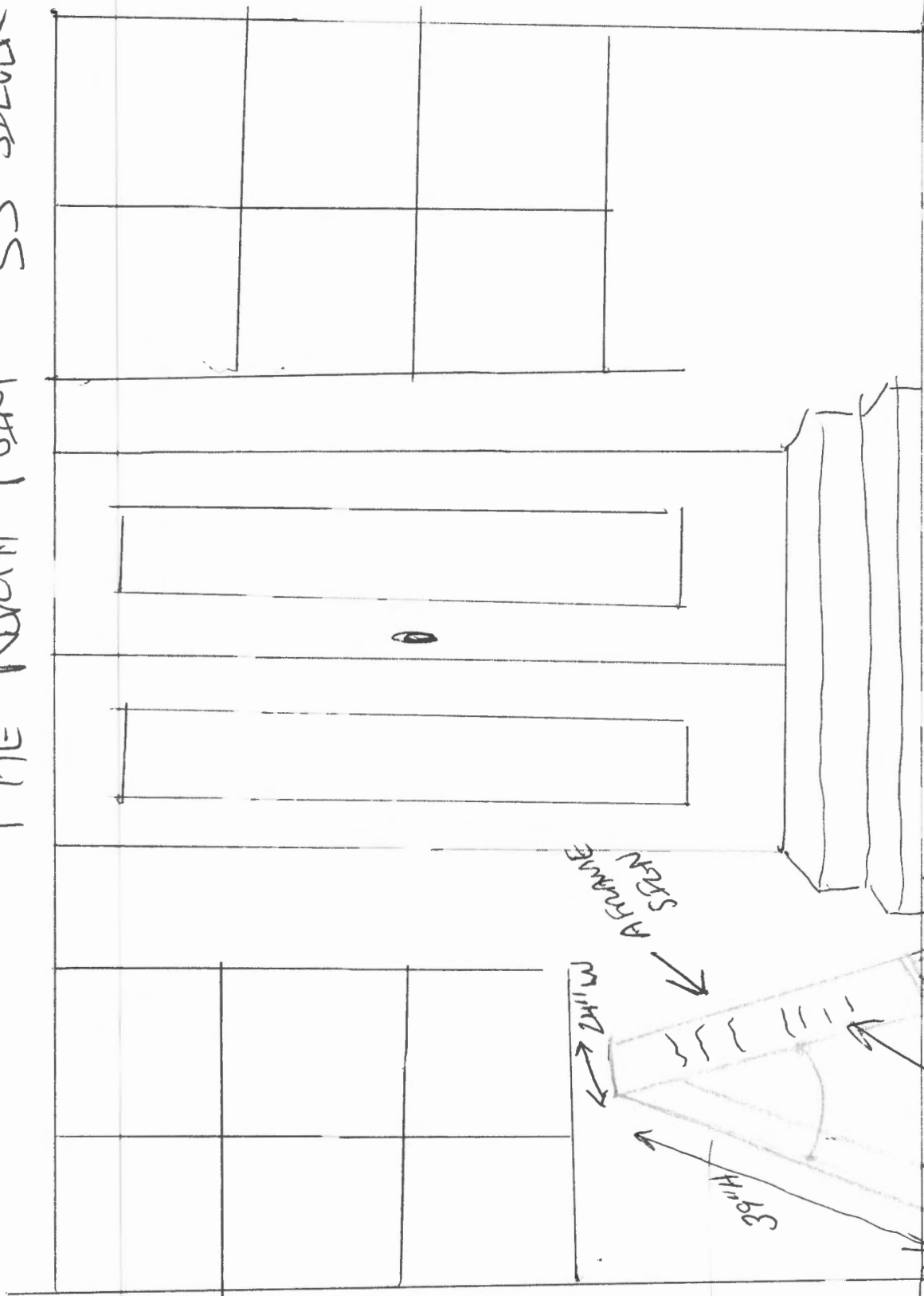

6' 6"
 STAIRWELL
 SPACE FOR
 EGRESS

A FRAME
 SIGN

EXISTING
 DRYING
 SPECIALLY ETC.

POSTERED
 TO RIGHT UP NEXT
 TO BUILDING FACE

SIDE WALK



3' 6" H

WALK