

DISPLAY THIS CARD ON PRINCIPAL FRONTAGE OF WORK

CITY OF PORTLAND

BUILDING DEPARTMENT

PERMIT

Permit Number: 090478

Please Read Application And Notes, If Any, Attached

This is to certify that WITT-T LLC /The Crooked N

has permission to outside seating 8 Chairs & 4 Tables

AT 37 SILVER ST G 029 B001001

provided that the person or persons, firm or corporation accepting this permit shall comply with all of the provisions of the Statutes of Maine and of the Ordinances of the City of Portland regulating the construction, maintenance and use of buildings and structures, and of the application on file in this department.



Apply to Public Works for street line and grade if nature of work requires such information.

Notification of inspection must be given and written permission procured before this building or part thereof is lath or other work is used-in. 24 HOUR NOTICE IS REQUIRED.

A certificate of occupancy must be procured by owner before this building or part thereof is occupied.

OTHER REQUIRED APPROVALS

Fire Dept. _____
Health Dept. _____
Appeal Board _____
Other _____
Department Name

[Handwritten Signature]
6/1/09
Director - Building & Inspection Services

PENALTY FOR REMOVING THIS CARD



City of Portland, Maine - Building or Use Permit Application

389 Congress Street, 04101 Tel: (207) 874-8703, Fax: (207) 874-8716

Permit No: 09-0478	Issue Date:	CBL: 029 B001001
-----------------------	-------------	---------------------

Location of Construction: 37 SILVER ST	Owner Name: WITT-T LLC	Owner Address: 378 LAKESIDE DR	Phone:
Business Name:	Contractor Name: The Crooked Mile	Contractor Address:	Phone:
Lessee/Buyer's Name	Phone:	Permit Type: Outdoor Seating	Zone: B-3

Past Use: Commercial "The Crooked Mile"	Proposed Use: Commercial "The Crooked Mile" - outside seating 8 Chairs & 4 Tables	Permit Fee: \$134.00	Cost of Work: \$134.00	CEO District: 1
		FIRE DEPT: <input type="checkbox"/> Approved <input checked="" type="checkbox"/> Denied <i>N/A</i>	INSPECTION: Use Group: <input checked="" type="checkbox"/> Type: <i>outdoor seating</i>	

Proposed Project Description: outside seating 8 Chairs & 4 Tables	Signature:	Signature:
	PEDESTRIAN ACTIVITIES DISTRICT (P.A.D.)	
	Action: <input type="checkbox"/> Approved <input type="checkbox"/> Approved w/Conditions <input checked="" type="checkbox"/> Denied	
	Signature:	Date:

Permit Taken By: Ldobson	Date Applied For: 05/20/2009	Zoning Approval
-----------------------------	---------------------------------	------------------------

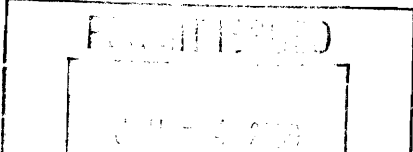
<ol style="list-style-type: none"> This permit application does not preclude the Applicant(s) from meeting applicable State and Federal Rules. Building permits do not include plumbing, septic or electrical work. Building permits are void if work is not started within six (6) months of the date of issuance. False information may invalidate a building permit and stop all work.. 	Special Zone or Reviews <input type="checkbox"/> Shoreland <input type="checkbox"/> Wetland <input type="checkbox"/> Flood Zone <input type="checkbox"/> Subdivision <input type="checkbox"/> Site Plan Maj <input type="checkbox"/> Minor <input type="checkbox"/> MM <input type="checkbox"/> Date: <i>6/1/09</i>	Zoning Appeal <input type="checkbox"/> Variance <input type="checkbox"/> Miscellaneous <input type="checkbox"/> Conditional Use <input type="checkbox"/> Interpretation <input type="checkbox"/> Approved <input type="checkbox"/> Denied Date:	Historic Preservation <input type="checkbox"/> Not in District or Landmark <input checked="" type="checkbox"/> Does Not Require Review <input type="checkbox"/> Requires Review <input type="checkbox"/> Approved <input type="checkbox"/> Approved w/Conditions <input type="checkbox"/> Denied Date: <i>6/1/09</i>
			

CERTIFICATION

I hereby certify that I am the owner of record of the named property, or that the proposed work is authorized by the owner of record and that I have been authorized by the owner to make this application as his authorized agent and I agree to conform to all applicable laws of this jurisdiction. In addition, if a permit for work described in the application is issued, I certify that the code official's authorized representative shall have the authority to enter all areas covered by such permit at any reasonable hour to enforce the provision of the code(s) applicable to such permit.

SIGNATURE OF APPLICANT	ADDRESS	DATE	PHONE
RESPONSIBLE PERSON IN CHARGE OF WORK, TITLE		DATE	PHONE



090473
29-B-1

Outdoor Dining Permit Application

If you or the property owner owes real estate or personal property taxes or user charges on any property within the City, payment arrangements must be made before permits of any kind are accepted.

<input type="checkbox"/> New Application for Outside Dining			<input checked="" type="checkbox"/> Renewal Application for Outside Dining		
City Clerk signature for liquor license approval: _____			or Pending Council Date _____		
Location/Address of Outdoor Seating: <u>8 milk St.</u>					
Total Square Footage of Proposed Seating Area ¹ <u>845q Feet</u>			Square Footage of Lot		
Tax Assessor's Chart, Block & Lot Chart# <u>02a</u> Block# <u>BooL</u> Lot# <u>001</u>		Phone#: <u>749-7388</u>		Owner: <u>Witt - LLC</u>	
Applicant * must be owner or Lessee Name: <u>Joe McBonyl</u> Address: <u>8 milk St</u> City, State & Zip: <u>Portland ME 04101</u>		Lessee/Buyer's Name: (If Applicable) <u>Joe McBonyl</u>		Annual Fee: \$80 Total Sq. Ft. Sq. Ft. Fee: \$ Total Fee: \$	
Current use: <u>Coffee Shop / cafe</u>					
Business name: <u>The Crooked mile</u>					
Seating area dimensions: _____					
How many chairs? <u>8</u> How many tables? <u>4</u>					
<input type="checkbox"/> Yes Alcohol is served.					
<input checked="" type="checkbox"/> No Alcohol being served.					
Who should we contact for the pre-inspection: <u>Joe McBonyl</u>					
Mailing address: <u>8 milk St</u> Phone: <u>749-7388</u>					

MAY 20 2009

Please submit all of the information outlined in the Outdoor Dining Application Checklist. Failure to do so will result in the automatic denial of your permit.

In order to be sure the City fully understands the full scope of the project, the Planning and Development Department may request additional information prior to the issuance of a permit. For further information visit us on-line at www.portlandmaine.gov, stop by the Building Inspections office, room 315 City Hall or call 874-8703.

I hereby certify that I am the Owner of record of the named property, or that the owner of record authorizes the proposed work and that I have been authorized by the owner to make this application as his/her authorized agent. I agree to conform to all applicable laws of this jurisdiction. In addition, if a permit for work described in this application is issued, I certify that the Code Official's authorized representative shall have the authority to enter all areas covered by this permit at any reasonable hour to enforce the provisions of the codes applicable to this permit.

Signature of Applicant: [Handwritten Signature]

Date: 5-20-09

¹ In no instance shall the total square footage of dining area equal more than 10% of park space, unless the applicant receives a waiver from the Director of Parks and Recreation or his or her designee. **This is not a permit; you may not commence ANY work until the permit is issued.**

CITY OF PORTLAND
DEPARTMENT OF PLANNING & URBAN DEVELOPMENT

389 Congress Street
 Portland, Maine 04101

INVOICE FOR PERMIT FEES

Application No: 9-0478	Applicant: WITT-T LLC
Project Name: outside seating 8 Chairs & 4 Tables	Location: 37 SILVER ST
CBL: 029 B001001	Development Type:
Invoice Date: 05/29/2009	

Previous Balance	-	Payment Received	+	Current Fees	-	Current Payment	=	Total Due	Payment Due Date
\$0.00		\$0.00		\$134.00		\$0.00		\$134.00	On Receipt

First Billing

Previous Balance	\$0.00
-------------------------	---------------

Fee Description	Qty	Fee/Deposit Charge
Outside Seating Sidewalk	27	\$54.00
Outside Seating	1	\$80.00
		<u>\$134.00</u>
Total Current Fees:	+	\$134.00
Total Current Payments:	-	\$0.00
Amount Due Now:		\$134.00

 Detach and remit with payment

Bill to: WITT-T LLC
 378 LAKESIDE DR
 BOOTHBAY HARBOR, ME 04538

CBL 029 B001001
Application No: 9-0478
Invoice Date: 05/29/2009
Invoice No: 34657
Total Amt Due: \$134.00
Payment Amount:

Make checks payable to the *City of Portland*, ATTN: Inspections, 3rd Floor, 389 Congress Street, Portland, ME 04101.

CITY OF PORTLAND
DEPARTMENT OF PLANNING & URBAN DEVELOPMENT

389 Congress Street
 Portland, Maine 04101

INVOICE FOR PERMIT FEES

Application No: 9-0478	Applicant: WITT-T LLC
Project Name: outside seating 8 Chairs & 4 Tables	Location: 37 SILVER ST
CBL: 029 B001001	Development Type:
Invoice Date: 05/29/2009	

Previous Balance	-	Payment Received	+	Current Fees	-	Current Payment	=	Total Due	Payment Due Date
\$0.00		\$0.00		\$134.00		\$0.00		\$134.00	On Receipt

First Billing

Previous Balance	\$0.00
-------------------------	---------------

Fee Description	Qty	Fee/Deposit Charge
Outside Seating Sidewalk	27	\$54.00
Outside Seating	1	\$80.00
		<u>\$134.00</u>
Total Current Fees:	+	\$134.00
Total Current Payments:	-	\$0.00
Amount Due Now:		\$134.00

 Detach and remit with payment

Bill to: WITT-T LLC
 378 LAKESIDE DR
 BOOTHBAY HARBOR, ME 04538

CBL 029 B001001
Application No: 9-0478
Invoice Date: 05/29/2009
Invoice No: 34657
Total Amt Due: \$134.00
Payment Amount:

Make checks payable to the *City of Portland*, ATTN: Inspections, 3rd Floor, 389 Congress Street, Portland, ME 04101.

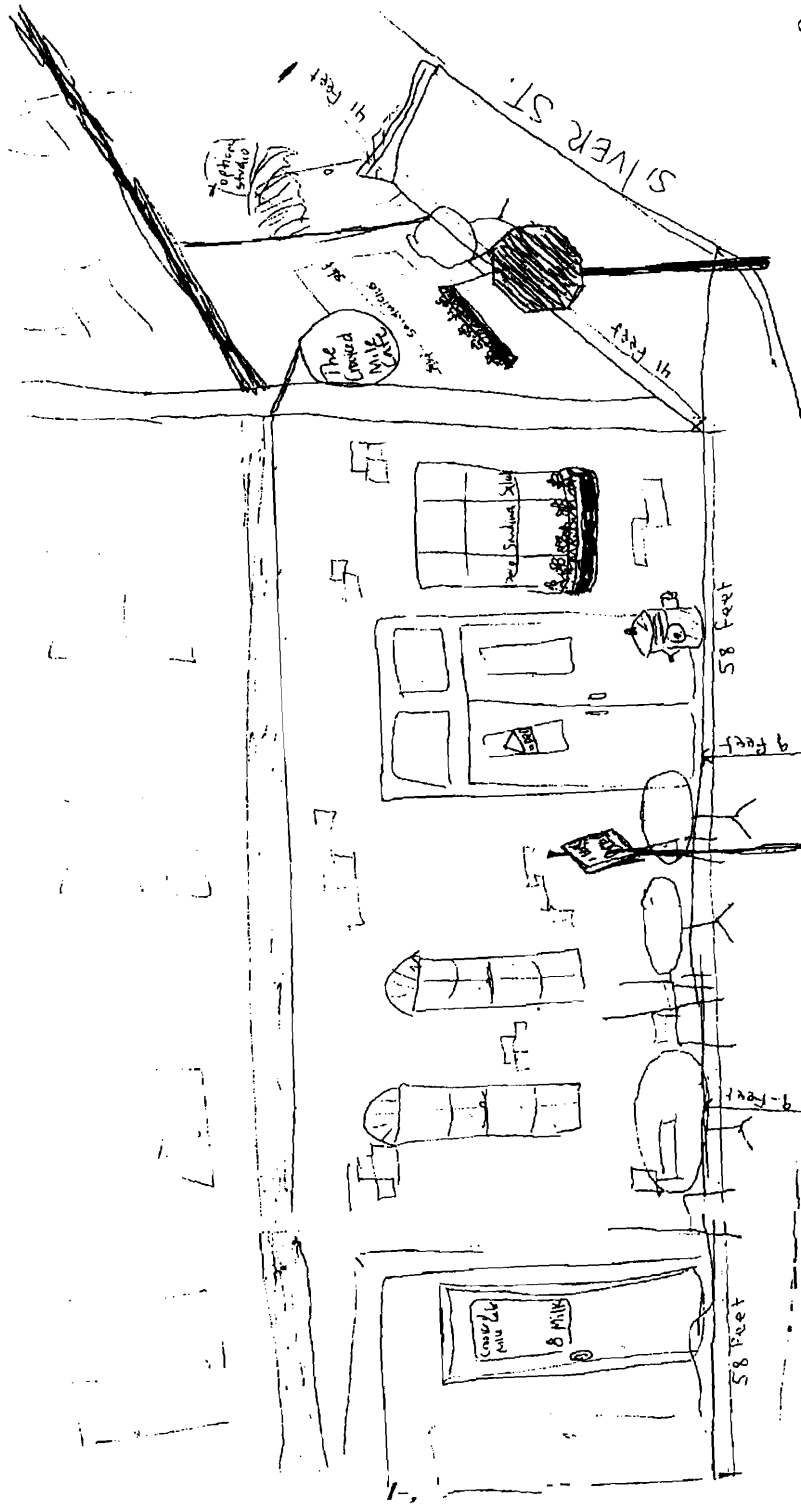

building = 41 x 58 feet
 sidewalk = 9 feet wide

MILK ST.
 2 chairs at each table - Total 8
 3 tables on the MILK ST. side - 24 inches wide
 3 tables on the SILVER ST. side

3 FT x 27 FT
 Grand Mile

SMH 5/26/09

$$\begin{array}{r}
 27 \\
 \times 3 \\
 \hline
 81 \text{ 50 FT} \\
 \text{SMH}
 \end{array}$$



OUTDOOR DINING PERMIT CHECKLIST

Permits are required for expanding food service establishments to the outside on City Property. The annual fee is \$80.00 plus \$2.00 per square foot of dining area on streets, sidewalks or other public ways and \$80.00 plus \$6.00 per square foot of dining area in city parks. For purposes of fee calculation, the area abutting the buildings which border Monument Square and extending ten (10) feet from the facade of said buildings shall be considered a sidewalk. The ten (10) foot area shall be measured from that portion of the facade that protrudes furthest into the sidewalk. The area beyond the ten (10) foot sidewalk shall be considered park space.

Outdoor dining is permitted year round under the permit; however, furniture must be removed in inclement weather to allow for sidewalk snow removal. **The permit must be renewed each year.**

All of the following information is required and must be submitted. You will also be required to fill out an Outdoor Dining Permit Application.

A plot plan is required and must include:

- A drawing of the lot, where the building sits on the lot along with the lot and building dimensions
- The dimensional setback from the sidewalk to the building
- The location of the street, and if it's a corner lot, the intersecting streets
- The sidewalk along with its width and curbing location
- The location of the table and chair placement, including dimensions

(NOTE: there must be a minimum of four feet of open sidewalk from the outer boundary of the seating area to the curb, and a minimum of five feet on corners, and egress from the building must be maintained free of obstruction per the building code and NFPA Life Safety Code).

Additional Requirements:

- The permit holder is required to produce, at the time of submission, and maintain public liability insurance coverage in an amount of not less than four hundred thousand dollars (\$400,000) combined single limit for bodily injury, death and property damage, naming the City as an additional insured thereon.

All permits for outdoor dining are issued subject to the following conditions:

- The tables and chairs must be placed within the permitted area on the sidewalk in such a manner as to allow the free and safe passage of pedestrian traffic. If the tables and chairs are moved and located outside of the permitted outdoor seating area, they must be relocated to within the permitted area. Failure to contain the tables and chairs to the permitted area may result in a reduced permitted area or a revocation of the permit.

- The permit holder is responsible for keeping the outdoor seating area clean. The sidewalk area where the tables and chairs are located must be kept neat and free from litter and debris.
- No food shall be prepared outside.
- If alcohol is to be served, the permit holder must notify the City's Business Licensing Office in room 203 of City Hall or by telephone at 874-8557 and obtain approval for the service of alcohol outdoors. Additionally, State law requires that any outdoor area serving alcohol be segregated from the rest of the public.
- All tables and chairs shall be removed prior to a predicted snowfall and while any snow or ice exists within the designated outdoor seating area or within four feet from the boundaries thereof. The City will not be responsible for damage to any tables, chairs or other property that is not properly removed when the City is engaged in sidewalk maintenance activities.
- The permit holder shall comply with all applicable rules and regulations implemented by the city regarding outdoor dining.

Failure to comply with any of the above conditions will result in revocation or non-renewal of the permit.

I/We fully understand that the City of Portland, its agents, officers and employees accept no responsibility and will not be liable for any injury, harm or damage to my/our person or property arising out of the establishment's occupancy of the sidewalk or park space. To the fullest extent permitted by law, I/We do hereby agree to assume all risk of injury, harm or damage to my/our person or property (including but not limited to all risk of injury, harm or damage to my/our property cause by the negligence of the City of Portland, its agents, officers or employees) arising out of the establishment's occupancy of the sidewalk or park space. I/We hereby agree, to the fullest extent permitted by law, to defend, indemnify and hold harmless the City of Portland, its agents, officers and employees, from and against all claims, damages, losses and expenses, just or unjust, including, but not limited to costs of defense and attorney's fees, arising out of the establishment's occupancy of the sidewalk or park space, provided that any such claims, damage, loss or expense (1) is attributable to bodily injury, sickness, disease, or death, or to injury to or destruction of tangible property including the loss of use there from, and (2) is caused in whole or in part by any negligent act or omission of the establishment, anyone directly or indirectly employed by it, or anyone for whose act it may be liable.

Signed and acknowledged: Joseph McLean Date: May 20 09
 Printed name Joseph McLean
 Establishment The Crooked Mile
 Location 8 mile St portland 04101

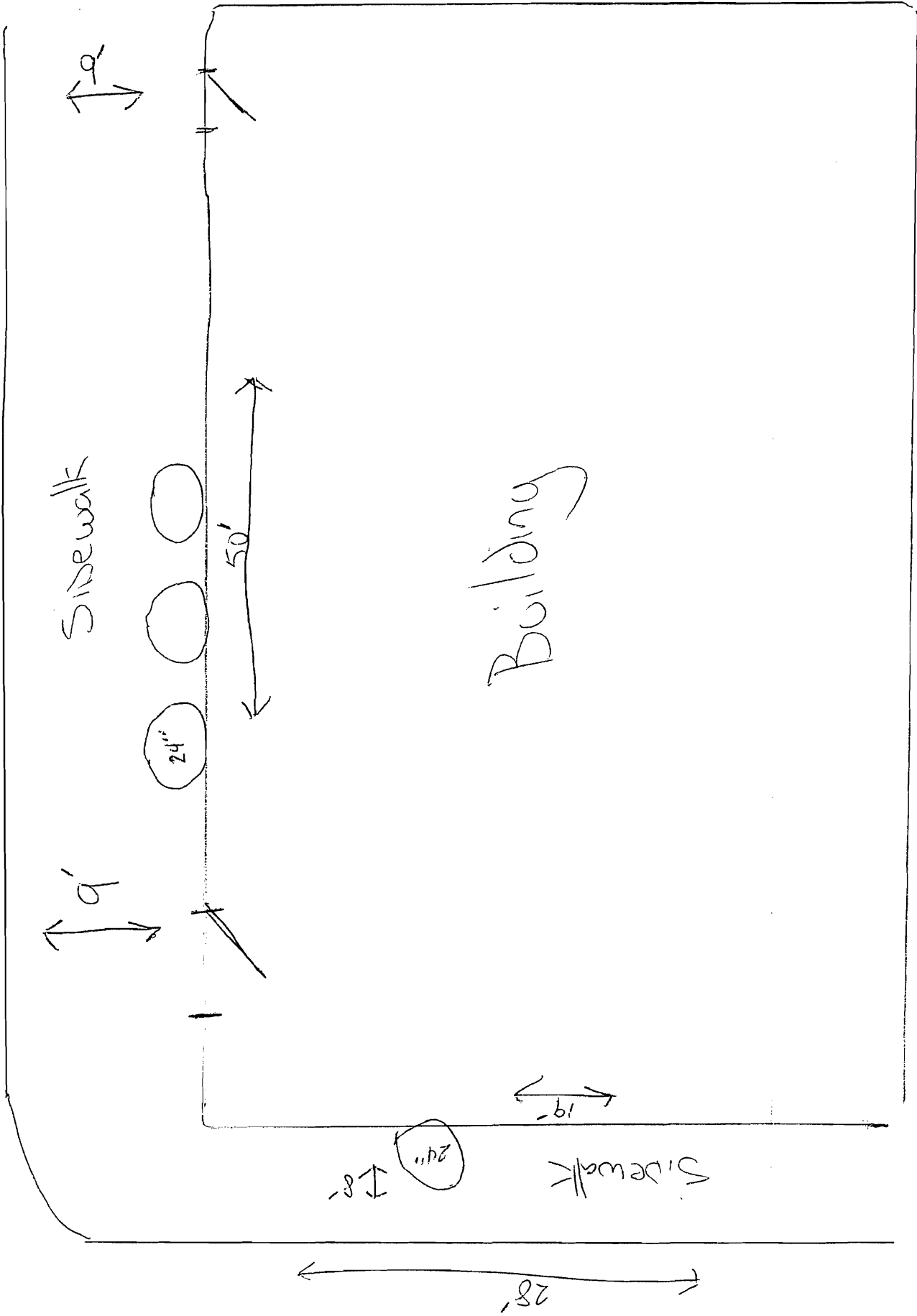

Sidewalk

Building

Sidewalk

9'

9'

24"

24"

24"

50'

8'

24"

19'

28'

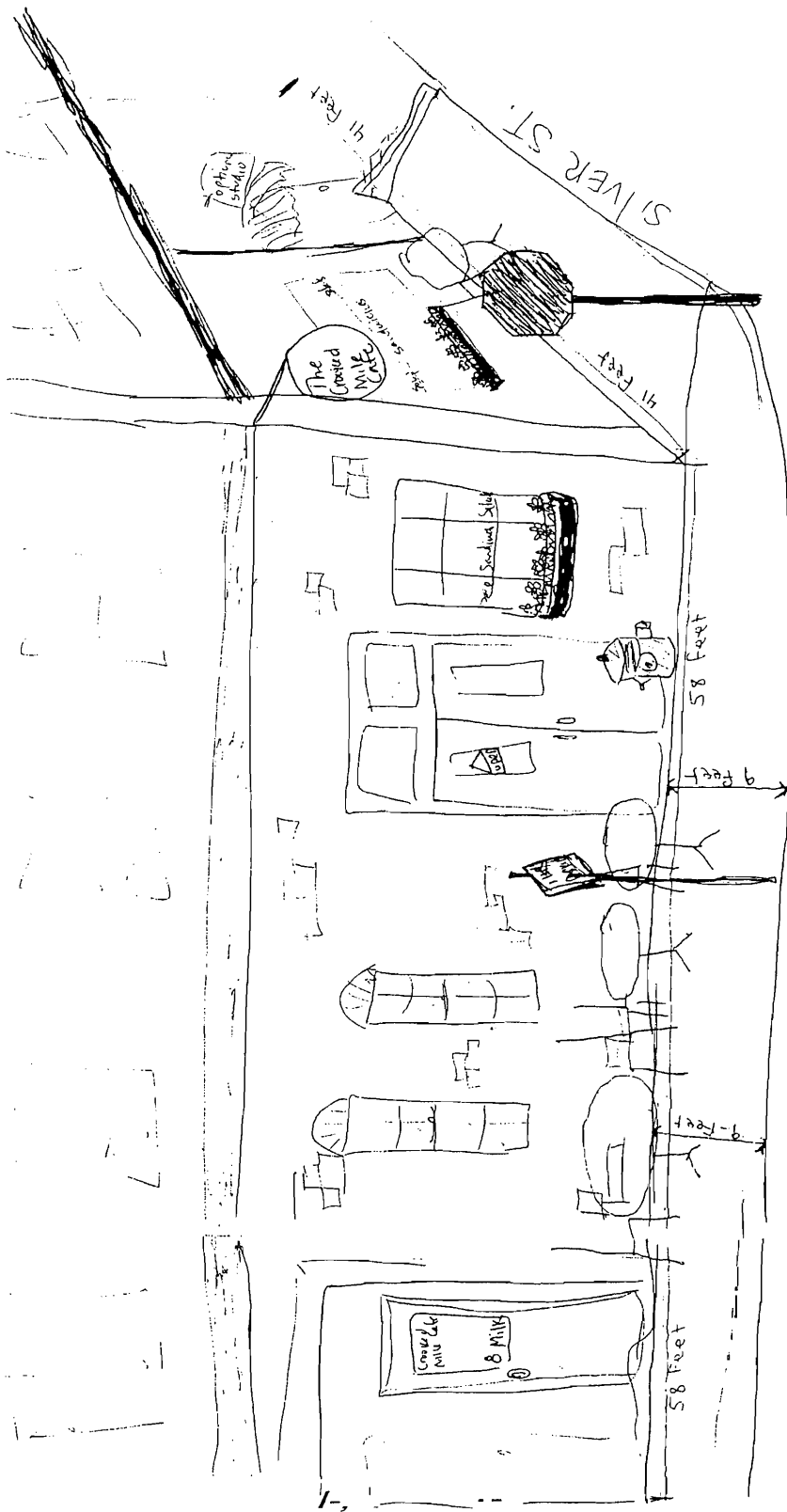

building = 41 x 58 feet
 sidewalk = 9 feet wide

- MILK ST.
- 2 chairs at each table - total 8
 - 3 tables on the MILK ST side - 24 inches wide
 - 1 table on the SILVER ST. side "

RENEWAL



EFFECTIVE DATE: 03/24/2009

Policy Number: BOP8011151	Prior Policy: 8011151
Billing Type: DIRECT BILL	
Coverage Is Provided In PEERLESS INSURANCE COMPANY - A STOCK COMPANY	
Named Insured and Mailing Address: EGBERT INC DBA THE CROOKED MILE 8 MILK ST PORTLAND ME 04101	Agent: HOLDEN AGENCY PO BOX 10610 1085 BRIGHTON AVE PORTLAND ME 04104 Agent Code: 0310128 Agent Phone: (207)-775-3793

**COMMERCIAL PROTECTOR COVERAGE FORM DECLARATIONS
BUSINESSOWNERS COVERAGE FORM DECLARATIONS**

In return for the payment of premium, and subject to all the terms of this policy, we agree with you to provide the insurance as stated in this policy.

POLICY PERIOD: From: 03/24/2009 To: 03/24/2010 at 12:01 AM Standard Time at your mailing address shown above.

FORM OF BUSINESS: CORPORATION

BUSINESS DESCRIPTION: COFFEE SHOP

DESCRIPTION OF PREMISES

Prem. No.	Bldg. No.	Location Occupancy, Construction/Fire Protection
001	001	8 MILK ST PORTLAND ME 04101 DELICATESSENS - NO FRYING ON PREMISES JOISTED MASONRY

PROPERTY COVERAGE (Business Income is included as an Additional Coverage not subject to the limits below, please refer to your policy and endorsements for coverage details and limitations)

Prem. No.	Bldg. No.	Coverage	Limits of Insurance
001	001	BUSINESS PERSONAL PROPERTY	\$ 23,877
DEDUCTIBLE:		\$ 250 In Any One Occurrence	

AUTOMATIC INCREASE: Building Coverage Shall Be Increased Annually.
Personal Property Coverage Shall Be Increased 2% Annually.

MORTGAGE HOLDERS: NONE

PROPERTY OPTIONAL COVERAGES

Coverage	Additional Limits of Insurance
COMMERCIAL PROTECTOR COVERAGE EXTENSION PLUS	INCLUDED

44-98 (06/04)

Forming a part of

Policy Number: BOP 8011151	
Coverage Is Provided In PEERLESS INSURANCE COMPANY - A STOCK COMPANY	
Named Insured: EGBERT INC DBA THE CROOKED MILE	Agent: HOLDEN AGENCY Agent Code: 0310128 Agent Phone: (207)-775-3793

DECLARATIONS EXTENSION

THE FOLLOWING IS ADDITIONAL INSURED - GRANTOR OF
FRANCHISE:

CITY OF PORTLAND
389 PORTLAND ST
PORTLAND, ME 04103

Date Issued:02/10/2009



Outdoor Dining Permit Application

If you or the property owner owes real estate or personal property taxes or user charges on any property within the City, payment arrangements must be made before permits of any kind are accepted.

Location/Address of Outdoor Seating: <u>37 Silver St / 8 mile St</u>		Total Square Footage of Proposed Seating Area ¹ <u>32</u>		Square Footage of Lot	
Tax Assessor's Chart, Block & Lot Chart# <u>029</u> Block# <u>B001</u> Lot# <u>001</u>		Owner: <u>W.H.H. - LLC</u>		Telephone: <u>749-7388</u>	
Lessee/Buyer's Name (If Applicable) <u>Joe Mcbonyel</u>		Applicant * <u>must be owner or Lessee</u> Name <u>Joseph Mcbonyel</u> Address <u>8 mile St</u> City, State & Zip <u>04101</u>		Annual Fee: <u>\$80</u> Sq Ft Fee: <u>84 SQ FT</u> \$ _____ Total Fee: \$ _____	
Current use: <u>Coffee shop / cafe</u>					
Business name: <u>The Crooked Mile</u>					
Seating area dimensions: _____					
How many chairs? <u>8</u> How many tables? <u>4</u>					
Alcohol to be served outside? circle one : YES <u>(NO)</u>					
Who should we contact for the pre-inspection: <u>Joe Mcbonyel</u>					
Mailing address: <u>8 mile St Portland</u> Phone: <u>749-7388</u>					

3x28'
Assees
SMH

Please submit all of the information outlined in the Outdoor Dining Application Checklist. Failure to do so will result in the automatic denial of your permit.

In order to be sure the City fully understands the full scope of the project, the Planning and Development Department may request additional information prior to the issuance of a permit. For further information visit us on-line at www.portlandmaine.gov, stop by the Building Inspections office, room 315 City Hall or call 874-8703.

I hereby certify that I am the Owner of record of the named property, or that the owner of record authorizes the proposed work and that I have been authorized by the owner to make this application as his/her authorized agent. I agree to conform to all applicable laws of this jurisdiction. In addition, if a permit for work described in this application is issued, I certify that the Code Official's authorized representative shall have the authority to enter all areas covered by this permit at any reasonable hour to enforce the provisions of the codes applicable to this permit.

Joe Mcbonyel
Signature of Applicant

5-15-88
Date

This is not a permit; you may not commence ANY work until the permit is issued.

¹ In no instance shall the total square footage of dining area equal more than 10% of park space, unless the applicant receives a waiver from the Director of Parks and Recreation or his or her designee.

City of Portland, Maine - Building or Use Permit Application

389 Congress Street, 04101 Tel: (207) 874-8703, Fax: (207) 874-8716

Permit No: 08-0537	Issue Date:	CBL: 029 B001001
-----------------------	-------------	---------------------

Location of Construction: 37 SILVER ST	Owner Name: WITT-T LLC	Owner Address: 378 LAKESIDE DR	Phone:
Business Name:	Contractor Name:	Contractor Address:	Phone:
Lessee/Buyer's Name	Phone:	Permit Type: Outdoor Seating	Zone: B-3

Past Use: Commercial - The Crooked Mile	Proposed Use: Commercial - The Crooked Mile - Outside seating 4 Tables & 8 Chairs 84 Square feet	Permit Fee: \$248.00	Cost of Work: \$0.00	CEO District: 1
Proposed Project Description: Outside seating 4 Tables & 8 Chairs, 84 Square feet.		FIRE DEPT: <input type="checkbox"/> Approved <input type="checkbox"/> Denied	INSPECTION: Use Group: <i>A2</i> Type: <i>Outdoor Dining</i> Signature: <i>JMB 5/27/08</i>	
		PEDESTRIAN ACTIVITIES DISTRICT (P.A.D.) Action: <input type="checkbox"/> Approved <input type="checkbox"/> Approved w/Conditions <input type="checkbox"/> Denied Signature: _____ Date: _____		

Permit Taken By: Idobson	Date Applied For: 05/20/2008	Zoning Approval
-----------------------------	---------------------------------	------------------------

<p>1. This permit application does not preclude the Applicant(s) from meeting applicable State and Federal Rules.</p> <p>2. Building permits do not include plumbing, septic or electrical work.</p> <p>3. Building permits are void if work is not started within six (6) months of the date of issuance. False information may invalidate a building permit and stop all work..</p>	<p>Special Zone or Reviews</p> <p><input type="checkbox"/> Shoreland</p> <p><input type="checkbox"/> Wetland</p> <p><input type="checkbox"/> Flood Zone</p> <p><input type="checkbox"/> Subdivision</p> <p><input type="checkbox"/> Site Plan</p> <p>Maj <input type="checkbox"/> Minor <input type="checkbox"/> MMT <input type="checkbox"/></p> <p>Date: <i>5/27/08</i></p>	<p>Zoning Appeal</p> <p><input type="checkbox"/> Variance</p> <p><input type="checkbox"/> Miscellaneous</p> <p><input type="checkbox"/> Conditional Use</p> <p><input type="checkbox"/> Interpretation</p> <p><input type="checkbox"/> Approved</p> <p><input type="checkbox"/> Denied</p> <p>Date: _____</p>	<p>Historic Preservation</p> <p><input type="checkbox"/> Not in District or Landmark</p> <p><input type="checkbox"/> Does Not Require Review</p> <p><input type="checkbox"/> Requires Review</p> <p><input type="checkbox"/> Approved</p> <p><input type="checkbox"/> Approved w/Conditions</p> <p><input type="checkbox"/> Denied</p> <p>Date: _____</p>
---	--	--	--

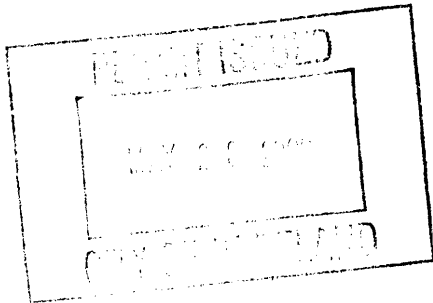

CERTIFICATION

I hereby certify that I am the owner of record of the named property, or that the proposed work is authorized by the owner of record and that I have been authorized by the owner to make this application as his authorized agent and I agree to conform to all applicable laws of this jurisdiction. In addition, if a permit for work described in the application is issued, I certify that the code official's authorized representative shall have the authority to enter all areas covered by such permit at any reasonable hour to enforce the provision of the code(s) applicable to such permit.

SIGNATURE OF APPLICANT	ADDRESS	DATE	PHONE
RESPONSIBLE PERSON IN CHARGE OF WORK, TITLE		DATE	PHONE

City of Portland, Maine - Building or Use Permit

389 Congress Street, 04101 Tel: (207) 874-8703, Fax: (207) 874-8716

Permit No: 09-0478	Date Applied For: 05/20/2009	CBL: 029 B001001
------------------------------	--	----------------------------

Location of Construction: 37 SILVER ST	Owner Name: WITT-T LLC	Owner Address: 378 LAKESIDE DR	Phone:
Business Name:	Contractor Name: The Crooked Mile	Contractor Address:	Phone:
Lessee/Buyer's Name	Phone:	Permit Type: Outdoor Seating	

Proposed Use: Commercial "The Crooked Mile" - outside seating 8 Chairs & 4 Tables	Proposed Project Description: outside seating 8 Chairs & 4 Tables
---	---

Dept: Zoning **Status:** Approved with Conditions **Reviewer:** Tammy Munson **Approval Date:** 06/01/2009

Note: **Ok to Issue:**

- 1) All outdoor seating is subject to adjustment at any time from the City's traffic engineer who ensures that the City sidewalk is open and cleared for pedestrian use.

Dept: Building **Status:** Approved with Conditions **Reviewer:** Tammy Munson **Approval Date:** 06/01/2009

Note: **Ok to Issue:**

- 1) This permit approves outside seating only. Any alcohol or entertainment in this space requires licensing approvals from the City Clerk.
- 2) The outside dining permit is approved for the area delineated at the inspection and stated on the permit, and must be kept on site. THIS PERMIT MUST BE RENEWED ANNUALY
- 3) The tables and chairs must not block any means of egress of any building, even during storage.