

Athleta - Portland, ME - Louver Exemption

4 messages

Dusty Granger <dusty.granger@wcwengineers.com>

Fri, Sep 9, 2016 at 12:38 PM

To: "jmb@portlandmaine.gov" <jmb@portlandmaine.gov>

Cc: Nick Riedel <nriedel@chipman-design.com>, Luis Roman <luis.roman@wcwengineers.com>

Hello Jeanie,

As we discussed over the phone a few days ago, I am working on a retail store project going up at 152 Middle St. in Portland, ME (which already went out for Permit). For this location, at the start of the design we reached out to the historical building department regarding fresh air and relief/exhaust locations and they strongly urged us to not put any louvers in the walls, but rather to locate the louvers in the windows located in the alleyway. While out on the survey, we did not find any ductwork inside the space that connected to an outside air intake or relief/exhaust air system. For that reason, we are showing a fresh air intake and relief/exhaust louver in the alleyway windows in accordance with the historical department suggestion. However, the relief/toilet exhaust louver is within 10 feet of the operable windows above (which are residential spaces). Per our call, could you confirm that we can have the relief air/toilet exhaust louver within 10 feet away from the operable windows above as it appears there are no other means to exhaust/relieve the space?

I've attached a photo of the alleyway area in question, please see attached. In the image below, you can see a marked-up image of the space showing the outside air intake, and relief/exhaust louver locations in respect to the operable windows.

Please let me know if you have any questions or if you require additional materials from us.

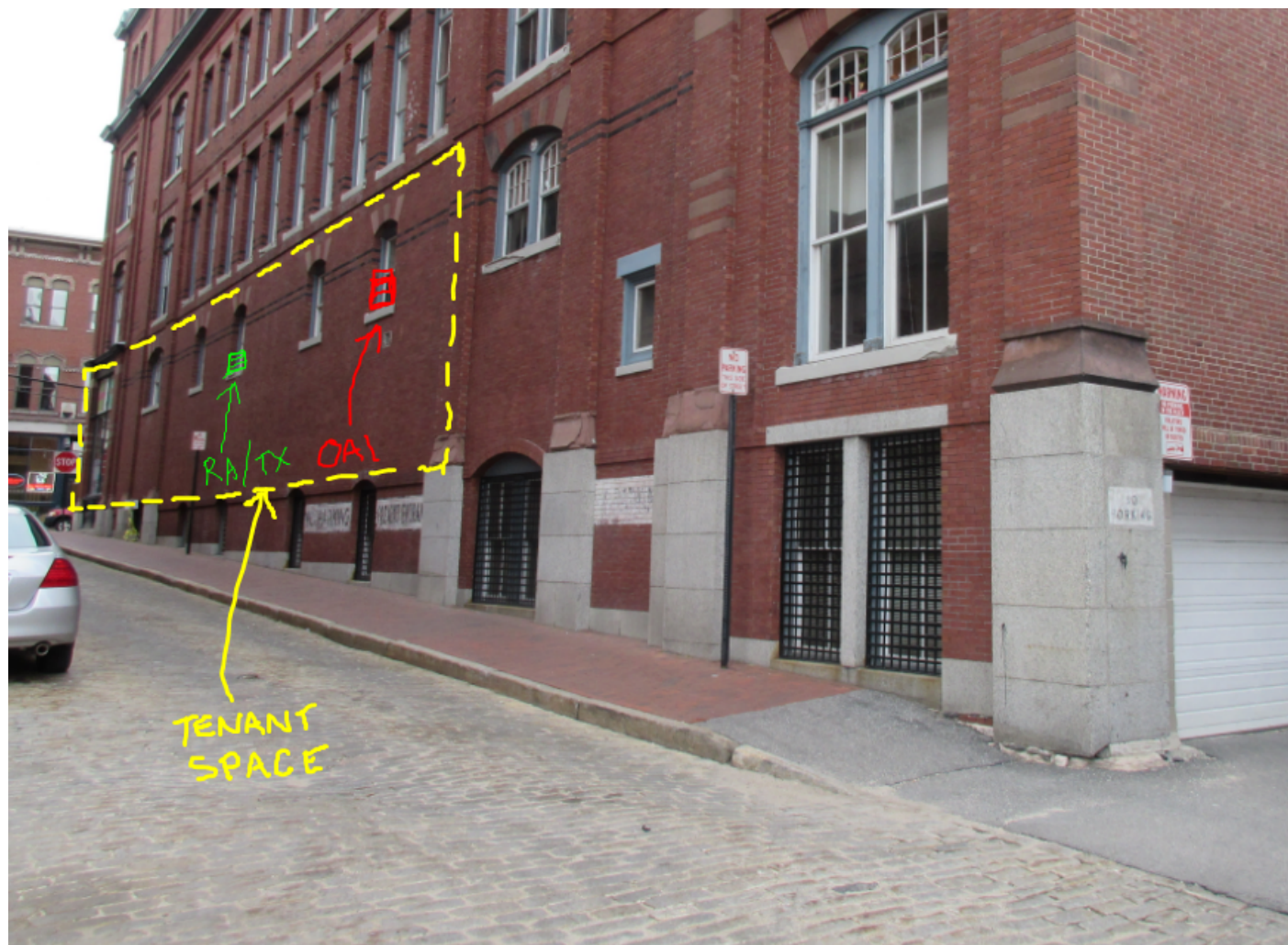

Thank you,

~~~~~  
Dusty Granger  
**WCW Engineers, Inc.**  
760 Creel Drive  
Wood Dale, IL 60191  
Tel: 630/595-8800  
Fax: 630/595-8818

**DISCLAIMER:**

This e-mail, including attachments, may include confidential and/or proprietary information and may be used only by the person to whom or entity to which it is addressed. If you, the reader of this e-mail, are not the intended recipient or his or her authorized agent, you, the reader, are hereby notified that any dissemination, distribution, or copying of this e-mail is prohibited. If you have received this e-mail in error, please notify the sender by replying to this message, and then delete this e-mail immediately.

Please consider the environment before printing this e-mail.

[www.WCWengineers.com](http://www.WCWengineers.com)



**IMG\_1910.jpg**  
4868K

---

**Jeanie Bourke** <jmb@portlandmaine.gov>  
To: Dusty Granger <dusty.granger@wcowengineers.com>  
Cc: Nick Riedel <nriedel@chipman-design.com>, Luis Roman <luis.roman@wcowengineers.com>

Mon, Sep 12, 2016 at 3:41 PM

Hi Dusty,

Thank you for sending the detail of these louvers. Can you give me an estimate on the distance from the top of the bath exhaust louver to the window opening above?

Thanks,  
Jeanie

Jeanie Bourke  
Code Enforcement Officer/Plan Reviewer

City of Portland  
Permitting and Inspections Department  
389 Congress St. Rm 315  
Portland, ME 04101  
[jmb@portlandmaine.gov](mailto:jmb@portlandmaine.gov)  
(207)874-8715

[Quoted text hidden]

---

**Nick Riedel** <nriedel@chipman-design.com>  
To: Jeanie Bourke <jmb@portlandmaine.gov>, Dusty Granger <dusty.granger@wcowengineers.com>  
Cc: Luis Roman <luis.roman@wcowengineers.com>

Mon, Sep 12, 2016 at 6:00 PM

Hi Jeanie,

From what we can judge by our onsite measurements of the window and the photos, there is about 7'-8' between the middle of the window where the louver will be located and the bottom of the operable window above. The louver will be located in the bottom half of the window, so the top of the louver will be located in the middle of the existing window.

Let me know if you need any additional information.

Thanks,

**Nick Riedel**

**Project Manager**

**Chipman Design Architecture**

2700 South River Road, Suite 400

Des Plaines, IL 60018

T: 847.298.6900

F: 847.298.6966

[nriedel@chipman-design.com](mailto:nriedel@chipman-design.com)

[www.chipman-design.com](http://www.chipman-design.com)

This electronic mail message is intended only for the person or entity to which it is addressed. If you are not the intended recipient, please contact the sender by reply e-mail and destroy all copies of the original message. Any attachments are proprietary in nature and may only be used for the specified project. Any use, other than for the stated architectural purposes within the recipient's organization, is not authorized.

**P Please consider the environment before printing this email.**

**From:** Jeanie Bourke [mailto:[jmb@portlandmaine.gov](mailto:jmb@portlandmaine.gov)]

**Sent:** Monday, September 12, 2016 2:41 PM

**To:** Dusty Granger <[dusty.granger@wcowengineers.com](mailto:dusty.granger@wcowengineers.com)>

**Cc:** Nick Riedel <[nriedel@chipman-design.com](mailto:nriedel@chipman-design.com)>; Luis Roman <[luis.roman@wcowengineers.com](mailto:luis.roman@wcowengineers.com)>

**Subject:** Re: Athleta - Portland, ME - Louver Exemption

Hi Dusty,

Thank you for sending the detail of these louvers. Can you give me an estimate on the distance from the top of the bath exhaust louver to the window opening above?

Thanks,

Jeanie

Jeanie Bourke  
Code Enforcement Officer/Plan Reviewer

City of Portland  
Permitting and Inspections Department  
389 Congress St. Rm 315  
Portland, ME 04101  
[jmb@portlandmaine.gov](mailto:jmb@portlandmaine.gov)  
(207)874-8715

On Fri, Sep 9, 2016 at 12:38 PM, Dusty Granger <[dusty.granger@wcowengineers.com](mailto:dusty.granger@wcowengineers.com)> wrote:

Hello Jeanie,

As we discussed over the phone a few days ago, I am working on a retail store project going up at 152 Middle St. in Portland, ME (which already went out for Permit). For this location, at the start of the design we reached out to the historical building department regarding fresh air and relief/exhaust locations and they strongly urged us to not put any louvers in the walls, but rather to locate the louvers in the windows located in the alleyway. While out on the survey, we did not find any ductwork inside the space that connected to an outside air intake or relief/exhaust air system. For that reason, we are showing a fresh air intake and relief/exhaust louver in the alleyway windows in accordance with the historical department suggestion. However, the relief/toilet exhaust louver is within 10 feet of the operable windows above (which are residential spaces). Per our call, could you confirm that we can have the relief air/toilet exhaust louver within 10 feet away from the operable windows above as it appears there are no other means to exhaust/relieve the space?

I've attached a photo of the alleyway area in question, please see attached. In the image below, you can see a marked-up image of the space showing the outside air intake, and relief/exhaust louver locations in respect to the operable windows.

Please let me know if you have any questions or if you require additional materials from us.

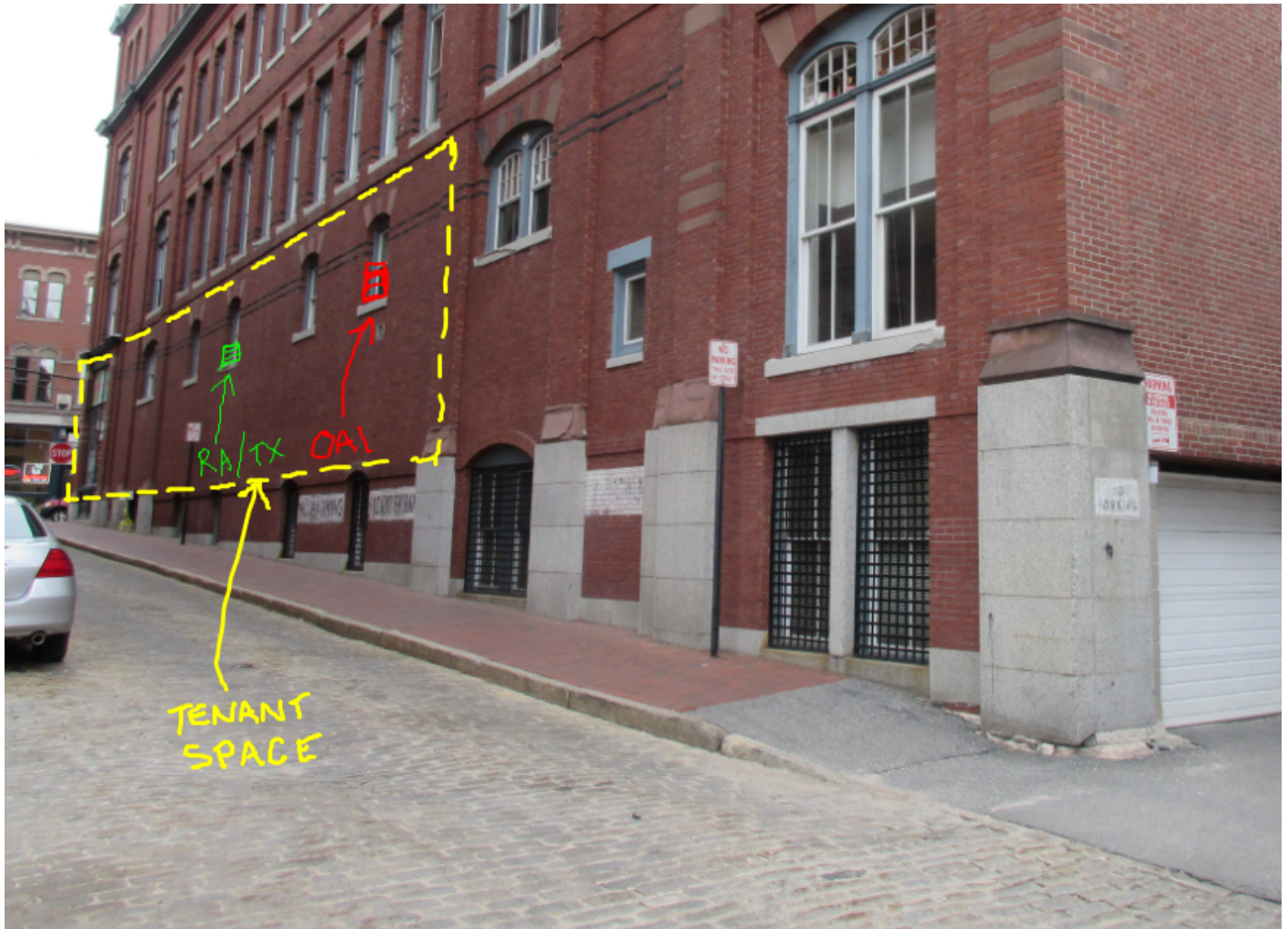

Thank you,

~~~~~  
Dusty Granger
WCW Engineers, Inc.
760 Creel Drive
Wood Dale, IL 60191
Tel: 630/595-8800
Fax: 630/595-8818

DISCLAIMER:

This e-mail, including attachments, may include confidential and/or proprietary information and may be used only by the person to whom or entity to which it is addressed. If you, the reader of this e-mail, are not the intended recipient or his or her authorized agent, you, the reader, are hereby notified that any dissemination, distribution, or copying of this e-mail is prohibited. If you have received this e-mail in error, please notify the sender by replying to this message, and then delete this e-mail immediately.

Please consider the environment before printing this e-mail.

www.WCWengineers.com

Notice: Under Maine law, documents - including e-mails - in the possession of public officials or city employees about government business may be classified as public records. There are very few exceptions. As a result, please be advised that what is written in an e-mail could be released to the public and/or the media if requested.

Jeanie Bourke <jmb@portlandmaine.gov>

Tue, Sep 13, 2016 at 2:04 PM

To: Nick Riedel <nriedel@chipman-design.com>

Cc: Dusty Granger <dusty.granger@wcwengineers.com>, Luis Roman <luis.roman@wcwengineers.com>, Robert Wiener <rwiener@portlandmaine.gov>

Thanks Nick, this will be allowed to be installed as proposed. This seems to be somewhat of a minor issue, albeit not 100% as prescribed by the code. Hopefully this will not be a nuisance, however, if our office receives complaints it may need to be addressed.

I will file this information with the permit documents.

Jeanie

Jeanie Bourke
Code Enforcement Officer/Plan Reviewer

City of Portland
Permitting and Inspections Department
389 Congress St. Rm 315
Portland, ME 04101
jmb@portlandmaine.gov
(207)874-8715

[Quoted text hidden]