



GAP INC.
CORPORATE ARCHITECTURE
1 HARRISON STREET
SAN FRANCISCO, CA 94105

STORE NO.: 7641

STORE NAME:
PORTLAND

STORE LOCATION:
152 MIDDLE STREET
PORTLAND, ME 04101

PROJ. I.D.: 0000053405

PROTOTYPE DATE: 09/4/15
PROTOTYPE VERSION 4.1

CONSULTANT INFO:

PROFESSIONAL STAMP:

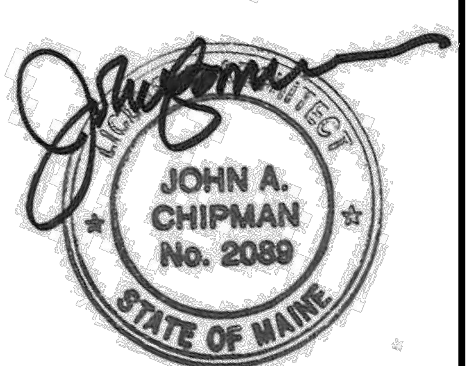

ARCHITECT INFO:



I HEREBY CERTIFY THAT THESE PLANS HAVE BEEN PREPARED BY MY OFFICE AND UNDER MY SUPERVISION AND THAT TO THE BEST OF MY KNOWLEDGE, THEY COMPLY WITH ALL LAWS, RULES, REGULATIONS AND ORDINANCES OF PORTLAND, ME RELATING TO STRUCTURES AND BUILDINGS.

ISSUE TYPE:
100% CD CHECKSET 5/20/16
PERMIT / BID
LL APPROVAL

DRAWN BY: NR
A&E JOB NO.: 16-5433

SHEET TITLE:
MEZZANINE FLOOR PLAN

SHEET NUMBER:
A2-1

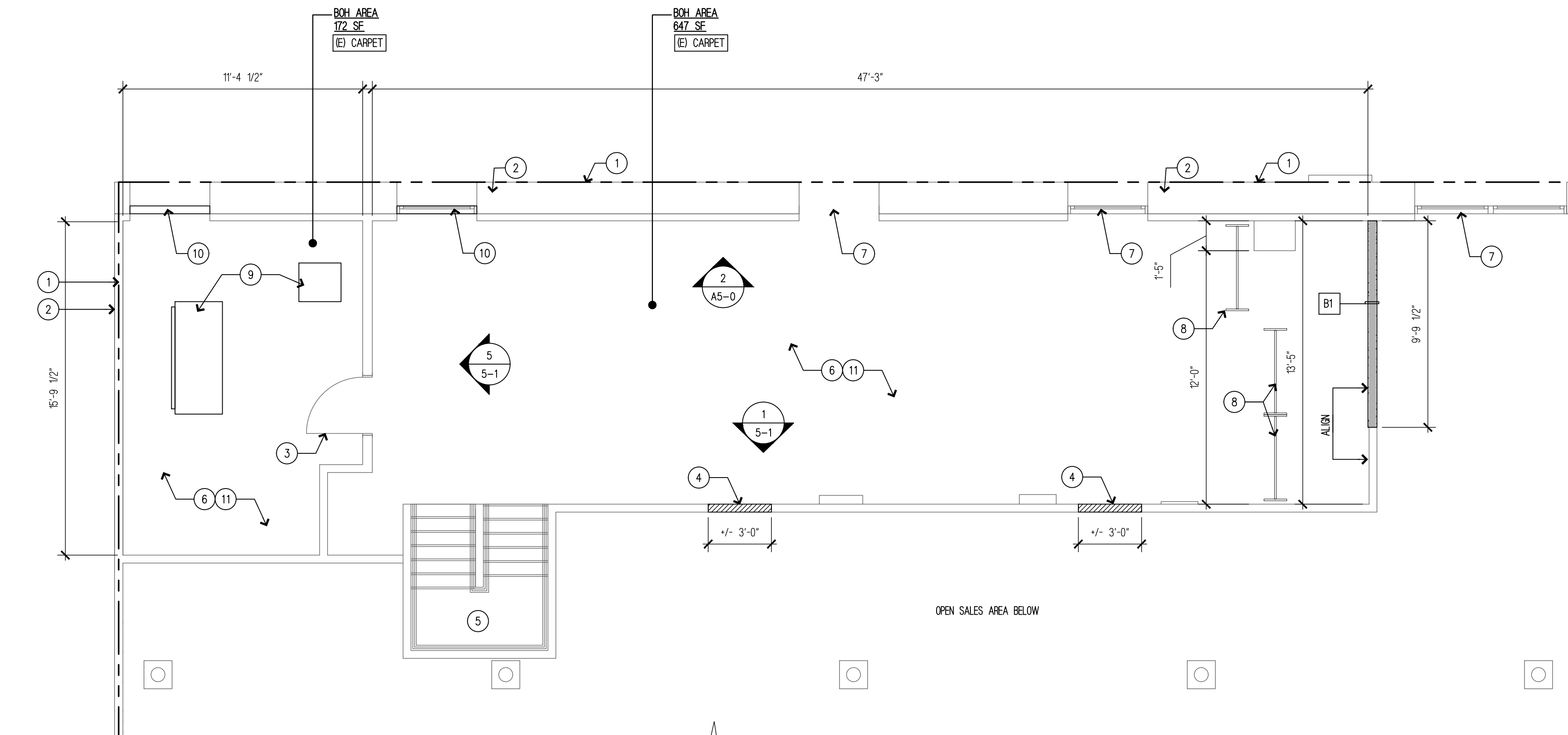

NOTE:
ALL PLYWOOD SHEATHING AND BLOCKING TO BE FIRE RESISTIVE, TYP. THROUGHOUT

NOTE TO GC:
SEE GO-2 AND GO-2.1 FOR FINISH LEGEND & ROOM FINISH SCHEDULE

FLOOR PLAN - MEZZANINE

SCALE:
1/4" = 1'-0" 2

KEY	DESCRIPTION	CODE	REF./SHT.	KEY	DESCRIPTION	CODE	REF./SHT.	KEY	DESCRIPTION	CODE	REF./SHT.	TYPE	DESCRIPTION
1	LEASE LINE			13	GC BUILT WALL WITH GC INSTALLED RECESSED 2X4X12 STANDARDS SPACED AT 23.5" O.C. & WOOD SHEATHING CENTER BETWEEN FEATURE WALLS. U.N.O.	A6-0		25	(E) COLUMN TO REMAIN. PAINT [P1-BG]			EXISTING WALL	
2	EXISTING DEMISING WALL, GC TO MAINTAIN EXISTING FIRE RATING			14	GC BUILT WALL WITH GC INSTALLED RECESSED 2X4X12 STANDARDS SPACED AT 23.5" O.C. & WOOD SHEATHING CENTER BETWEEN FEATURE WALLS. U.N.O.			26	GC TO ABSEX FLOOR AS REQUIRED TO CREATE LEVEL FLOOR AT REAR DOOR			GC BUILT WALL	
3	(E) DOOR TO REMAIN			15	EXISTING CONCRETE SLAB. READ BLAST & SEAL	GO-1 GO-2		27	GC TO PROVIDE ATHLETA NAME AND SPACE NUMBER AT EXTERIOR SIDE OF REAR DOOR			FURRED OUT WALL BY GC	
4	GC TO INFILL PARTITION WALL AS REQUIRED. MATCH FINISHES OF (E) WALL			16	METAL TRANSITION STRIP BETWEEN WD FLOORING & TILE FLOORING	5/A0-1.1		28	GC TO PROVIDE (N) CYP. BOARD FINISHES BELOW STOREFRONT. PAINT [E1-E2]				
5	(E) STAIRS, HANDRAILS & FINISHES TO REMAIN			17	METAL TRANSITION STRIP BETWEEN WD FLOORING & CONCRA MAT @ ENTRY	9/A0-1.1		29	GC TO MATCH FIRE RATING AND FINISHES OF THE (E) SERVICE CORRIDOR RECESSED EXIT, WHERE NEEDED				
6	(E) WALL FINISHES & TRIM TO REMAIN. PATCH & REPAIR AS REQUIRED. PAINT [P1-EG]			18	METAL TRANSITION STRIP BETWEEN WD FLOORING & CONCRETE	5/A0-1.1		30	CUSTOM WOOD FRAME	WB-6			
7	GC TO CLEAN & PROTECT (E) WINDOWS. PAINT FRAME [P-TBD]			19	WOOD BASE [BB] IN SALES PROVIDED BY VENDOR AND INSTALLED BY GC	1B-3		31	GC TO POUR ABSEX TO LEVEL THE FLOOR FINISHES - 1:48 MAX. SLOPE				
8	BOH SHELVING RACK			20	16" SHELF PROVIDED BY OWNER			32	GC TO USE 1/2" ADA THRESHOLD	2/A0-1.1			
9	FLOOR MOUNTED AHU. REFER TO MECHANICAL.			21	22" SHELF PROVIDED BY OWNER			33	RECESSED 190X W/ FACE PLATE REFER TO ELECTRICAL DWGS. CENTER WITH CASH WRAP	SEE ELEC.			
10	GC TO INSTALL OUTSIDE AIR LOUVERS AT EXISTING WINDOW OPENING. REFER TO MECH. PAINT LOUVERS WHITE TO MATCH (E) EXTERIOR WINDOW FRAMES			22	VERTICALLY MOUNTED TRACK LIGHT. INSTALL ON SIDE OF WINDOW OPENING ALONG FULL HEIGHT OF STOREFRONT GLAZING	A5-1	A4-1	34	GC TO USE 1/2" ADA THRESHOLD	1/A0-1.1			
11	(E) CARPET TO REMAIN. CLEAN AS REQUIRED			23	EXPOSED MASONRY AT (E) EXTERIOR WALL			35					
12				24	(E) STAIRS, HANDRAILS & FINISHES TO REMAIN			36					

KEYNOTES 3 GENERAL NOTES 1