

**NOTE:**

- 1. ANY SUBSURFACE TANKS AND CONTAMINATED SOIL ENCOUNTERED DURING CONSTRUCTION, SHALL BE REMOVED PER CREDERE ASSOCIATES RECOMMENDATIONS.

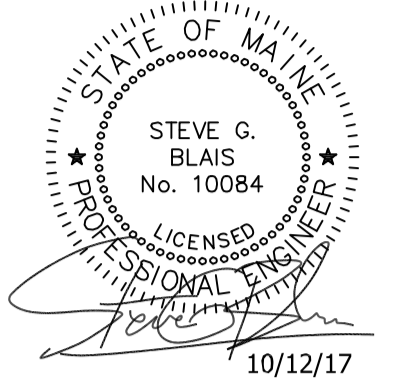

REV.	DESCRIPTION	DATE
1.	REVISED PER CITY COMMENTS	10/12/17

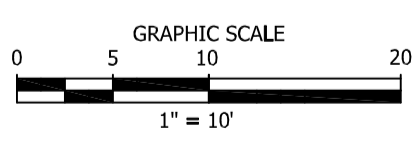
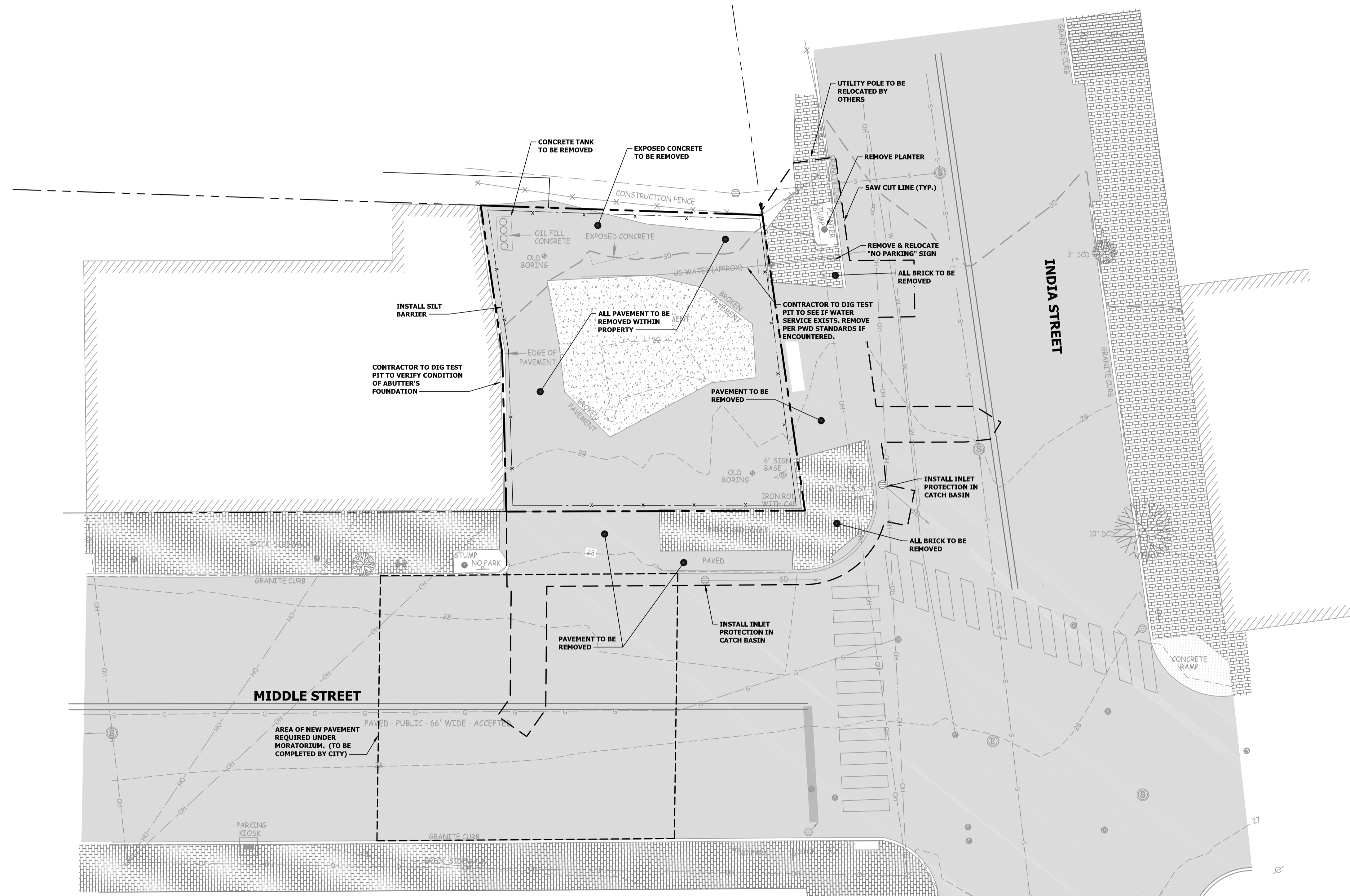

**DEMOLITION & EROSION CONTROL PLAN**

**SPORT CREDIT UNION**  
50 INDIA STREET  
PORTLAND, MAINE 04101

DRAWINGS PREPARED FOR:  
SPORT CREDIT UNION  
50 RIVERSIDE INDUSTRIAL PARKWAY  
PORTLAND, MAINE 04101

DRAWING:  
PROJECT:

ISSUED DATE: 10/2/17  
DESIGNED BY: JDY  
DRAWN BY: JDY  
CHECKED BY: SGB  
PROJECT NUMBER: 16101



**C-102**