

Project

**PORT CITY GLASS**  
50 INDIA STREET  
PORTLAND, ME 04101

Consultants

**STRUCTURAL ENGINEER**

Downeast Structural Consultants, LLC  
5 Oak Street  
Cumberland Center, ME 04021  
P: 207.829.8015  
Mobile: 207.650.3093  
Email: [cray@downeaststructural.com](mailto:cray@downeaststructural.com)  
<http://www.downeaststructural.com>

**FOR PERMIT**

PERMIT DRAWINGS FOR  
EXISTING WORK

Revisions

Drawing Title

**FLOOR PLAN**

Scale Date

AS NOTED DECEMBER 20, 2012

Drawn By MJD Checked

Drawing Number **S-1**

JOB NO 1214

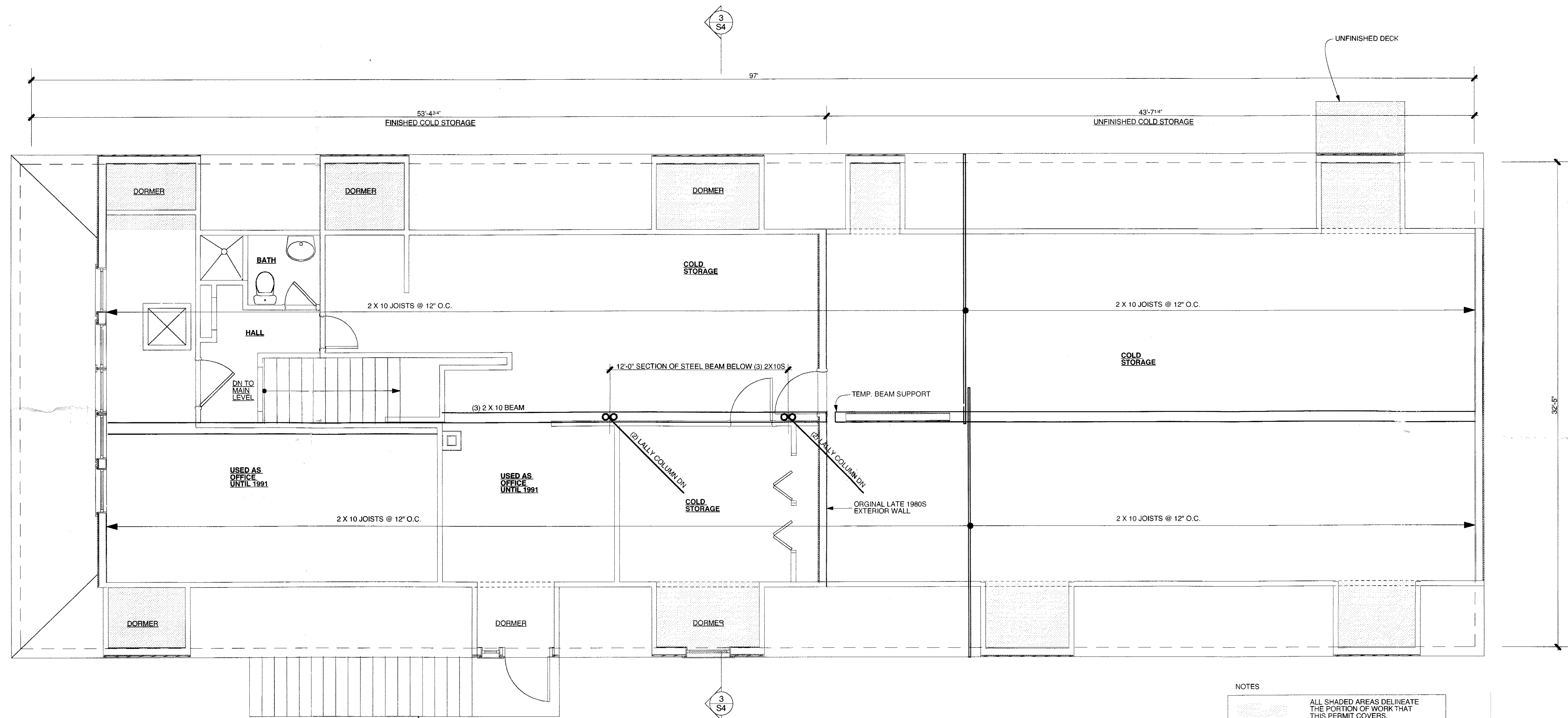

**1 SECOND FLOOR FRAMING**  
SCALE: 1/4" = 1' - 0"

STAIR, DORMER AND POOR  
ADDED WITH THE LATE 1980S  
ADDITION. THIS SHADING IS NOT  
NECESSARY FOR THE  
SECOND FLOOR OFFICES.  
STAIR NOT IN USE  
AND WILL BE ADDRESSED  
VIA A CHANGE OF USE  
PERMIT. PREFER ALSO  
TO THE ELECTRONIC FILE.

**NOTES**

ALL SHADED AREAS DELINEATE THE PORTION OF WORK THAT THIS PERMIT COVERS.

ALL WORK SHOWN ON THESE DRAWINGS IS EXISTING.

ALL WORK SHOWN ON THESE DRAWINGS WAS DESIGNED AND BUILT BY OTHERS.

ALL SHADED WORK SHOWN WAS CONSTRUCTED BY A PREVIOUS OWNER WITHOUT A BUILDING PERMIT PRIOR TO THE CREATION OF THESE DRAWINGS.

UNFORSEEN CONDITIONS ARE LIKELY TO EXIST IN THIS BUILDING.

DUE TO THE UNUSUAL NATURE OF THIS BUILDING PERMIT LUCKSE DESIGN, LLC AND DOWNEAST STRUCTURAL CONSULTANTS ASSUME ZERO LIABILITY FOR ANY LEGAL ISSUES THAT ARISE IN CONNECTION WITH THIS BUILDING.