

KEY PLAN
SCALE: N. T. S.

TENANT SPACE - AREA OF NEW WORK

PROJECT NOTES

1. THE CONSTRUCTION TYPE NOTED WITHIN IS LIMITED TO THE SCOPE OF WORK FOR THE PROJECT AS SHOWN AND OUTLINED IN THE CONSTRUCTION DOCUMENTS. CONSTRUCTION TYPE AND USE BEYOND THIS SCOPE OF WORK SHALL BE OUTSIDE THE RESPONSIBILITY OF THE ARCHITECT.
2. SCOPE OF WORK: THE PROJECT INCLUDES THE TENANT FIT-UP OF INTERIOR WALLS FOR "OLD PORT SPECIALTY TILE".
3. THE TENANT SPACE SHALL BE CONSTRUCTED TO CONFORM WITH ALL APPLICABLE CODES INCLUDING, BUT NOT LIMITED TO, THE LATEST EDITIONS OF IBC, NFPA 101, ANSI, UFAS, HUD/AG, ADA/AG, MPS.
4. THE CONTRACTOR SHALL WORK FROM GIVEN DIMENSIONS AND LARGE SCALE DETAILS ONLY. DO NOT SCALE THE DRAWINGS.
5. INSTALL BLOCKING FOR SURFACE APPLIED FIXTURES, TRIM, WHEN MOUNTED ON STUD WALLS, INCLUDING ALL FUTURE INSTALLATIONS.
6. INSTALL U.L. FIRE-STOPPING SEALANT SYSTEM EQUAL TO THE EXISTING/PROPOSED FIRE RATED FLOOR, CEILING AND WALL ASSEMBLY.
7. ALL INTERIOR FINISHES SHALL MEET: WALLS & CEILINGS: CLASS A OR B FLOOR FINISHES: NOT LESS THAN CLASS II.
8. FURNITURE, FIXTURES AND EQUIPMENT: SHALL BE FLAME RESISTANT AND MEET NFPA 701, STANDARD METHODS OF FIRE TESTS FOR FLAME PROPAGATION OF TEXTILES AND FILMS.
9. ELECTRICAL: ALL NEW WORK SHALL MEET THE NEC AND NFPA 70.
10. LIFE SAFETY INTEGRATION W/ THE EXISTING SHALL MEET NFPA 72 & CITY OF PORTLAND FIRE DEPARTMENT. SYSTEM SHALL BE DESIGNED AND INSTALLED BY A CITY/ STATE APPROVED DESIGNER & CONTRACTOR.
11. SPRINKLER SYSTEM SHALL MEET NFPA 13 - NEW HEADS PER PLAN. (REVISE EXISTING AS REQ'D PER NFPA 13)
12. ALL EXISTING EGRESS COMPONENTS SHALL REMAIN AS SHOWN ON DRAWINGS.
13. HVAC - VERIFY EXISTING HVAC SYSTEM & DUCT WORK WITH PROPOSED PLAN.

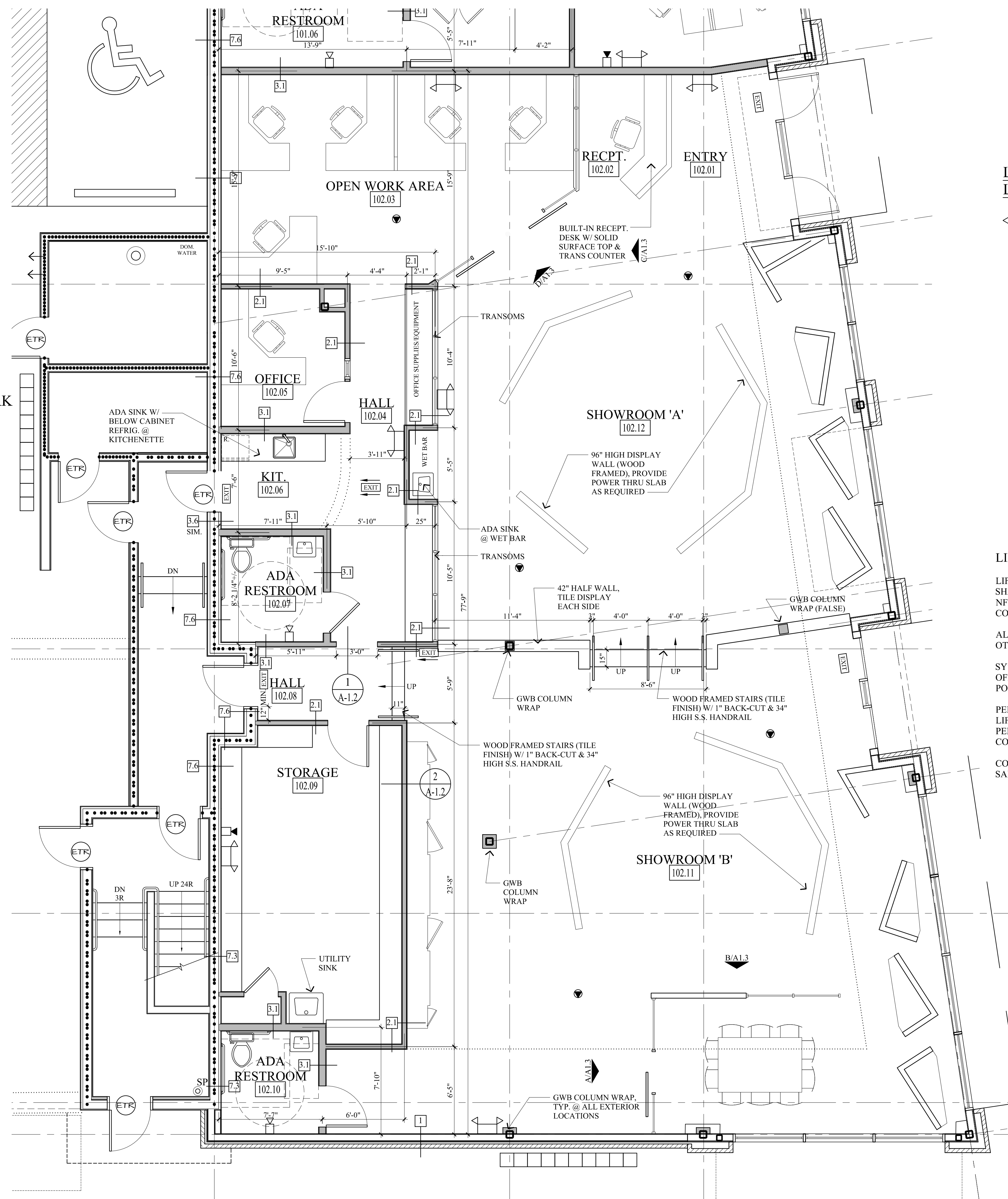

PROPOSED FIRST FLOOR PLAN
SCALE: 1/4"=1'-0"

WALL LEGEND

	NEW STUD WALL
	EXISTING STUD WALL
	CMU WALL
	BRICK WALL
	FIRE RATED WALL
	1/2 HOUR
	1 HOUR
	2 HOUR

LIFE SAFETY LEGEND:

	EMERGENCY BACKUP LIGHT
	EXIT LIGHT
	SMOKE DETECTOR
	SMOKE & CO DETECTOR, SINGLE STATION
	PHOTOELEC SMOKE W/ SOUNDER BASE AND CO DETECTOR
	HEAT & CO DETECTOR
	HORN/SSTROBE
	HORN/SSTROBE - CEILING MOUNTED
	STROBE
	FIRE EXTINGUISHER IN RECESSED CABINET
	PULL STATION - SPRINKLER SYSTEM
	DATA/PHONE OUTLET

LIFE SAFETY NOTES:

LIFE SAFETY AND FIRE ALARM SYSTEMS SHALL BE DESIGNED AND INSTALLED PER NFPA 72, BY A CITY/ STATE APPROVED CONTRACTOR WITH A SEPARATE PERMIT.

ALL STROBES TO BE 30 CANDELA UNLESS OTHERWISE NOTED.

SYSTEM SHALL BE SUPERVISED BY AN OFF-SITE CERTIFIED BY THE CITY OF PORTLAND THIRD PARTY

PERMITTING AND INSTALLATION OF THE LIFE SYSTEM SHALL BE PERMITTED AND PERFORMED BY A CITY APPROVED CONTRACTOR

COORDINATE W/ MAIN BUILDING LIFE SAFETY SYSTEM AS REQ'D

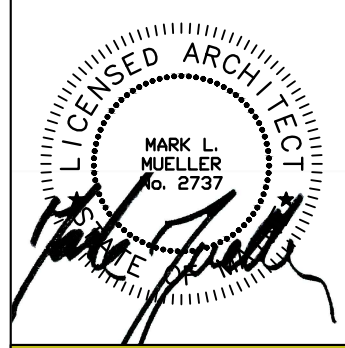
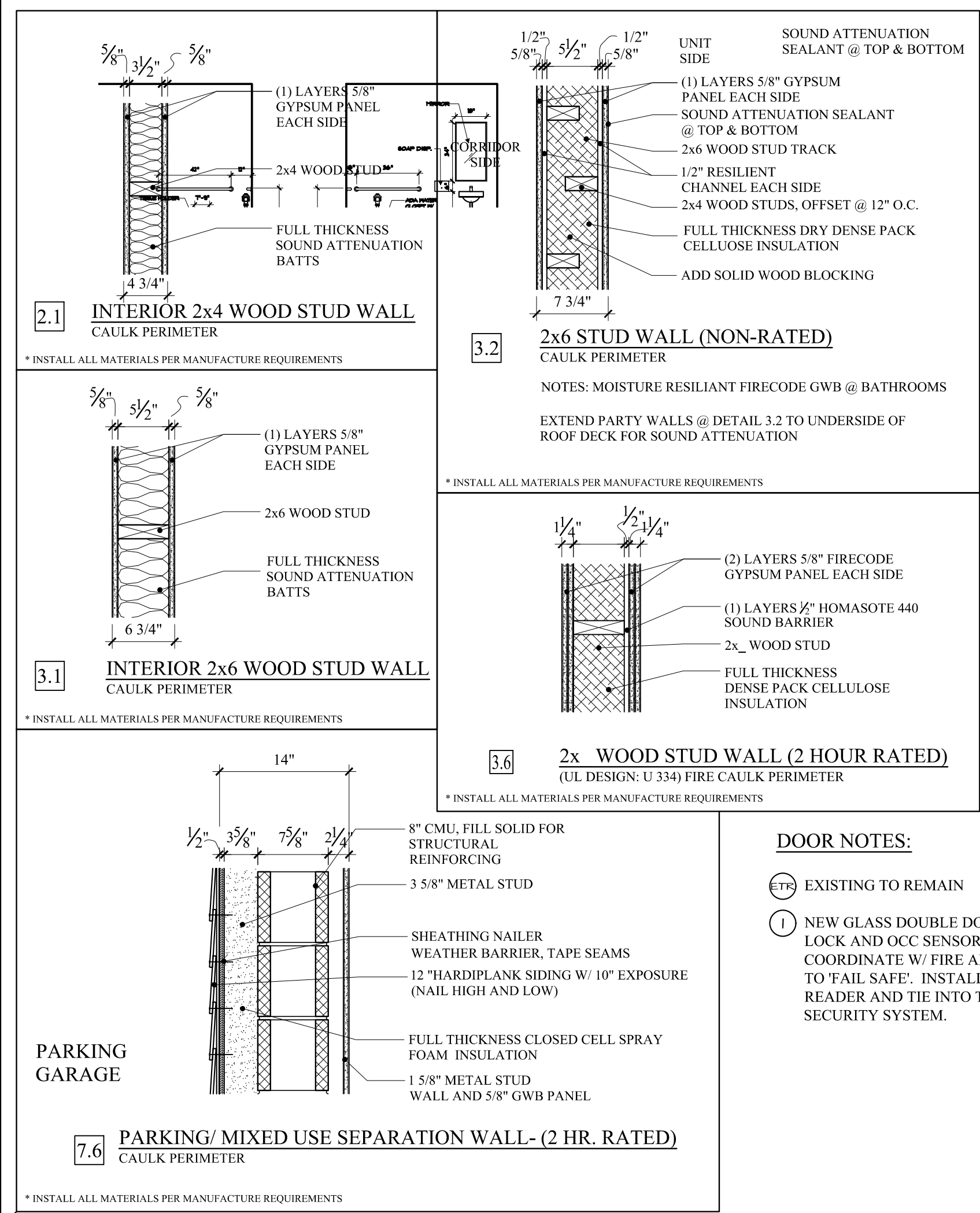

MARK MUELLER ARCHITECTS
A.I.A.
100 Commercial Street
Suite 205
Portland, Maine 04101
Phone: 207.774.9057
Email: rfi@muellerarchitects.com

© COPYRIGHT 2017
MARK MUELLER ARCHITECTS



TENANT FIT-UP FOR:
PROPOSED OLD PORT TILE FLOOR PLAN

DATE	OCT. 2017
PROJECT	INDIA STREET
DRAWN BY	MRP
CHECK BY	MLM

PERMIT SET: DECEMBER 27, 2017

A-1.1