

NEWBURY STREET (UN)

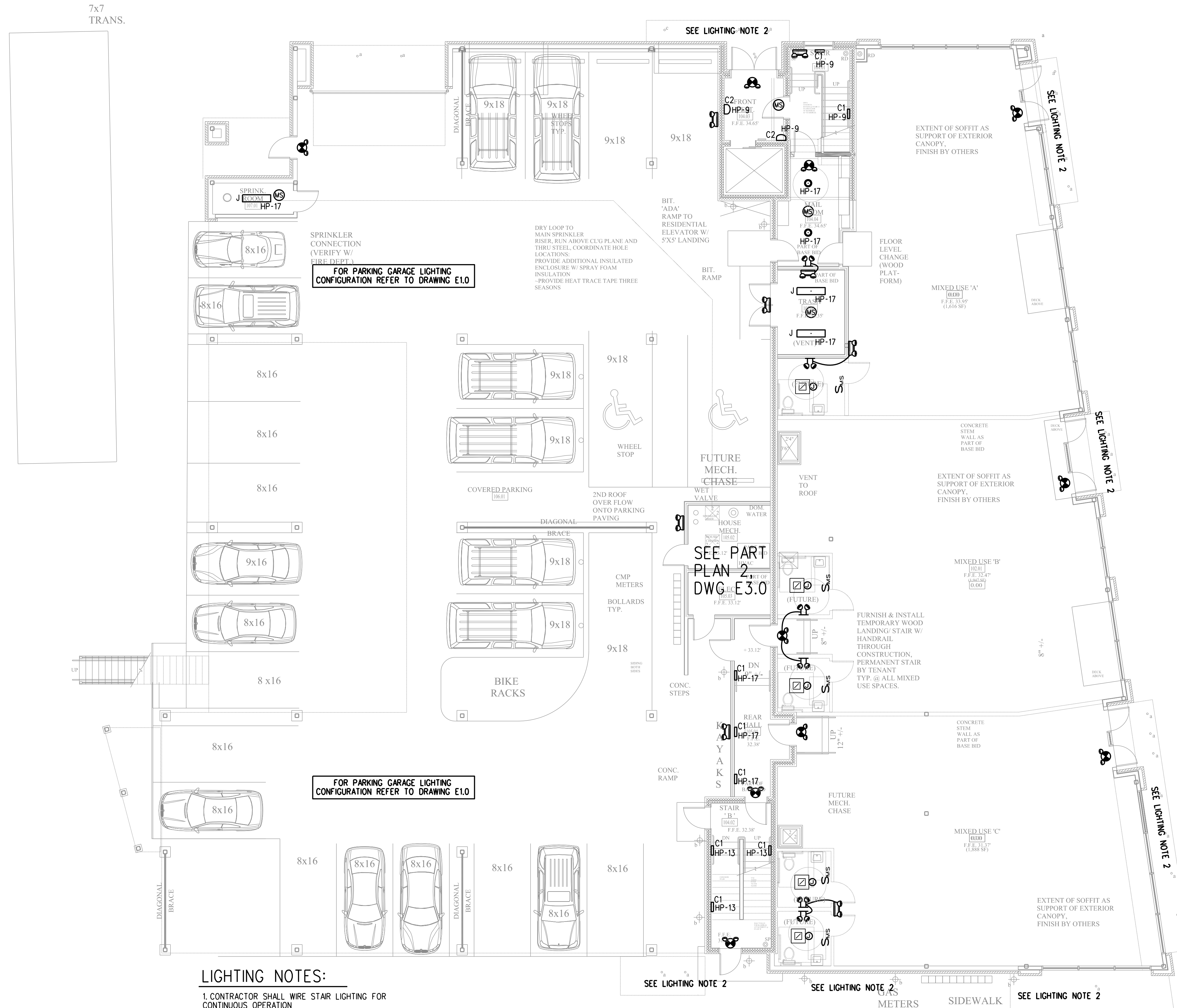

LIGHTING NOTES:

1. CONTRACTOR SHALL WIRE STAIR LIGHTING FOR CONTINUOUS OPERATION
2. REFER TO DRAWING E1.0 FOR ALL CANOPY AND PARKING GARAGE LIGHTING INFORMATION.

FIRST FLOOR PLAN

SCALE: 1/8" = 1'-0"

1ST FLOOR NOTES:
 MIXED USE COMMERCIAL SPACES ARE SHAL UNFINISHED AS PART OF THE BASIC CONTR
 WORK AT COMMERCIAL SPACES TO OBTAIN OCCUPANCY PERMITS WILL INCLUDE: SPRINKLER SYSTEMS, TEMP. HEAT, TEMP. LI LIFE SAFETY SYSTEM, SOILS AND RADON VE SYSTEMS, STUBS TO MAIN SEWER PIPING AN ROUGH-IN FOR FUTURE UTILITIES AND PROF EXPOSED COLUMNS AND SUPPORTING CONC STEM WALLS WITHIN THE SPACE. WITHIN ED WALLS WILL REQUIRE FIRE-SPRAY PROTECT PART OF THE BASIC CONTRACT. FIRE RATEI CEILING ASSEMBLY SHALL BE COMPLETED ENTIRETY. FIRE RATED WALL ASSEMBLY BI COMMERCIAL SPACE & PARKING AREA SHAL COMPLETED IN ITS ENTIRETY.
 GENERAL NOTE: PROVIDE A COMPLETE SPRI DESIGN FOR STRUCTURAL MECHANICAL COORDINA PRIOR TO STEEL SHOP DRAWINGS.

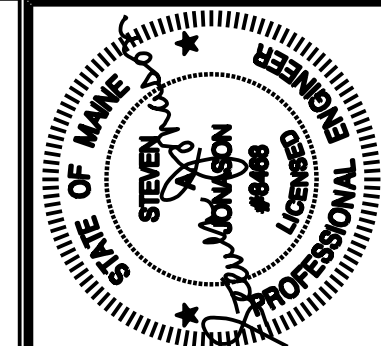

Prepared For:

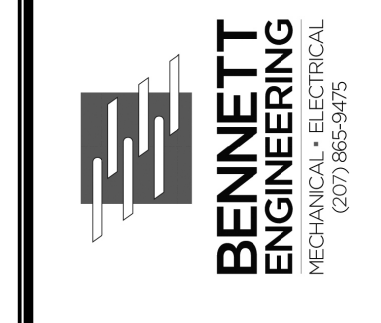

Consultant:

Architect:

Project: 62 India Street

NEWBURY / HANCOCK ST., PORTLAND ME

Revisions:
 ISSUED FOR PERMIT

Scale: 1/8" = 1'-0" or AS NOTED

Date: 11/18/16

FIRST FLOOR LIGHTING PLAN

E2.0