

FACADE MOUNT DECK DETAIL
SCALE: 3/4" = 1'-0"

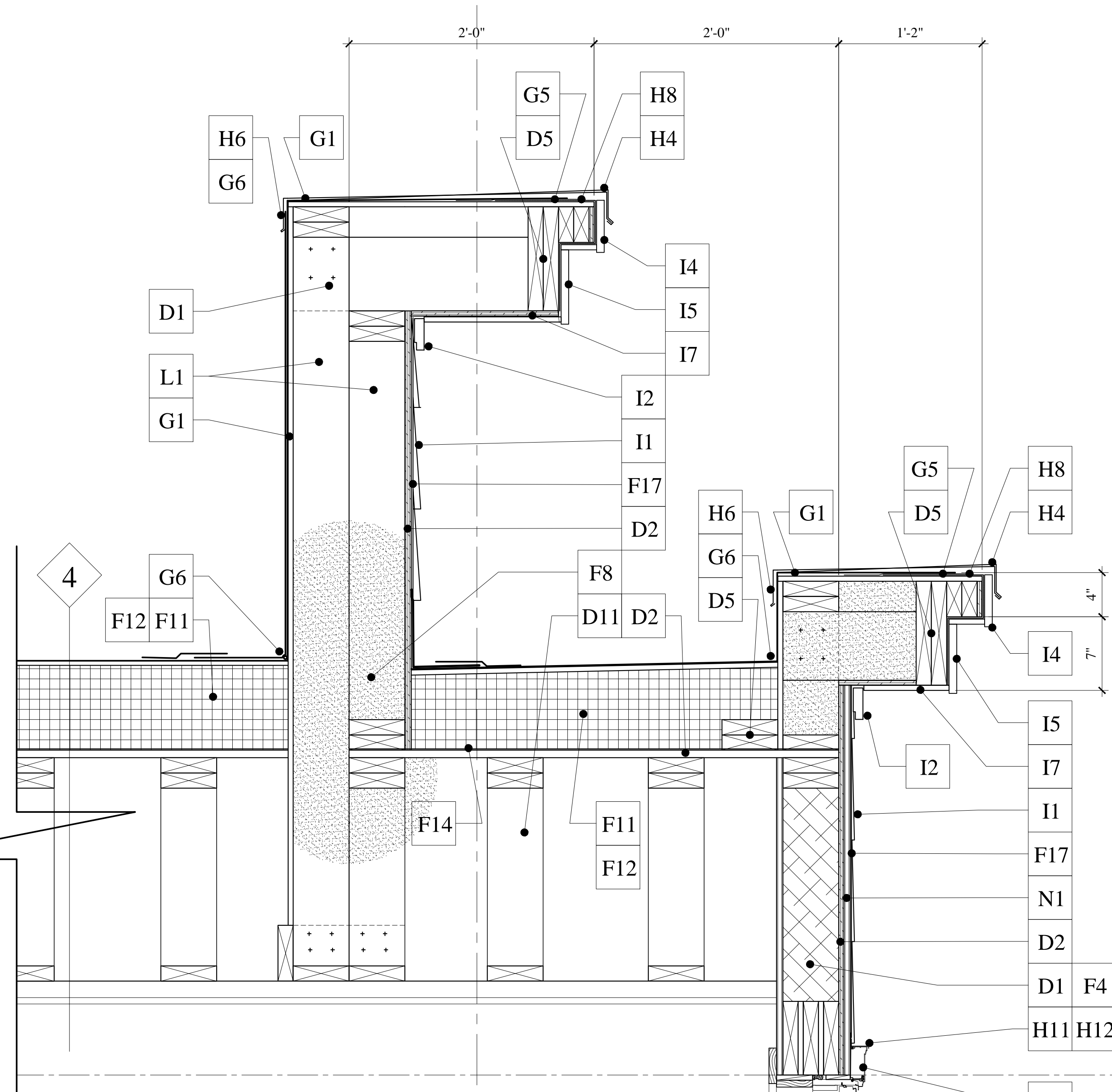

12 WALL SECTION @ PARAPET
A-3.6 SCALE: 1 1/2" = 1'-0"

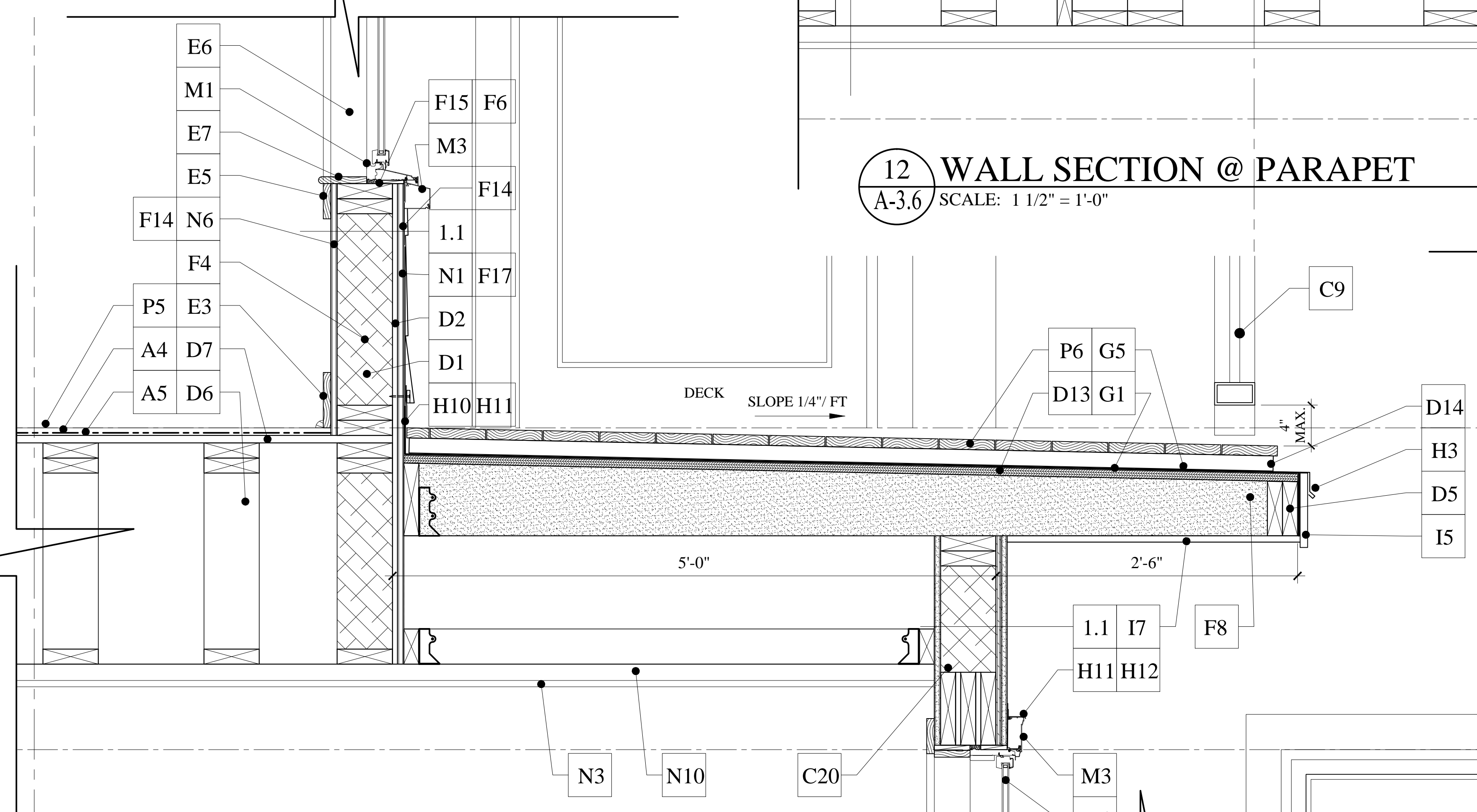

13 WALL SECTION @ ACCESS
A-3.6 SCALE: 1 1/2" = 1'-0"

- MATERIALS SCHEDULE:**
- | | | | |
|-----|--|-----|---|
| A1 | CAST IN PLACE CONCRETE WALL | F1 | CEMENTITIOUS WATERPROOFING |
| A2 | CONCRETE SLAB ON GRADE | F2 | FLUID APPLIED WATERPROOFING MEMBRANE |
| A3 | 1 1/2" GYP-CRETE | F3 | EXTRUDED POLYSTYRENE BOARD INSULATION (R-30 MIN.) |
| A4 | 3/4" GYP-CRETE | F4 | CELLULOSIC FIBER INSULATION (FULL THICKNESS) |
| A5 | SOUND ATTENUATION MAT (1/8") TURN UP WALL - TYPICAL | F5 | VAPOR RETARDER (UNDER SLAB) |
| A6 | CONCRETE SLAB (BROOM FINISH @ OUTDOOR PATIO) CONCRETE PIER | F6 | FOAM-IN-PLACE INSULATION SEALANT |
| A7 | | F7 | CLOSED CELL SPRAY FOAM INSULATION (R-21) |
| B1 | BRICK VENEER W/ CONTROL JOINTS - TYPICAL | F8 | CLOSED CELL SPRAY FOAM INSULATION (R-30) |
| B2 | BRICK ROWLOCK WINDOW SILL - TYPICAL | F9 | CLOSED CELL SPRAY FOAM INSULATION (FULL THICKNESS) |
| B3 | BRICK TERMINATION COURSE (SLOPED STRETCHER COURSE - PRE-MANUFACTURED) | F10 | OPEN CELL SPRAY FOAM INSULATION (FULL THICKNESS) |
| B4 | BRICK SOLDIER COURSE HEAD (1 COURSE) - TYPICAL | F11 | POLYISOCYANURATE BOARD INSULATION (POLYISO) - R-20 MIN |
| B5 | SUB-GRADE BRICK GROUT SOLID - TYPICAL | F12 | POLYISO TAPERED RIGID INSULATION (1/4" MIN TAPER) - R-20 MIN. TYPICAL |
| B6 | MORTAR NET - TYPICAL | F13 | WEATHER BARRIER (SHEET W/ OVERLAP) - TYPICAL |
| B7 | WEEP HOLE - TYPICAL | F14 | WEATHER BARRIER FLASHING TAPE |
| B8 | BRICK TIE / ANCHOR | F15 | FOUNDATION WEATHER BARRIER TAPE - TYPICAL |
| B9 | VERTICAL BRICK RELIEF, 1 1/2" RECESS | F16 | VAPOR BARRIER - TYPICAL |
| B10 | PRE-MANUFACTURED STRETCHER BRICK TERMINATION - TYPICAL | F17 | PRE-FABRICATED SILL DRAINAGE PAN (WINDOWS) |
| B11 | BRICK ENTABLATURE: (4) CORBEL, (2) STANDARD | F18 | COPPER PAN FLASHING W/ WELDED SEAMS, TYP. @ ALL EXTERIOR DECK DOORS |
| B12 | THRU-WALL / EMBEDDED COPPER FLASHING | F19 | DRAINABLE BUILDING WRAP - TYPICAL |
| B13 | FLASHING TAPE | F20 | SOUND ATTENUATED INSULATION (FULL THICKNESS) |
| B14 | COMPRESSIBLE FILLER (CLOSED CELL) | G1 | EPDM RUBBER DECK ROOFING - TYPICAL |
| B15 | 1 1/2" AIR SPACE - TYPICAL | G2 | EPDM @ PARAPET WALL - TYPICAL |
| C1 | STRUCTURAL STEEL | G3 | METAL TRANSITION STRIP - TYPICAL |
| C2 | STEEL LINTEL (LOOSE) | G4 | TERMINATION BAR |
| C3 | STEEL RELIEVING ANGLE | G5 | EPDM REINFORCING STRIP - TYPICAL |
| C4 | STEEL TUBE | G6 | NEOPRENE GASKET / EXPANSION JOINT BULB - TYPICAL |
| C5 | STEEL HANDRAIL POST W/ SHEET MEMBRANE FLASHING ROOT | G7 | EPDM PIPE FLASHING |
| C6 | STEEL ANGLE | G8 | ROOF DRAIN |
| C7 | STEEL PIPE HANDRAIL (PAINTED) | G9 | ROOF HATCH |
| C8 | STEEL SPIRAL STAIR (W/ WOOD TREADS & STEEL HANDRAIL) | G10 | DRAINAGE MAT |
| C9 | SQUARE ALUMINUM 42" HIGH HANDRAIL SYSTEM, BLACK (PRE-FABRICATED) | G11 | CAPILLARY WEEP |
| C10 | STAINLESS STEEL CANOPY SUPPORT SYSTEM | H1 | COPPER SHEET FLASHING |
| C11 | METAL PLATE/CLIP - REFER TO STRUCTURAL DRAWINGS - TYPICAL | H2 | ALUMINUM SHEET FLASHING |
| C12 | METAL STUD | H3 | PAINTED STEEL SHEET FLASHING |
| C13 | METAL SLEEVE (CAST IN CONCL.) | H4 | METAL ROOF EDGE STRIP - TYPICAL |
| D1 | WOOD FRAME WALL CONSTRUCTION - TYPICAL | H5 | COUNTER FLASHING - TYPICAL |
| D2 | STRUCTURAL "OSB" SHEATHING (REFER TO STRUCTURAL) - TYPICAL | H6 | METAL COPING - TYPICAL |
| D3 | WOOD BLOCKING | H7 | METAL FASCIA'S, RAKES AND SOFFITS - TYPICAL |
| D4 | WOOD NAILER | H8 | ICE AND WATER SHIELD FLASHING - TYPICAL |
| D5 | WOOD NAILED | H9 | 5" ALUMINUM SQUARE GUTTER & DOWNSPOUT, GREY |
| D6 | WOOD FRAME FLOOR TRUSS SYSTEM - TYPICAL | H10 | METAL FLASHING |
| D7 | 3/4" STRUCTURAL FLOOR SHEATHING - TYPICAL | H11 | WINDOW FLASHING SYSTEM - TYPICAL |
| D8 | FIRE RETARDANT TREATED LUMBER - TYPICAL | H12 | FLASHING TAPE |
| D9 | P.T. 2x SILL PLATE - TYPICAL | I1 | 12" CEMENTITIOUS SIDING (10" EXPOSURE) W/ METAL BACK FLASHING - TYPICAL |
| D10 | BUILT-UP 2x - TYPICAL | I2 | 5/4x6 CEMENTITIOUS TRIM |
| D11 | WOOD FRAME ROOF TRUSS SYSTEM - TYPICAL | I3 | 5/4x6 CEMENTITIOUS TRIM |
| D12 | TAPERED DECK JOISTS (TAPER 1/2" / FT. - TAPER MIN. PER STRUCTURALS) TYP. | I4 | 1x6 CEMENTITIOUS TRIM |
| D13 | DECK SHEATHING (REFER TO STRUCTURALS) - TYPICAL | I5 | 1x8 CEMENTITIOUS TRIM |
| D14 | P.T. SLEEPER W/ EPDM SOLES THREE SIDES (GLUE) - TYPICAL | I6 | 1x10 CEMENTITIOUS TRIM |
| D15 | LVL BEAM / HEADER | I7 | 3x CEMENTITIOUS SOFFIT PANEL |
| E1 | 1x6 WOOD TRIM - TYPICAL | I8 | 3x CEMENTITIOUS TRIM |
| E2 | 1x4 WOOD TRIM - TYPICAL | J1 | CEMENTITIOUS SPRAY FIRE RESISTIVE MATERIAL - TYPICAL |
| E3 | 1x6 WOOD (POPLAR) BASEBOARD W/ 3/4" QUARTER ROUND - TYPICAL | J2 | FIRE STOPPING |
| E4 | WOOD BASE - REFER TO INTERIOR ELEVATIONS/FINISH SCHEDULE - TYPICAL | K1 | SILL SEALANT - TYPICAL |
| E5 | 1x4 WOOD (POPLAR) TRIM, PAINTED - TYPICAL | K2 | BACKER ROD (CLOSED CELL) & SEALANT @ BRICK VENEER - TYPICAL |
| E6 | 1x WOOD (POPLAR) EXTENSION JAMBS, PAINTED (FIELD APPLIED) - TYPICAL | K3 | BACKER ROD (CLOSED CELL) & SEALANT (HEAD, JAMB AND SILL) - TYPICAL |
| E7 | 1x WOOD (POPLAR) SILL PAINTED FINISH (FIELD APPLIED) - TYPICAL | K4 | CONTROL JOINT W/ CLOSED CELL FOAM FILLER |
| E8 | PAINTED MDF CLOSET SHELF & PAINTED WOOD ROD | L1 | WOOD DOOR |
| E9 | SOLID SURFACE SHOWER SEAT | L2 | HOLLOW METAL FRAME W/ SOUND / SMOKE SEAL STEEL DOOR (INSULATED) |
| E10 | MILLWORK | L3 | ALUMINUM FRAME W/ SOUND / SMOKE SEAL |
| | | L4 | ALUMINUM DOOR |
| | | L5 | ALUMINUM DOOR SILL (ADA) |
| | | L6 | WOOD CLAD DOOR (EXTERIOR) |
| | | L7 | FIELD APPLIED EXTERIOR DOOR CASING BY MANUFACTURER |
| | | L8 | METAL OVERHEAD ROLLING DOOR SYSTEM |
| | | L9 | |
| | | M1 | RESIDENTIAL WOOD CLAD WINDOW |
| | | M2 | FACTORY MULL (ONLY NARROW MULL) - TYPICAL |
| | | M3 | FIELD APPLIED EXTERIOR WINDOW CASING BY MANUFACTURER |
| | | M4 | ALUMINUM STOREFRONT WINDOW SYSTEM |
| | | M5 | SKYLIGHT W/ FALL PROTECTION GLAZING |
| | | N1 | EXTERIOR FIRE CODE SHEATHING (DENS GLASS) - TYPICAL |
| | | N2 | FIRE CODE TYPE 'X' GWB |
| | | N3 | FIRE CODE TYPE 'C' GWB |
| | | N4 | MOISTURE & MOLD RESISTANT GWB |
| | | N5 | DENS DECK GWB SHEATHING |
| | | N6 | INTERIOR GWB SHEATHING |
| | | N7 | GWB FIRE RATED SHAFT WALL ASSEMBLY |
| | | N8 | TILE BACKER BOARD |
| | | N9 | 1/2" RESILIENT CHANNEL - TYPICAL |
| | | N10 | 7/8" HAT CHANNEL W/ GENIE CLIPS - TYPICAL |
| | | N11 | 7/8" HAT CHANNEL |
| | | O1 | SUSPENDED NON-RATED EXTERIOR GWB, CEILING |
| | | O2 | SUSPENDED ACOUSTICAL CEILING |
| | | O3 | WOOD FIBER CORE CEILING |
| | | O4 | 5" VINYL V-GROOVE CEILING W/ SCOTIA - TYPICAL |
| | | P1 | FLOOR TILE |
| | | P2 | WALL TILE |
| | | P3 | CARPET |
| | | P4 | RECESSED ENTRY MAT |
| | | P5 | PRE-ENGINEERED FLOATING HARDWOOD FLOOR - TYPICAL |
| | | P6 | COMPOSITE EXTERIOR DECKING |
| | | P7 | VCT |
| | | P8 | FLOORING TRANSITION STRIP |
| | | Q1 | RECESSED LIGHT (CEILING MOUNT) - TYPICAL |
| | | Q2 | RECESSED LIGHT (WALL MOUNT) - TYPICAL, 18" AFF. WALL SCENCE |
| | | Q3 | |
| | | R1 | CRUSHED ROCK |
| | | R2 | COMPACTED SAND |
| | | R3 | COMPACTED FILL |
| | | R4 | FILTER FABRIC |
| | | R5 | SAND BASE |
| | | R6 | "OLD PORT" PAVER SIDEWALK - TYPICAL |
| | | R7 | BITUMINOUS PAVING - TYPICAL |
| | | R8 | RADON/SUB-SURFACE SOIL MITIGATION SYSTEM (VENT THRU ROOF) |
| | | R9 | VAPOR RETARDER |
| | | R10 | GEOTEXTILE FABRIC |
| | | R11 | WATER STOP |
| | | R12 | SUB-SURFACE GROUND IMPROVEMENT |

MARK MUELLER ARCHITECTS
A.I.A.
100 Commercial Street
Suite 205
Portland, Maine 04101
Phone: 207.774.9057
Email: rfm@muellerarchitects.com

© COPYRIGHT 2016
MARK MUELLER ARCHITECTS

62
I
N
D
I
A

INDIA STREET NEIGHBORHOOD
PORTLAND, MAINE

DETAILS

DATE	
PROJECT	INDIA STREET
DRAWN BY	
CHECK BY	MAM

FOUNDATION PERMIT
JULY 8, 2016

A-5.3