

DISPLAY THIS CARD ON PRINCIPAL FRONTAGE OF WORK
CITY OF PORTLAND

Please Read
Application And
Notes, If Any,
Attached

BUILDING DEPARTMENT

PERMIT

Permit Number: 071497

This is to certify that JORDAN'S READY TO EAT MEATS Services, Inc

has permission to Remove 5,000 gallon #4 fuel tank back with same compact

AT 62 INDIA ST E 028 P008001

provided that the person or persons, firm or corporation accepting this permit shall comply with all of the provisions of the Statutes of Maine and of the ordinances of the City of Portland regulating the construction, maintenance and use of buildings and structures, and of the application on file in this department.

Apply to Public Works for street line and grade if nature of work requires such information.

Notification inspection must given and when permit is procured before this building is started or altered or repaired or closed-in. 24 HOUR NOTICE IS REQUIRED.

A certificate of occupancy must be procured by owner before this building or part thereof is occupied.

OTHER REQUIRED APPROVALS

Fire Dept. Craig Cass (See Con. Plans)

Health Dept. _____

Appeal Board _____

Other _____

Department Name

DEC 19 2007
CITY OF PORTLAND

Janie Bank 12/11/07
Director - Building & Inspection Services

PENALTY FOR REMOVING THIS CARD

BUILDING PERMIT INSPECTION PROCEDURES

Please call 874-8703 or 874-8693 to schedule your inspections as agreed upon

Permits expire in 6 months, if the project is not started or ceases for 6 months.

The Owner or their designee is required to notify the inspections office for the following inspections and provide adequate notice. Notice must be called in 48-72 hours in advance in order to schedule an inspection:

By initializing at each inspection time, you are agreeing that you understand the inspection procedure and additional fees from a "Stop Work Order" and "Stop Work Order Release" will be incurred if the procedure is not followed as stated below.

_____ **Pre-construction Meeting:** Must be scheduled with your inspection team upon receipt of this permit. Jay Reynolds, Development Review Coordinator at 874-8632 must also be contacted at this time, before any site work begins on any project other than single family additions or alterations.

_____ **Footing/Building Location Inspection:** Prior to pouring concrete

_____ **Re-Bar Schedule Inspection:** Prior to pouring concrete

_____ **Foundation Inspection:** Prior to placing ANY backfill

_____ **Framing/Rough Plumbing/Electrical:** Prior to any insulating or drywalling

_____ **Final/Certificate of Occupancy:** Prior to any occupancy of the structure or use. NOTE: There is a \$75.00 fee per inspection at this point.

Certificate of Occupancy is not required for certain projects. Your inspector can advise you if your project requires a Certificate of Occupancy. All projects DO require a final inspection

_____ **If any of the inspections do not occur, the project cannot go on to the next phase, REGARDLESS OF THE NOTICE OR CIRCUMSTANCES.**

_____ **CERTIFICATE OF OCCUPANCIES MUST BE ISSUED AND PAID FOR, BEFORE THE SPACE MAY BE OCCUPIED**



Signature of Applicant/Designee

Date

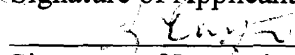

Signature of Inspections Official

12/13/07

Date

CBL: 25-PC05

Building Permit #: 01-1-997

City of Portland, Maine - Building or Use Permit Application
 389 Congress Street, 04101 Tel: (207) 874-8703, Fax: (207) 874-8716

Permit No: 07-1497	Issue Date:	CBL: 028 P008001
-----------------------	-------------	---------------------

Location of Construction: 62 INDIA ST	Owner Name: JORDAN'S READY TO EAT MEA	Owner Address: 38 INDIA ST	Phone:
Business Name:	Contractor Name: ENPRO Services, Inc.	Contractor Address: 31 Waldron Way Portland	Phone: 2078783031
Lessee/Buyer's Name	Phone:	Permit Type: Tanks - Removal	Zone: 52B

Past Use: Commercial	Proposed Use: Commercial - Remove 5,000 gallon #4 fuel tank back fill with sand compacted	Permit Fee: \$35.00	Cost of Work: \$35.00	CEO District: 1
Proposed Project Description: Remove 5,000 gallon #4 fuel tank back fill with sand compacted		FIRE DEPT: <input checked="" type="checkbox"/> Approved <input type="checkbox"/> Denied <i>See conditions</i>	INSPECTION: Use Group: F Type: TANK REMOVAL	
		Signature: <i>[Signature]</i> Signature: <i>[Signature]</i> 12/11/07		
PEDESTRIAN ACTIVITIES DISTRICT (P.A.D.)				
Action: <input type="checkbox"/> Approved <input type="checkbox"/> Approved w/Conditions <input type="checkbox"/> Denied				
Signature: _____ Date: _____				

Permit Taken By: ldobson	Date Applied For: 12/11/2007	Zoning Approval		
1. This permit application does not preclude the Applicant(s) from meeting applicable State and Federal Rules. 2. Building permits do not include plumbing, septic or electrical work. 3. Building permits are void if work is not started within six (6) months of the date of issuance. False information may invalidate a building permit and stop all work..		Special Zone or Reviews <input type="checkbox"/> Shoreland <input type="checkbox"/> Wetland <input type="checkbox"/> Flood Zone <input type="checkbox"/> Subdivision <input type="checkbox"/> Site Plan Maj <input type="checkbox"/> Minor <input type="checkbox"/> MM <input type="checkbox"/> Date: _____	Zoning Appeal <input type="checkbox"/> Variance <input type="checkbox"/> Miscellaneous <input type="checkbox"/> Conditional Use <input type="checkbox"/> Interpretation <input type="checkbox"/> Approved <input type="checkbox"/> Denied Date: _____	Historic Preservation <input type="checkbox"/> Not in District or Landmark <input type="checkbox"/> Does Not Require Review <input type="checkbox"/> Requires Review <input type="checkbox"/> Approved <input type="checkbox"/> Approved w/Conditions <input type="checkbox"/> Denied Date: _____

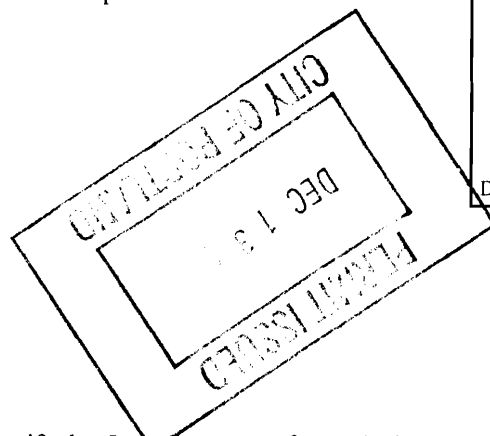

CERTIFICATION

I hereby certify that I am the owner of record of the named property, or that the proposed work is authorized by the owner of record and that I have been authorized by the owner to make this application as his authorized agent and I agree to conform to all applicable laws of this jurisdiction. In addition, if a permit for work described in the application is issued, I certify that the code official's authorized representative shall have the authority to enter all areas covered by such permit at any reasonable hour to enforce the provision of the code(s) applicable to such permit.

 SIGNATURE OF APPLICANT ADDRESS DATE PHONE

 RESPONSIBLE PERSON IN CHARGE OF WORK, TITLE DATE PHONE

City of Portland, Maine - Building or Use Permit

389 Congress Street, 04101 Tel: (207) 874-8703, Fax: (207) 874-8716

Permit No: 07-1497	Date Applied For: 12/11/2007	CBL: 028 P008001
------------------------------	--	----------------------------

Location of Construction: 62 INDIA ST	Owner Name: JORDAN'S READY TO EAT MEA	Owner Address: 38 INDIA ST	Phone:
Business Name:	Contractor Name: ENPRO Services, Inc.	Contractor Address: 31 Waldron Way Portland	Phone: (207) 878-3031
Lessee/Buyer's Name	Phone:	Permit Type: Tanks - Removal	

Proposed Use: Commercial - Remove 5,000 gallon #4 fuel tank back fill with sand compacted	Proposed Project Description: Remove 5,000 gallon #4 fuel tank back fill with sand compacted
---	--

Dept: Zoning	Status: Not Applicable	Reviewer: Jeanine Bourke	Approval Date: 12/11/2007
Note:			Ok to Issue: <input checked="" type="checkbox"/>
Dept: Building	Status: Approved	Reviewer: Jeanine Bourke	Approval Date: 12/11/2007
Note:			Ok to Issue: <input checked="" type="checkbox"/>
Dept: Fire	Status: Approved with Conditions	Reviewer: Capt Greg Cass	Approval Date: 12/11/2007
Note:			Ok to Issue: <input checked="" type="checkbox"/>
1) Tank removal shall comply with NFPA # 1 chapter 66.2.5.5 and NFPA 30. A copy is available upon request.			



General Building Permit Application

If you or the property owner owes real estate or personal property taxes or user charges on any property within the City, payment arrangements must be made before permits of any kind are accepted.

Location/Address of Construction: <u>Former Jordan's Meats, 38 India Street, Portland, Me</u>		
Total Square Footage of Proposed Structure/Area <u>600 (EXCAVATION SIZE)</u>		Square Footage of Lot
Tax Assessor's Chart, Block & Lot Chart# Block# Lot# <u>28 P 8</u>	Applicant * must be owner, Lessee or Buyer* Name <u>PME-1 Limited Partnership</u> Address <u>1140 Reservoir Ave</u> City, State & Zip <u>Cranston, RI</u>	Telephone: <u>(401) 946-4600</u> <u>Tom Niles</u>
Lessee/DBA (If Applicable)	Owner (if different from Applicant) Name <u>PME-1 Limited Partnership</u> Address <u>1140 Reservoir Ave</u> City, State & Zip <u>Cranston, RI</u> <u>02920</u>	Cost Of Work: \$ <u>7,200</u> C of O Fee: \$ _____ Total Fee: \$ <u>35⁰⁰/₁₀₀</u>
Current legal use (i.e. single family) <u>VACANT</u> If vacant, what was the previous use? <u>Meat Processing</u> Proposed Specific use: <u>Re-Development</u> Is property part of a subdivision? <u>NO</u> If yes, please name _____ Project description: <u>EXCAVATION & Removal of 5,000 gallon #4 Heating Oil Tank. Waste materials to be shipped to ENPRO Services, South Portland & Commercial Recycling, Scarborough, Me. Tank to be disposed of at New England Metal Recycling, Portland, Me. SAND to be used for Backfilling Compact</u>		
Contractor's name: <u>ENPRO Services, Inc</u> Address: <u>31 Waldron Way</u> City, State & Zip <u>Portland Maine 04101</u> Telephone: <u>207 878 3031</u> Who should we contact when the permit is ready: <u>Scott Albock</u> Telephone: <u>207 878 3031</u> Mailing address: <u>31 Waldron Way Portland, Me 04101</u>		

Please submit all of the information outlined on the applicable Checklist. Failure to do so will result in the automatic denial of your permit.

In order to be sure the City fully understands the full scope of the project, the Planning and Development Department may request additional information prior to the issuance of a permit. For further information or to download copies of this form and other applications visit the Inspections Division on-line at www.portlandmaine.gov, or stop by the Inspections Division office, room 315 City Hall or call 874-8703.

I hereby certify that I am the Owner of record of the named property, or that the owner of record authorizes the proposed work and that I have been authorized by the owner to make this application as his/her authorized agent. I agree to conform to all applicable laws of this jurisdiction. In addition, if a permit for work described in this application is issued, I certify that the Code Official's authorized representative shall have the authority to enter all areas covered by this permit at any reasonable hour to enforce the provisions of the codes applicable to this permit.

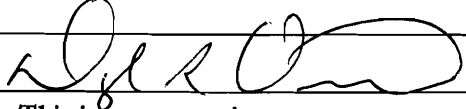
Signature: 

Date: 12-11-07

This is not a permit; you may not commence ANY work until the permit is issue

Maine Department of Environmental Protection
Bureau of Remediation and Waste Management
17 State House Station
Augusta, Maine 04333-0017
Attention: Tank Removal Coordinator
Telephone: (207) 287-2651

Expires after six (6) months if the
Department does not receive removal
confirmation.

**NOTICE OF INTENT TO ABANDON (REMOVE)
AN UNDERGROUND OIL STORAGE FACILITY
OR UNDERGROUND PRODUCT PIPING**

**THIS FORM MUST BE FILED WITH THE DEP AND YOUR LOCAL FIRE DEPARTMENT AT
LEAST 30 DAYS PRIOR TO THE SCHEDULED REMOVAL**

PLEASE TYPE OR PRINT IN INK:

Name of Facility Owner: PME-1 LIMITED PARTNERSHIP
Mailing Address: 1140 RESERVOIR AVE Telephone #: _____
City: CRANSTON State: RI Zip Code: 02920
Contact Person (name, address & telephone #): TOM NIKES, TPG DEVELOPMENT
1140 RESERVOIR AVE, CRANSTON RI 02920 401-946-4600
Name of Facility: JORDAN'S MEATS Registration #: 1367
Facility Location (town & street): 38 INDIA STREET, PORTLAND

1. Identify the tanks at this location which are going to be removed:

<u>DEP Registered #</u>	<u>Tank Age</u>	<u>Tank Size</u>	<u>Piping Age</u>	<u>Type of Product Stored</u>
<u>1367</u>	<u>15 YEAR</u>	<u>5000 GAL</u>	<u>15 YR</u>	<u>#4 HEATING OIL</u>
_____	_____	_____	_____	_____
_____	_____	_____	_____	_____

2. Directions to this facility (be specific): I-295 TO PORTLAND, EXIT 7,
EASTON FRANKLIN ARTERIAL, 0.7 MI, RT ON MIDDLE ST, RT ON INDIA ST

3. Is or was the tank(s) or piping used to store Class I liquids (e.g., gasoline, jet fuel)?
Yes ___ No

**IF YES, REMOVAL OF THE TANK(S) MUST BE DONE UNDER THE
DIRECTION OF A CERTIFIED TANK INSTALLER.**

Tank Installer's Name: _____ Certification #: _____ Signature: _____

4. Environmental site assessments are required for all tanks or product piping except those
used for storing #2 oil, kerosene, and other heating oils that have not been heated during
storage, not for resale, or for farm or residential motor fuel tanks under 1,100 gallons where the
product is used on site. Site Assessor's Name and Address (if applicable):

ENPRO SERVICES, INC 31 WALDRON WAY, PORTLAND ME 04108

5. Name and telephone number of contractor who will do the tank removal:

ENPRO SERVICES, INC 878-3031

6. Expected date of removal (month/day/year): 11 / 15 / 07

I hereby provide Notice that I intend to properly abandon the underground oil storage facility as described
above.

Date: September 12, 2007 Signature of Owner or Operator: [Signature]

Printed Name and Title: Vice President of Development, TPG Development, LLC

Mail one copy to the DEP and one to the fire department. Retain one copy for your records.

SEND REMOVAL CONFIRMATION TO THE DEP AFTER TANK(S) HAVE BEEN REMOVED

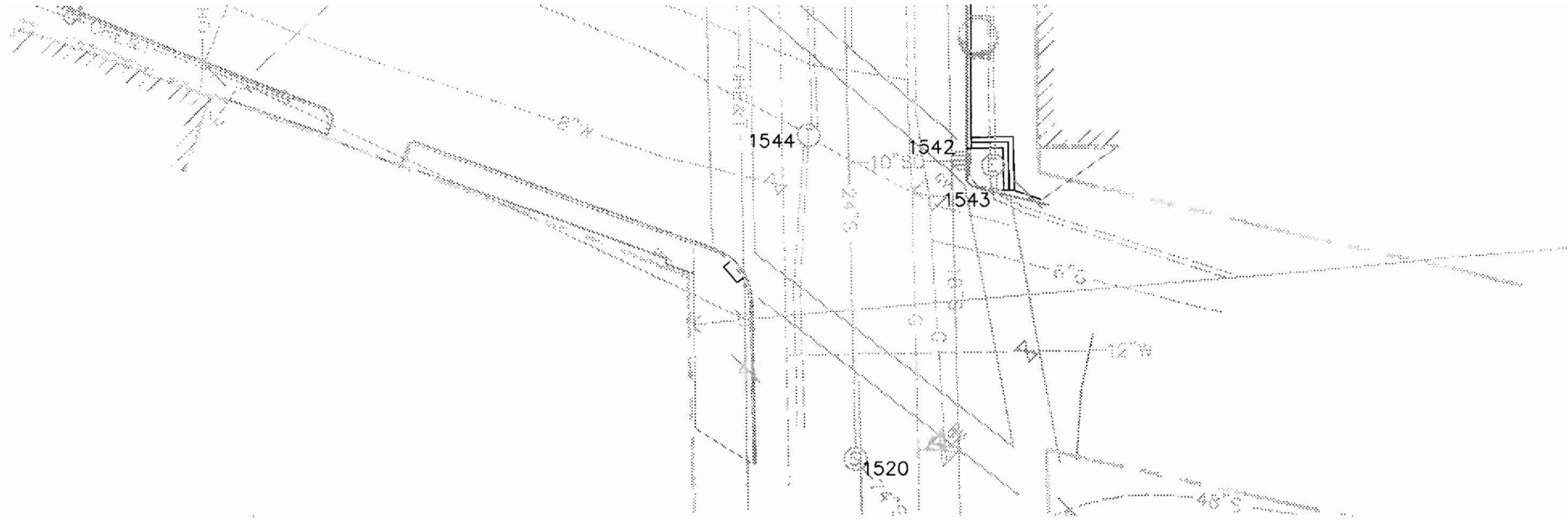

18.58
22.42
23.81
24.59
VEL 22.93
23.32
55)

UTILITY STRUCTURE CHART							
STRUCTURE TYPE	STRUCTURE #	RIM ELEVATION	INVERT ELEVATION (PLAN)	TO/FROM	OTHER STRUCTURE # OR DIRECTION	SIZE (INCHES)	MISCELLANEOUS NOTE
SMH	2312	28.65	15.63	I	2626	24"	
	2312		15.23	O	2317		
SMH	2317	28.48	12.56	I	3149		EL. 13.58 AT CULV LOC. ±
	2317		13.58	O	1339	24"B	
	2317			I	2305		
	2317			I	2312		
CB	2328	27.71		O	NW		TOP TRAP 23.87 - WATER LEVEL 23.49
CB	2331	28.68	25.52	O	SW	6"PVC	
CB	2345	28.35	24.14	O	2346	6"PVC	
DMH	2346	28.28	23.49	I	2345	6"PVC	
	2346		23.92	I	NW	6"PVC	TO CB OFFSITE
	2346			O	NW	12"C	22.95 TOP TRAP (22.04 WATER LEVEL)
EMH	2472	27.95					
SMH	2622	28.92	19.51	I	2626		
	2622		19.84	I	SW	36"ESVCP	MAIN (IN) FLOW ON MIDDLE ST.
	2622		18.88	O	2784	48"C	
TMH	2625	28.02					
SMH	2626	28.69	19.77	I	2622	(24")	
	2626		19.72	O	2312	24"	
CB	2635	29.48	24.43	I	NW	12"CLAY	
	2635		23.95	O	2601	10"CLAY	
DMH	2646	28.22	21.9	I	2647	12"PVC	
	2646		21.73	O	2667	12"PVC	
CB	2647	29.7	24.06	O	2646	18"PVC	
CB	2666	24.69	19.04	O	2667	12"PVC	
DMH	2667	25.09	18.29	I	2646	15"PVC	
	2667		18.77	I	2666	12"PVC	
	2667		18.5	O	NE	12"PVC	
CB	2725	19.96	14.77	O	3148	12"C	
	2725						
CB	2725	19.96	14.77	O	3148	12"C	
SMH	2780	20.03	5.13	I	3084	18"	
	2780		4.93	I	1348	30"	
	2780		4.48	O	1149	24"	
	2780			O	2784		OVERFLOW TO 2784
CB	2783	20.31		O	3148		10.30 TOP TRAP (9.30 WATER LEVEL)
	2783						

UTILITY STRUCTURE CHART							
STRUCTURE TYPE	STRUCTURE #	RIM ELEVATION	INVERT ELEVATION (PLAN)	TO/FROM	OTHER STRUCTURE # OR DIRECTION	SIZE (INCHES)	
SMH	2784	19.67	5.16	I	2780		
	2784		4.87	I	2991		
	2784			I			
	2784		4.32	O	3173		
CB	2891	30.24		O	SW	12"	
SMH	2991	20.36	12.38	I	S	(18" VI	
	2991		12.32	I	SW		
	2991		12.14	O	2784	(18" VI	
DMH	3034	17.73		O	3083		
	3034		13.24	I	SW	15" CO	
CB	3082	19.18	14.87	I	SW	6"CLAY	
	3082			O	2784		
CB	3083	19.01	11.39	I	SW	12"	
	3083		9.83	I	3034	18"	
	3083		9.78	O	3084	18" CL	
DMH	3084	19.75	5.39	I	3083	18" CL	
	3084		5.47	O	2780	18" CL	
CB	3148	18.33	13.13	I	2725	12"C	
	3148			O	SW	12"C	
SMH	3149	28.71	14.03	I	2299		
	3149		15.15	I	2305	30"	
	3149		13.8	O	2317		
CB	3151	15.73	11.94	O	1142		
CB	3211	27.56		O	NE		
SMH	3324	25.28	14.32	I	1920	24"	
	3324		14.29	O	1520	24"	

STATE C
CUMBERLAND
RECEIVED ___
AT ___h ___
PLAN BOOK
ATTEST ___

NEWBURY STREET

GRID

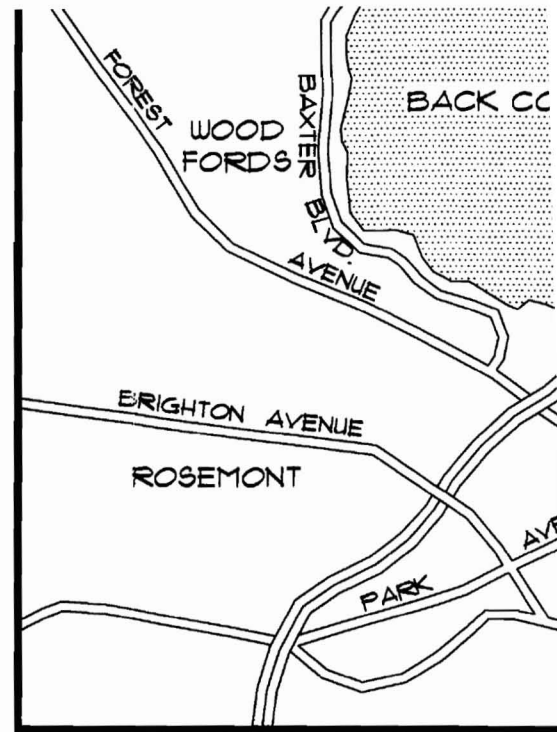

LOCATION MAP

LEGEND
EXISTING

BENCHMARK
X ON FLANGE BOLT
ON FIRE HYDRANT
ELEV = 28.99'

MANHOLE & HAND HOLES ON
CONCRETE PAD FOR
UNDERGROUND OIL TANK(S)

★
Tank Removal
AREA.

LAWN

(FOUNTAIN)

INDIA STREET

1920

1921

3211

1883

1922

1655

2249

1877

3324

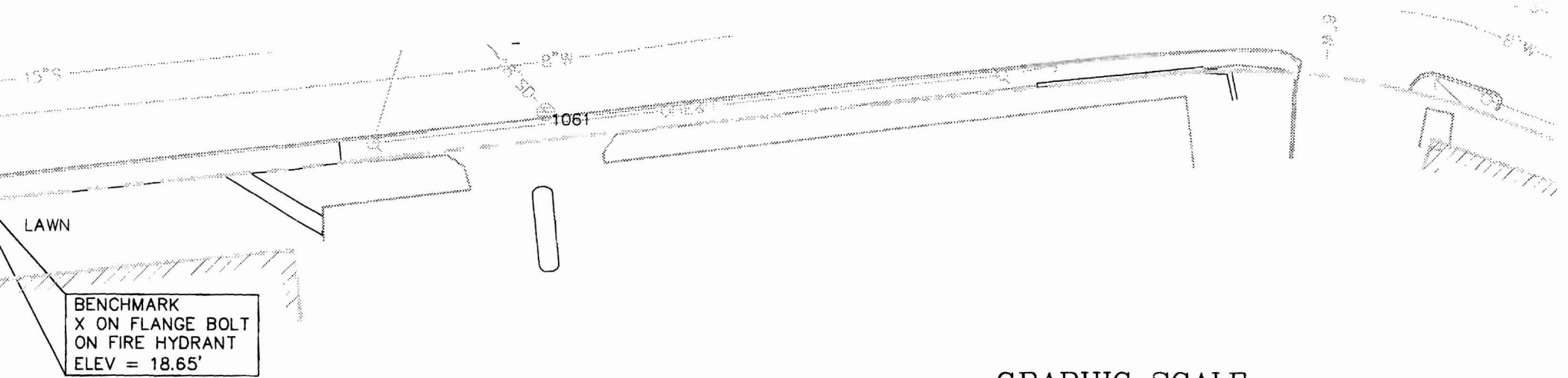

TRAFFIC CONTROL BOX
M.I.D. UNDER PAVEMENT
TRAFFIC SIGNAL LOOPS
AT FRANKIN & FORE

GRAPHIC SCALE

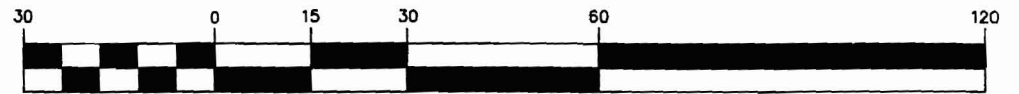

(IN FEET)

1 inch = 30 ft.

** SEE SHEET 1 OF 2 FOR NOTES AND BOUNDARY INFORMATION.

STRUCTURE CHART

RIM ELEVATION	INVERT ELEVATION (PLAN)	TO/FROM	OTHER STRUCTURE # OR DIRECTION	SIZE (INCHES)	MISCELLANEOUS NOTE
7.03					
5.21		O	1142		11.87 TOP TRAP (11.13 WATER LEVEL)
0.35	11.3	O	1121	12"VIT	END ES
9.64	11.32	I	NW	10"	FROM BDG
	11.13	O	SE	10"	MAIN ES LN
3.46	9.51	I	1111	12"VIT	
	9.46	O	1142	12"VIT	
6.7		O	SE		TOP TRAP 13.12 WATER LEVEL 12.49
1.52	9.85	I	1262	12"	
	9.67	O	SE	12"	MAIN ES LN
.23	10.02	I	3151	18"CLAY	
	8.08	I	1121	10"CLAY	
	9.58	I	1061	18"CLAY	
	7.96	O	1149	18"CLAY	
.43	5.1	I	2780	24"	
	6.68	I	1142		
	10.25	I	NW	6"	
	9.02	I	SE	6"	
	4.42	O	SE	30"	
42		O	SW		11.90 TOP TRAP (11.90 WATER LEVEL)
31	13.37	I	NW		TOP PIPE FROM BDG
	13.15	I	NW		TOP PIPE FROM BDG
	11.71	I	NW		BOTTOM SMH
		O	1134		13.36" TOP PIPE FROM BDG
92	11.81	O	1348	10"	TOWARDS BDG
37	10.46	I	1340	10"	
	6.29	I	2317	24" B	
	6.23	O	1348	30"VIT	
15		O	1339		CB IS COMPLETELY FULL OF SAND
12	5.98	I	1339	30"VIT	
	5.87	O	2780	30"VIT	
	6.84	I	1270	10"	
5					
16	10.31	O	1520	24"VIT	ABANDONED
	10.38	I	SE	24"VIT	ABANDONED
6	3.75	I	1655	18"VIT	
	14	I	NW	8"	
	8.98	I	1520	24"VIT	
	3.72	O	SE	48"BR	

UTILITY STRUCTURE CHART

STRUCTURE TYPE	STRUCTURE #	RIM ELEVATION	INVERT ELEVATION (PLAN)	TO/FROM	OTHER STRUCTURE # OR DIRECTION	SIZE (INCHES)	MISCELLANEOUS NOTE
SMH	1520	20.3	10.73	I	3324	24"VIT	
	1520		10.71	O	1519	24"VIT	
CB	1542	19.96	16.84	O	SW	10"	
TMH	1544	21.02					
CB	1637	21.42		O	NE		TOP TRAP 19.30 - WATER LEVEL
SMH	1655	27.6	15.63	I			
	1655		15.55	O	1519	18"	
CB	1877	26.54	22.42	O	NW		TOP TRAP 23.20 - WATER LEVEL
CB	1883	27.8		O	SW		TOP TRAP 23.95 - WATER LEVEL
SMH	1920	29.01	18.61	I	NW	24"RCCP	
	1920		17.66	O	3253	24"VIT	
CB	1921	28.16		O	NE		TOP TRAP 25.13 - WATER LEVEL
TMH	1922	27.97					
CB	1924	27.05		O	NE		TOP TRAP - WATER LEVEL
SMH	1951	28.22	19.43	O	1961	18"	
SMH	1961	28.26	16.68	I	NW	10"PVC	
	1961		16.24	I	1951	15"	
	1961		16.3	O	2305	15"	
CB	1972	28.03	23.15	I	2294		6"PVC
	1972			O	W		TOP TRAP 23.67 - WATER LEVEL
CB	2216	26.95	22.75	O	NW	8"	
EMH	2249	27.24					
SMH	2291	28.81	23	I	NE	10"PVC	
	2291		17.79	I	NE	10"PVC	
	2291		22.79	I	SW	10"PVC	
	2291		17.6	I	SW	10"PVC	
	2291		17.19	O	2299	18"PVC	
	2291		17.4	I	NW	18"PVC	
CB	2294	28.2	24.39	I	1972	6"PVC	
	2294			O	2291		TOP TRAP 24.13 WATER LEVEL
SMH	2299	28.55	17.15	I	2291	18"PVC	
	2299		15.29	I	NW	8"PVC	
	2299		16.97	I	NW	6"PVC	
	2299		14.91	O	3149		
SMH	2305	28.69	15.83	I	1961	15"	
	2305		17.01	I	2291	8"	
	2305			O	2317		
	2305		15.67	O	3149	15"	

HAMPSHIRE
STREET

MIDDLE STREET

JORDAN'S MEATS

TRAFFIC CONTROL BOX
MISC UNDER PAVEMENT
TRAFFIC SIGNAL LOOPS
AT FRANKIN & MIDDLE

APPROXIMATE GAS SERVICE LOCATION (PLAN
WAS VAGUE AND LINE WAS NOT FIELD PAINTED)

BUILDING FACE
BUILDING OVERHANG

SEE NOTE 11

SEE NOTE 10

PAVED
YARD

