

**FIELD VERIFICATION NOTES**

1. G.C. TO FIELD VERIFY THE INTERIOR SPACE DIMENSIONS.
2. USE THE PLAN FOR ALL DIMENSIONS AND NOTES.
3. CUT OUT THE VERIFY SPACE PLAN (6) 8-1/2" X 11" PLANS AND FAX (OR SCAN AND EMAIL) TO U.O.I. CONSTRUCTION MANAGER WITHIN 48 HOURS OF ARRIVING ON SITE. MARK GRID LINE LETTERS ON EACH SEPARATE SHEET.
4. USE THE ELEVATION SYMBOLS TO VERIFY EXISTING HEIGHTS WITHIN THE SPACE.
5. FIELD VERIFY THAT WINDOW FILMPAPER IS ON THE INTERIOR SIDE OF ALL WINDOWS.

**FIELD VERIFY ELEVATIONS**

- 0'-0" TO FLOOR @ FLOOR A
- TO FLOOR @ FLOOR B
- TO FLOOR @ FLOOR C
- TO FLOOR @ FLOOR D
- TO LL PROVIDED MASONRY OPENINGS AT GRID D
- B/O SPRINKLERS @ A
- B/O SPRINKLERS @ B
- B/O CLG. @ A
- B/O CLG. @ B

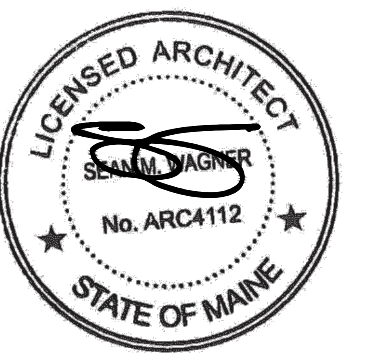
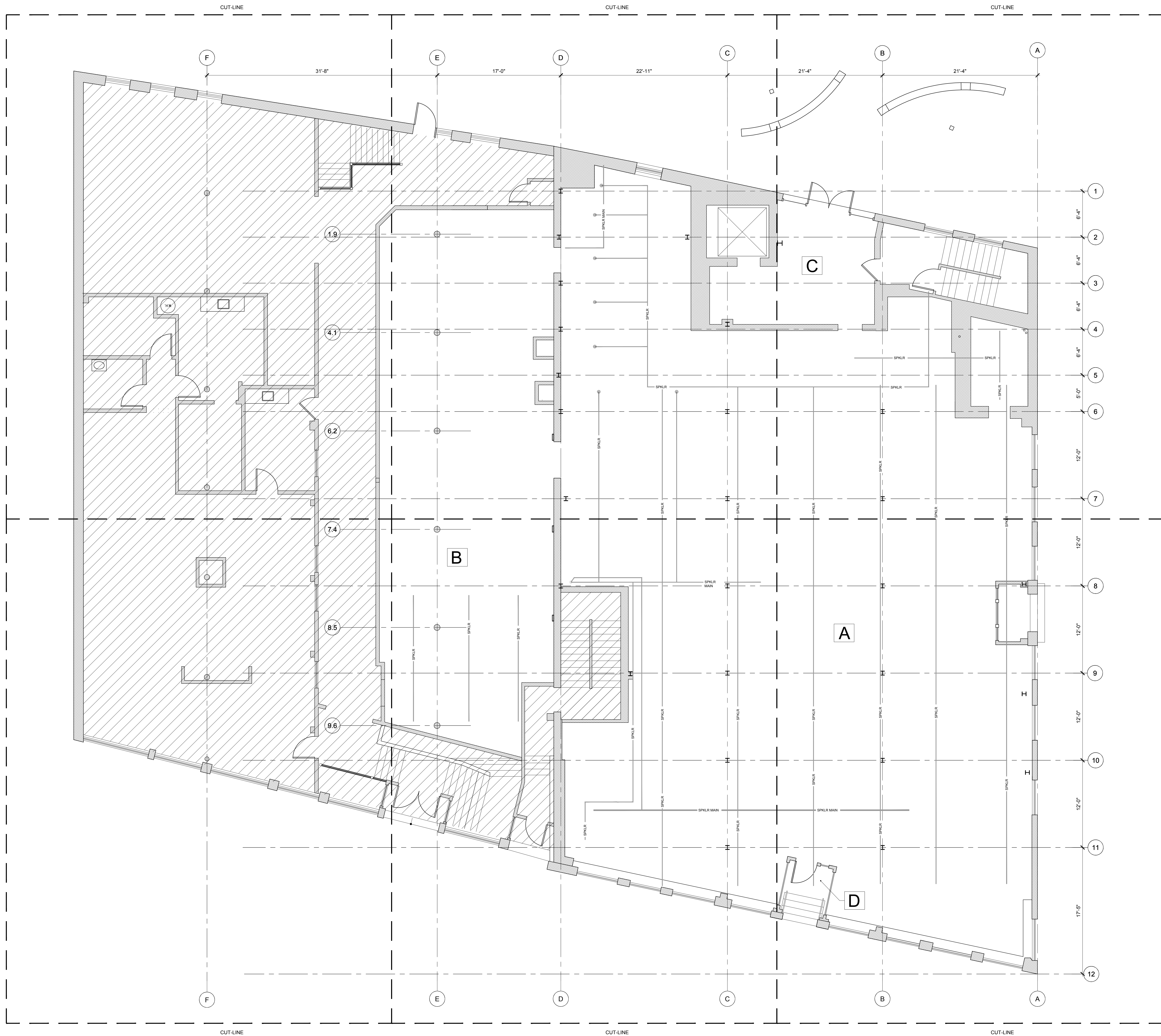

ARCHITECTS  
I hereby certify that this plan, specification, or report was prepared by me or under my direct supervision and that I am a duly Licensed Architect under the laws of the State of Maine.

Print Name: Sean M. Wagner, AIA

Date: 08-01-2014 License #: ARC4112

**NewStudioArchitecture**

4431 Lake Avenue South  
White Bear Lake, MN 55110

p: 651.207.5527 f: 651.207.8247

**ANTHROPOLOGIE**

60 Pearl Street  
Portland, ME 04101

DRAWN BY: BH CHECKED BY: SMW

NSA PROJECT NUMBER: 2013-99

PROJECT PHASE: CD

ISSUE / DATE:

100% CHECKSET 07-11-2014

BID/PERMIT 08-01-2014

REVISION:

SHEET TITLE:  
**FIELD  
VERIFICATION  
PLAN**

SHEET NO:

**FV100**

