

2 PARTIAL RAMP PLAN
3/8" = 1'-0"

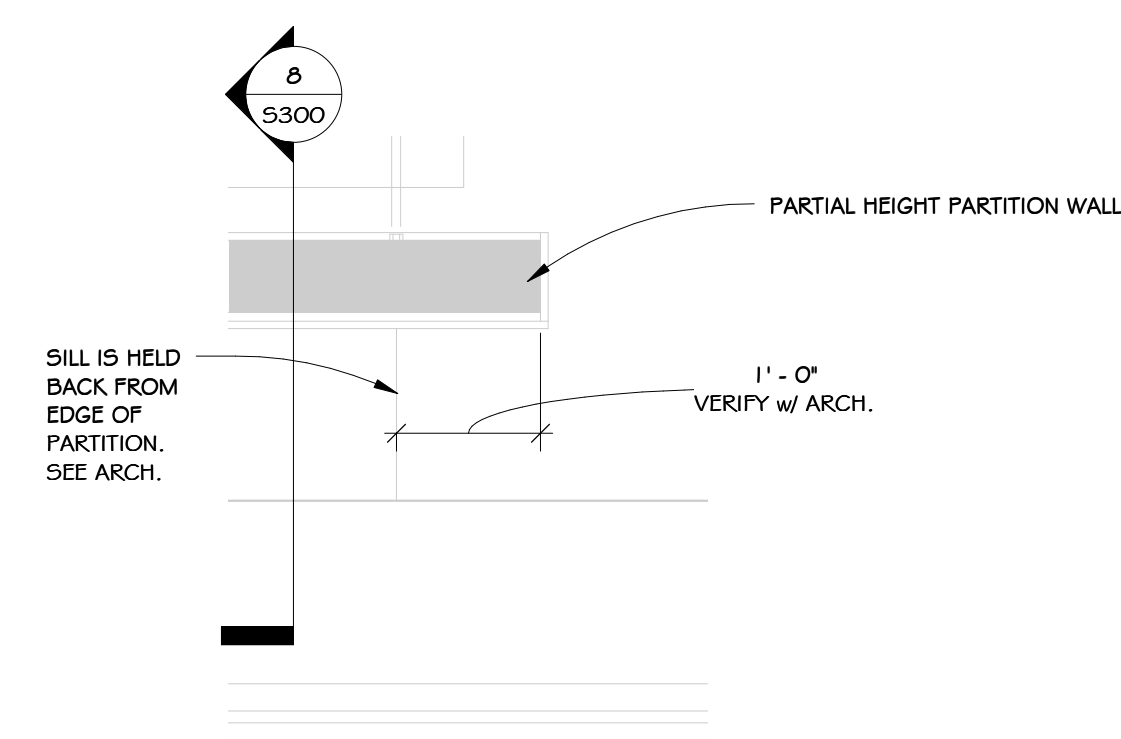

3 PARTIAL WALL FRAMING PLAN
3/4" = 1'-0"

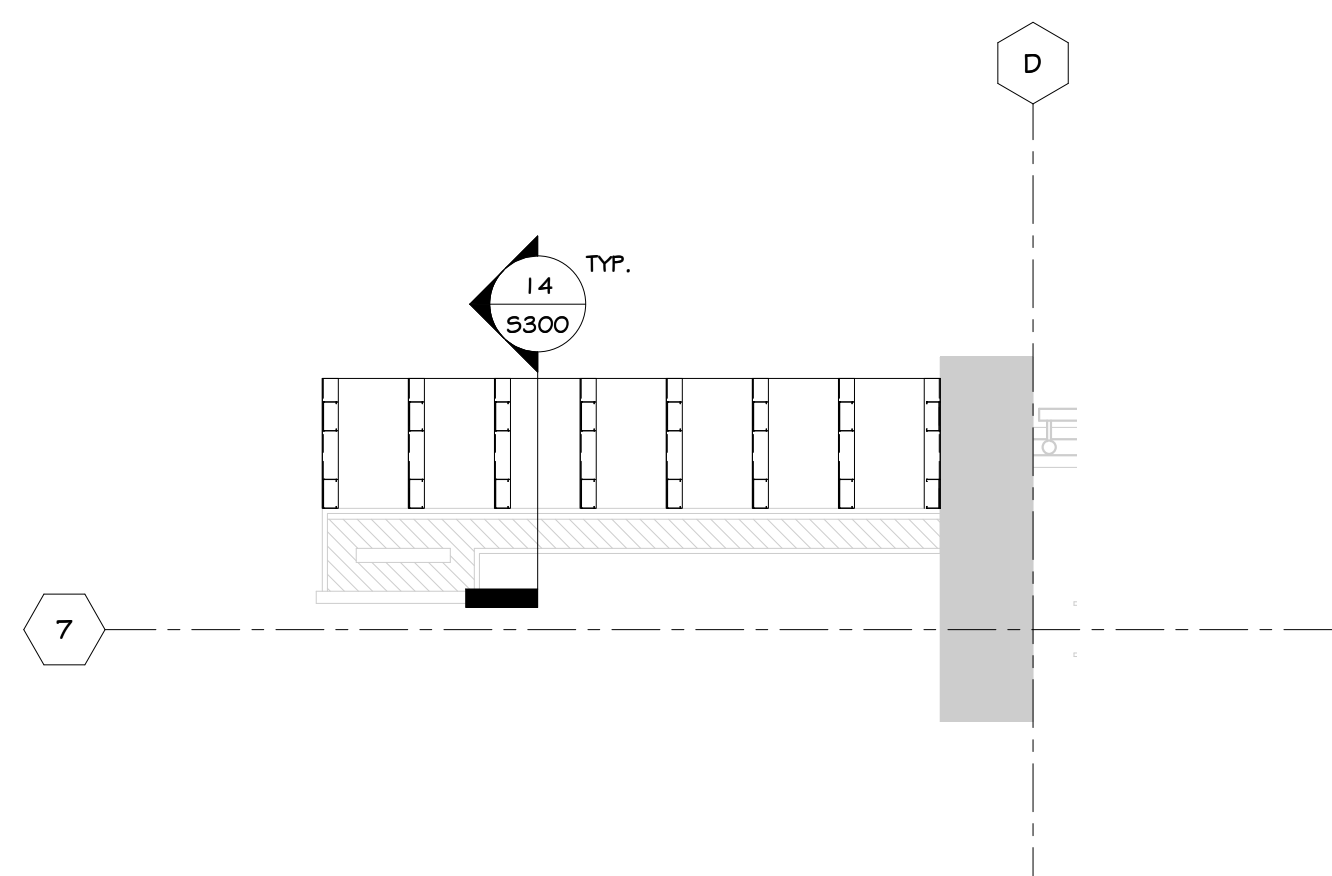

4 BENCH FRAMING PLAN
1/2" = 1'-0"

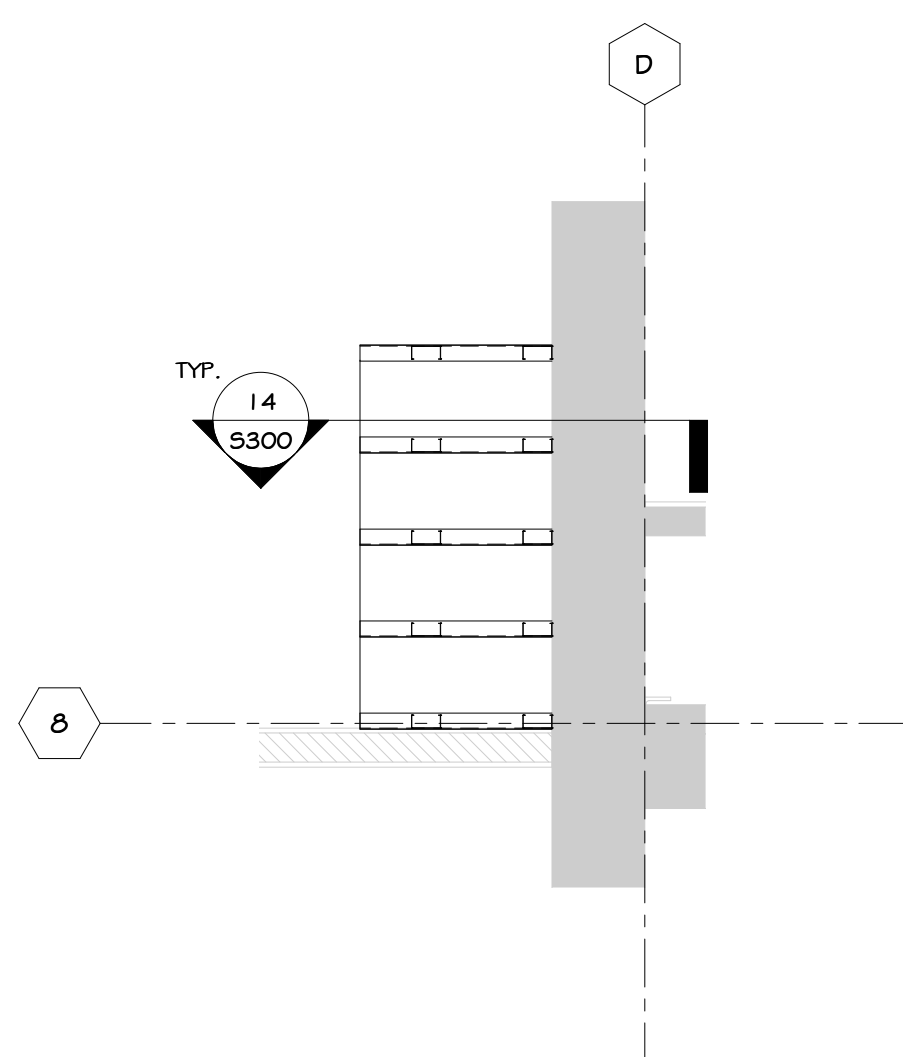

5 ADA BENCH FRAMING PLAN
1/2" = 1'-0"

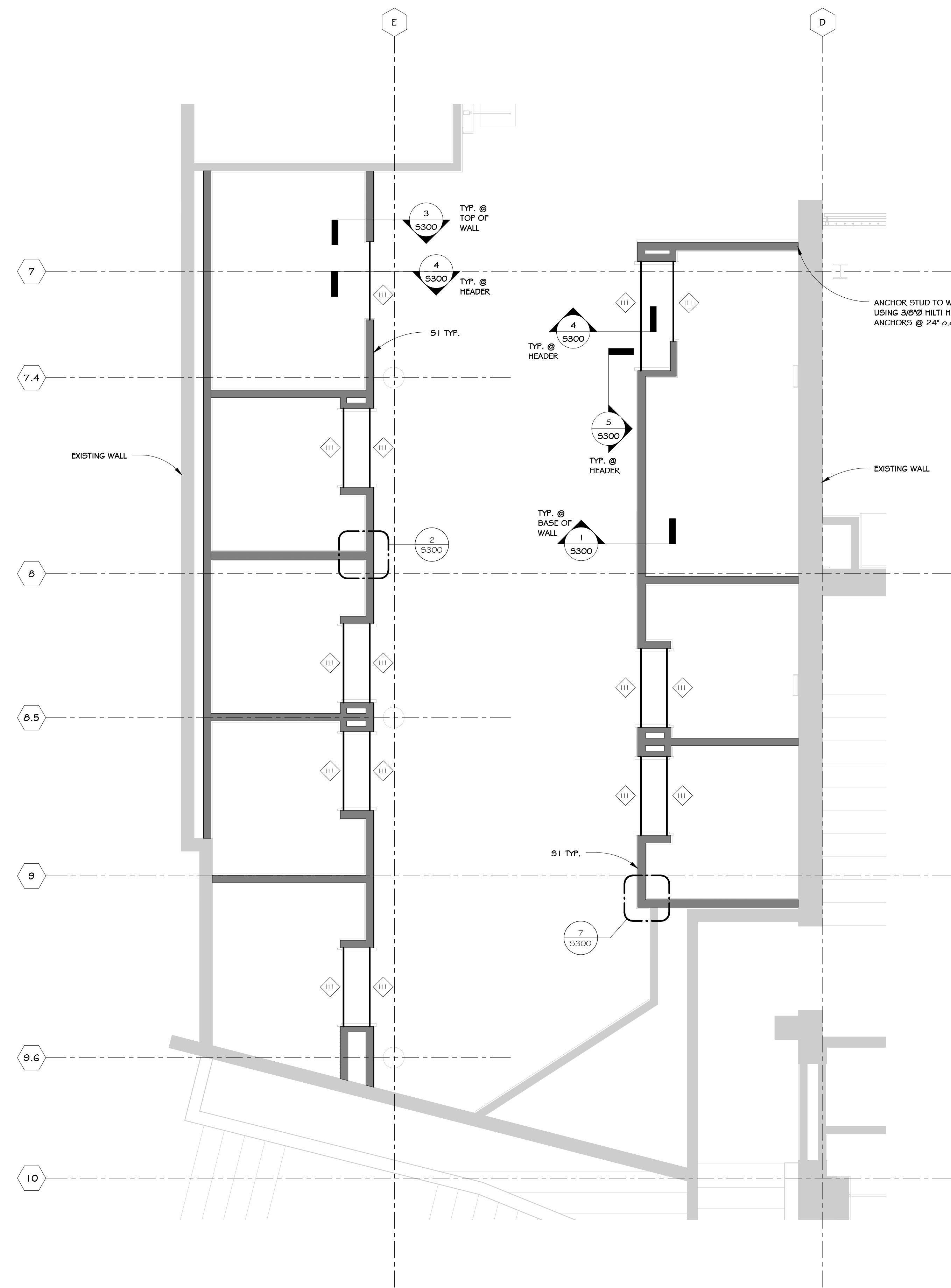

1 PARTIAL WALL FRAMING PLAN
3/8" = 1'-0"

- PLAN NOTES:
- "S1" DENOTES LIGHT-GAGE WALL. SEE SCHEDULE ON THIS SHEET.
 - "H1" DENOTES BUILT-UP LIGHT-GAGE HEADER, SEE SCHEDULE ON THIS SHEET.
 - VERIFY ALL DIMENSIONS w/ ARCH.

WALL TYPES			
MARK	STUD TYPE	SPACING	MAX. WALL HEIGHT
S1	3x25 1/2-33 STEEL STUDS (20 GAGE)	1'0" o.c.	NA
S2	6005 1/2-33 STEEL STUDS (20 GAGE)	1'0" o.c.	NA

NOTES:

- SEE SECTIONS AND DETAILS FOR THICKNESS OF TOP & BOTTOM TRACK SECTIONS.
- FASTEN GYP. BOARD SHEATHING TO STUDS w/ #6x 1 1/4" GYP.
- COORDINATE WALL TYPES w/ ARCH.
- SEE ARCH. DRAWINGS FOR STUD WALL SHEATHING. WHERE SHEATHING IS NOT CONTINUOUS BOTH SIDES FOR FULL HEIGHT OF WALL PROVIDE CONTINUOUS 1/2" GA. HORIZ. BRIDGING @ 24" o.c. VERT. ANCHOR BRIDGING TO STUDS WITH 1/2" GA. CLIP ANGLES WITH (2) #10 SCREWS TO STUDS AND BRIDGING.

LIGHT GAGE HEADER SCHEDULE	
MARK	HEADER TYPE
H1	(2) 6005 1/2-33 (20 GAGE)

NOTES:

- SCREW MEMBERS TOGETHER w/ #10 TEK SCREWS @ 6" o.c.
- SEE 4-65300 FOR ADDITIONAL INFORMATION.

ENGINEER/SEAL:

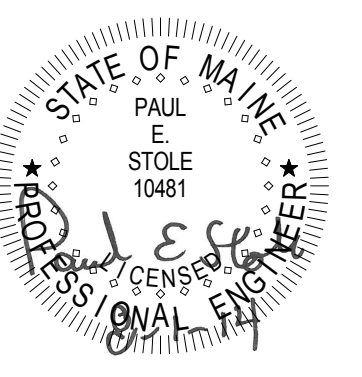

NewStudio Architecture

4431 Lake Avenue South
White Bear Lake, MN 55110
P: 651.207.5527
F: 651.207.5247
NSA PROJECT NUMBER: 2013-99

ANTHROPOLOGIE

60 Pearl Street
Portland, ME 04101

STRUCTURAL ENGINEER:

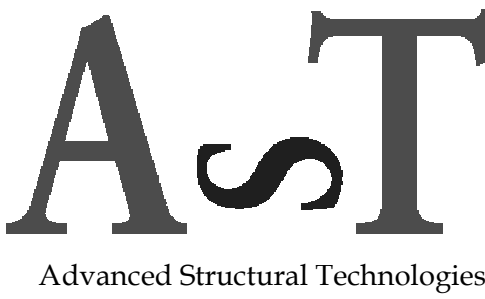

7212 Metro Blvd
Edina, MN 55439
(952) 854-9302 tel
(952) 854-9690 fax
www.astmn.com

PROPERTY OF ADVANCED STRUCTURAL TECHNOLOGIES. THIS DOCUMENT MAY NOT BE COPIED OR CARRIED WITHOUT THE PRIOR WRITTEN CONSENT OF ADVANCED STRUCTURAL TECHNOLOGIES.

DRAWN BY: AJM CHECKED BY: DCB

AST PROJECT NUMBER: ME 1001

PROJECT PHASE: CD

ISSUE / DATE:

100% CHECK SET 07-11-2014

BID/PERMIT 08-01-2014

REVISION:

SHEET TITLE:
PARTIAL FRAMING PLANS

SHEET NO.:

S110