

**FIXTURE LEGEND**

FIXTURE DESCRIPTION	PLAN DETAIL	ELEVATION	SIZE
FLOATING WALL #1	9/A451	3/A451	10'-7 1/2" W. X 10'-2" H.
FLOATING WALL #2	9/A451	4/A451	10'-7 1/2" W. X 8'-8" H.

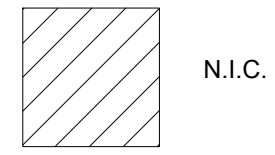

**FIXTURE PLAN GENERAL NOTES**

- TENANT MUST HAVE AT LEAST ONE 44" MINIMUM WIDTH PATH OF EGRESS FROM STOREFRONT TO BACK CORRIDOR. ALL OTHER PATHWAYS MUST BE 36" WIDE (MINIMUM).
- U.N.O. ALL STEEL FIXTURE STANDARDS (TUBE STEEL, ANGLES, PLATES, FASTENERS, ETC.) TO BE OF ASTM500 GRADE B HOT ROLLED STRUCTURAL STEEL AND FINISHED PER FINISH TAG. M-15 ABOVE. SUBMIT SAMPLES TO UOI FOR REVIEW AND APPROVAL.
- REFER TO FINISH SCHEDULE C102 FOR TSM NUMBERS FOR FLOOR, BASE, AND MISCELLANEOUS MATERIALS.
- REFER TO C103 FOR TENANT SUPPLIED MATERIALS LIST.

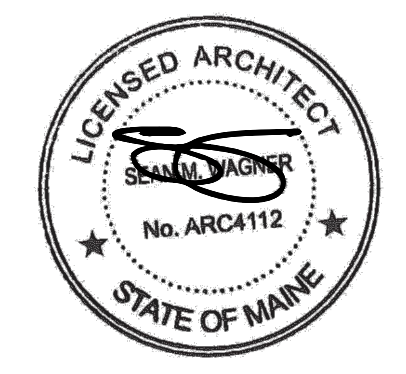

ARCHITECTS  
I hereby certify that this plan, specification, or report was prepared by me or under my direct supervision and that I am a duly Licensed Architect under the laws of the State of Maine.

Print Name: Sean M. Wagner, AIA

Date: 08-01-2014 License #: ARC4112

**NewStudioArchitecture**

4431 Lake Avenue South  
White Bear Lake, MN 55110  
p: 651.207.5527 f: 651.207.8247

**ANTHROPOLOGIE**

60 Pearl Street  
Portland, ME 04101

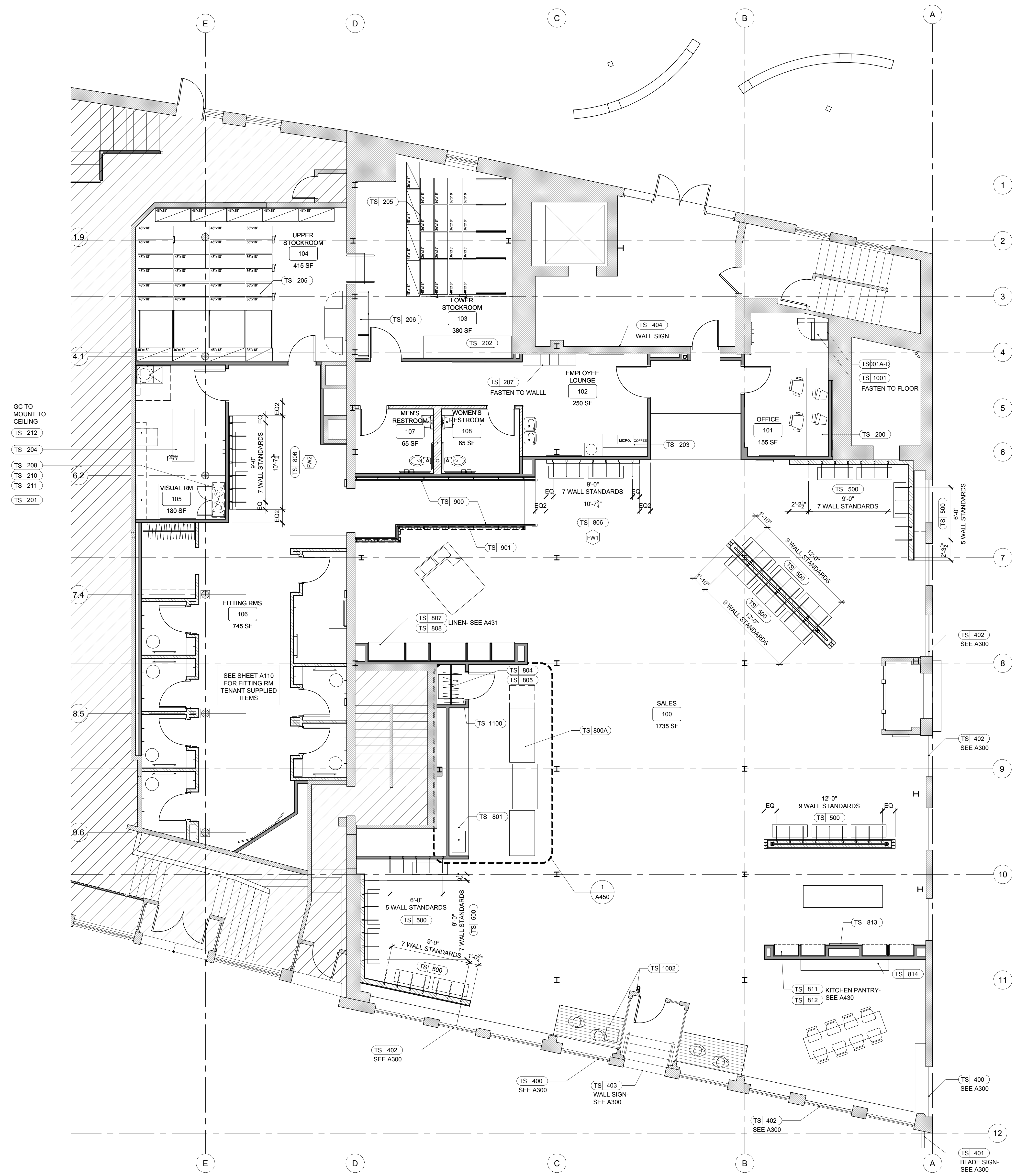

GC TO MOUNT TO CEILING  
TSI 212  
TSI 204  
TSI 208  
TSI 210  
TSI 211  
TSI 201

DRAWN BY: BH CHECKED BY: SMW  
NSA PROJECT NUMBER: 2013-99  
PROJECT PHASE: CD

ISSUE / DATE:  
100% CHECKSET 07-11-2014  
BID/PERMIT 08-01-2014

REVISION:

SHEET TITLE:  
**FIXTURE PLAN**

SHEET NO:  
**A130**