



AdvantEDGE™ Sandwich Food Preparation Refrigerators



NLSP48-12

PROJECT:

ITEM NUMBER:

MODEL NUMBER:

ADVANTEDGE™ SANDWICH FOOD PREPARATION REFRIGERATORS

SPECIFICATIONS FOR: NLSP27-8, NLSP48-12, NLSP60-16, NLSP72-18

- Finish: Stainless steel interior and exterior.
- Insulation: The complete cabinet and doors are foamed-in-place with polyurethane insulation. Insulated pan cover.
- Hardware: Curved handle with recessed pocket with one epoxy coated shelf per door, 6" diameter casters standard.
- Electrical: 115 volt, 60 Hz, 1 phase with cord and plug.
- Refrigeration: Self contained forced air refrigeration system. The condensate is collected and automatically evaporated from an energy efficient hot gas style vaporizer. Refrigerant flow is controlled by a capillary tube. R-134a refrigerant. Temperature range: 32°F to 40°F.
- Accessories: 1/6 size pans included and 9-1/2" polyethylene cutting board.
- Approvals: UL, C-UL and ETL Sanitation.

STANDARD FEATURES

- 1/6 size pans included
 Note: NLSP27-8 has (6) 1/6 size pans and (2) 1/9 size pans included.
- Air cooled condensing unit
- Automatic condensate vaporizer
- Automatic defrost
- Capillary tube system
- Casters standard
- Cutting board
- Magnetic gaskets
- Self closing doors
- Stainless steel interior and exterior
- UL, C-UL and ETL sanitation
- Warranties:
 1 Year Parts & Labor,
 5 Year Compressor

OPTIONAL FEATURES*

- Additional shelves



Nor-Lake, Inc.
 Registered to ISO 9001:2008
 File No. 10001816

*Most options are available one week from receipt of order. Please contact us for specific questions.
 **C-UL is Underwriters Laboratories Safety Certification Mark which indicates that UL has tested the equipment to applicable CSA Standards.



FRONT

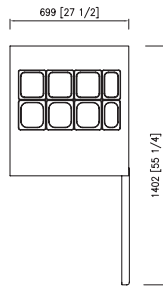

TOP

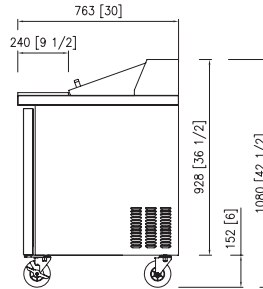

SIDE

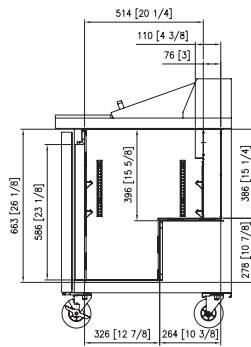

SIDE INTERIOR

NLSP27-8



FRONT

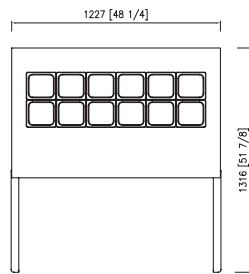

TOP

NLSP48-12



FRONT

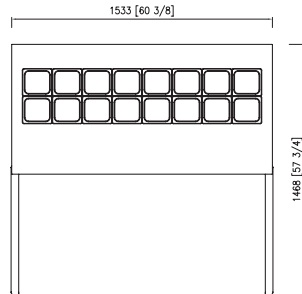

TOP

NLSP60-16

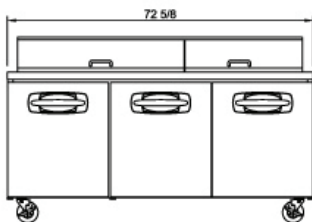

FRONT

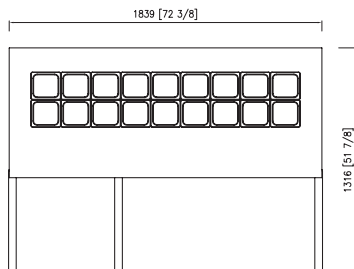

TOP

NLSP72-18

SPECIFICATIONS

Model	NLSP27-8	NLSP48-12	NLSP60-16	NLSP72-18
Crated Height	42-7/8"	42-7/8"	42-7/8"	42-7/8"
Crated Width	30-1/8"	51-1/8"	63"	74-3/8"
Crated Depth	33-1/2"	33-1/2"	33-1/2"	33-1/2"
Crated Weight (lbs.)	212	304	344	384
Interior Height	26-1/8"	26-1/8"	26-1/8"	26-1/8"
Interior Width	23-3/4"	44-5/8"	56-3/4"	68-5/8"
Interior Depth	20-1/4"	20-1/4"	20-1/4"	20-1/4"
Overall Height	42-1/2"	42-1/2"	42-1/2"	42-1/2"
Overall Width	27-1/2"	48-1/4"	60-3/8"	72-3/8"
Overall Depth	30"	30"	30"	30"
Gross Cubage (ft. ³)	7	13	16	20
Number of Shelves	1	2	2	3
Number of Casters	4	4	4	4
Condensing Unit Size	1/5 HP	3/8 HP	3/8 HP	3/8 HP
Refrigerant	R-134a	R-134a	R-134a	R-134a
Electrical Characteristics	115/60/1	115/60/1	115/60/1	115/60/1
Cord and Plug Furnished	Yes	Yes	Yes	Yes
Nema Plug Configuration	5-15P	5-15P	5-15P	5-15P
Total Amp Draw	3.2	7.9	7.9	9.9

Specifications subject to change without notice.



Revision: 11/10
 ©2010 Nor-Lake, Inc.
 Printed in the USA
 Part Number: 146621

