

# WINDOW SCHEDULE

MARK	SIZE		TYPE	MATERIAL	NOTES
	WIDTH	HEIGHT			
1	3'-0"	3/4"	--	--	--
2	3'-0"	3/4"	--	--	--
3	3'-0"	3/4"	--	--	--
4	1'-9"	3/4"	--	--	--
5	3'-0"	3/4"	--	--	--
6	3'-0"	3/4"	--	--	--
7	2'-7"	1/2"	--	--	--
8	6'-9"	3/4"	--	--	--
9	2'-8"	2'-0"	--	--	--
10	3'-0"	3/4"	--	--	Tempered Glazing
11	3'-0"	3/4"	--	--	--
12	3'-0"	3/4"	--	--	--
13	3'-0"	3/4"	--	--	--
14	3'-0"	3/4"	--	--	Tempered Glazing
15	3'-0"	3/4"	--	--	Tempered Glazing
16	3'-0"	3/4"	--	--	--
17	3'-0"	3/4"	--	--	--
18	3'-0"	3/4"	--	--	--
19	5'-11"	1'-4"	--	--	--
20	3'-0"	3/4"	--	--	--
21	2'-10"	5'-1"	--	--	Egress Window
22	2'-10"	5'-1"	--	--	--
23	2'-3"	4'-0"	--	--	--
24	2'-3"	4'-0"	--	--	--
25	2'-3"	4'-0"	--	--	--
26	2'-10"	5'-1"	--	--	--
27	2'-10"	5'-1"	--	--	--
28	2'-10"	5'-1"	--	--	Egress Window

# DOOR AND FRAME SCHEDULE

MARK	SIZE		MATL	GLAZING	FIRE RATING LABEL	NOTES
	WD	HGT				
1	2'-8"	7'-0"	1 3/4"	--	--	1 Hr fire rating, self closing hinges
2	2'-6"	7'-0"	1 3/4"	--	--	--
3	2'-8"	7'-0"	1 3/4"	--	--	--
4	2'-8"	7'-0"	1 3/4"	--	--	--
5	3'-0"	6'-10"	NA	--	--	--
6	2'-6"	7'-0"	1 3/8"	--	--	1 Hr rating, self closing hinges
7	2'-8"	6'-10"	1 3/4"	--	--	--
8	3'-6"	7'-0"	1 3/8"	--	--	--
9	3'-6"	7'-0"	1 3/8"	--	--	--
10	3'-11"	6'-10"	1 3/4"	--	--	--
11	2'-6"	7'-0"	1/2"	--	--	--
12	2'-6"	7'-0"	1/2"	--	--	--
13	2'-6"	7'-0"	1 3/4"	--	--	--
14	2'-6"	7'-0"	1 3/4"	--	--	--
15	2'-8"	7'-0"	1 3/4"	--	--	--
16	2'-8"	7'-0"	1 3/4"	--	--	--
17	2'-6"	7'-0"	1 3/4"	--	--	--

WINDOW NOTES:  
 ALL WINDOWS SHALL BE LOW E ARGON FILLED INSULATING GLASS  
 ALL WINDOWS TO HAVE A U-FACTOR RATING OF 0.30 OR BETTER.  
 ALL WINDOW GRILLES SHALL BE SIMULATED DIVIDED LITE.

ALL GLAZING SHALL CONFORM TO IRC 2012 R308  
 WINDOW GLAZING WITH SILL HTS LESS THAN 18" TO BE TEMPERED,  
 WINDOW GLAZING 24" OR CLOSER TO DOORS SHALL BE TEMPERED,  
 WINDOW GLAZING 36" OR CLOSER TO STAIRWAYS AND 36" OR LESS  
 ABOVE FLOOR SHALL BE TEMPERED.  
 WINDOW GLAZING WITHIN 60" OF THE BOTTOM OF A STAIRWAY AND  
 LESS THAN 36" ABOVE THE FLOOR SHALL BE TEMPERED.

ALL WINDOWS SHALL CONFORM TO R312 WINDOW FALL  
 PROTECTION  
 ALL WINDOWS WITH SILL HTS LESS THAN 24" AND MORE THAN 72"  
 ABOVE GRADE TO HAVE OPENING LIMITERS TO RESTRICT OPENING  
 TO 4".

R310 EMERGENCY ESCAPE AND RESCUE OPENINGS  
 SLEEPING ROOMS SHALL HAVE AT LEAST ONE EGRESS WINDOW WITH  
 A SILL HT OF NOT MORE THAN 44". A MINIMUM CLEAR OPENING  
 HEIGHT OF 24" AND A MINIMUM CLEAR OPENING WIDTH OF 20"

HEADER NOTES:  
 SEE PLAN FOR HEADER SIZES.  
 ALL HEADERS SPANS GREATER THAN 5'-0" SHALL HAVE 2 JACK STUDS  
 AT EACH END.

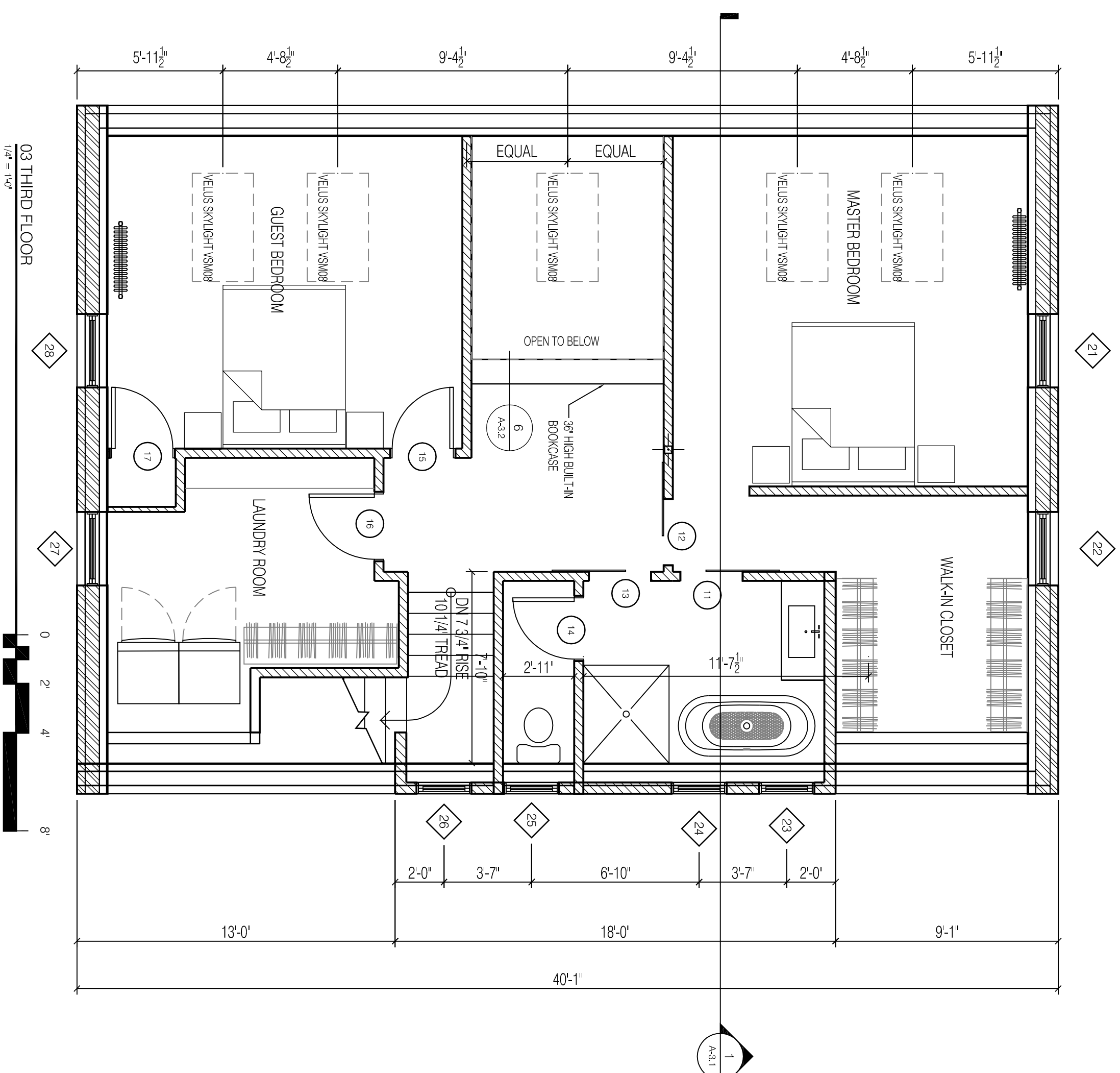

PROSPECT



DESIGN  
 58 FORE ST, PORTLAND, ME  
 www.prospectdesign.me  
 T. 207.749.7400

MCINTYRE  
 76 INDIA STREET  
 MOLLY MCINTYRE

THIRD FLOOR PLAN AND SCHEDULES

PERMIT SET

SHEET TITLE  
 REVISION

FORMER: BB  
 DATE: November 28, 2014

A-1.3