

**CITY OF PORTLAND
SITE PLAN AND SUBDIVISION NOTES**

- LANDSCAPING SHALL MEET THE "ARBORICULTURAL SPECIFICATIONS AND STANDARDS OF PRACTICE AND LANDSCAPE GUIDELINES" OF THE CITY OF PORTLAND TECHNICAL AND DESIGN STANDARDS AND GUIDELINES.
- THE ENTIRE SITE SHALL BE DEVELOPED AND/OR MAINTAINED AS DEPICTED ON THE SITE PLAN. APPROVAL OF THE PLANNING AUTHORITY OR PLANNING BOARD SHALL BE REQUIRED FOR ANY ALTERATION TO OR DEVIATION FROM THE APPROVED SITE PLAN, INCLUDING, WITHOUT LIMITATION: TOPOGRAPHY, DRAINAGE, LANDSCAPING, RETENTION OF WOODED OR LAWN AREAS, ACCESS, SIZE, LOCATION, AND SURFACING OF PARKING AREAS AND LOCATION AND SIZE OF BUILDINGS.
- ALL POWERLINE UTILITIES SHALL BE UNDERGROUND.
- SIDEWALKS AND CURBING SHALL BE DESIGNED AND BUILT WITH TYPED RAMP AT ALL STREET CORNERS, CROSSWALKS AND DRIVEWAYS IN CONFORMANCE WITH THE CITY OF PORTLAND TECHNICAL AND DESIGN STANDARDS AND GUIDELINES.
- ALL EROSION CONTROL MEASURES SHALL BE CONSTRUCTED AND MAINTAINED IN ACCORDANCE WITH THE MAINE EROSION AND SEDIMENT CONTROL BMPs PUBLISHED BY THE BUREAU OF LAND AND QUALITY, MAINE DEPARTMENT OF ENVIRONMENTAL PROTECTION, MARCH 2003.
- ALL EROSION CONTROL MEASURES SHALL BE INSTALLED PRIOR TO ANY SITE EXCAVATION OR REGRADING.
- ALL DISTURBED AREAS ON THE SITE NOT COVERED BY BUILDINGS OR PAVED AREAS SHALL BE STABILIZED WITH LOAM AND SEED OR OTHER METHODS AS REQUIRED BY BEST MANAGEMENT PRACTICES (SEE ABOVE).
- PRIOR TO CONSTRUCTION, A PRECONSTRUCTION MEETING SHALL BE HELD AT THE PROJECT SITE WITH THE CONTRACTOR, DEVELOPMENT REVIEW COORDINATOR, PUBLIC WORKS REPRESENTATIVE AND OWNER TO REVIEW THE CONSTRUCTION SCHEDULE AND CRITICAL ASPECTS OF THE SITE WORK. AT THAT TIME, THE SITE/BUILDING CONTRACTOR SHALL PROVIDE THREE (3) COPIES OF A DETAILED CONSTRUCTION SCHEDULE TO THE ATTENDING CITY REPRESENTATIVE. IT SHALL BE THE CONTRACTOR'S RESPONSIBILITY TO ARRANGE A MUTUALLY AGREEABLE TIME FOR THE PRECONSTRUCTION MEETING.
- EXISTING VEGETATION SHALL BE CONSERVED IN AREAS SHOWN ON THIS SITE. FENCING OR OTHER PROTECTIVE BARRIERS SHALL BE ERECTED OUTSIDE THE DRIP-LINE OF INDIVIDUAL GROUPINGS OF TREES DESIGNATED FOR PRESERVATION PRIOR TO THE ONSET OF CONSTRUCTION. REGRADING SHALL NOT TAKE PLACE WITHIN THE DRIP-LINE OF TREES DESIGNATED FOR PRESERVATION. NO STORAGE OR CONSTRUCTION MATERIALS SHALL BE PERMITTED WITHIN THE DRIP-LINE OF TREES TO BE PRESERVED.
- SUBDIVISION AT THE TIME OF APPROVAL IS DEFINED AS "SUBDIVISION SHALL MEAN THE DIVISION OF A LOT, TRACT OR PARCEL OF LAND INTO THREE (3) OR MORE LOTS, INCLUDING LOTS OF FORTY (40) ACRES OR MORE, WITHIN ANY FIVE-YEAR PERIOD WHETHER ACCOMPLISHED BY SALE, LEASE, DEVELOPMENT, BUILDINGS OR OTHERWISE AND AS FURTHER DEFINED IN 30-A M.R.S.A. SECTION 4401. THE TERM SUBDIVISION SHALL ALSO INCLUDE THE DIVISION OF A NEW STRUCTURE OR STRUCTURES ON A TRACT OR PARCEL OF LAND INTO THREE (3) OR MORE DWELLING UNITS WITHIN A FIVE-YEAR PERIOD AND THE DIVISION OF AN EXISTING STRUCTURE OR STRUCTURES PREVIOUSLY USED FOR COMMERCIAL OR INDUSTRIAL USE INTO THREE (3) OR MORE DWELLING UNITS WITHIN A FIVE-YEAR PERIOD. THE AREA INCLUDED IN THE EXPANSION OF AN EXISTING STRUCTURE IS DEEMED TO BE A NEW STRUCTURE FOR THE PURPOSE OF THIS PARAGRAPH. A DWELLING UNIT SHALL INCLUDE ANY PART OF A STRUCTURE WHICH, THROUGH SALE OR LEASE, IS INTENDED FOR HUMAN HABITATION, INCLUDING SINGLE-FAMILY AND MULTIFAMILY HOUSING CONDOMINIUMS, TIME-SHARE UNITS AND APARTMENTS."

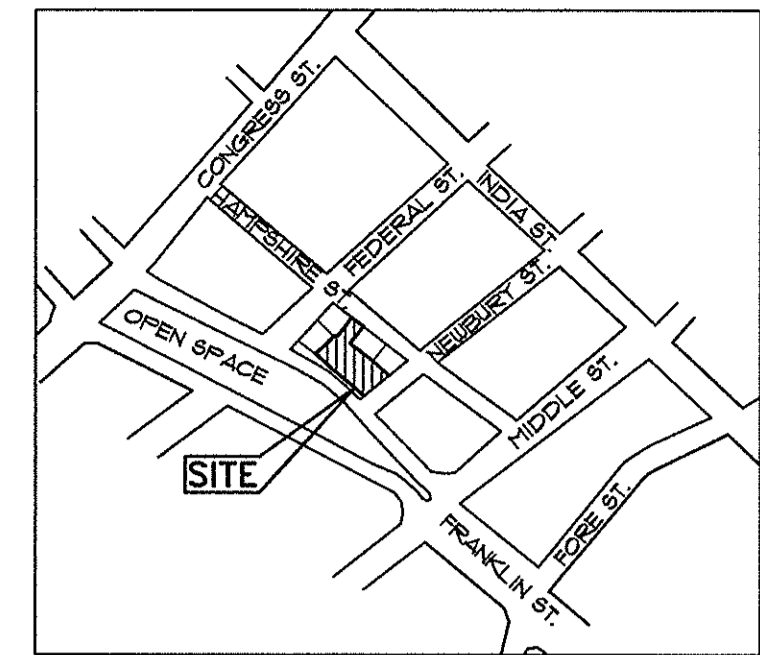

LOCATION PLAN
SCALE: 1"=400'

PROJECT SITE DRAWINGS

- C11 COVER SHEET
 - C12 SUBDIVISION RECORDING PLAT
 - C13 SITE PLAN
 - C14 EXISTING CONDITIONS AND DEMOLITION PLAN
 - C15 GRADING AND UTILITIES PLAN
 - C16 EROSION CONTROL PLAN, NOTES AND DETAILS
 - C17 LANDSCAPE PLAN, NOTES AND DETAILS
 - C18 PARKING LAYOUT & DETAILS
 - C21 DETAILS
 - C22 DETAILS
- RECONFIGURED BOUNDARY SURVEY

HAMPSHIRE STREET

LEGEND

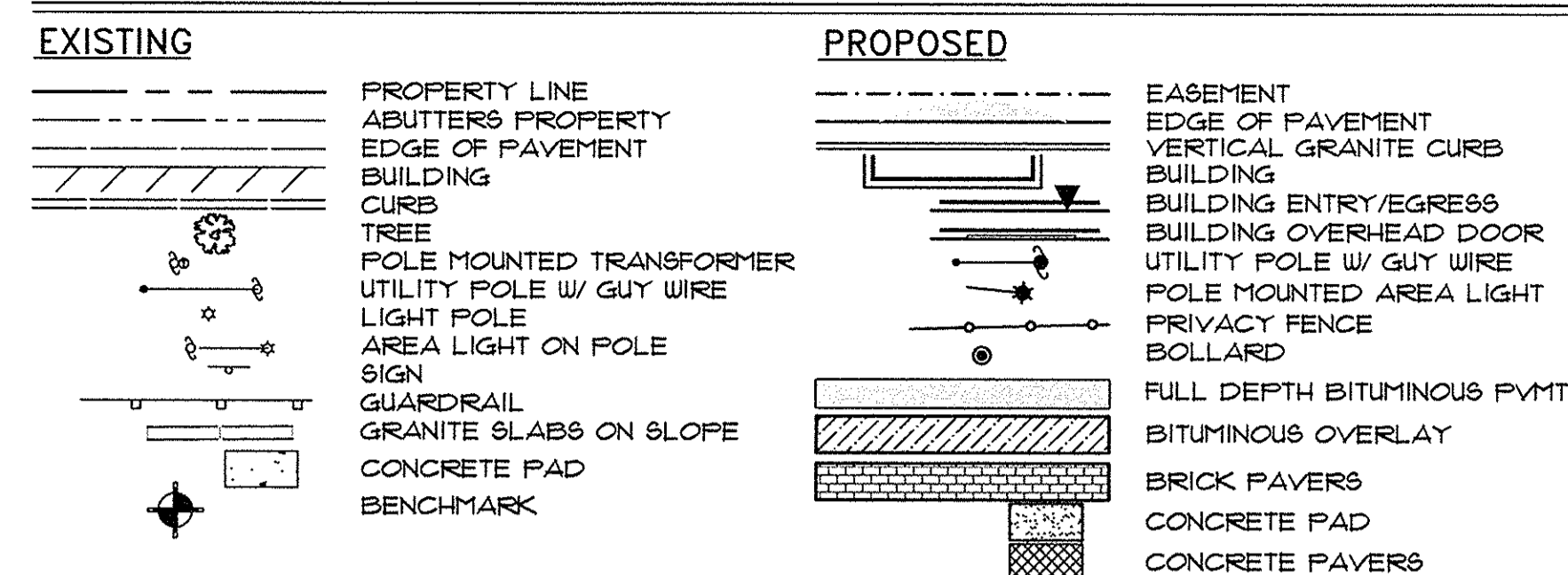

ZONE INFORMATION

18-FBC INDIA STREET FORM-BASED CODE, ABUTTING ZONES:
 UT - URBAN TRANSITIONAL SUBDISTRICT
 UN - URBAN NEIGHBORHOOD SUBDIVISION
 PERMITTED USE: MULTI-FAMILY DWELLING

PARKING INFORMATION

OFF STREET PARKING 23 SPACES REQUIRED BY ZONING
 BIKE RACKS
 EXTERIOR: 2
 INTERIOR: 10

WAIVERS

- ALLOW PARKING SPACE SIZES: 8'-6"x18'-0" AND 8'-6"x15' SPACES.
- ALLOW THE DEVELOPER TO PAY INTO THE STREET TREE FUND IN LIEU OF PLANTING 26 STREET TREES.

GENERAL NOTES

- OWNER: LUMINATO CONDOMINIUM, LLC, 118 CONGRESS STREET, PORTLAND MAINE 04101, DEEDS RECORDED IN CUMBERLAND COUNTY REGISTRY OF DEEDS BK. 32835, PG. 23, DATE SEPT. 19, 2011.
- ENGINEER: PINKHAM & GREER CIVIL ENGINEERS, 28 VANNAH AVENUE, PORTLAND, MAINE, 04103.
- ARCHITECT: ARCHETYPE ARCHITECTS, 48 UNION WHARF, PORTLAND, MAINE 04101.
- TOPOGRAPHIC & BOUNDARY: NORTHEAST CIVIL SOLUTIONS, 193 US ROUTE ONE, SCARBOROUGH, MAINE, 04074.
- UNDERLYING SOILS MAPPING TAKEN FROM SOIL CONSERVATION STUDY OF CUMBERLAND COUNTY AND CLASSIFIED HINCKLEY (H1B). THE SURFACE OF THE SITE IS CURRENT URBAN LAND.
- TAX MAP REFERENCE: MAP 28 / BLOCK 1 / LOT 4, 6, 9 & 10.
- TOTAL PARCEL = 0.24 acres
- UNITS TO BE SERVICED BY PUBLIC WATER, SEWER, AND GAS FROM NEWBURY STREET. THESE SERVICES, INCLUDING HYDRANTS, ARE AS SHOWN ON SHEET C14, GRADING AND UTILITIES PLAN.
- POWER, TELEPHONE AND CABLE SERVICES ARE TO BE UNDERGROUND FROM FEDERAL STREET. THESE SERVICES ARE SHOWN ON SHEET C14, GRADING AND UTILITIES PLAN.
- CALL DIG-SAFE PRIOR TO COMMENCING WORK, 1-800-DIG-SAFE.
- ALL WORK WITHIN THE PUBLIC RIGHT OF WAY SHALL MEET CITY OF PORTLAND TECHNICAL MANUAL STANDARDS.
- PROPOSED PARKING SPACES: 26 INDOOR SPACES.
- THE SUBJECT PARCEL SHOWN AS LUMINATO CONDOMINIUMS IS SUBJECT TO A CITY OF PORTLAND LEVEL II SITE PLAN AND SUBDIVISION PERMIT.
- DETAILS OF STREET TREES ARE INCLUDED ON THE LANDSCAPE PLAN AS PART OF THE APPROVAL FOR LUMINATO CONDOMINIUMS SITE PLAN.
- FLOODPLAIN: THIS PROPERTY IS IN ZONE C OF THE FLOOD INSURANCE RATE MAP, COMMUNITY PANEL 230051 0014 B, EFFECTIVE DATE JULY 17, 1986. IT IS NOT IN A SPECIAL FLOOD HAZARD ZONE.
- NEW PROPERTY PINS TO BE SET AT THE EXPENSE OF THE DEVELOPER AT THE END OF CONSTRUCTION.
- ALL CONSTRUCTION AND SITE ALTERATIONS SHALL BE DONE IN ACCORDANCE WITH THE "MAINE EROSION AND SEDIMENT CONTROL BMPs" PUBLISHED BY THE BUREAU OF LAND AND WATER QUALITY, MAINE DEPARTMENT OF ENVIRONMENTAL PROTECTION, LATEST EDITION, MARCH 2003.

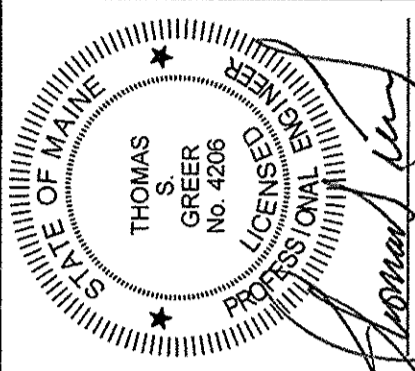
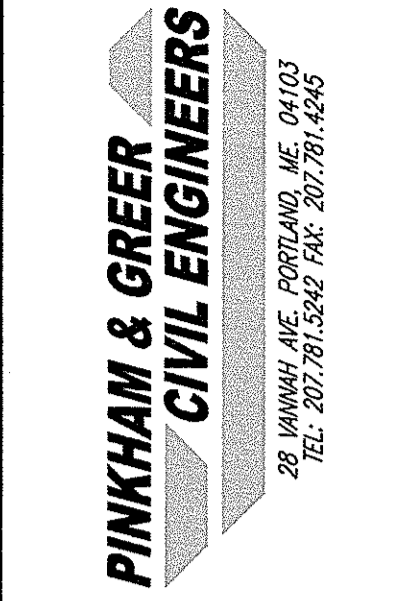

REV.	DATE	DESCRIPTION
6	7/19/16	REV PER OWNER REVIEW & REF #2
5	6/7/16	REV LAYOUT OF UTILITY ROOMS
4	5/16/16	REV PER STAFF COMMENTS
3	3/25/16	REV PER STAFF COMMENTS FOR SITE PLAN APPROVAL
2	3/16/16	REV PER STAFF REVIEW COMMENTS
1	3/8/16	REV PER STAFF REVIEW COMMENTS

LUMINATO CONDOMINIUM, LLC
 118 CONGRESS STREET, UNIT 401
 PORTLAND, MAINE

SCALE: AS SHOWN
 DATE: JANUARY 22, 2016
 PROJECT: 15178

DRN BY: JDC
 DESG BY: TSG
 CHK BY: TSG

LUMINATO CONDOMINIUMS
 167 NEWBURY STREET, PORTLAND, MAINE

SITE PLAN

C1.2

MAP/LOT 28 / 1 / 4, 6, 9 & 10

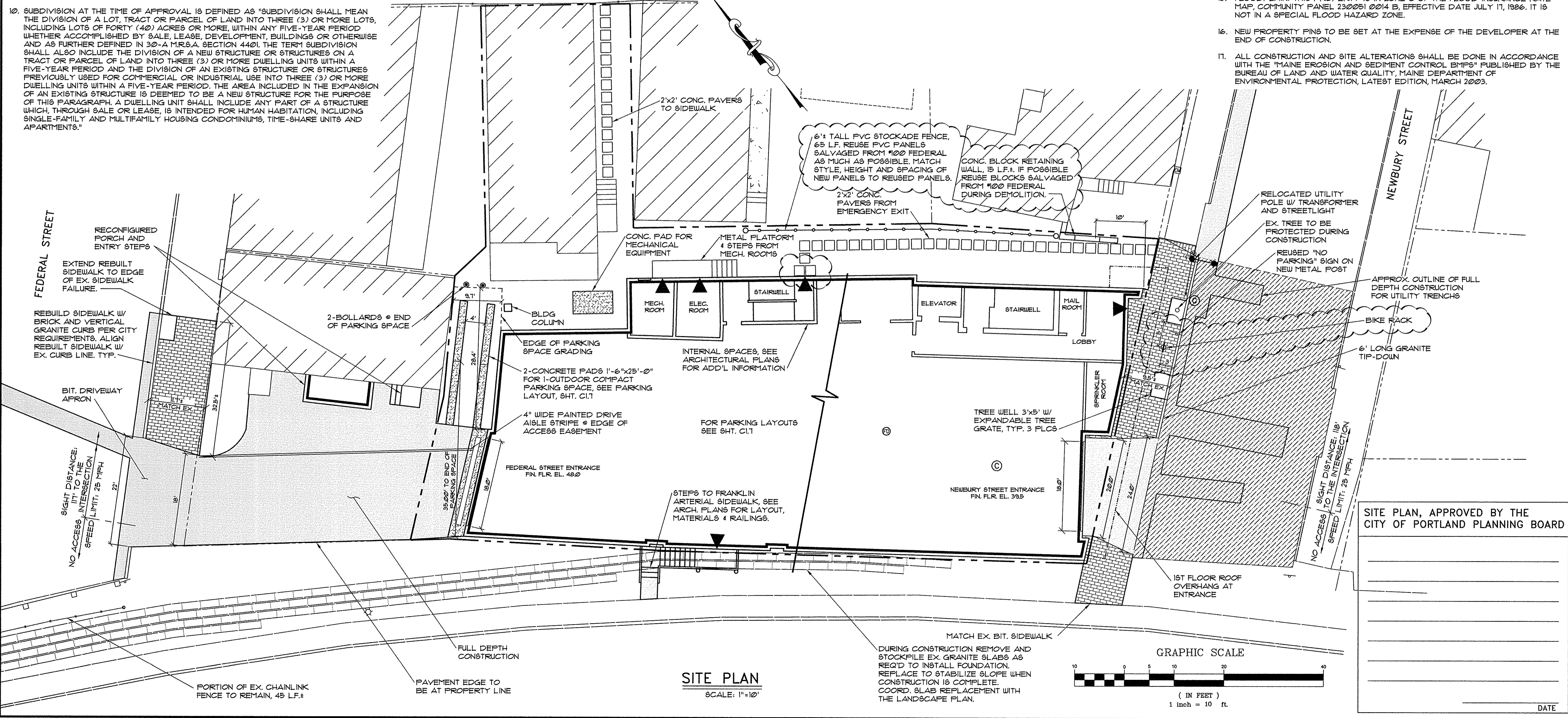

SITE PLAN
SCALE: 1"=10'