

LEGEND

- EXISTING**
- PROPERTY LINE
 - ADJUTERS PROPERTY
 - EDGE OF PAVEMENT
 - 45 --- CONTOURS
 - BUILDING
 - EDGE OF GRAVEL CURB
 - GAS LINE
 - SANITARY SEWER
 - STORM DRAIN
 - OVERHEAD UTILITY
 - UGL --- WATER LINE
 - CATCH BASIN
 - DRAIN MANHOLE
 - SEWER MANHOLE
 - ELECTRIC MANHOLE
 - ELECTRIC METER
 - GAS METER
 - HYDRANT
 - WATER VALVE
 - GAS VALVE
 - POLE MOUNTED TRANSFORMER
 - UTILITY POLE W/ GUY WIRE
 - LIGHT POLE
 - AREA LIGHT ON POLE
 - SIGN
 - GUARDRAIL
 - GRANITE SLABS ON SLOPE
 - CRUSHED STONE
 - CONCRETE PAD
 - BENCHMARK
- PROPOSED**
- EASEMENT
 - EDGE OF PAVEMENT
 - VERTICAL GRANITE CURB
 - BUILDING
 - BUILDING ENTRY/EGRESS
 - BUILDING OVERHEAD DOOR
 - 45 --- CONTOURS
 - GAS LINE
 - SANITARY SEWER
 - STORM DRAIN
 - OVERHEAD UTILITY
 - UGL --- UNDERGROUND UTILITY
 - WATER LINE
 - SPOT GRADE
 - FLOOR DRAIN
 - CATCH BASIN
 - UTILITY POLE W/ GUY WIRE
 - POLE MOUNTED AREA LIGHT
 - SURFACE DRAINAGE
 - WATER SHUT OFF
 - PRIVACY FENCE
 - FULL DEPTH BITUMINOUS P/MT
 - BITUMINOUS OVERLAY
 - BRICK PAVERS
 - CONCRETE PAD
 - CONCRETE PAVERS

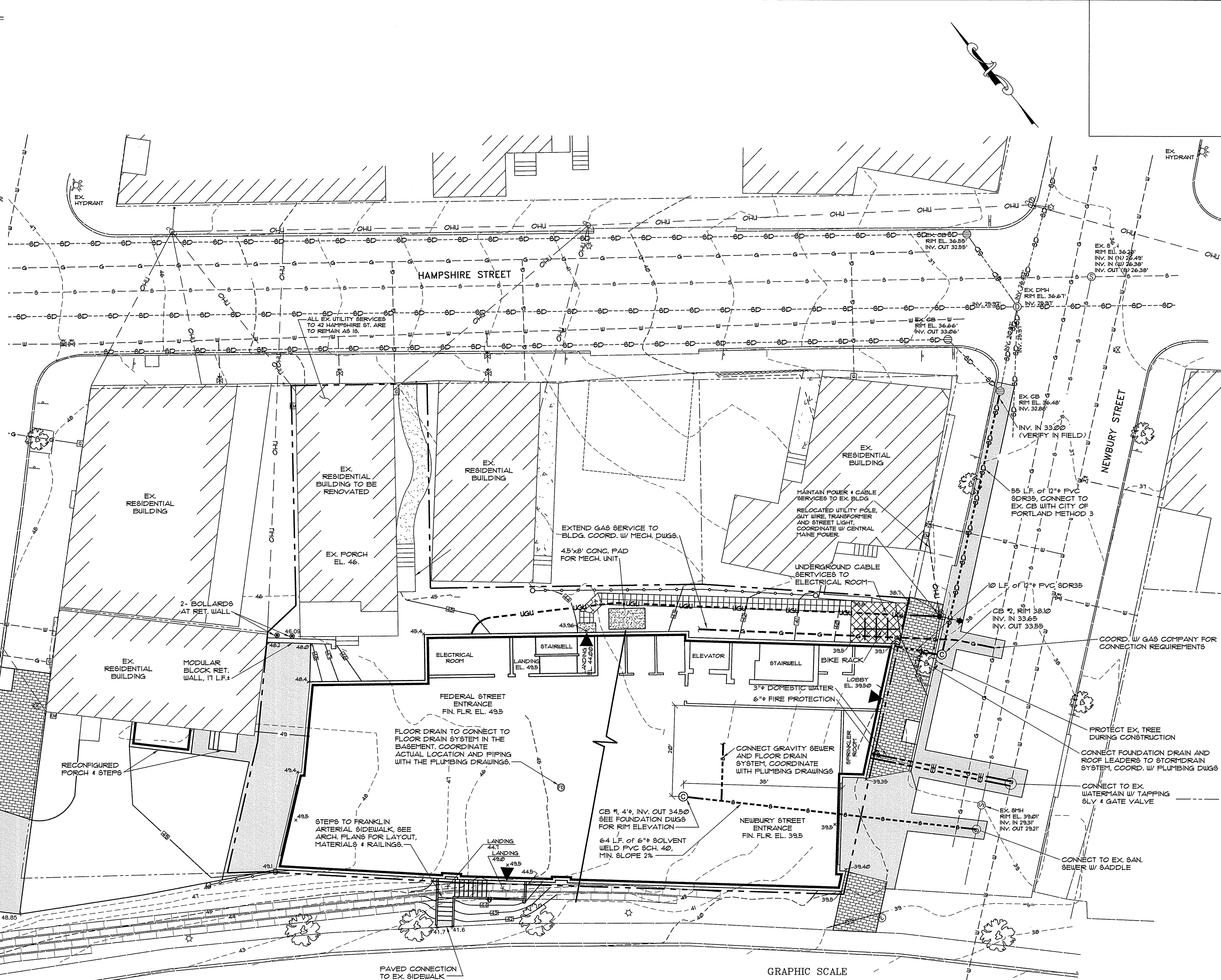

PINKHAM & GREER
CIVIL ENGINEERS
 28 WINDY AVE. PORTLAND, ME. 04103
 TEL. 207.761.5242 FAX. 207.761.9240

Professional Engineer Seal for Thomas Greer, License No. 4326, State of Maine.

REV.	DATE	REVISION
1	3/8/16	REVISED PER STAFF REVIEW COMMENTS

LUMINATO CONDOMINIUMS, LLC
 118 CONGRESS STREET, UNIT 401
 PORTLAND, MAINE

SCALE: AS SHOWN
 DATE: JANUARY 22, 2016
 PROJECT: 15178

DRN BY: JDC
 DESG BY: TSG
 CHK BY: [Signature]

LUMINATO CONDOMINIUMS
 169 NEWBURY STREET, PORTLAND, MAINE

GRADING AND UTILITIES PLAN

C1.4

MAP/LOT 28/114, 6, 9 & 10

GRADING & UTILITIES PLAN
 SCALE: 1"=20'

