

1 | UNITS 206 & 306
1/4" = 1'-0"

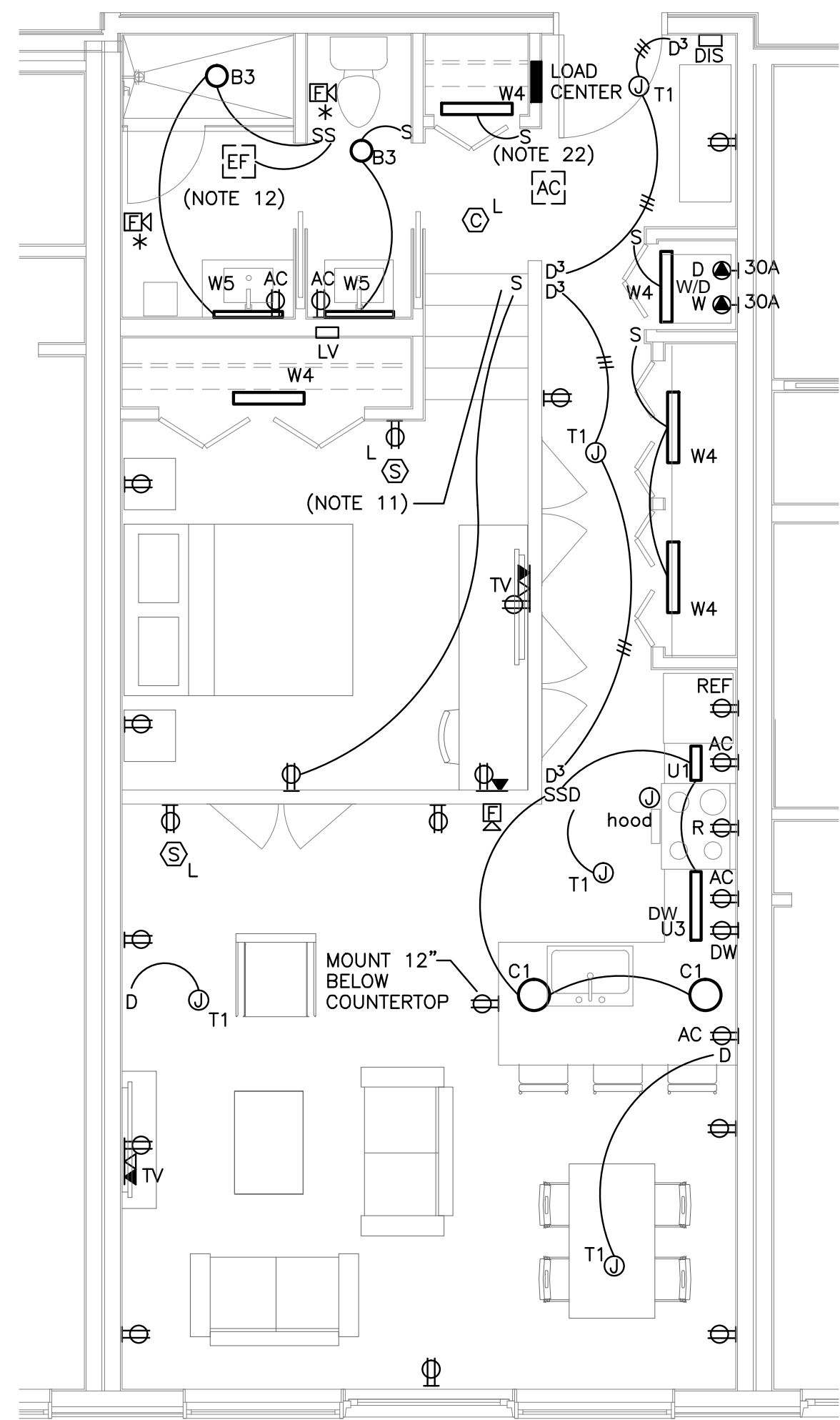

2 | UNITS 402 & 502
1/4" = 1'-0"

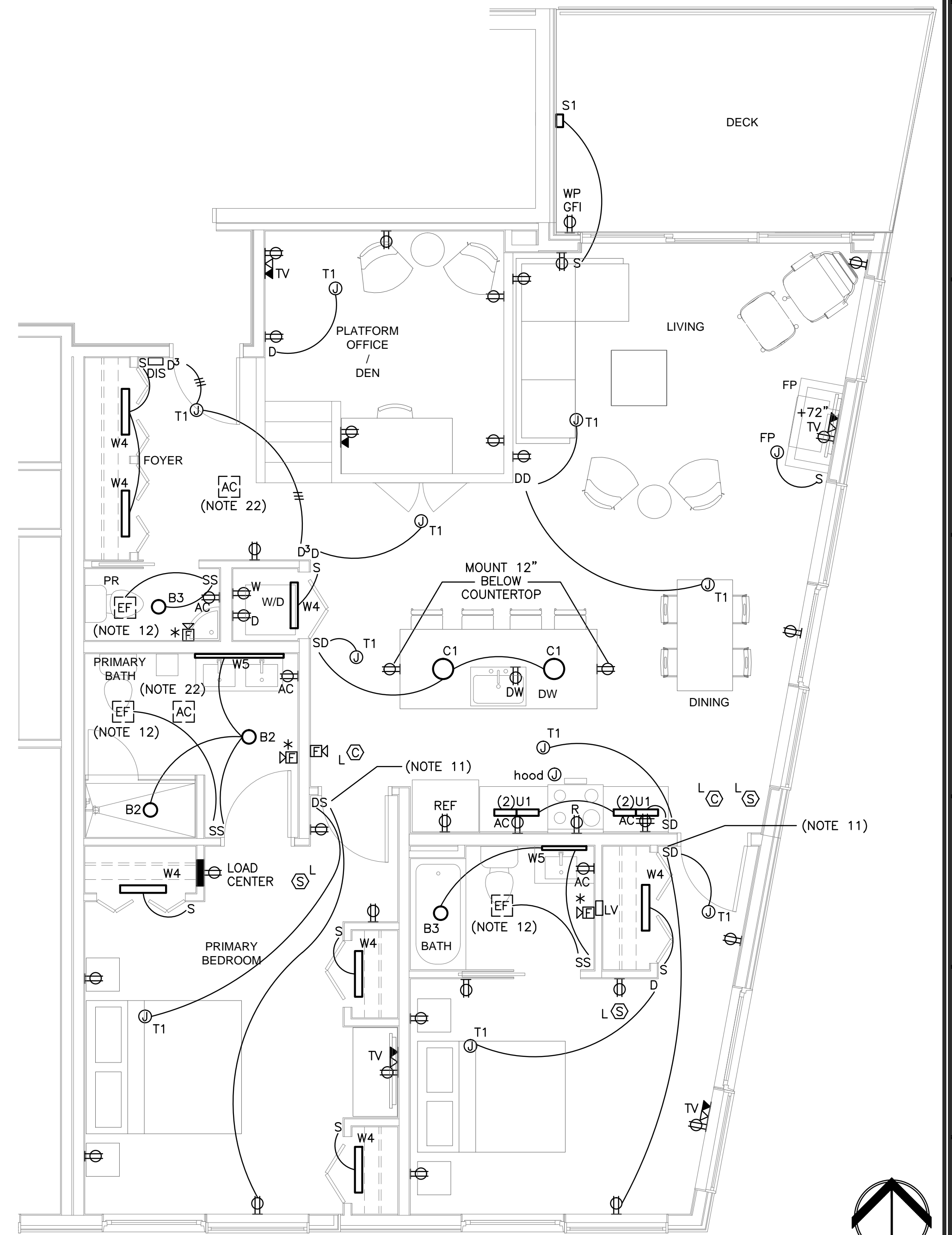

3 | UNIT 401
1/4" = 1'-0"

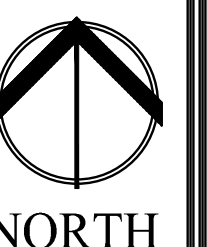

Prepared For:
NewHeight Group

Consultant:
Bartlett Design
ELECTRICAL ENGINEERING
441 HUNTERS ROAD
PORTLAND, ME 04103
TEL: (207) 448-5447 FAX: (207) 448-5000

Architect:
ARCHITYPE
architects
48 Union Wharf Portland, Maine 04101
(207) 772-6022 Fax (207) 772-4056

Project:
LUMINATO
Newbury Street Portland, Maine

Revisions:
06/17/16 100% REVIEW SET
07/22/16 REVISED PLANS
07/28/16 ADDENDUM A

Date: JUNE 17 2016
Scale: 1/4" = 1'-0"
UNITS 206, 211, 401,
402 & 502

E3.02