

UNIT PLAN NOTES:

- ALL 120V RECEPTACLES IN KITCHENS SHALL BE GFCI RATED EXCEPT FOR THE REFRIGERATOR.
- MINIMUM CIRCUIT BREAKER SIZE SHALL BE 20 AMP. MINIMUM WIRE SIZE SHALL BE #12 AWG.
- ALL 120 VOLT RECEPTACLE CIRCUITS IN LIVING UNITS SHALL BE ARC-FAULT TYPE CIRCUIT BREAKERS IN LOAD CENTERS, EXCEPT FOR BATHROOM RECEPTACLE CIRCUIT WHICH SHALL BE COMBINATION ARC-FAULT, GROUND FAULT.
- ALL RECEPTACLES IN LIVING UNITS SHALL BE TAMPER-RESISTANT.
- LOCAL SMOKE DETECTORS SHALL BE PHOTOELECTRIC TYPE.
- SMOKE DETECTORS AND CARBON MONOXIDE DETECTORS IN LIVING UNITS SHALL BE CIRCUITED TO THE LOCAL LIGHTING CIRCUIT.
- STROBE CANDELA RATING FOR HOUSE FIRE ALARM NOTIFICATION APPLIANCES SHALL BE 15cd.
- INSTALL LOAD CENTERS WITHIN HOUSE UNITS WITH THE TOP CIRCUIT BREAKER HANDLE AT 48IN AFF.
- COORDINATE THE EXACT LOCATION OF RECEPTACLES IN KITCHENS SO THAT NO POINT ON THE COUNTER IS GREATER THAN 24IN TO A RECEPTACLE. PROVIDE AN ABOVE COUNTER RECEPTACLE AT ALL KITCHEN COUNTERS THAT ARE GREATER THAN 12IN.
- CONTRACTOR SHALL BE RESPONSIBLE FOR PROVIDING RECEPTACLES ON EACH WALL SPACE THAT IS 24IN OR GREATER IN BEDROOMS, LIVING ROOMS, DINING ROOM/KITCHEN AREAS. COORDINATE THE EXACT LOCATION OF RECEPTACLES SO THAT AT NO POINT ALONG A WALL IS GREATER THAN 6FT TO A RECEPTACLE. IN ENTRY/FOYER AREAS A RECEPTACLE SHALL BE PROVIDED ON EACH WALL SPACE 36IN OR GREATER. PROVIDE A RECEPTACLE IN HALLWAYS/CORRIDORS GREATER THAN 10FT LONG.
- FOR RECEPTACLES INDICATED, CONNECT TOP HALF TO ROOM LIGHT SWITCH AS SHOWN, BOTTOM HALF SHALL REMAIN 'HOT' AT ALL TIMES.
- PROVIDE A SEPARATE SWITCH FOR BATHROOM FANS. CIRCUIT FANS TO UNIT LIGHTING CIRCUIT (AHEAD FOR LIGHT SWITCH).
- DO NOT INSTALL FLUSH MOUNTED BOXES BACK-TO-BACK IN WALLS; PROVIDE A MINIMUM 24 INCH SEPARATION, WHERE 24 INCH SEPARATION IS NOT PHYSICALLY POSSIBLE, APPROVAL FOR CLOSER SPACING SHALL BE OBTAINED FROM THE ARCHITECT PRIOR TO ROUGH-IN. IN SUCH CASES, PROVIDE UL LISTED FIRESTOP PADS FOR BOXES.
- ENSURE THAT OUTLET BOXES IN COMMON WALLS OF DWELLING UNITS ARE SEALED AGAINST AIR FILTRATION THROUGH THE USE OF CAULKING DRYWALL TO THE BOX AND PROVIDING COVER PLATE GASKETS.
- ELECTRICAL CONTRACTOR TO PROVIDE (2) PAR20 LED LAMPS TO BE INSTALLED WITHIN KITCHEN HOOD.
- MOUNT DISHWASHER RECEPTACLES WITHIN CABINET UNDERNEATH SINK SO THAT THEY ARE READILY ACCESSIBLE.
- CONNECT NO MORE THAN 6 RECEPTACLES TO A SINGLE RECEPTACLE CIRCUIT.
- UNLESS SPECIFICALLY NOTED OTHERWISE, ALL DISCONNECT SWITCH SIZES SHALL BE 30A/2P

19. PROVIDE THE FOLLOWING CIRCUITS WITHIN UNIT LOAD CENTERS:

- | | | |
|----------------------------------|--------------------------|--------------------------|
| 20A/1P RANGE | 20A/1P LIGHTS/DETECTORS | 20A/1P LIGHTS/DETECTORS |
| 20A/1P RANGE HOOD | 20A/1P BATHROOM RECEPT | 20A/1P BATHROOM RECEPT |
| 20A/1P REFRIGERATOR | 20A/1P BEDROOM RECEPTS | 20A/1P BEDROOM RECEPTS |
| 20A/1P KITCHEN RECEPTS | 20A/1P LIVING RM RECEPTS | 20A/1P LIVING RM RECEPTS |
| 20A/1P KITCHEN RECEPTS | 20A/1P WASHER (NOTE 20) | 20A/1P WASHER (NOTE 21) |
| 20A/1P DISHWASHER | 30A/2P WASHER (NOTE 20) | 30A/2P DRYER (NOTE 21) |
| 20A/1P FIREPLACE | 20A/2P A/C (NOTE 22) | 30A/2P A/C (NOTE 22) |
| 40A/2P WALL OVEN (UNIT 601 ONLY) | | |
20. UNITS 203, 204, 205, 303, 304, 305, 402 AND 502 SHALL HAVE A 208-VOLT, 1-PHASE, 30A RECEPTACLE CIRCUITED TO A 30A/2P CIRCUIT BREAKER FOR THE WASHER AND A 208-VOLT, 1-PHASE, 30A RECEPTACLE CIRCUITED TO A 30A/2P CIRCUIT BREAKER FOR THE DRYER.
21. UNITS 201, 202, 206, 301, 302, 306, 401, 403, 404, 406, 501, 503, 504, 505 AND 506 SHALL HAVE A 120-VOLT, 1-PHASE, 20A RECEPTACLE CIRCUITED TO A 20A/1P CIRCUIT BREAKER FOR THE WASHER AND ONE A 120-VOLT, 1-PHASE, 20A RECEPTACLE CIRCUITED TO A 20A/1P CIRCUIT BREAKER FOR THE DRYER. COORDINATE INSTALLATION HEIGHTS WITH APPLIANCE REQUIREMENTS.
22. INDOOR AC UNIT SHALL BE POWERED THROUGH THE CORRESPONDING OUTDOOR CONDENSING UNIT LOCATED ON THE ROOF (SEE SHEETS E1.01, E1.03 AND E1.04). PROVIDE WITHIN EACH UNIT LOAD CENTER A CIRCUIT BREAKER AND POWER WIRING TO THE UNIT'S CONDENSING UNIT. CIRCUIT BREAKER SIZES SHALL BE AS FOLLOWS:
20/2 CB UNITS 201 THRU 206, 301 THRU 306, 402 THRU 405, AND 502 THRU 505
30/2 CB UNITS 401, 405, 501, 505, 601 & 602.

4 LIVING UNIT NOTES
NONE

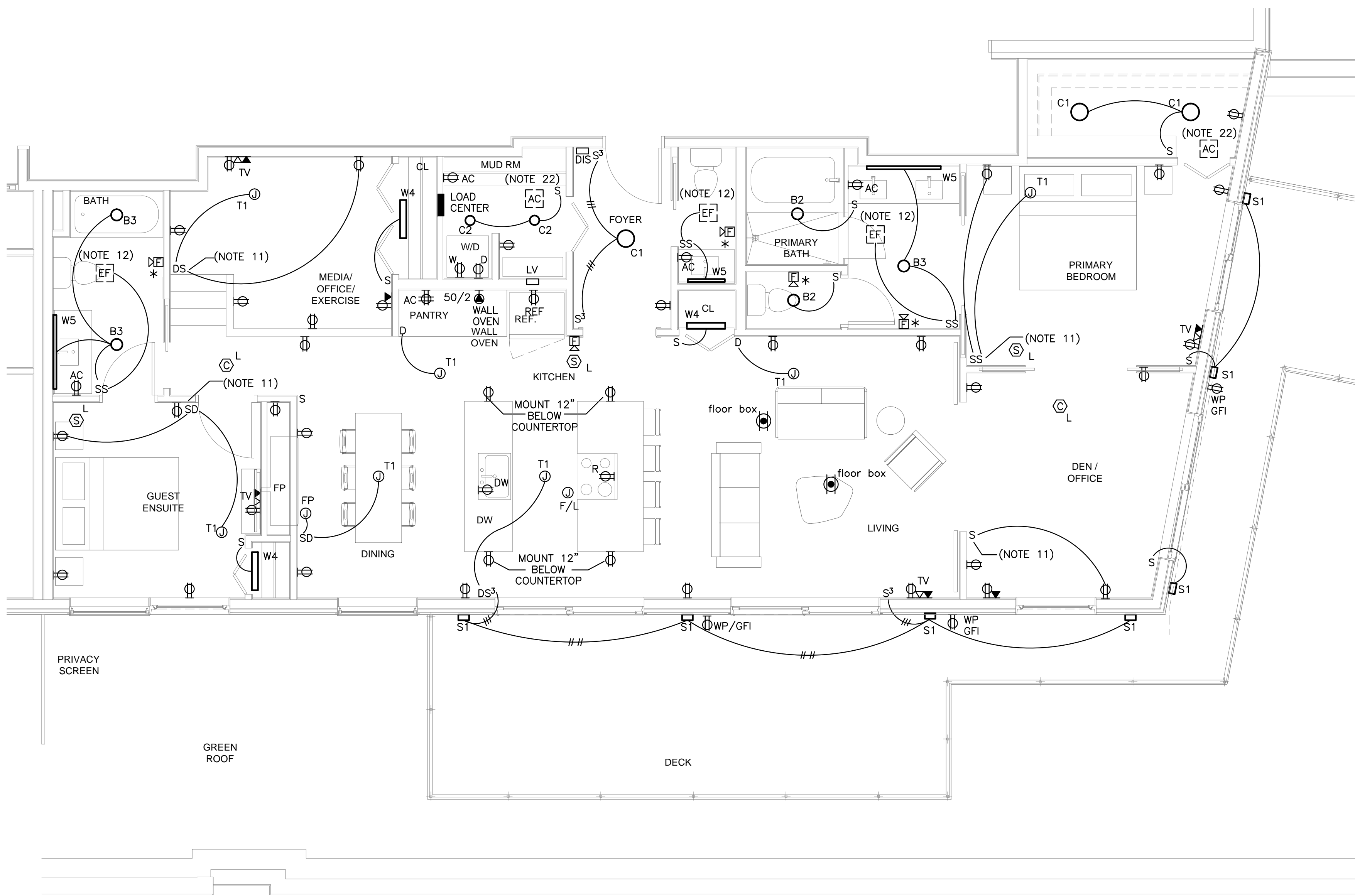

1 UNIT 601
1/4" = 1'-0"

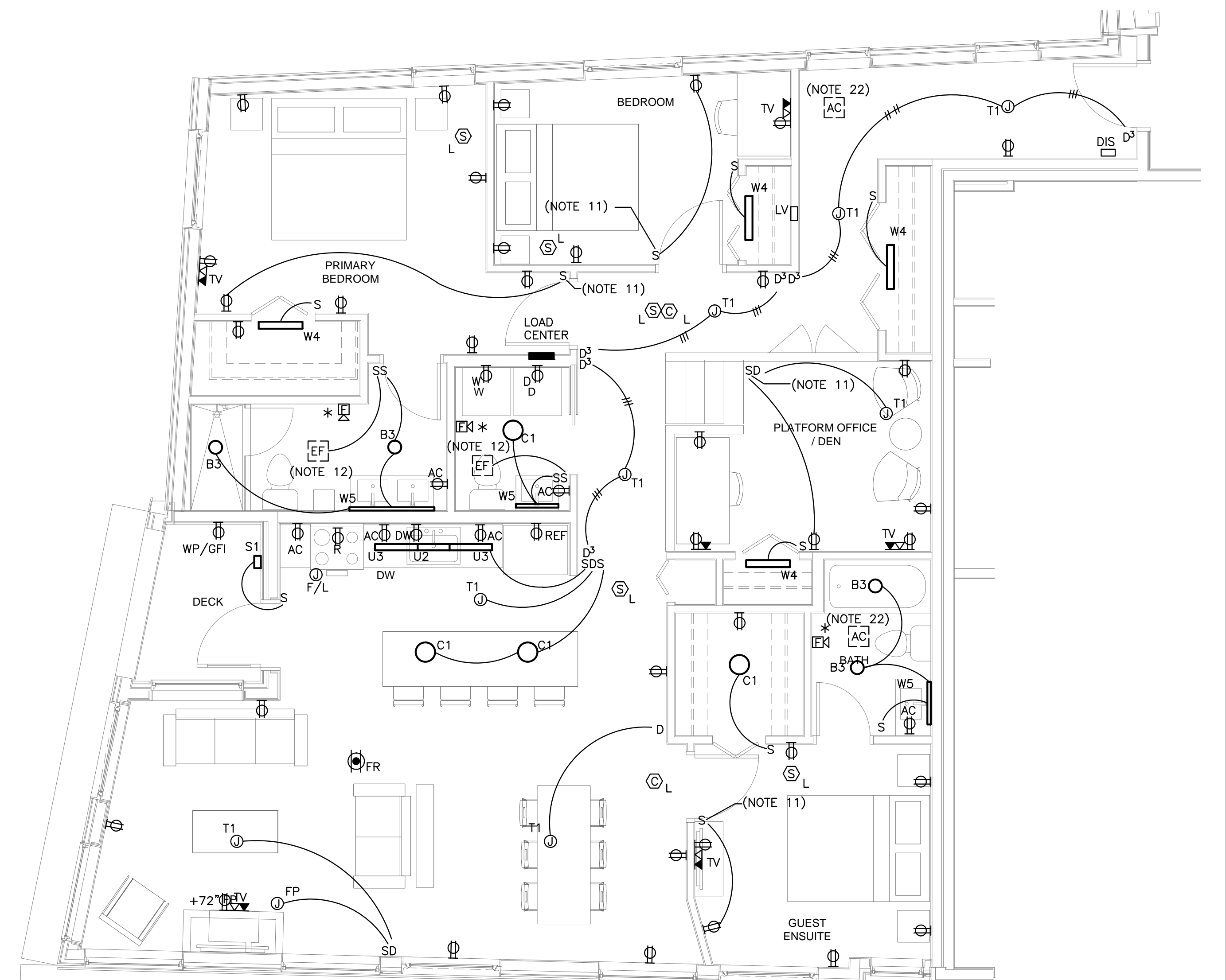

3 UNIT 506
1/4" = 1'-0"

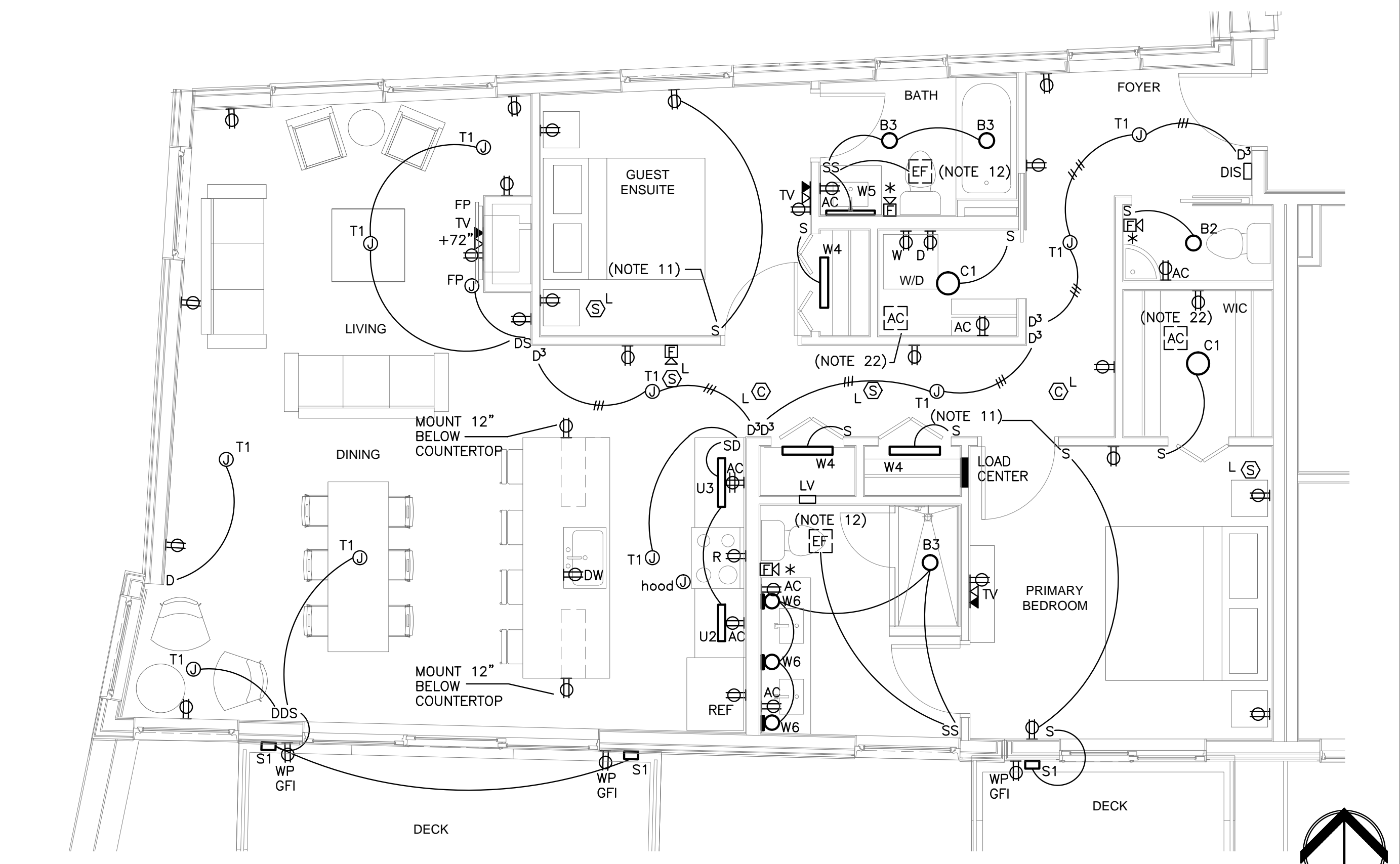

2 UNIT 602
1/4" = 1'-0"

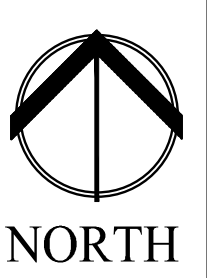

Prepared For: **NewHeight Group**

Consultant: **Bartlett Design**
Electrical Engineering
448 Union Wharf, Portland, Maine 04101
Tel: (207) 443-3447 Fax: (207) 443-3000

Architect: **ARCHETYPE architects**
48 Union Wharf, Portland, Maine 04101
(207) 772-6022 Fax (207) 772-4056

Project: **LUMINATO**
Newbury Street Portland, Maine

Revisions: 06/17/16 100% REVIEW SET
07/22/16 REVISED PLANS

Date: **JUNE 17 2016**
Scale: **1/4" = 1'-0"**
UNITS 506, 601 & 602

E3.04