

COLUMN SCHEDULE

COL. NO.	C1	C2	C3	C4	C5	C6	C7	C8	C9	C10	C11	C12	C13	C14	C15	C16	C17	C18	C19	C20	C21	C22	C23	C24	C25	C26	C27
LEVEL																											
ROOF EL. VARIES																											
THIRD FLOOR																											
SECOND FLOOR																											
FIRST FLOOR																											
BASE PL. TYPE	--																										
BASE PL. SIZE	XX" X XX"																										
"N" X "L" X "B"	X XX"																										

COLUMN SCHEDULE NOTES:
 1. ALL HSS COLUMNS SHALL BE ASTM A500 GRADE B.
 2. ALL WF COLUMNS SHALL BE ASTM A572 GRADE 50.

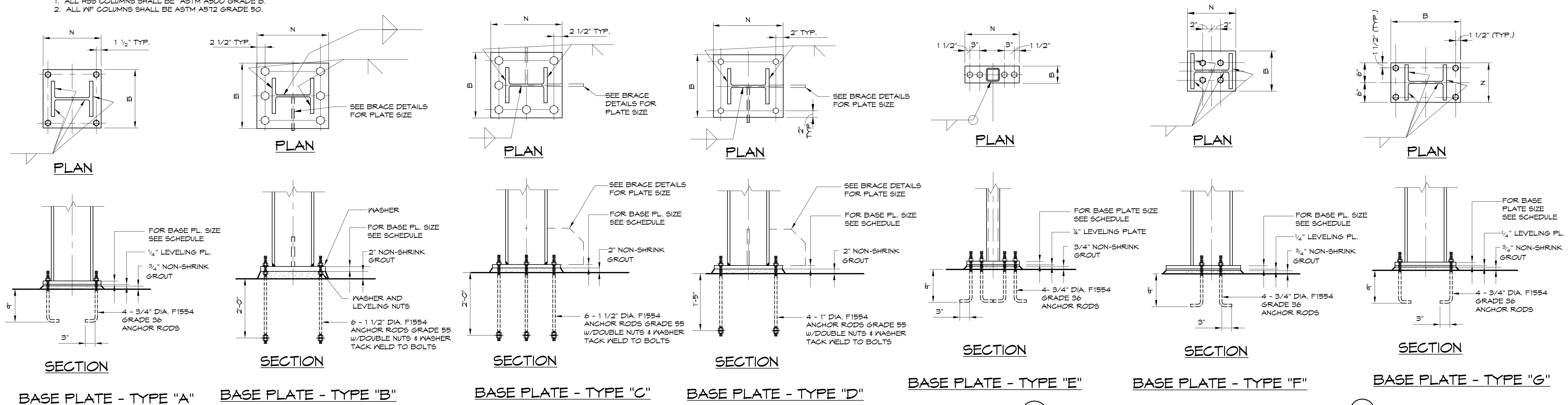

PIER SCHEDULE				
MARK	TYPE	SIZE "A" X "B"	REINFORCING	TIES
P1	A	30" x 30"	Ø-#8	#4@12"
P2	B	24" x 24"	Ø-#8	#4@12"
P3	C	24" x 24"	Ø-#8	#4@12"
P4				
P5				
P6				
P7				
P8				

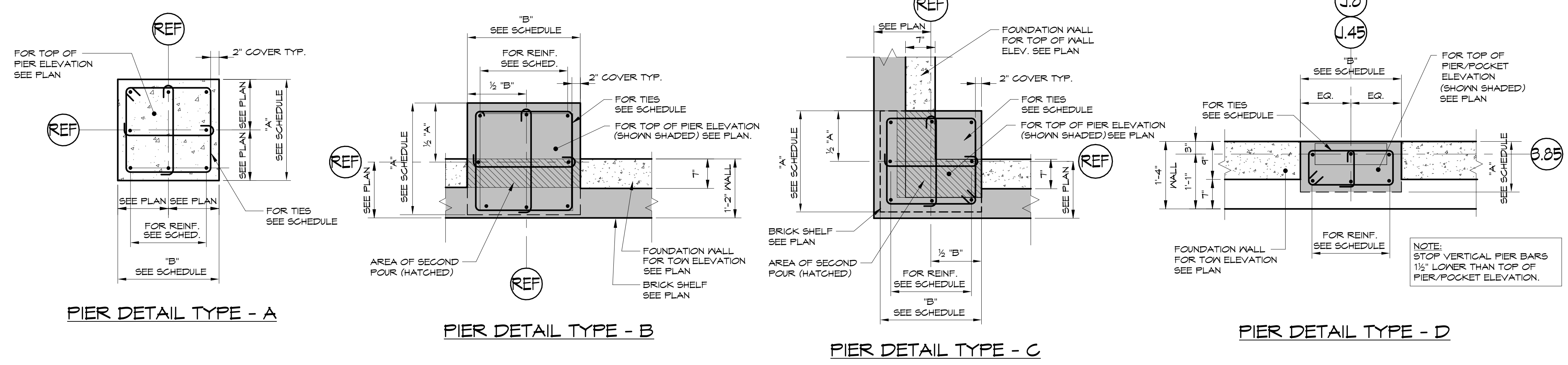

SECTION AT TYPICAL PIER
 3/4"=1'-0"

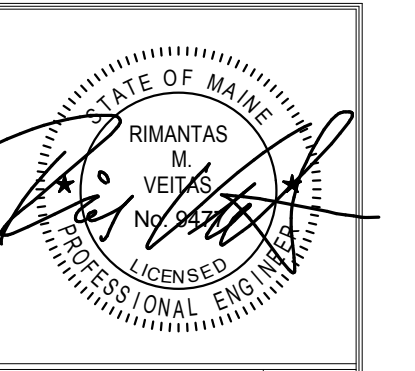

Prepared For:
NewHeight Group
 118 Congress Street, Unit 401
 Portland, Maine

Consulting Engineer:
VEITAS & VEITAS
 engineers
 638 Granite Street, Suite 101
 Business: 201.874.0214
 Tel: 201.874.0200 FAX: 201.874.0205

Architect:
ARCHETYPE
 architects
 48 Union Wharf Portland, Maine 04101
 (207) 775-6022 ARCHETYPE@ARCHETYPEPA.COM

Project:
LUMINATO
 Newbury Street Portland, Maine

Revisions:
 5/16/16 FOUNDATION PERMIT

Date: 04/19/16
 Scale: As indicated
COLUMN SCHEDULE & PIER DETAILS

S301