

GRANT HAYS
ASSOCIATES

ARCHITECTURE & INTERIOR DESIGN
P.O. BOX 6179 FALMOUTH MAINE 04105
207.871.5900 www.granthays.com

1/2" = 1'-0"

REV/NO/DATE

DRAWING NAME

HISTORIC EXTERIOR WINDOWS
CUMBERLAND COUNTY COURTHOUSE
205 NEWBURY STREET PORTLAND, MAINE 04101

1/2" = 1'-0"

SECOND
FLOOR
PLAN

DATE
7 DEC '15

SCALE
1/8" = 1'-0"

DRAWN
MFH/mgk

JOB NO.
150512

1/2" = 1'-0"

A-3

COPYRIGHT
REPRODUCTION OR REV. OF THIS
DOCUMENT WITHOUT WRITTEN
PERMISSION FROM GRANT HAYS
ASSOCIATES IS PROHIBITED.

DEMOLITION NOTES

1. REMOVE EXISTING METAL WINDOWS IN OPENINGS DESIGNATED TO RECEIVE NEW UNITS. DISPOSE OF EXISTING WINDOWS IN ACCORDANCE WITH LAWS, REGULATIONS, AND ORDINANCES.
2. PREPARE THE OPENINGS TO RECEIVE NEW WINDOWS AS REQUIRED AND IN ACCORDANCE WITH THE DETAILS INDICATED. FIELD VERIFY EXISTING MASONRY OPENING AND INTERIOR FINISH OPENING PRIOR TO ORDERING AND INSTALLING WINDOWS.
3. PROTECT EXISTING EXTERIOR STONEMWORK DURING DEMOLITION AND NEW WINDOW INSTALLATION.
4. PROTECT EXISTING INTERIOR WOODWORK AND WALL FINISHES DURING DEMOLITION AND NEW WINDOW INSTALLATION.
5. REPAIR ANY DAMAGE TO ANY EXISTING SURFACE TO REMAIN TO MATCH THE EXISTING ADJACENT FINISH AT NO ADDITIONAL EXPENSE TO THE OWNER.

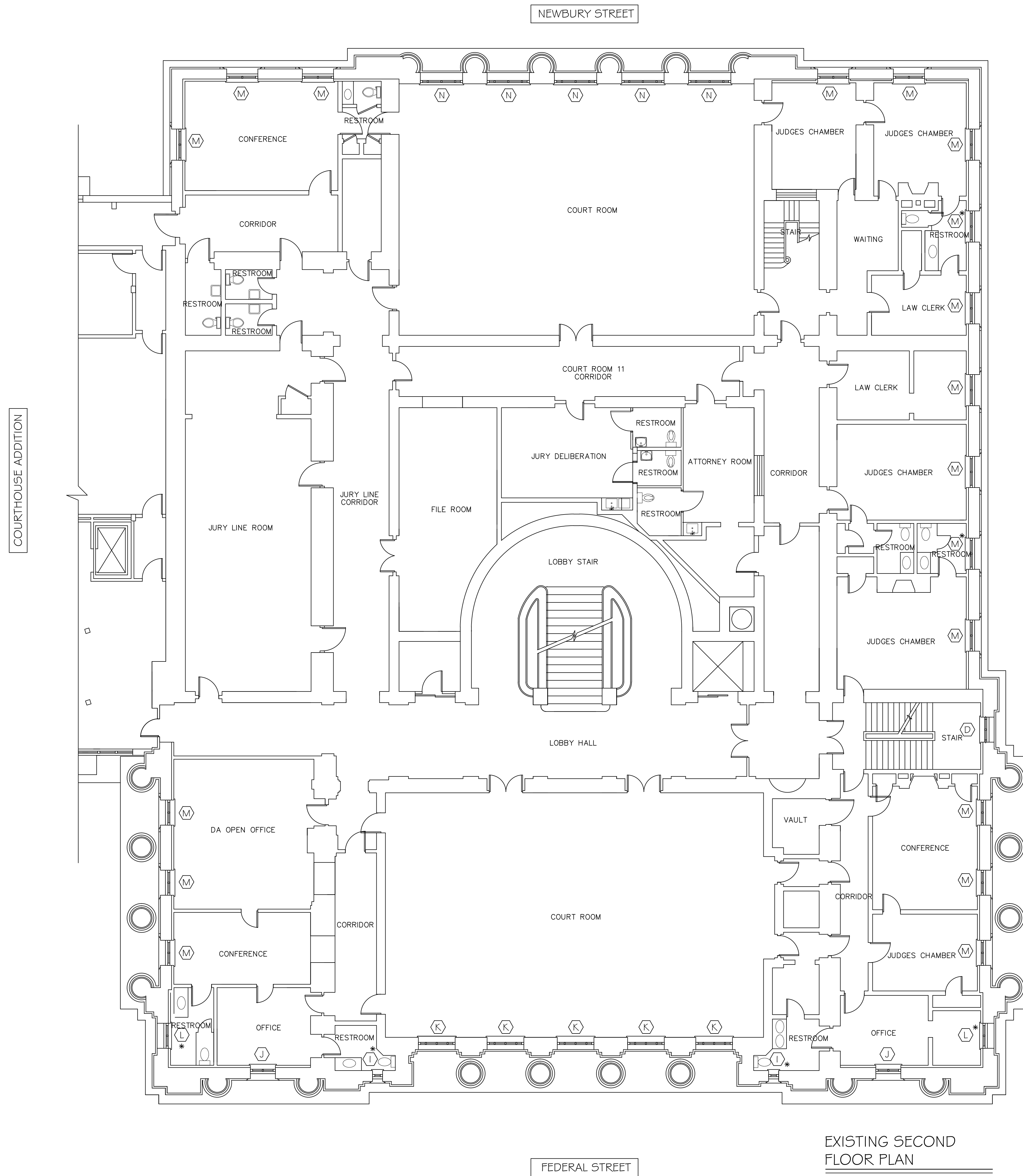

EXISTING SECOND
FLOOR PLAN

SCALE: 1/8" = 1'-0"