

GRANT HAYS
ASSOCIATES

ARCHITECTURE & INTERIOR DESIGN
P.O. BOX 6179 FALMOUTH MAINE 04103
207.871.5900 www.granthays.com

SCALE

REVISION

DRAWING NAME

HISTORIC EXTERIOR WINDOWS
CUMBERLAND COUNTY COURTHOUSE
205 NEWBURY STREET PORTLAND, MAINE 04101

SHEET

BASEMENT
FLOOR
PLAN

DATE 7 DEC '15
SCALE 1/8"=1'-0"
DRAWN MFH/mgk
JOB NO. 150512

SHEET
A-1
COPYRIGHT REPRODUCTION OR REVUE OF THIS DOCUMENT WITHOUT WRITTEN PERMISSION FROM GRANT HAYS ASSOCIATES IS PROHIBITED.

DEMOLITION NOTES

1. REMOVE EXISTING METAL WINDOWS IN OPENINGS DESIGNATED TO RECEIVE NEW UNITS. DISPOSE OF EXISTING WINDOWS IN ACCORDANCE WITH LAWS, REGULATIONS, AND ORDINANCES.
2. PREPARE THE OPENINGS TO RECEIVE NEW WINDOWS AS REQUIRED AND IN ACCORDANCE WITH THE DETAILS INDICATED. FIELD VERIFY EXISTING MASONRY OPENING AND INTERIOR FINISH OPENING PRIOR TO ORDERING AND INSTALLING WINDOWS.
3. PROTECT EXISTING EXTERIOR STONEMWORK DURING DEMOLITION AND NEW WINDOW INSTALLATION.
4. PROTECT EXISTING INTERIOR WOODWORK AND WALL FINISHES DURING DEMOLITION AND NEW WINDOW INSTALLATION.
5. REPAIR ANY DAMAGE TO ANY EXISTING SURFACE TO REMAIN TO MATCH THE EXISTING ADJACENT FINISH AT NO ADDITIONAL EXPENSE TO THE OWNER.

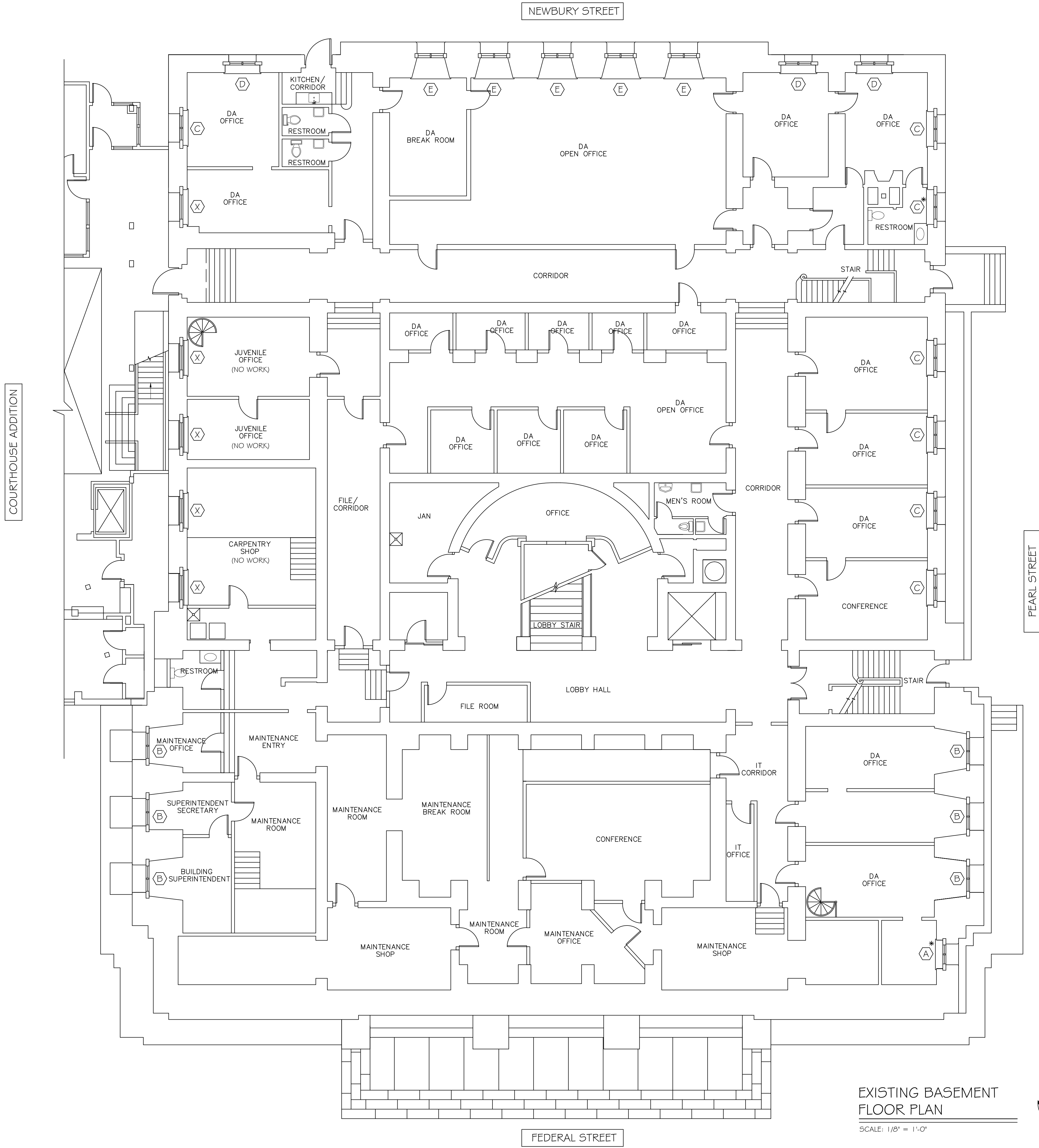

EXISTING BASEMENT
FLOOR PLAN
SCALE: 1/8" = 1'-0"

