

C:\Users\Gschertler\AppData\Local\Temp\AcPublish_9156\17051E.dwg Dec 22, 2017 9:05am

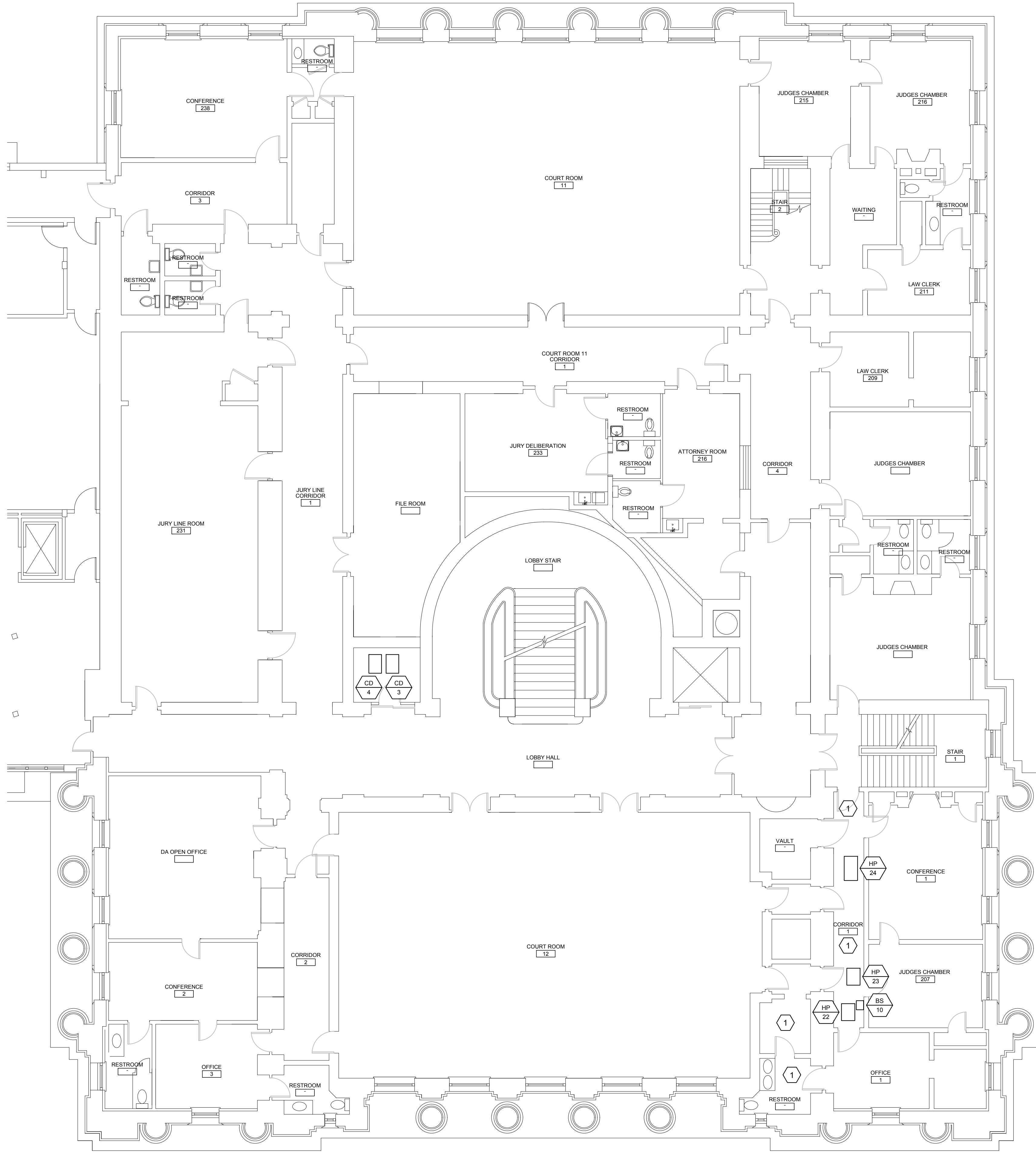

A1 ELECTRICAL SECOND FLOOR PLAN
SCALE: 1/8"=1'-0"

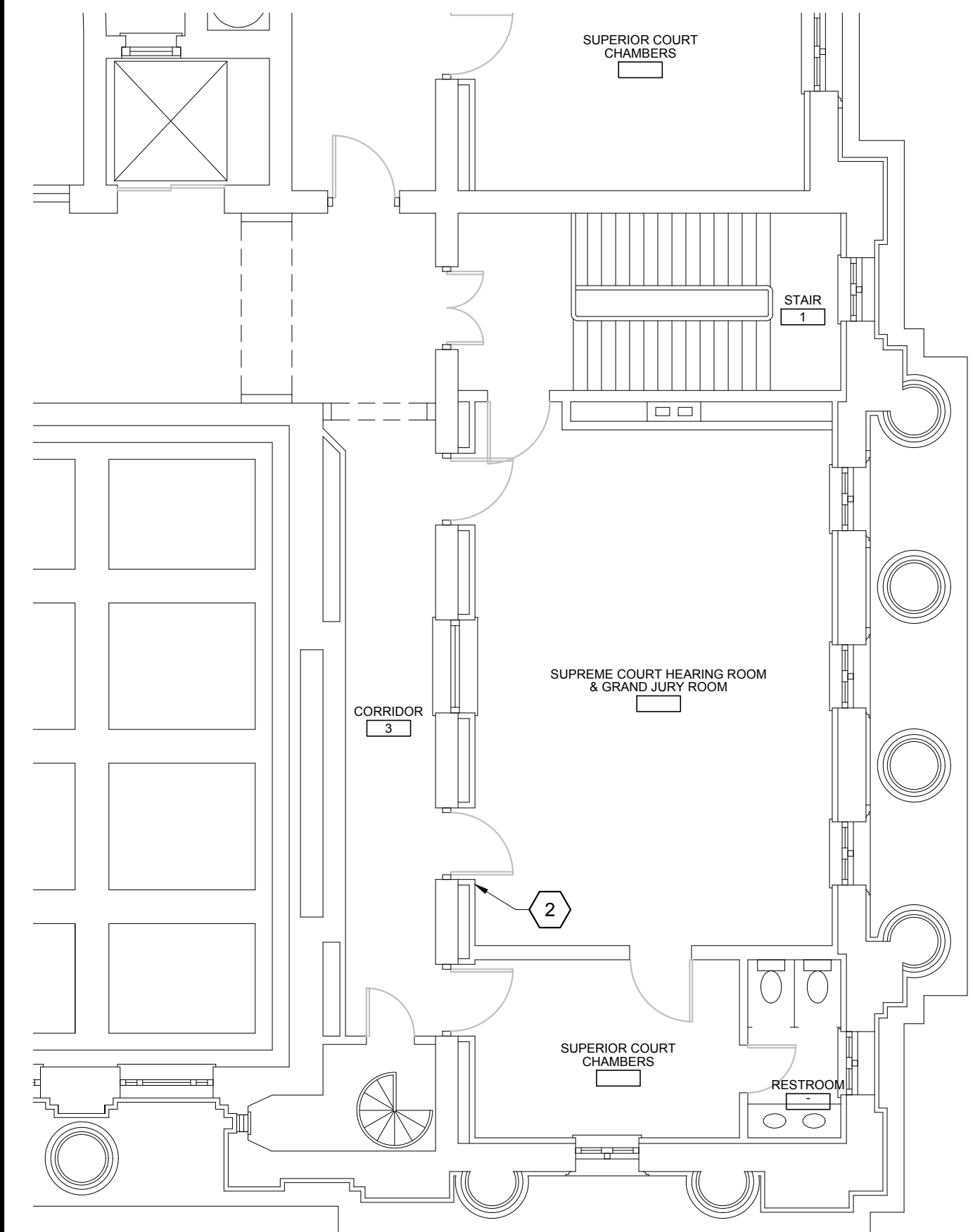

E7 ELECTRICAL THIRD FLOOR PART PLAN
SCALE: 1/8"=1'-0"

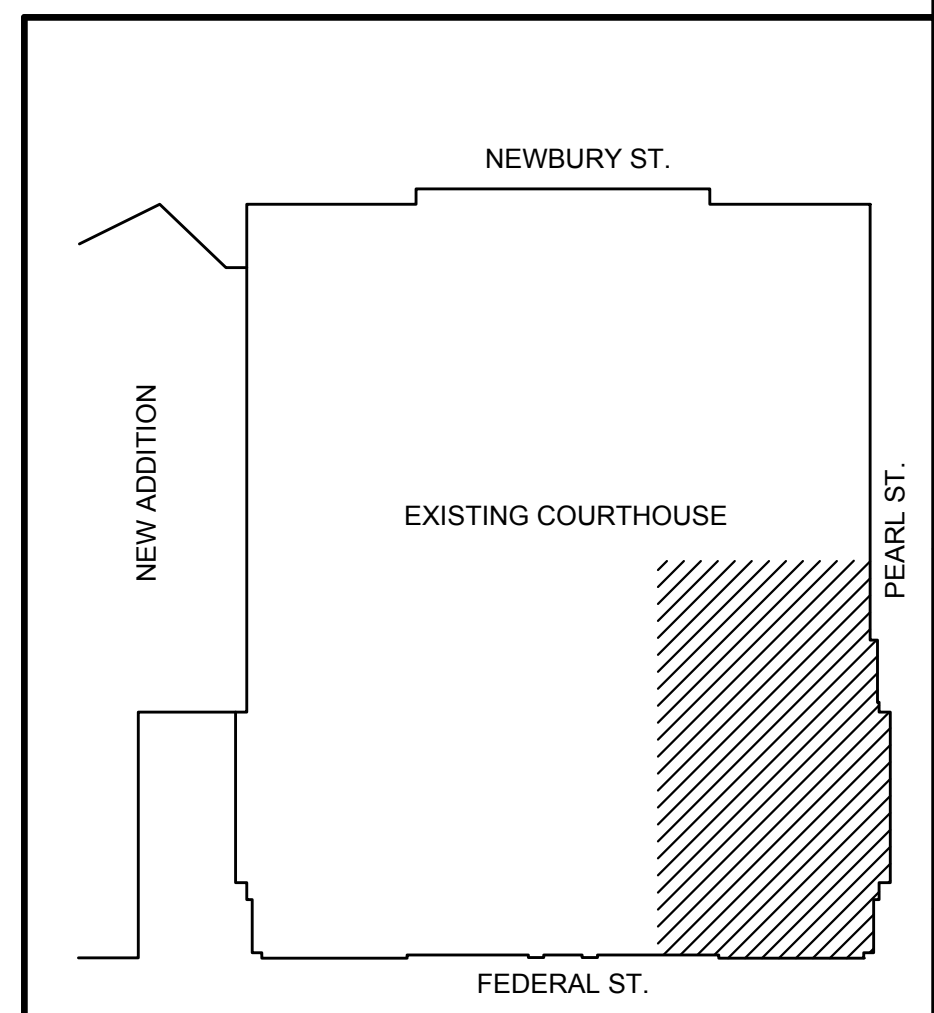

E9 THIRD FLOOR KEY PLAN
DO NOT SCALE

- C9** KEYNOTES
- DO NOT SCALE
- 1 EXISTING ACOUSTICAL CEILING IN THIS AREA WILL BE REMOVED AND RE-INSTALLED UNDER OTHER DIVISIONS. REMOVE, PROTECT, AND RE-INSTALL EXISTING CEILING MOUNTED ELECTRICAL ITEMS. PROVIDE SUPPORTS AS REQUIRED TO SUPPORT ABOVE-CEILING WIRING IN ACCORDANCE WITH CODE REQUIREMENTS.
 - 2 EXISTING WAINSCOTING ON WALL WILL BE REMOVED AND RE-INSTALLED UNDER OTHER DIVISIONS. PROTECT TWO EXISTING CATEGORY SE DATA CABLES THAT RUN VERTICALLY UP THE WALL SURFACE DURING WAINSCOTING REMOVAL AND RE-ROUTE TO BE CONCEALED WITHIN WALL.

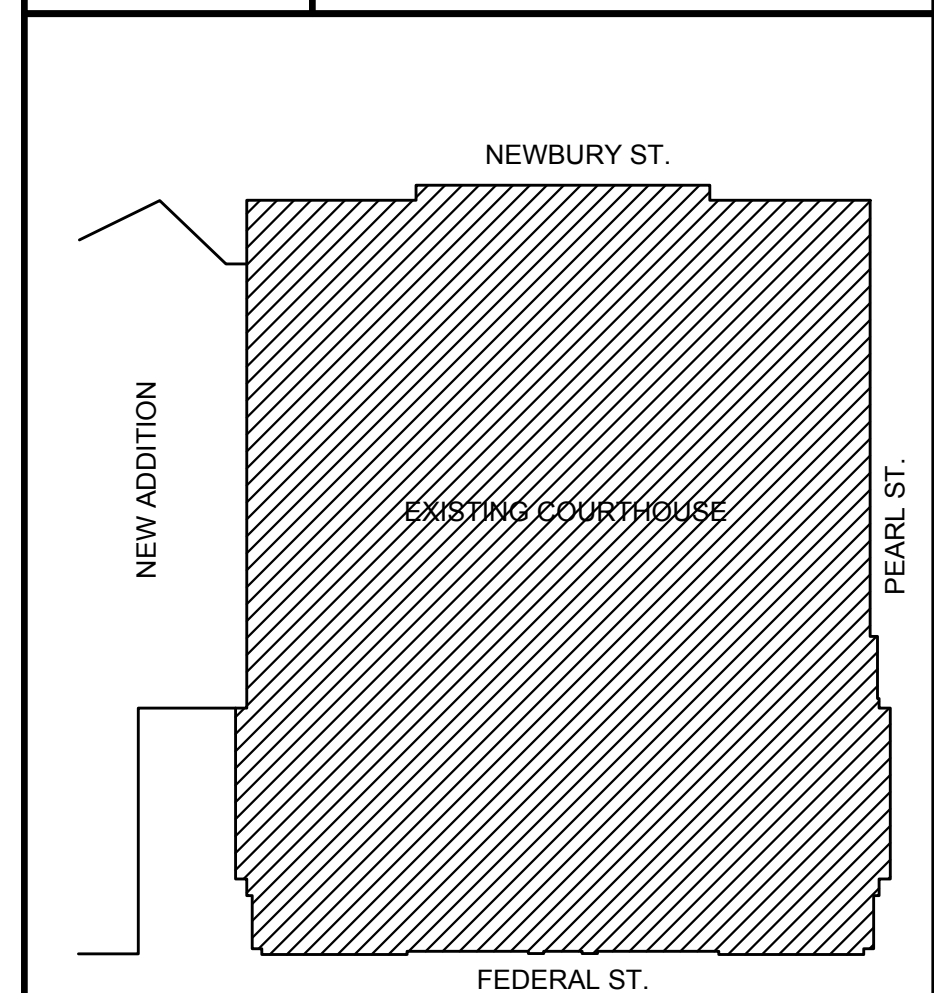

A9 SECOND FLOOR KEY PLAN
DO NOT SCALE

160 Veranda Street
Portland, Maine 04103
T: 207.221.2260
F: 207.221.2266
Web: www.allied-eng.com

Allied Engineering
Structural Mechanical Electrical Commissioning

REVISIONS	
NUMBER	DESCRIPTION

Date: DECEMBER 22, 2017
Drawn By: GMC
Checked By: SRM
Project Mgr: ASD
Project No: 17051
Cad File: 17051E.DWG
Graphic Scale: 0' 1'

ELECTRICAL SECOND & THIRD FLOOR PLANS

AIR CONDITIONING AND HEATING UPGRADES
CUMBERLAND COUNTY COURTHOUSE
142 FEDERAL STREET, PORTLAND, MAINE
© 2017 ALLIED ENGINEERING, INC.

E-101