

A1 FLOOR PLAN
3/32"=1'-0"

C:\Users\Gfaucher\OneDrive\Public\752910057E.dwg Oct 28, 2016 - 11:58am

CIRCUITING NOTE:
PROVIDE (1) 20A 277V SIEMENS TYPE BQCH CIRCUIT BREAKER IN EXISTING PANEL N TO FEED LIGHTING IN THIS PROJECT.

- 1 LIGHTING CONTROL SHALL BE MANUAL ON/MANUAL OFF VIA WALL SWITCHES.
- 2 LIGHTING CONTROL SHALL BE 0-10V DIMMING VIA WALL SWITCHES.

F7 LIGHTING CONTROL NOTES

- 1 CONNECT FIXTURE TO STAIR LIGHTING CIRCUIT AND SWITCHING.
- 2 REPLACE EXISTING SWITCH CONTROLLING EXISTING LIGHTING FOR FILE STORAGE AREA WITH SWITCH AS INDICATED.
- 3 CONNECT SWITCH TO EXISTING WIRING TO CONTROL EXISTING FILE STORAGE AREA LIGHTING.

F8 KEYNOTES

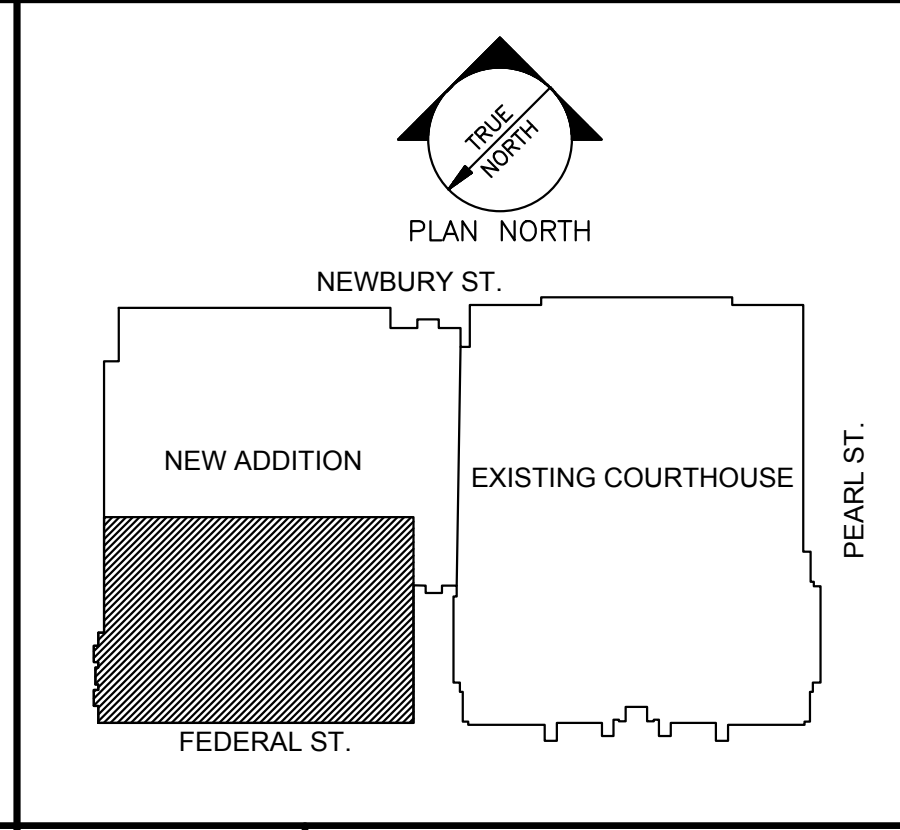

F9 KEY PLAN

STATE OF MAINE
CATHERINE A. FAUCHER
No. 75291
REGISTERED PROFESSIONAL ENGINEER

Allied Engineering
Structural Mechanical Electrical Commissioning

160 Veranda Street
Portland, Maine 04103
T: 207.221.2260
F: 207.221.2266
Web: www.allied-eng.com

AEI Project No: 16057

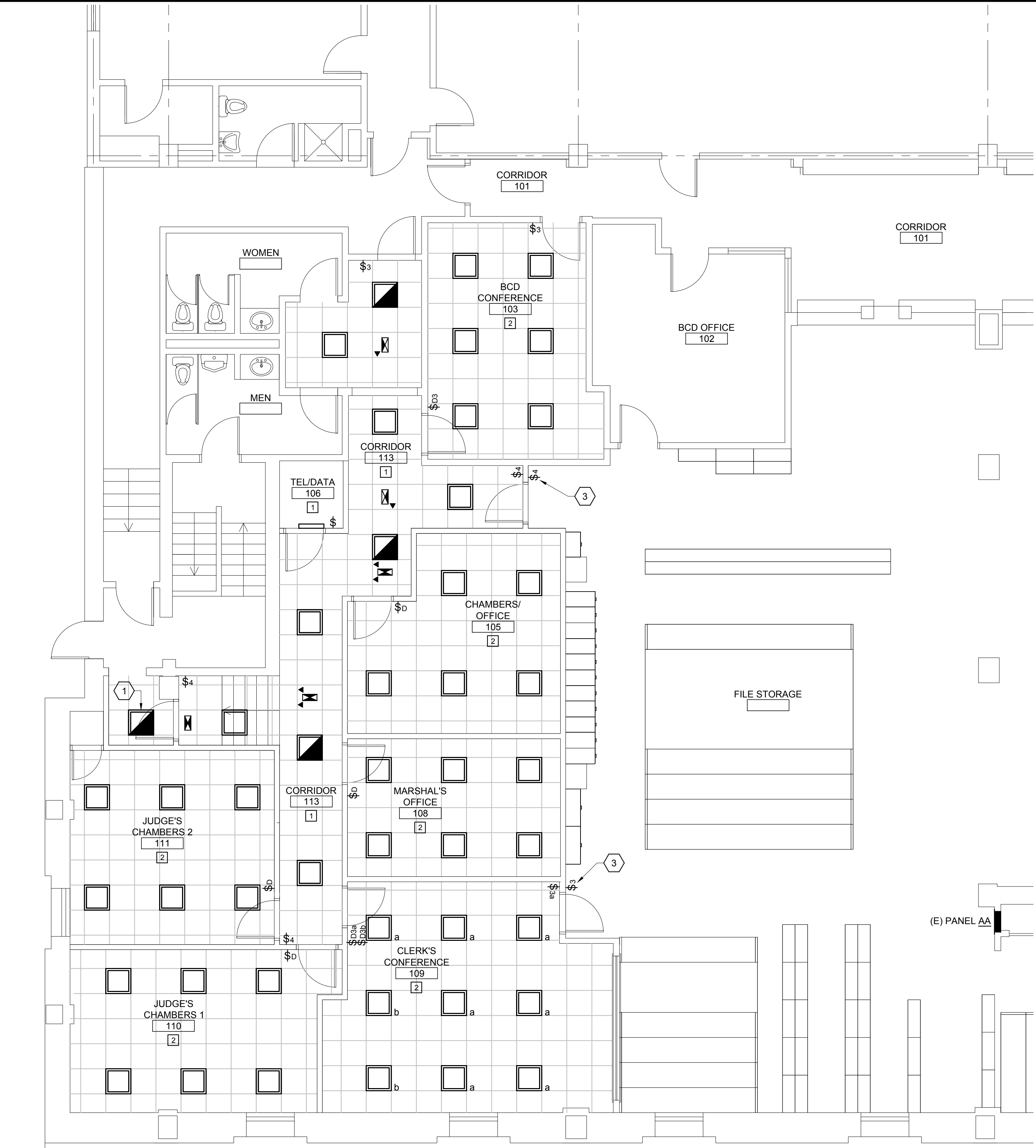

A6 ENLARGED FLOOR PLAN- LIGHTING
1/4"=1'-0"

GROUND FLOOR CLERK'S RENOVATIONS
CUMBERLAND COUNTY COURTHOUSE
PORTLAND, MAINE

SRL Architects
Bethel Portland

93 Pitt Street
Portland, ME 04103
207.747-5975 voice

822 Grover Hill Rd.
Bethel, ME 04217
207.824.7237 voice/fax
info@smithreuter.com

ELECTRICAL LIGHTING PLAN - GROUND FLOOR

BGS #2720
SRL 239-18

10/28/2016

E1