

PRINTED: Jun 04, 2014

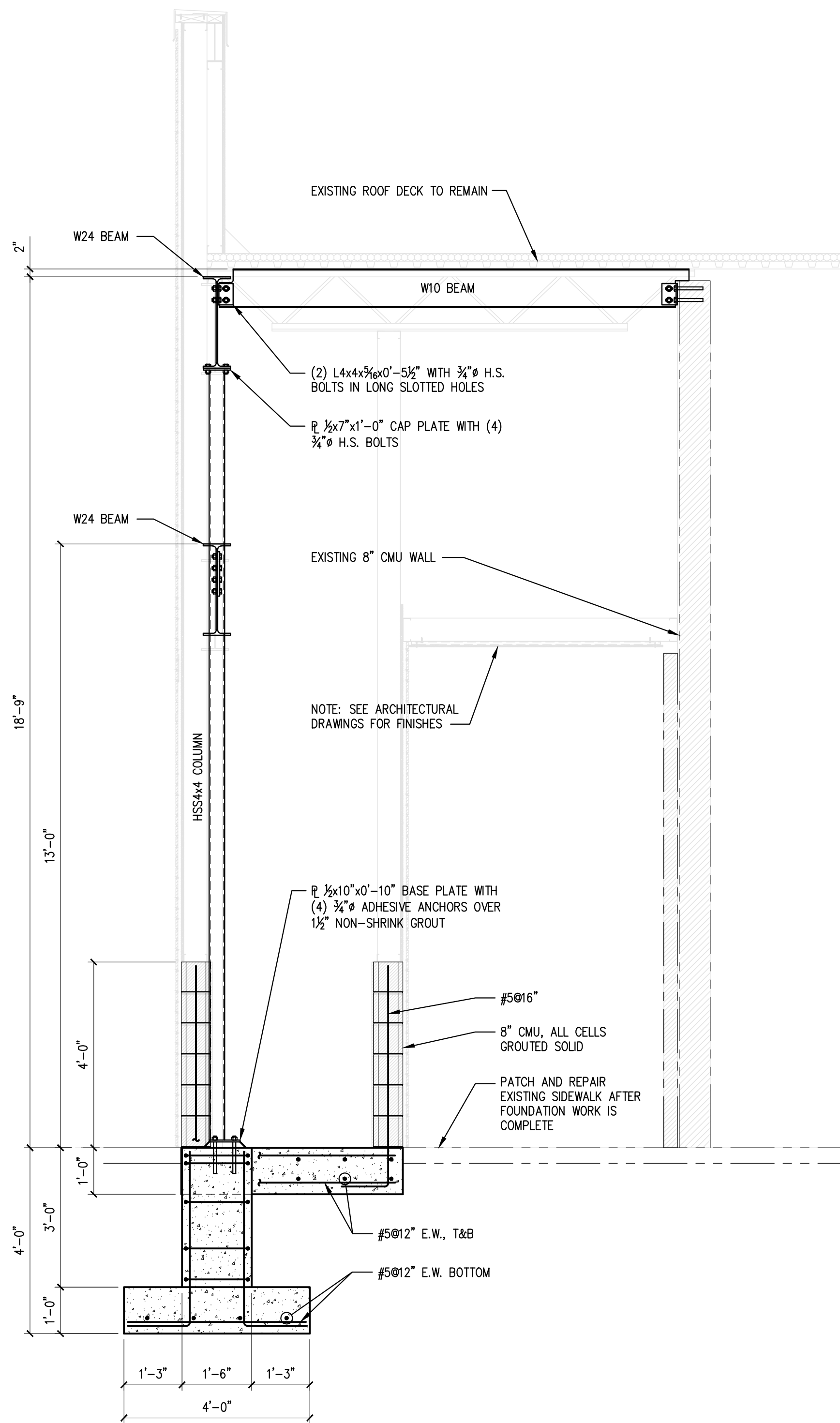

NOTE: DRAWINGS BASED ON FIELD INVESTIGATIONS. CONTRACTOR SHALL FIELD VERIFY AND CONFIRM ALL EXISTING CONDITIONS AND DIMENSIONS PRIOR TO FABRICATION, ERECTION AND CONSTRUCTION.

SECTION

SCALE: 1/2"=1'-0"

1

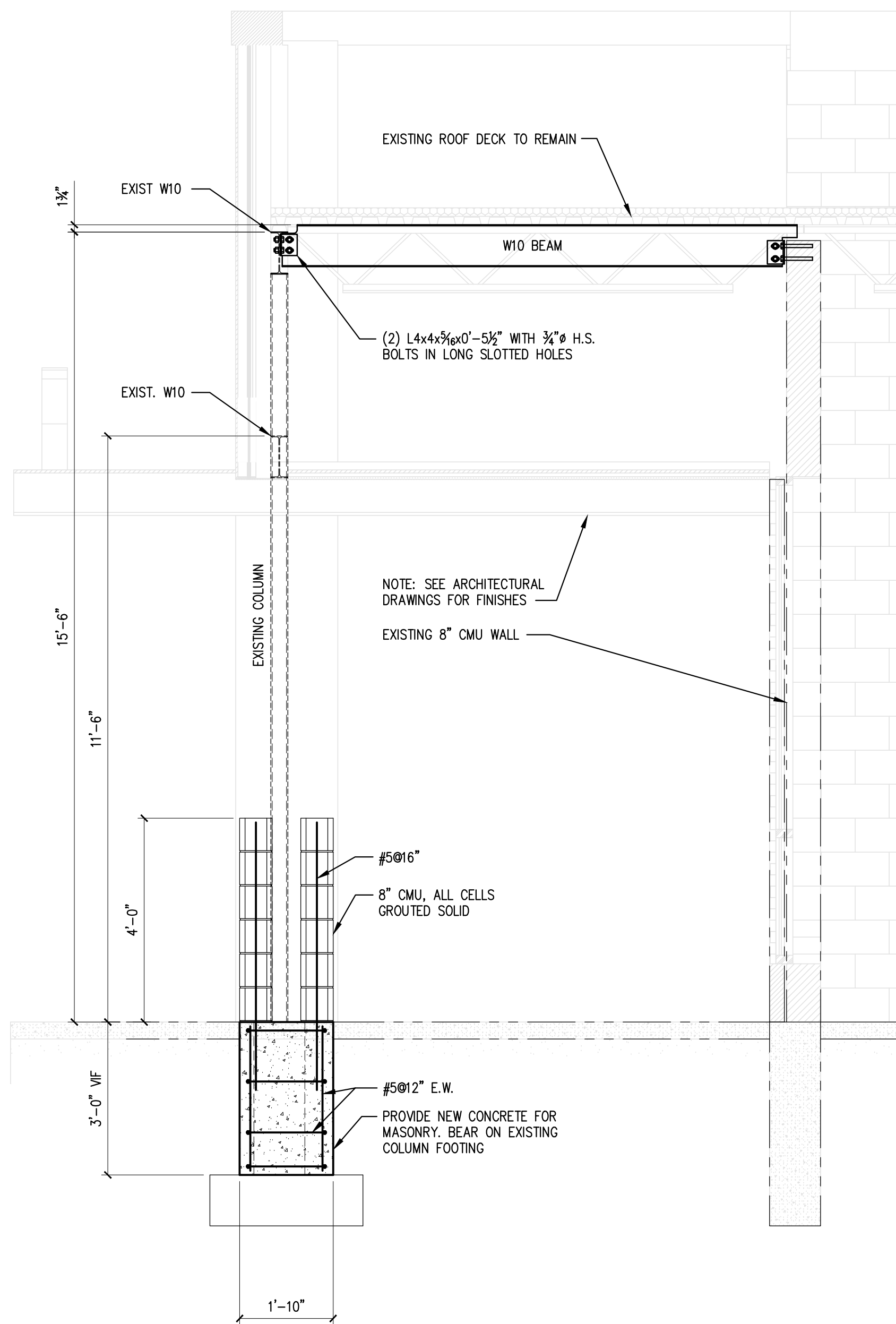

SECTION

SCALE: 1/2"=1'-0"

2

SECTION

SCALE: 1/2"=1'-0"

-

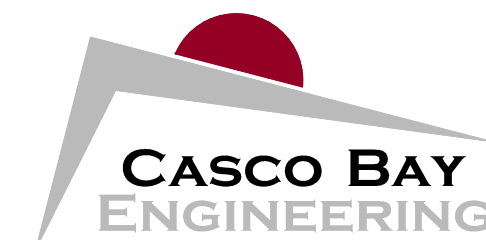

424 Fore Street
Portland, ME 04101
Phone 207.842.2800
Fax 207.842.2828
www.cascobayengineering.com

CLIENT:
WHIPPLE - CALLENDER
ARCHITECTS

136 PLEASANT AVENUE
PORTLAND, MAINE 04101

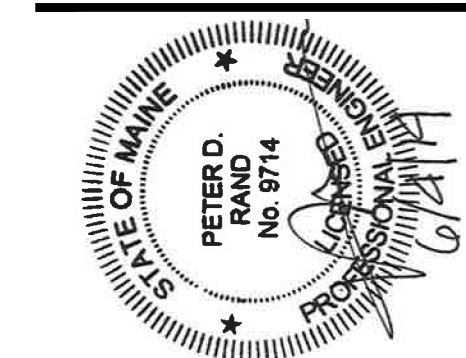

290 CONGRESS STREET
290 CONGRESS STREET
PORTLAND, MAINE

CANOPY RENOVATIONS

No.	DESCRIPTION	ISSUED		ISSUED FOR CLIENT REVIEW		ISSUED FOR PERMIT	
		DR.	DATE	PDR	DATE	PDR	DATE
A							
B							

SHEET TITLE:

SECTIONS AND
DETAILS

DESIGNED: PDR
DRAWN: PDR
DATE: 5-21-14
PROJECT NUMBER: 14-030

S200