

DISPLAY THIS CARD ON PRINCIPAL FRONTAGE OF WORK

CITY OF PORTLAND

BUILDING INSPECTION

PERMIT

Permit Number: 091209

Please Read Application And Notes, If Any, Attached

This is to certify that CITY OF PORTLAND /Rally for Equality
has permission to Stage Set-up 11/2/2009 Rally for Equality Breakdown same day
AT 456 CONGRESS ST CE 027 G001001

provided that the person or persons, firm or corporation accepting this permit shall comply with all of the provisions of the Statutes of Maine and of the Ordinances of the City of Portland regulating the construction, maintenance and use of buildings and structures, and of the application on file in this department.

Apply to Public Works for street line and grade if nature of work requires such information.

Notification of inspection must be given and written permission procured before this building or part thereof is lathed or otherwise enclosed-in. 24 HOUR NOTICE IS REQUIRED.

A certificate of occupancy must be procured by owner before this building or part thereof is occupied.

OTHER REQUIRED APPROVALS

Fire Dept. CAPT. Ke Sautter
Health Dept. _____
Appeal Board _____
Other _____
Department Name

[Signature] 10/30/09
Director - Building & Inspection Services

PENALTY FOR REMOVING THIS CARD

PERMIT ISSUED

OCT 29 2009

City of Portland

City of Portland, Maine - Building or Use Permit Application

389 Congress Street, 04101 Tel: (207) 874-8703, Fax: (207) 874-8716

Permit No: 09-1209	Issue Date:	CBL: 027 G001001
-----------------------	-------------	---------------------

Location of Construction: 456 CONGRESS ST	Owner Name: CITY OF PORTLAND	Owner Address: 389 CONGRESS ST	Phone:
Business Name:	Contractor Name: Rally for Equality	Contractor Address:	Phone
Lessee/Buyer's Name	Phone:	Permit Type: Tents	Zone: B-3

Past Use: Monument Square	Proposed Use: Monument Square - Stage Set-up 11/2/2009 Rally for Equality breakdown same day	Permit Fee: \$30.00	Cost of Work: \$30.00	CEO District: 1
		FIRE DEPT: <input checked="" type="checkbox"/> Approved <input type="checkbox"/> Denied	INSPECTION: Use Group: <i>Temp Stage</i> Type: <i>IBC-2003</i>	

Proposed Project Description: Stage Set-up 11/2/2009 Rally for Equality breakdown same day	Signature: <i>(Signature)</i>	Signature: <i>(Signature) 10/30/09</i>
PEDESTRIAN ACTIVITIES DISTRICT (P.A.D.)		
Action: <input type="checkbox"/> Approved <input type="checkbox"/> Approved w/Conditions <input type="checkbox"/> Denied		
Signature: _____ Date: _____		

Permit Taken By: Ldobson	Date Applied For: 10/28/2009	Zoning Approval
-----------------------------	---------------------------------	------------------------

<p>1. This permit application does not preclude the Applicant(s) from meeting applicable State and Federal Rules.</p> <p>2. Building permits do not include plumbing, septic or electrical work.</p> <p>3. Building permits are void if work is not started within six (6) months of the date of issuance. False information may invalidate a building permit and stop all work..</p>	<p>Special Zone or Reviews</p> <input type="checkbox"/> Shoreland <input type="checkbox"/> Wetland <input type="checkbox"/> Flood Zone <input type="checkbox"/> Subdivision <input type="checkbox"/> Site Plan Maj <input type="checkbox"/> Minor <input type="checkbox"/> MM <input type="checkbox"/> Date: <i>(Signature)</i>	<p>Zoning Appeal</p> <input type="checkbox"/> Variance <input type="checkbox"/> Miscellaneous <input type="checkbox"/> Conditional Use <input type="checkbox"/> Interpretation <input type="checkbox"/> Approved <input type="checkbox"/> Denied Date: _____	<p>Historic Preservation</p> <input type="checkbox"/> Not in District or Landmark <input type="checkbox"/> Does Not Require Review <input type="checkbox"/> Requires Review <input type="checkbox"/> Approved <input type="checkbox"/> Approved w/Conditions <input type="checkbox"/> Denied Date: _____
---	--	---	---

CERTIFICATION

I hereby certify that I am the owner of record of the named property, or that the proposed work is authorized by the owner of record and that I have been authorized by the owner to make this application as his authorized agent and I agree to conform to all applicable laws of this jurisdiction. In addition, if a permit for work described in the application is issued, I certify that the code official's authorized representative shall have the authority to enter all areas covered by such permit at any reasonable hour to enforce the provision of the code(s) applicable to such permit.

PERMIT ISSUED

SIGNATURE OF APPLICANT	ADDRESS	DATE OCT 29 2009	PHONE
RESPONSIBLE PERSON IN CHARGE OF WORK, TITLE		DATE	PHONE City of Portland

City of Portland, Maine - Building or Use Permit

389 Congress Street, 04101 Tel: (207) 874-8703, Fax: (207) 874-8716

Permit No: 09-1209	Date Applied For: 10/28/2009	CBL: 027 G001001
------------------------------	--	----------------------------

Location of Construction: 456 CONGRESS ST	Owner Name: CITY OF PORTLAND	Owner Address: 389 CONGRESS ST	Phone:
Business Name:	Contractor Name: Rally for Equality	Contractor Address:	Phone:
Lessee/Buyer's Name	Phone:	Permit Type: Tents	

Proposed Use: Monument Square - Stage Set-up 11/2/2009 Rally for Equality breakdown same day	Proposed Project Description: Stage Set-up 11/2/2009 Rally for Equality breakdown same day
--	--

Dept: Zoning **Status:** Approved **Reviewer:** Marge Schmuckal **Approval Date:** 10/29/2009
Note: **Ok to Issue:**

Dept: Building **Status:** Approved with Conditions **Reviewer:** Jeanine Bourke **Approval Date:** 11/30/2009
Note: **Ok to Issue:**

1) This permit DOES NOT authorize any construction activities. The tent/stage must be removed at the end of the event.

Dept: Fire **Status:** Approved **Reviewer:** Capt Keith Gautreau **Approval Date:** 10/29/2009
Note: **Ok to Issue:**

PERMIT ISSUED

OCT 29 2009

City of Portland



Tent/Canopy or Temporary Event Staging Permit Application

If you or the property owner owes real estate or personal property taxes or user charges on any property within the City, payment arrangements must be made before permits of any kind are accepted.

Location/Address/Park of Installation: <u>Monument Square</u>		
Date of Set up/Event <u>11/2/09 Rally for Equality</u>		Date of Breakdown/ End of Event <u>11/2/09 2pm</u>
Tax Assessor's Chart, Block & Lot Chart# Block# Lot# <u>27 6 1</u>	Property Owner:	Telephone:
Lessee/Buyer's Name (If Applicable)	Applicant name, address & telephone: <u>Sam Parker</u> <u>550 Forest Ave</u> <u>239.7804</u> <u>Portland, ME 07101</u>	Fee: <u>\$30.00</u>

The permit fee and the following items must be completed and submitted along with this application in order to receive a permit.

RECEIVED

1. Certificate of Flammability
2. Letter of approval from property owner.
If the City is owner, attach a completed copy of Application to Use City Parks & Public Space from Parks & Recreation (756-8275).
3. Company name of installer (contact info).
4. Plot Plan showing the following:

OCT 28 2009

**Dept. of Building Inspections
City of Portland Maine**

Tent/Canopy or temporary event staging locations, including dimensions, exits and entrances of proposed and existing, parking and existing building locations. If this is temporary staging, you will need to include product information. (Applicant may call Parks & Recreation for maps of Portland's Parks @ 756-8275).

5. If the City is the property owner, Certificate of Insurance listing the City as additional insured. Minimum amount of coverage is \$400,000.00

Who should we contact when permit is ready: SAM PARKER
Address: 550 Forest Ave, Portland ME Telephone: 207 239.7804

Please submit all of the information outlined in the Tent/Canopy and Event Staging Permit Application as one package. Failure to do so will result in the automatic denial of your permit.

In order to be sure the City fully understands the full scope of the project, the Planning and Development Department may request additional information prior to the issuance of a permit. For further information visit us on-line at www.portlandmaine.gov, stop by the Building Inspections office, room 315 City Hall or call 874-8703.

I hereby certify that I am the Owner of record of the named property, or that the owner of record authorizes the proposed work and that I have been authorized by the owner to make this application as his/her authorized agent. I agree to conform to all applicable laws of this jurisdiction. In addition, if a permit for work described in this application is issued, I certify that the Code Official's authorized representative shall have the authority to enter all areas covered by this permit at any reasonable hour to enforce the provisions of the codes applicable to this permit.

Signature of applicant: <u>[Signature]</u>	Date: <u>10/27/09</u>
--	-----------------------

This is not a permit; you may not commence ANY work until the permit is issued.

MAN □ 18,400 sq Feet

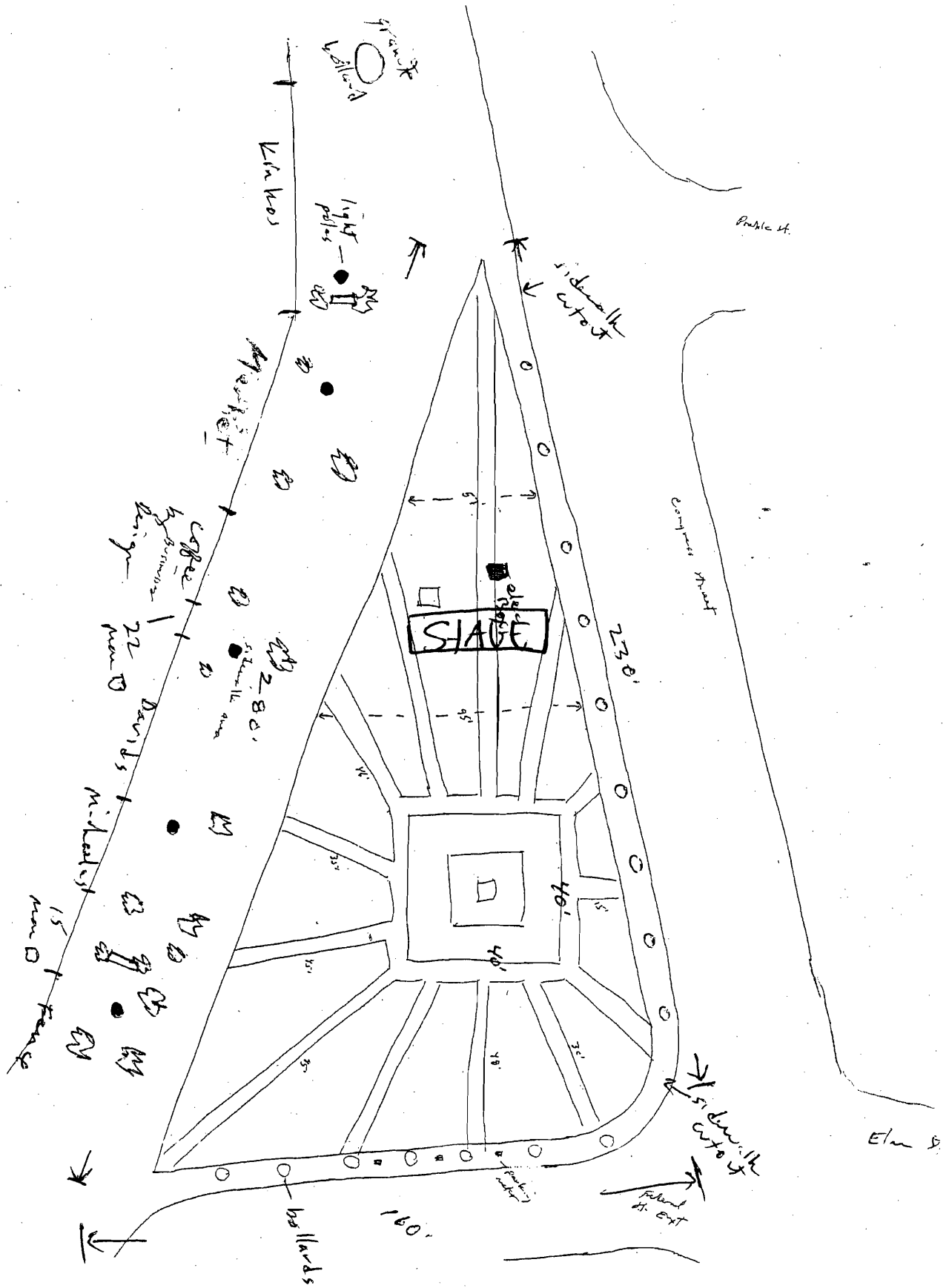

Also Atq 287-716-8275 on 211

Page 8274

ACORD™ CERTIFICATE OF LIABILITY INSURANCE

DATE (MM/DD/YYYY)
10/28/2009

PRODUCER (207)490-5330 FAX (207)490-5333
Sanford Insurance Agency
1048 Main Street
PO Box 111
Sanford, ME 04073-0111

THIS CERTIFICATE IS ISSUED AS A MATTER OF INFORMATION ONLY AND CONFERS NO RIGHTS UPON THE CERTIFICATE HOLDER. THIS CERTIFICATE DOES NOT AMEND, EXTEND OR ALTER THE COVERAGE AFFORDED BY THE POLICIES BELOW.

INSURED EQUALITY
P.O. BOX 1951
PORTLAND, ME 04104

INSURERS AFFORDING COVERAGE	NAIC #
INSURER A: Hanover Insurance Company	22292
INSURER B:	
INSURER C:	
INSURER D:	
INSURER E:	

COVERAGES

THE POLICIES OF INSURANCE LISTED BELOW HAVE BEEN ISSUED TO THE INSURED NAMED ABOVE FOR THE POLICY PERIOD INDICATED. NOTWITHSTANDING ANY REQUIREMENT, TERM OR CONDITION OF ANY CONTRACT OR OTHER DOCUMENT WITH RESPECT TO WHICH THIS CERTIFICATE MAY BE ISSUED OR MAY PERTAIN, THE INSURANCE AFFORDED BY THE POLICIES DESCRIBED HEREIN IS SUBJECT TO ALL THE TERMS, EXCLUSIONS AND CONDITIONS OF SUCH POLICIES. AGGREGATE LIMITS SHOWN MAY HAVE BEEN REDUCED BY PAID CLAIMS.

INSR LTR	ADD'L INSRS	TYPE OF INSURANCE	POLICY NUMBER	POLICY EFFECTIVE DATE (MM/DD/YY)	POLICY EXPIRATION DATE (MM/DD/YY)	LIMITS
A		GENERAL LIABILITY <input checked="" type="checkbox"/> COMMERCIAL GENERAL LIABILITY <input checked="" type="checkbox"/> CLAIMS MADE <input type="checkbox"/> OCCUR GEN'L AGGREGATE LIMIT APPLIES PER: <input type="checkbox"/> POLICY <input type="checkbox"/> PRO-JECT <input type="checkbox"/> LOC	ZHP 5894000 10	07/17/2009	07/17/2010	EACH OCCURRENCE \$ 1,000,000 DAMAGE TO RENTED PREMISES (EA occurrence) \$ 50,000 MED EXP (Any one person) \$ 5,000 PERSONAL & ADV INJURY \$ 1,000,000 GENERAL AGGREGATE \$ 2,000,000 PRODUCTS - COMP/OP AGG \$ 2,000,000
		AUTOMOBILE LIABILITY <input type="checkbox"/> ANY AUTO <input type="checkbox"/> ALL OWNED AUTOS <input type="checkbox"/> SCHEDULED AUTOS <input type="checkbox"/> HIRED AUTOS <input type="checkbox"/> NON-OWNED AUTOS				COMBINED SINGLE LIMIT (EA accident) \$ BODILY INJURY (Per person) \$ BODILY INJURY (Per accident) \$ PROPERTY DAMAGE (Per accident) \$
		GARAGE LIABILITY <input type="checkbox"/> ANY AUTO				AUTO ONLY - EA ACCIDENT \$ OTHER THAN EA ACC \$ AUTO ONLY: AGG \$
		EXCESS/UMBRELLA LIABILITY <input type="checkbox"/> OCCUR <input type="checkbox"/> CLAIMS MADE <input type="checkbox"/> DEDUCTIBLE RETENTION \$				EACH OCCURRENCE \$ AGGREGATE \$ \$ \$
		WORKERS COMPENSATION AND EMPLOYERS' LIABILITY ANY PROPRIETOR/PARTNER/EXECUTIVE OFFICER/MEMBER EXCLUDED? If yes, describe under SPECIAL PROVISIONS below OTHER				WC STATU-TORY LIMITS <input type="checkbox"/> OTH-ER <input type="checkbox"/> E.L. EACH ACCIDENT \$ E.L. DISEASE - EA EMPLOYEE \$ E.L. DISEASE - POLICY LIMIT \$

DESCRIPTION OF OPERATIONS / LOCATIONS / VEHICLES / EXCLUSIONS ADDED BY ENDORSEMENT / SPECIAL PROVISIONS

CERTIFICATE HOLDER

CITY OF PORTLAND
389 CONGRESS STREET
PORTLAND, ME 04101

CANCELLATION

SHOULD ANY OF THE ABOVE DESCRIBED POLICIES BE CANCELLED BEFORE THE EXPIRATION DATE THEREOF, THE ISSUING INSURER WILL ENDEAVOR TO MAIL 10 DAYS WRITTEN NOTICE TO THE CERTIFICATE HOLDER NAMED TO THE LEFT, BUT FAILURE TO MAIL SUCH NOTICE SHALL IMPOSE NO OBLIGATION OR LIABILITY OF ANY KIND UPON THE INSURER, ITS AGENTS OR REPRESENTATIVES.

AUTHORIZED REPRESENTATIVE

Daniel Fisher

VERSALITE® PORTABLE PLATFORM SYSTEM

SECTION 11065

Specification Sheet

PART I - GENERAL

1.01 SUMMARY

A. Section Includes:

1. Portable platform set. System shall be suitable for all types of performance events requiring portable platform stage. Stage shall be 14 x 8 x 24 consisting of ___ decks, ___ legs of ___ length.
2. Staging extension. System shall be suitable for use as a stage extension providing platform performance area at stage level and trimmed to fit stage lip. Stage extension shall be approximately ___ x ___ x ___ consisting of ___ decks, ___ legs of ___ length.
3. Orchestra pit filler. System shall be suitable for use as an orchestra pit filler for platform area at stage level, audience seating level, and/or floor level. Orchestra pit shall be approximately ___ x ___ x ___, consisting of ___ decks, ___ legs of ___ length.
4. Tiered seating. System shall be suitable for use as multilevel performer or audience seating. Tiered seating platforms shall be ___ x ___ with a ___ rise. Based upon ___ per chair, seating arrangement shall accommodate ___ number of seats.

1.02 REFERENCES

- A. American Plywood Association (APA) - Performance Standards and Policies for Structural Use Panels.
- B. Aluminum Association's Aluminum Standards and Data.

1.03 SYSTEM DESCRIPTION

- A. Design Requirements: Portable interlocking platform system with detachable and interchangeable legs to create a single or multiple-height platform area.
- B. Performance Requirements: Installed platform system at a height of 40" (101.6 cm) shall be capable of supporting a uniform vertical load of 200 pounds per square foot (976.5 kg/sq m) while simultaneously withstanding a 3% side load uniformly applied to the platform system along its longest

dimension. Under rated load of 200 psf (976.5 kg/sq m) unit deflection must not exceed .375" (.95 cm).

- C. **Guardrail Requirements:** Guardrail system shall be capable of withstanding a 200 lb (90.7 kg) point load applied laterally or vertically and a 50 lb per lineal foot (22.7 kg per .3 m) applied laterally or vertically. These loads shall not be superimposed. Testing performed by an independent testing agency with the guardrail attached to the specified staging platform is required to comply with this specification. Furthermore, if codes require it, the guardrails must be able to prevent a sphere measuring 4" from passing through anywhere in the rail. Load tests performed by an independent testing agency must show that the 4" sphere rail is capable of withstanding the same loads as noted above.

1.04 SUBMITTALS (REFER TO SECTION 01300)

- A. **Product Data:** Submit applicable documentation showing compliance with reference standards, current performance data, and application recommendations and product limitations.
- B. **Shop Drawings:** Submit assembly and installation drawings showing product components in assembly with adjacent materials and products.
- C. **Contract Closeout Submittals (refer also to Section 01700):**
 - 1. Operation and Maintenance Data.
 - 2. Warranty.
- D. **Test Data:** Where required submit test data from independent testing agencies demonstrating compliance with structural or performance standards.

1.05 QUALITY ASSURANCE

- A. **Versalite® Portable Platform system** shall be supplied by Wenger Corporation, 555 Park Drive, Owatonna, MN 55060, USA.
- B. **Design and Fabrication Experience Levels:** The manufacturer shall have designed, fabricated and installed not less than five staging projects of a comparable size to this project within the last 12 months and have not less than 10 years experience in manufacturing portable staging platforms.

1.06 PROJECT CONDITIONS

- A. **Field Measurements:** Obtain field measurements from Contractor or by job site visit and indicate on shop drawings.

1.07 WARRANTY

- A. Provide written warranty that products found to be not in accordance with the requirements of the Contract Documents within a period of five years after date of delivery shall be corrected promptly after receipt of written notice from owner.

PART 2 - PRODUCTS

2.01 ACCEPTABLE MANUFACTURERS

- A. WENGER CORPORATION, 555 Park Drive, Owatonna, MN 55060, (Toll Free 800/733-0393 or 800/326-8373) (call collect 507/455-4100) (Telex 263 228 WNGR UR) (FAX 507/455-1011).
- B. Manufacturers offering substitute products must obtain approval 10 days prior to bid opening.
 - 1. Request for prior approval or offer of voluntary alternate must include test reports signed by registered engineer to indicate manufacturer's capability of meeting performance requirements as set forth in Section 1.03, paragraph B of this specification with production run components.

2.02 STANDARD MANUFACTURED COMPONENTS

- A. Decks:
 - 1. Each deck shall be 3/4" (1.9 cm) overall comprised of Group I Douglas fir veneer plywood. Finish surfaces available shall be:
 - a. Black thermally fused overlay embossed with raised, textured circles. Backer material shall be thermally fused HDO overlay.
 - b. 1/8" (0.32 cm) tempered hardboard outer plies with a natural, mill finish.
 - c. Manufacturer's standard grey carpet applied to 5/8" plywood.
 - d. 5/8" plywood ready to receive carpet or other finished surface measuring at least 1/8" thick.

B. Frame:

1. Frame shall be constructed of 6063 structural aluminum with a natural finish. The extrusion shall be a box design for maximum strength and rigidity, with special grooves to protect the top surface edge, connect adjacent platforms, and to attach all accessories. The overall thickness of the frame shall be 3" (7.6 cm).

C. Single Height Legs:

1. Deck units shall be provided with six leg sockets to accept the detachable legs.
2. Leg sockets shall be designed with a single action, friction lever for locking legs into the sockets. Leg sockets shall be permanently attached to the platform frames.
3. The legs shall be fabricated from structural aluminum 2" (5 cm) square tubes in lengths to provide platform heights.
4. Each leg shall be provided with a plastic cap to protect existing flooring. Optional legs are available which shall be equipped with a screw-type adjustable foot to allow for fine adjustments.
5. The legs shall be a natural aluminum finish.

D. Telescoping Legs:

1. Adjustable height leg assembly with 4" (10 cm) height increments shall be comprised of an outer tube, a telescoping inner tube, a major adjustment pin, and a round foot assembly with threaded adjustment to allow infinite height options through the entire advertised range (16" (40.6 cm) through 28" (71.1 cm), 24" (61 cm) through 40" (101.6 cm), or custom heights). The outer tube shall be 1.97" (5 cm) square, .098" (.25 cm) wall, tempered aluminum with integral nylon bearing for smooth operation and minimum side play; the inner tube shall be 1.50" (3.8 cm) round, .125" (.32 cm) wall, tempered aluminum; major adjustment pin shall be .50" (1.27 cm) diameter plated steel with pull ring and spring-ball detent for security; round foot assembly shall have resilient rubber pad with up to 4" (10 cm) of fine leveling adjustment.

E. Unit-to-Unit:

1. Unit-to-Unit connectors shall be provided in the quantity necessary for proper function of the complete stage system.

2. Stage units shall be capable of being connected to each other on any side or end to allow for unlimited stage assembly configurations through the use of the unit-to-unit connectors. Connectors shall be designed to be inserted into the special grooves and to be located at any position at the end of any frame rail on the stage unit.

2.03 ACCESSORIES

A. Ten-Unit Versalite® Storage/Transport Truck:

1. Each ten-unit transport cart shall be capable of holding up to ten platforms in a horizontal position. A push handle shall be provided with each set of transport carts.
2. Each ten-unit transport cart set shall have four ball bearing casters with 8" (20 cm) wheels, each rated at 900 pounds (408 kg). Two casters shall be swivel and two shall be rigid.
3. Ten-unit transport cart shall be designed to attach to the 4' (1.2 m) or 3' (.91 m) end of a rectangular stage platform. Additional platforms are stacked on top up to a maximum of ten platforms.
4. Floor area when transporting or storing 4' (1.2 m) x 8' (2.4 m) units shall be 49-1/2" (1.3 m) x 98-1/2" (2.5 m).

B. Eight-Unit Versalite® Storage/Transport Truck:

1. Each eight-unit transport cart shall be capable of holding up to eight platforms in a vertical position.
2. Each eight-unit transport cart shall have four ball bearing casters with 8" (20 cm) wheels, each rated at 900 lbs. (408 kg). Two casters shall be swivel and two shall be rigid.
3. Eight-unit transport cart will be capable of folding for compact storage when not in use. Dimensions for storage shall be 43-1/2" (1.1 m) wide x 40-1/2" (1 m) long x 18-1/2" (47 cm) high.
4. Dimensions when transporting 4' x 8' (1.2 m x 2.4 m) platforms is 30" (76 cm) wide x 96" (2.4 m) long x 62-1/2" (1.6 m) high.

C. Stairway System:

1. Stairways shall be furnished to provide easy access to stage.

2. Stairways shall have 2, 3, or 4 steps. The 2-step stairway shall adjust for 16" (40.6 cm) or 24" (60.9) elevations, 3-step adjusts for 24" (60.9 cm) or 32" (81.2 cm) elevations, and 4-step shall adjust for 32" (81.2 cm) and 40" (101.6) stage elevations.
3. Each stairway unit shall be provided with two handrails. The handrails and side frames are of one construction. This framework is constructed of 1" (2.54 cm) square steel tubing with a black baked powder paint.
4. Each step shall be 11" (27.9 cm) deep and 36" (99 cm) wide with 8" (20.3 cm) height increments. The steps are constructed from 1/2" (1.27 cm) thick exterior grade hardboard with a non-slip tread. Each step shall be painted black with a white stripe at front edge for safety. The step support frame shall be 1/8" (.32 cm) x 1 1/4" (3.2) steel angle weldment, bolted to side frames.
5. Stairways shall be provided with 1" (2.54 cm) wide x 3" (7.6 cm) diameter, non-marking wheels for ease of transport and positioning for engagement to a stage unit. Stair legs have non-marking glides for protection.
6. Each stairway unit shall be equipped with a slide lock hook tube, with push button release that adjusts engagement hook attachment to various stage heights. Each unit attached securely to the stage platform.
7. Overview:

	<u>3-Step</u>	
Overall Width	39"	(99 cm)
Overall Depth	34-1/2"	(88 cm)
Overall Height	57"	(145 cm)
	<u>4-Step</u>	
Heights	32" & 40"	(81 cm & 102 cm)
Overall Width	39"	(99 cm)
Overall Depth	45"	(114 cm)
Overall Height	69"	(175 cm)

D. Guardrail:

1. Guardrails shall conform to the loading requirements set forth in 1.03C. Failure to provide independent test reports upon request shall be considered not in compliance with this specification.
2. The guardrail shall clamp to the platform. Guardrail systems that require bolting to the platform shall not be acceptable.

3. Guardrails shall incorporate two cross members, one 42" above the platform surface and the other 26" above the platform surface. Cross members shall be constructed of not higher than 16 gauge square steel tubing with an outside diameter of 1-1/4".
 4. A chair stop located 1-5/8" above the platform surface shall be an integral component of the guardrail system.
 5. Guardrail uprights shall be constructed of not higher than 14 gauge square steel tubing with an outside dimension of 1-1/2".
 6. A cart shall be provided to store and transport the guardrail system.
- E. Stage Drapes:
1. Drapes shall be made of 100% retardant polyester woven fabric.
 2. Drape material shall be black unless otherwise requested.
 3. Drapes shall utilize a hook and loop fastening system to attach to the platform edge.
- F. Backdrop:
1. Backdrop drapery shall be 8' above the platform surface.
 2. Backdrop drapery shall be available in a choice of standard colors and be attached to the backdrop frame with hook and loop tape.
 3. Backdrop frame shall attach to guardrails for maximum security. Self-standing backdrop frames that do not require the use of guardrails shall not be considered acceptable.

PART 3 - EXECUTION *(Edit the following where required for project scope).*

3.01 INSTALLATION

- A. Install per manufacturer's recommended installation.

3.02 CLEANING

- A. Manufacturer's appointed installer shall clean stage deck surfaces upon installation.
- B. Manufacturer's installer shall remove all packing materials and construction debris from site.

3.03 DEMONSTRATION

- A. At installation completion, manufacturer's installer shall demonstrate to Owner personnel the use of the staging system including set-up, take-down, and storage procedures.]

3.04 SCHEDULES

****CONTACT WENGER FOR ASSISTANCE IN PREPARING DRAWINGS AND SCHEDULES FOR THIS PRODUCT. ****

END OF SECTION