

- TECHNICAL NOTES:**
- LOCATE POWER JACKS FOR POS SYSTEM BENEATH WORKTOP, BEHIND BAR TOP
 - REFER TO TECH NOTE IN THIS LOCATION ON SHEET EY102A FOR WALL BOX INFORMATION
 - EXISTING DEVICES ON EXISTING SURFACES SHALL REMAIN UNLESS NOTED OTHERWISE
 - HVAC CONTROL POWER. LOCATE WITHIN JUNCTION BOX AT CEILING. COORDINATE WITH DIV. 23 CONTRACTOR FOR EXACT LOCATION.
 - CIRCUIT FOR DOOR HARDWARE POWER SUPPLY. LOCATE ABOVE ACCESSIBLE CEILING. COORDINATE EXACT LOCATION IN FIELD WITH SECURITY VENDOR.
 - COORDINATE FIELD CONNECTIONS TO EVAPORATORS IN FIELD WITH EQUIPMENT AND FOOD SERVICE VENDOR.

REV.	DESCRIPTION	DATE
0	ISSUED FOR BID	06 JUNE 2016

WBRC
ARCHITECTS ENGINEERS
WWW.WBRCAE.COM
BANGOR, MAINE 207-947-4511
PORTLAND, MAINE 207-428-4511
SARASOTA, FLORIDA 941-556-0757

ASYLUM

FIRST FLOOR POWER PLAN - SEGMENT A

SHEET TITLE:

WBRC CAD FILE: C:\Users\jlaplant\Documents\407110 - ASYLUM DANCE CLUB - ELEC. jlaplant.rvt

PROJECT No: 4071.10

SCALE: 1/4" = 1'-0"

PROJECT MANAGER: JRB

DRAWN BY: KRM

CHECKED BY: SJL

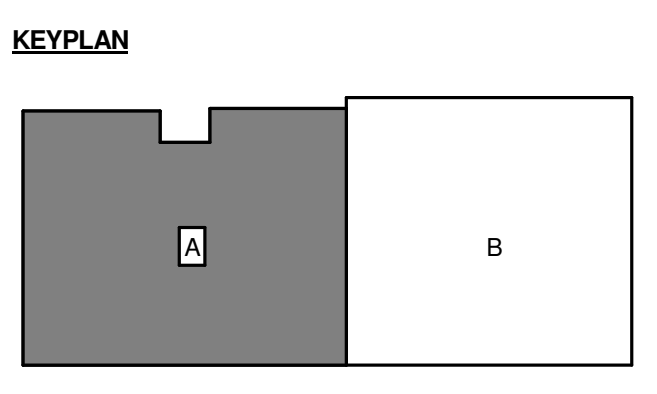

A1 FIRST FLOOR POWER PLAN - SEGMENT A
1/4" = 1'-0"