

- TECHNICAL NOTES:**
- LIGHTING CONTROL SYSTEM TOUCHSCREEN - PROVIDE CAT. 5 TO DMX CONTROLLER IN ELECT. 009. REFER TO DETAIL A7/E-502 FOR LIGHTING CONTROL SYSTEM RISER.
 - BAR COUNTER WITH INTEGRATED RGB LED STRIP LIGHT - FIXTURE, ASSOCIATED INTERFACE AND POWER SUPPLY SHALL BE BY DIV. 6. ALL WIRING ASSOCIATED WITH SYSTEM CONNECTION TO LIGHTING CONTROL SYSTEM.
 - EMERGENCY LIGHTING UL924 SWITCHING RELAY - RELAY SHALL BE EQUAL TO LVS, CAT. NO. EPC-A-1/ REFER TO DETAIL A7/E-502 FOR ADDITIONAL WIRING INFORMATION.
 - OCCUPANCY SENSOR CONNECTED TO LIGHTING CONTROL SYSTEM. LOW VOLTAGE WIRING NOT SHOWN FOR CLARITY. REFER TO DETAIL A7/E-502 FOR ADDITIONAL CONNECTION INFORMATION.
 - INTERNALLY LIT DISPLAY CASE CONNECTION - DISPLAY CASE PROVIDED BY DIV. 10. ALL POWER AND CONTROLS CONNECTIONS BY DIV. 26.
 - DECORATIVE PANEL WITH INTEGRAL LED LIGHTING - PANEL, POWER SUPPLY AND ASSOCIATED CONTROLLER PROVIDED BY DIV. 06. ALL POWER AND CONTROLS CONNECTIONS BY DIV. 26.
 - FIXTURE SHALL BE RECESSED INTO SIFFIT WALL. REFER TO BUILDING SECTIONS FOR MORE INFORMATION.
 - JUNCTION BOX FOR WALK-IN LIGHTS - LIGHTS AND SWITCH PROVIDED BY FOOD SERVICE VENDOR. ALL WIRING ASSOCIATED WITH WALK-IN BY DIV. 26.
 - CANOPY RECESSED STRIP LIGHT TRANSFORMER - WALL MOUNT ABOVE ACCESSIBLE CEILING. TRANSFORMER SHALL BE CALL LIGHTING, CAT. NO. TRA150-120V-12V. LOW VOLTAGE WIRING TO TREADS SHALL BE CONCEALED WITHIN WALL.
 - JUNCTION BOX FOR INTERNALLY ILLUMINATED SIGNAGE MOUNTED ON SKYLIGHT WALL. COORDINATE EXACT LOCATION PRIOR TO ROUGH IN. SIGNAGE SHALL BE PROVIDED BY OWNERS VENDOR. ALL POWER AND CONTROLS CONNECTIONS BY DIV. 26.
 - LIGHTING CONTROL SYSTEM SWITCHING/DIMMING CONTROLLER - WALL MOUNT ABOVE ACCESSIBLE CEILING. REFER TO LIGHTING CONTROL SCHEDULES FOR MORE INFORMATION.
 - JUNCTION BOX FOR BUILDING SIGNAGE - MOUNT TO TOP OF CANOPY. SIGNAGE PROVIDED BY OWNERS VENDOR. POWER AND CONTROL CONNECTIONS BY DIV. 26.
 - CONTRACTOR TO FIELD LOCATE FIBER OPTIC CEILING ILLUMINATOR. RECONNECT ILLUMINATOR TO SWITCHING CONTROLLER S3, ZONE #2 SO THAT CEILING CAN BE TURNED ON/OFF VIA LIGHTING CONTROL SYSTEM.
 - LIGHTING CONTROL SYSTEM SWITCHING CONTROLLER - WALL MOUNT ABOVE ACCESSIBLE CEILING. REFER TO LIGHTING CONTROL SCHEDULES FOR MORE INFORMATION.
 - INTENT IS FOR FIXTURES TO BE SUSPENDED FROM SKYLIGHT WALLS.

REV.	DESCRIPTION	DATE
0	ISSUED FOR BID	06 JUNE 2016



WBRC
ARCHITECTS ENGINEERS
WWW.WBRCAE.COM
BANGOR, MAINE 207-947-4511
PORTLAND, MAINE 207-828-4511
SARASOTA, FLORIDA 941-556-0757

PROJECT:
ASYLUM

SHEET TITLE:
FIRST FLOOR LIGHTING PLAN - SEGMENT A

WBRC CAD FILE: C:\Users\laura.mahar\Documents\407110 - ASYLUM DANCE CLUB - ELEC. lura.mahar.rvt	GRAPHIC SCALE: 0" = 1"
PROJECT No: 4071.10	SHEET No:
SCALE: 1/4" = 1'-0"	EL102A
PROJECT MANAGER: JRB	CHECKED BY: LW
DRAWN BY: KRM	

A1 FIRST FLOOR LIGHTING PLAN - SEGMENT A
1/4" = 1'-0"

DUE TO LENGTH OF CANOPY, THIS FIXTURE RUN WILL BE COMPRISED OF (2) INDIVIDUAL RUNS. ENSURE SEEM BETWEEN RUNS IS SMOOTH

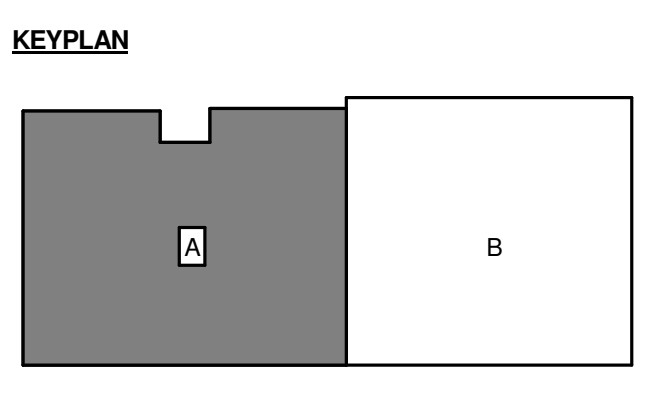

6/3/2016 3:16:25 PM C:\Users\laura.mahar\Documents\407110 - ASYLUM DANCE CLUB - ELEC. lura.mahar.rvt