

DISPLAY THIS CARD ON PRINCIPAL FRONTAGE OF WORK  
**CITY OF PORTLAND**

BUILDING INSPECTION

Please Read Application And Notes, If Any, Attached

**PERMIT**

Permit Number: 100182  
**PERMIT ISSUED**

This is to certify that 22 MONUMENT SQUARE L (Victory) \_\_\_\_\_

has permission to outside seating 4 tables 8 Chairs \_\_\_\_\_ JUL 16 2010

AT 22 MONUMENT SQ \_\_\_\_\_ City 027 F003001

provided that the person or persons, firm, or corporation accepting this permit shall comply with all of the provisions of the Statutes of Maine and of the Ordinances of the City of Portland regulating the construction, maintenance and use of buildings and structures, and of the application on file in this department.

Apply to Public Works for street line and grade if nature of work requires such information.

Notification of inspection must be given and written permission procured before this building or part thereof is lath or other closed-in. 24 HOUR NOTICE IS REQUIRED.

A certificate of occupancy must be procured by owner before this building or part thereof is occupied.

**OTHER REQUIRED APPROVALS**  
Fire Dept. \_\_\_\_\_  
Health Dept. \_\_\_\_\_  
Appeal Board \_\_\_\_\_  
Other \_\_\_\_\_  
Department Name

*[Handwritten Signature]*  
Director - Building & Inspection Services

**PENALTY FOR REMOVING THIS CARD**

**City of Portland, Maine - Building or Use Permit Application**

389 Congress Street, 04101 Tel: (207) 874-8703, Fax: (207) 874-8716

Permit No: 10-0782	Issue Date:	CBL: 027 F003001
-----------------------	-------------	---------------------

Location of Construction: 22 MONUMENT SQ	Owner Name: 22 MONUMENT SQUARE LLC	Owner Address: 22 MONUMENT SQ STE 600	Phone:
Business Name:	Contractor Name: Victory Cafe	Contractor Address:	Phone:
Lessee/Buyer's Name	Phone:	Permit Type: Outdoor Seating	Zone: B-3

Past Use: Commercial "Victory Cafe"	Proposed Use: Commercial "Victory Cafe" - outside seating 4 tables 8 Chairs	Permit Fee: \$430.00	Cost of Work: \$280.00	CEO District: 1
		FIRE DEPT: <input type="checkbox"/> Approved <input checked="" type="checkbox"/> Denied <i>N/A</i>	INSPECTION: Use Group: <i>Outdoor Seating</i> Type:	

Proposed Project Description: outside seating 4 tables 8 Chairs	Signature:	Signature:
	PEDESTRIAN ACTIVITIES DISTRICT (P.A.D.)	
	Action: <input type="checkbox"/> Approved <input type="checkbox"/> Approved w/Conditions <input checked="" type="checkbox"/> Denied	Date:

Permit Taken By: ldobson	Date Applied For: 07/01/2010	<b>Zoning Approval</b>
-----------------------------	---------------------------------	------------------------

<p>1. This permit application does not preclude the Applicant(s) from meeting applicable State and Federal Rules.</p> <p>2. Building permits do not include plumbing, septic or electrical work.</p> <p>3. Building permits are void if work is not started within six (6) months of the date of issuance. False information may invalidate a building permit and stop all work..</p>	<p>Special Zone or Reviews</p> <input type="checkbox"/> Shoreland <input type="checkbox"/> Wetland <input type="checkbox"/> Flood Zone <input type="checkbox"/> Subdivision <input type="checkbox"/> Site Plan <input type="checkbox"/> Major <input type="checkbox"/> Minor <input checked="" type="checkbox"/> MM	<p>Zoning Appeal</p> <input type="checkbox"/> Variance <input type="checkbox"/> Miscellaneous <input type="checkbox"/> Conditional Use <input type="checkbox"/> Interpretation <input type="checkbox"/> Approved <input type="checkbox"/> Denied	<p>Historic Preservation</p> <input type="checkbox"/> Not in District or Landmark <input type="checkbox"/> Does Not Require Review <input type="checkbox"/> Requires Review <input type="checkbox"/> Approved <input type="checkbox"/> Approved w/Conditions <input type="checkbox"/> Denied
	Date: <i>7/13/10</i>	Date:	Date:

**PERMIT ISSUED**

JUL 16 2010

City of Portland

**CERTIFICATION**

I hereby certify that I am the owner of record of the named property, or that the proposed work is authorized by the owner of record and that I have been authorized by the owner to make this application as his authorized agent and I agree to conform to all applicable laws of this jurisdiction. In addition, if a permit for work described in the application is issued, I certify that the code official's authorized representative shall have the authority to enter all areas covered by such permit at any reasonable hour to enforce the provision of the code(s) applicable to such permit.

SIGNATURE OF APPLICANT	ADDRESS	DATE	PHONE
RESPONSIBLE PERSON IN CHARGE OF WORK, TITLE		DATE	PHONE

**City of Portland, Maine - Building or Use Permit**

389 Congress Street, 04101 Tel: (207) 874-8703, Fax: (207) 874-8716

Permit No: 10-0782	Date Applied For: 07/01/2010	CBL: 027 F003001
-----------------------	---------------------------------	---------------------

Location of Construction: 22 MONUMENT SQ	Owner Name: 22 MONUMENT SQUARE LLC	Owner Address: 22 MONUMENT SQ STE 600	Phone:
Business Name:	Contractor Name: Victory Cafe	Contractor Address:	Phone:
Lessee/Buyer's Name	Phone:	Permit Type: Outdoor Seating	

Proposed Use: Commercial "Victory Cafe" - outside seating 4 tables 8 Chairs	Proposed Project Description: outside seating 4 tables 8 Chairs
--	--

**Dept:** Zoning      **Status:** Approved      **Reviewer:** Marge Schmuckal      **Approval Date:** 07/13/2010  
**Note:**      **Ok to Issue:**

**Dept:** Building      **Status:** Approved with Conditions      **Reviewer:** Tammy Munson      **Approval Date:** 07/16/2010  
**Note:**      **Ok to Issue:**

- 1) The outside dining permit is approved for the area delineated at the inspection and stated on the permit, and must be kept on site. THIS PERMIT MUST BE RENEWED ANNUALLY
- 2) This permit approves outside seating only. Any alcohol or entertainment in this space requires licensing approvals from the City Clerk.
- 3) The tables and chairs must not block any means of egress of any building, even during storage.

**Comments:**

7/13/2010-mes: Gave back to Lannie

**PERMIT ISSUED**

JUL 16 2010

City of Portland



# CITY OF PORTLAND, MAINE

Department of Building Inspections

## Original Receipt

7.1 20 10

Received from Victory Cafe

Location of Work 24 Monument Sq

Cost of Construction \$ \_\_\_\_\_ Building Fee: \_\_\_\_\_

Permit Fee \$ \_\_\_\_\_ Site Fee: \_\_\_\_\_

Certificate of Occupancy Fee: \_\_\_\_\_

Total: 81.50

Building (1L) \_\_\_\_\_  Plumbing (1S) \_\_\_\_\_  Electrical (1E) \_\_\_\_\_  Site Plan (1J) \_\_\_\_\_

Other \_\_\_\_\_

CBL: 27-F-3

Check #: 1537 Total Collected \$ 81.50

**No work is to be started until permit issued.  
Please keep original receipt for your records.**

Taken by: [Signature]

WHITE - Applicant's Copy  
YELLOW - Office Copy  
PINK - Permit Copy



27-F3  
100782

# Outdoor Dining Permit Application

If you or the property owner owes real estate or personal property taxes or user charges on any property within the City, payment arrangements must be made before permits of any kind are accepted.

<input checked="" type="checkbox"/> New Application for Outside Dining <input type="checkbox"/> Renewal Application for Outside Dining		
City Clerk signature for liquor license approval: _____ or Pending Council Date _____ Location/Address of Outdoor Seating: _____		
Total Square Footage of Proposed Seating Area <sup>1</sup> <u>100</u>		Square Footage of Lot _____
Tax Assessor's Chart, Block & Lot Chart# <u>27</u> Block# <u>F.</u> Lot# <u>3</u>	Phone#: <u>699-5577</u>	Owner: <u>Michael Royles</u>
Applicant *must be owner or Lessee Name: <u>M. Royles</u> Address: <u>24 Monument Sq.</u> City, State & Zip: <u>Portland Me 04101</u>	Lessee/Buyer's Name: (If Applicable) _____	Annual Fee: \$80 Total Sq. Ft. <u>100</u> Sq. Ft. Fee: \$ <u>200</u> Total Fee: \$ <u>280.00</u>
Current use: _____ Business name: <u>a Victory Cafe</u> Seating area dimensions: <u>10x10</u> How many chairs? <u>8</u> How many tables? <u>4</u> <input type="checkbox"/> Yes Alcohol is served. <input checked="" type="checkbox"/> No Alcohol being served. <u>AM 7-14-10 NO ALCOHOL</u>		
Who should we contact for the pre-inspection: <u>Michael Royles</u> Mailing address: <u>24 Monument Sq</u> Phone: <u>699-5577</u> <u>Portland Me 04101</u>		

Please submit all of the information outlined in the Outdoor Dining Application Checklist. Failure to do so will result in the automatic denial of your permit.

In order to be sure the City fully understands the full scope of the project, the Planning and Development Department may request additional information prior to the issuance of a permit. For further information visit us on-line at [www.portlandmaine.gov](http://www.portlandmaine.gov), stop by the Building Inspections office, room 315 City Hall or call 874-8703.

I hereby certify that I am the Owner of record of the named property, or that the owner of record authorizes the proposed work and that I have been authorized by the owner to make this application as his/her authorized agent. I agree to conform to all applicable laws of this jurisdiction. In addition, if a permit for work described in this application is issued, I certify that the Code Official's authorized representative shall have the authority to enter any areas covered by this permit at any reasonable hour to enforce the provisions of the codes applicable to this permit.

RECEIVED

Signature of Applicant: \_\_\_\_\_

JUN 30 2010

Date: 6-30-10

Dept. of Building Inspections  
City of Portland, Maine

<sup>1</sup> In no instance shall the total square footage of dining area equal more than 18% of Main Space, unless the applicant receives a waiver from the Director of Parks and Recreation or his or her designee. This is not a permit; you may not commence ANY work until the permit is issued.



# OUTDOOR DINING PERMIT CHECKLIST

Permits are required for expanding food service establishments to the outside on City Property. The annual fee is \$80.00 plus \$2.00 per square foot of dining area on streets, sidewalks or other public ways and \$80.00 plus \$6.00 per square foot of dining area in city parks. For purposes of fee calculation, the area abutting the buildings which border Monument Square and extending ten (10) feet from the facade of said buildings shall be considered a sidewalk. The ten (10) foot area shall be measured from that portion of the facade that protrudes furthest into the sidewalk. The area beyond the ten (10) foot sidewalk shall be considered park space.

Outdoor dining is permitted year round under the permit; however, furniture must be removed in inclement weather to allow for sidewalk snow removal. **The permit must be renewed each year.**

All of the following information is required and must be submitted. You will also be required to fill out an Outdoor Dining Permit Application.

### A plot plan is required and must include:

- A drawing of the lot, where the building sits on the lot along with the lot and building dimensions
  - The dimensional setback from the sidewalk to the building
  - The location of the street, and if it's a corner lot, the intersecting streets
  - The sidewalk along with its width and curbing location
  - The location of the table and chair placement, including dimensions
- (NOTE: there must be a minimum of four feet of open sidewalk from the outer boundary of the seating area to the curb, and a minimum of five feet on corners, and egress from the building must be maintained free of obstruction per the building code and NFPA Life Safety Code).

### Additional Requirements:

- The permit holder is required to produce, at the time of submission, and maintain public liability insurance coverage in an amount of not less than four



**CITY OF PORTLAND, MAINE**  
Department of Building Inspections

## Original Receipt

Received from 7.11.20/0

Location of Work Victory Cafe  
24 Monument

Cost of Construction \$ \_\_\_\_\_ Building Fee: \_\_\_\_\_

Permit Fee \$ \_\_\_\_\_ Site Fee: \_\_\_\_\_

Certificate of Occupancy Fee: \_\_\_\_\_ Total: 80

Building (IL) \_\_\_\_\_ Plumbing (15) \_\_\_\_\_ Electrical (12) \_\_\_\_\_ Site Plan (12) \_\_\_\_\_

Other Outside Seating

CBL: 27-1F-3

Check #: 1537 Total Collected \$ 80

**No work is to be started until permit issued.  
Please keep original receipt for your records.**

Taken by: S.P.

WHITE - Applicant's Copy  
YELLOW - Office Copy  
PINK - Permit Copy

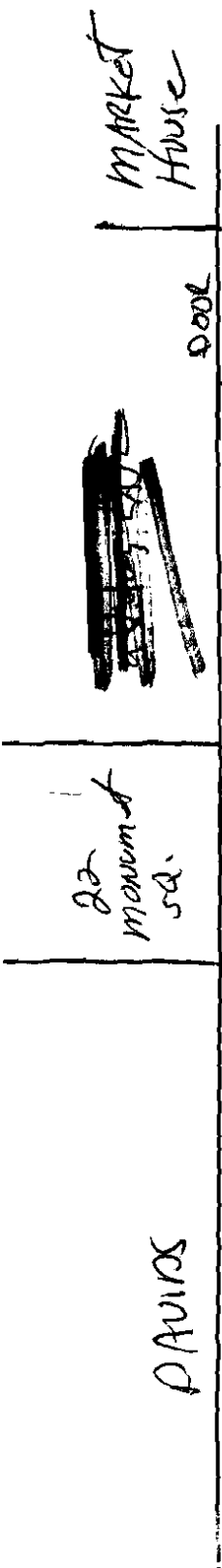

10' x 10'

286001 #  
 14 B

22  
 monum of  
 sd.

10' x 10' =  
 100 SFT  
 7/1/10  
 10'

**COPY**

1 Monum of SD

15 monum of SD

6.30-10

# ACORD™ CERTIFICATE OF LIABILITY INSURANCE

DATE (MM/DD/YYYY)  
06/30/2010

PRODUCER (207) 781-3519 FAX (207) 781-3907  
**United Insurance**  
 Bradish-Young Agency  
 202 U.S. Route One  
 Falmouth, ME 04105

THIS CERTIFICATE IS ISSUED AS A MATTER OF INFORMATION ONLY AND CONFERS NO RIGHTS UPON THE CERTIFICATE HOLDER. THIS CERTIFICATE DOES NOT AMEND, EXTEND OR ALTER THE COVERAGE AFFORDED BY THE POLICIES BELOW.

INSURED **MICHAEL ROYLOS**  
**IRIA: a Victory Cafe Featuring Spartan Grill**  
 24 Monument Square  
 PORTLAND, ME 04101

INSURERS AFFORDING COVERAGE		NAIC #
INSURER A:	<b>ME Insurance Company</b>	<b>15997</b>
INSURER B:		
INSURER C:		
INSURER D:		
INSURER E:		

## COVERAGES

THE POLICIES OF INSURANCE LISTED BELOW HAVE BEEN ISSUED TO THE INSURED NAMED ABOVE FOR THE POLICY PERIOD INDICATED. NOTWITHSTANDING ANY REQUIREMENT, TERM OR CONDITION OF ANY CONTRACT OR OTHER DOCUMENT WITH RESPECT TO WHICH THIS CERTIFICATE MAY BE ISSUED OR MAY PERTAIN, THE INSURANCE AFFORDED BY THE POLICIES DESCRIBED HEREIN IS SUBJECT TO ALL THE TERMS, EXCLUSIONS AND CONDITIONS OF SUCH POLICIES. AGGREGATE LIMITS SHOWN MAY HAVE BEEN REDUCED BY PAID CLAIMS.

INSR ADD'L LTR	INSRC	TYPE OF INSURANCE	POLICY NUMBER	POLICY EFFECTIVE DATE (MM/DD/YY)	POLICY EXPIRATION DATE (MM/DD/YY)	LIMITS
A		GENERAL LIABILITY	<b>MP 0432725</b>	<b>03/10/2010</b>	<b>03/10/2011</b>	EACH OCCURRENCE \$ <b>1,000,000</b>
		<input checked="" type="checkbox"/> COMMERCIAL GENERAL LIABILITY <input type="checkbox"/> CLAIMS MADE <input checked="" type="checkbox"/> OCCUR GENL AGGREGATE LIMIT APPLIES PER: <input type="checkbox"/> POLICY <input type="checkbox"/> PROJECT <input type="checkbox"/> LOC				DAMAGE TO RENTED PREMISES (Ea occurrence) \$ <b>250,000</b> MED EXP (Any one person) \$ <b>5,000</b> PERSONAL & ADV INJURY \$ <b>1,000,000</b> GENERAL AGGREGATE \$ <b>2,000,000</b> PRODUCTS - COMP/OP AGG \$ <b>2,000,000</b>
		AUTOMOBILE LIABILITY				COMBINED SINGLE LIMIT (Ea accident) \$ BODILY INJURY (Per person) \$ BODILY INJURY (Per accident) \$ PROPERTY DAMAGE (Per accident) \$
		GARAGE LIABILITY				AUTO ONLY - EA ACCIDENT \$ OTHER THAN AUTO ONLY: EA ACC \$ AGG \$
		EXCESS/UMBRELLA LIABILITY				EACH OCCURRENCE \$ AGGREGATE \$ \$ \$ \$
		WORKERS COMPENSATION AND EMPLOYERS' LIABILITY				WC STATUTORY LIMITS OTH-ER E.L. EACH ACCIDENT \$ E.L. DISEASE - EA EMPLOYEE \$ E.L. DISEASE - POLICY LIMIT \$
		ANY PROPRIETOR/PARTNER/EXECUTIVE OFFICER/MEMBER EXCLUDED? If yes, describe under SPECIAL PROVISIONS below				
		OTHER				

DESCRIPTION OF OPERATIONS / LOCATIONS / VEHICLES / EXCLUSIONS ADDED BY ENDORSEMENT / SPECIAL PROVISIONS  
**Certificate is named additional insured.**

\*Cancellation notice will be 10 days if for non-payment of premium

## CERTIFICATE HOLDER

**City of Portland**  
 388 Congress Street  
 Portland, ME 04101

## CANCELLATION

SHOULD ANY OF THE ABOVE DESCRIBED POLICIES BE CANCELLED BEFORE THE EXPIRATION DATE THEREOF, THE ISSUING INSURER WILL ENDEAVOR TO MAIL **30\*** DAYS WRITTEN NOTICE TO THE CERTIFICATE HOLDER NAMED TO THE LEFT, BUT FAILURE TO MAIL SUCH NOTICE SHALL IMPOSE NO OBLIGATION OR LIABILITY OF ANY KIND UPON THE INSURER, ITS AGENTS OR REPRESENTATIVES.

AUTHORIZED REPRESENTATIVE

**Jodi Turner/JLT**

*Jodi Turner*



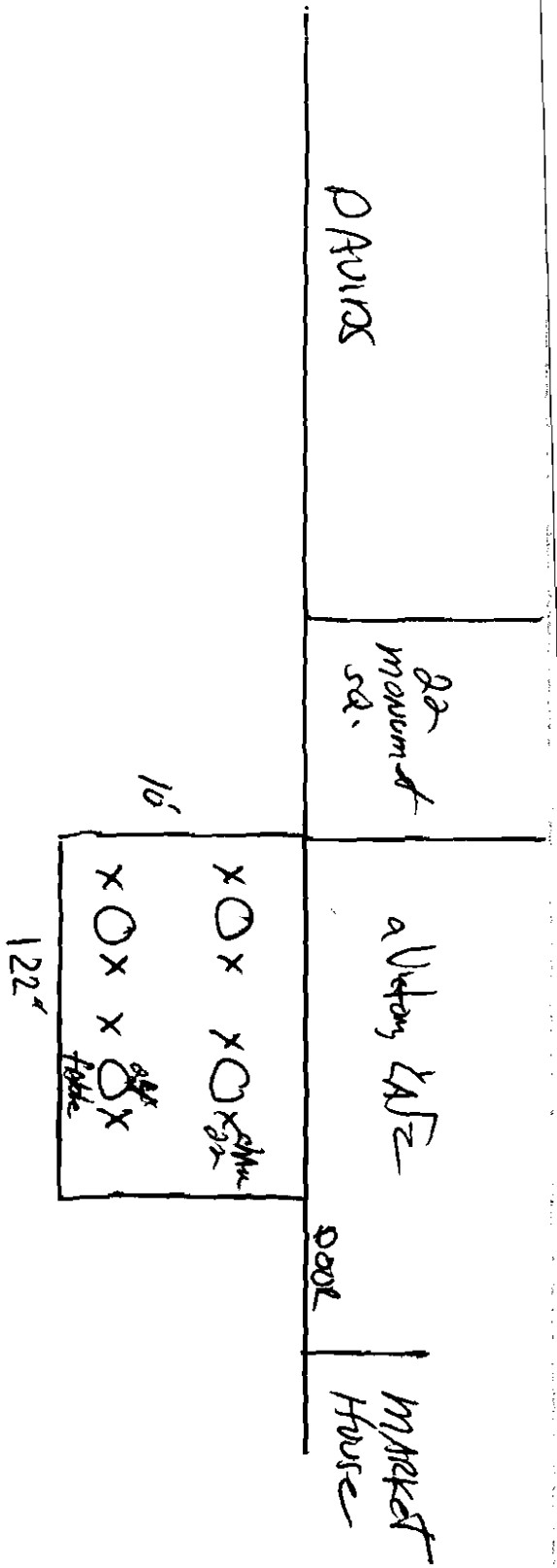

MANUFACT SP

CONGRESS ST

6.30-10