



INNOVATIONS FOR LIVING™

# QuietZone® Acoustic Floor Mat

wood is dry and the moisture content has stabilized. This can be done by standing the panels on edge for several days in the rooms where they will be installed. It is recommended that all of the plywood raft pieces needed are pre-cut prior to assembly.

- Place one layer of plywood directly on top of the floor mat so the entire surface area is covered. Space the plywood panels so that there is a 1/8" gap between adjacent pieces of plywood and from the walls.
- Apply an even coat of standard wood glue to the top surface of bottom layer of plywood, and then place a second layer of plywood onto glued surface. The second layer of plywood should be oriented perpendicular to the bottom layer with the joints staggered. The finished surface of the plywood forms the top surface of the raft. Space the plywood panels so that there is a 1/8" gap between adjacent pieces of plywood and from wall.
- Fasten the two layers of plywood together using 3/4" long wood screws spaced 12" apart across entire surface area, including the joints and perimeter. Use 1" long screws when 1/2" plywood is being installed.

**NOTE:** Since wood is a natural material, it is susceptible to dimensional change. Providing a gap around all edges of the plywood panels should accommodate any dimensional change. However, in the event that the

## Installation Instructions

plywood raft does not lay evenly over the QuietZone acoustic floor mat, one may selectively screw down the plywood raft (up to 16" oc) without significantly compromising the acoustic performance of the system. Care should be taken to use wood screws that completely penetrate the sub-floor without entering into the floor joists.

### 3. Install Finished Flooring

- Install the finished flooring as recommended by the manufacturer.
- Ensure that the finished flooring is installed close enough to the wall so that the finishing trim will conceal the QuietZone acoustic floor mat.

### 4. Clean-up

- Remove tape from wall.
- Trim away excess QuietZone acoustic floor mat so that the mat is flush with the finished floor.
- Add baseboard of finishing trim as required.

### Installation with Gypsum Concrete Raft

Note: for use with

- hardwood
- vinyl
- ceramic tile
- wood laminate
- carpet and padding

#### 1. Install Floor Mat

- Roll out QuietZone acoustic floor mat directly on top of the

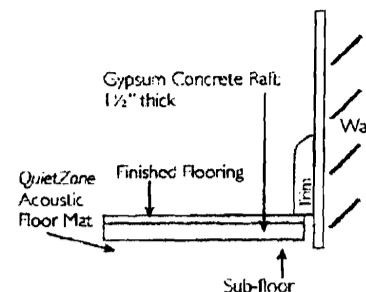

subfloor so that the entire floor surface area is covered and floor mat just touches the wall.

- Butt adjoining edges of floor mat against each other and tape all seams with standard (2" wide) building tape.
- Cut a strip of QuietZone acoustic floor mat 3-4" wide and place strip along wall and tape edge to the floor mat on the subfloor.

**NOTE:** Floor mat strip should form a sealed, right angle with the floor mat on the subfloor.

- Tape the top of the perimeter strip to the wall so that the gypsum concrete can fill the entire floor surface area.

- Ensure the QuietZone acoustic floor mat is free of any tears or punctures.

#### 2. Install Gypsum Concrete Raft on Top of Floor Mat

- Pour the lightweight gypsum concrete material per manufacturer's instructions on top of the QuietZone acoustic floor mat so there is a layer of gypsum concrete at least 1 1/2" thick covering the entire floor surface area.



## Installation Instructions

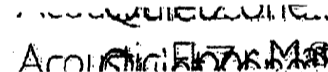



# QuietZone® Acoustic Floor Mat

## Installation Instructions

Figure 1

Wood Frame Construction

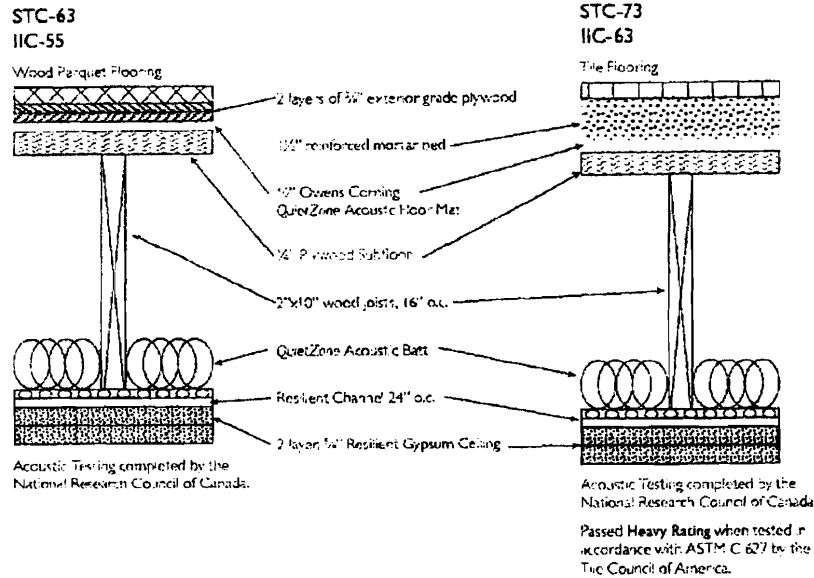

### 3. Install Finished Flooring

- After the raft has dried sufficiently according to gypsum concrete manufacturer's instructions, install the finished flooring as recommended by the flooring manufacturer.

- Ensure that the finished flooring is installed close enough to the wall so that the finishing trim will conceal the QuietZone acoustic floor mat.

### 4. Clean-up

- Remove tape from wall.

- Trim away excess QuietZone acoustic floor mat so that the mat is flush with the finished floor.

- Add baseboard or finishing trim as required.

Figure 2

Concrete Slab Construction

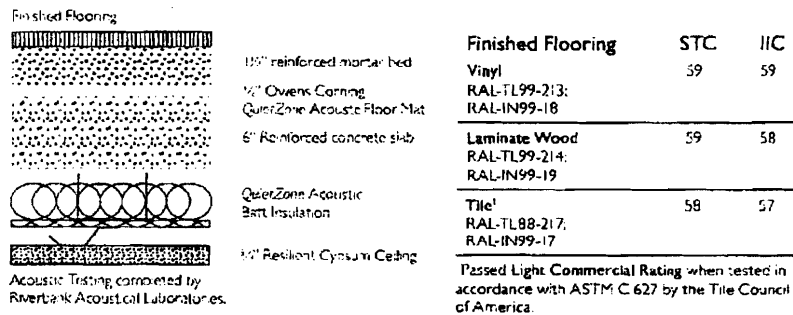

**CAUTION: COMBUSTIBLE.**  
This product should not be exposed to open flames or other possible ignition sources. It may contain flammable vapors and should be stored in well ventilated areas. Further processing of the product may result in the localized release of flammable vapors. This product should be installed in such a way that it is separated from the building interior by a thermal barrier. Typical thermal barriers are a minimum of 5/8" plywood or 1" thick concrete. Please refer to the Material Safety Data Sheet for more information.



INNOVATIONS FOR LIVING™

## QuietZone® Acoustic Floor Mat

### Installation Instructions

#### Design Considerations

QuietZone acoustic floor mat is to be placed between the subfloor and plywood or gypsum concrete overlayment to create an isolation layer for sound vibrations and impact noises such as foot traffic. The plywood or gypsum concrete overlayment, once installed, "floats" on top of the floor mat providing a rigid surface for the finished flooring.

#### Fire Safety & Applicable Standards

QuietZone acoustic floor mat has been tested in accordance with ASTM E-84 with resulting flame spread/smoke developed indices of 20/50. Thermal barrier and structural requirements are met by using 1½" of gypsum concrete or 2 layers of ¾" exterior grade plywood.

Always check with your local building code official regarding local requirements affecting installation of all building components.

For more information, call 1-800-GET-PINK or visit our Web site at:  
[www.quietzone.com](http://www.quietzone.com)

#### Technical Data

Property	Test Method
Material	Polyethylene foam with an anti-static agent
Package Form	Roll
Length	35 ft
Width	4 ft
Area	140 Sq. Ft.
Thickness	¾ in. (9.5mm)
Roll Diameter	14 in
Roll Weight	10.25 lbs.

#### Specification

Sound rated floor material shall be ¾" (9.5mm) thick closed cell polyethylene foam with an anti-static agent.

The isolation system shall have a minimum IIC rating of \_\_\_\_\_, and an STC rating of \_\_\_\_\_ when tested in accordance with ASTM E-497 and ASTM E-90 at an accredited Acoustical Laboratory.

The sound rated material shall be QuietZone acoustic floor mat as supplied by Owens Corning.



INNOVATIONS FOR LIVING™

**OWENS CORNING INSULATING SYSTEMS, LLC**  
ONE OWENS CORNING PARKWAY  
TOLEDO, OHIO, USA 43659

1-800-GET-PINK™  
[www.owenscorning.com](http://www.owenscorning.com)

Pub. No. 102322-A. Printed in U.S.A. January 2007. THE PINK PANTHER™ & ©1964-2007 Metro-Goldwyn-Mayer Studios Inc. All Rights Reserved. The color PINK is a registered trademark of Owens Corning. ©2007 Owens Corning.





Strengthening a Remarkable City, Building a Community for Life • www.portlandmaine.gov

Director of Planning and Urban Development  
Penny St. Louis Littell

Inspection Services, Director  
Tammy M. Munson

April 16, 2009

DODGE ROBERT H & MARIANNE M  
27 MONUMENT SQ # 2  
PORTLAND , ME 04101

CBL: 027 F002002  
Located at 27 MONUMENT SQ  
RE: THIRD (3) AND FOURTH (4<sup>TH</sup>) FLOOR RENOVATIONS

Certified Mail 70080500000145879734

### STOP WORK ORDER

Dear Robert & Marianne Dodge:

An evaluation of the above-referenced property on 04/16/2009 revealed that building construction was being conducted without benefit of a valid building permit as required by §105.1 of the 2003 International Building Code, of the City of Portland.

Appropriate permitting has not been issued for the property listed above; therefore all construction activity at that property must stop immediately. This is a Stop Work Order pursuant to § 114. of 2003 International Building Code of the City of Portland.

You may resume construction activity only after issuance of the appropriate building permit and the subsequent lifting of this order. Building Permit Applications are available in this office, Room 315 at Portland City Hall, from 8:00 a.m. to 4:00 p.m. weekdays except holidays.

Failure to comply will result in this office referring the matter to the City of Portland Corporation Counsel for legal action and possible civil penalties, as provided for in § 1-15 of the Code and in Title 30-A of M.R.S.A. § 4452. This constitutes an appealable decision pursuant to § 112 of the City of Portland Building Code.

If you wish to discuss this matter, or you have any questions, please feel free to contact me @ 207.874.8702.

Sincerely,

  
Jon Rioux,  
Code Enforcement Officer

MAY 13 2009

CC: Keith Gautreau, Captain

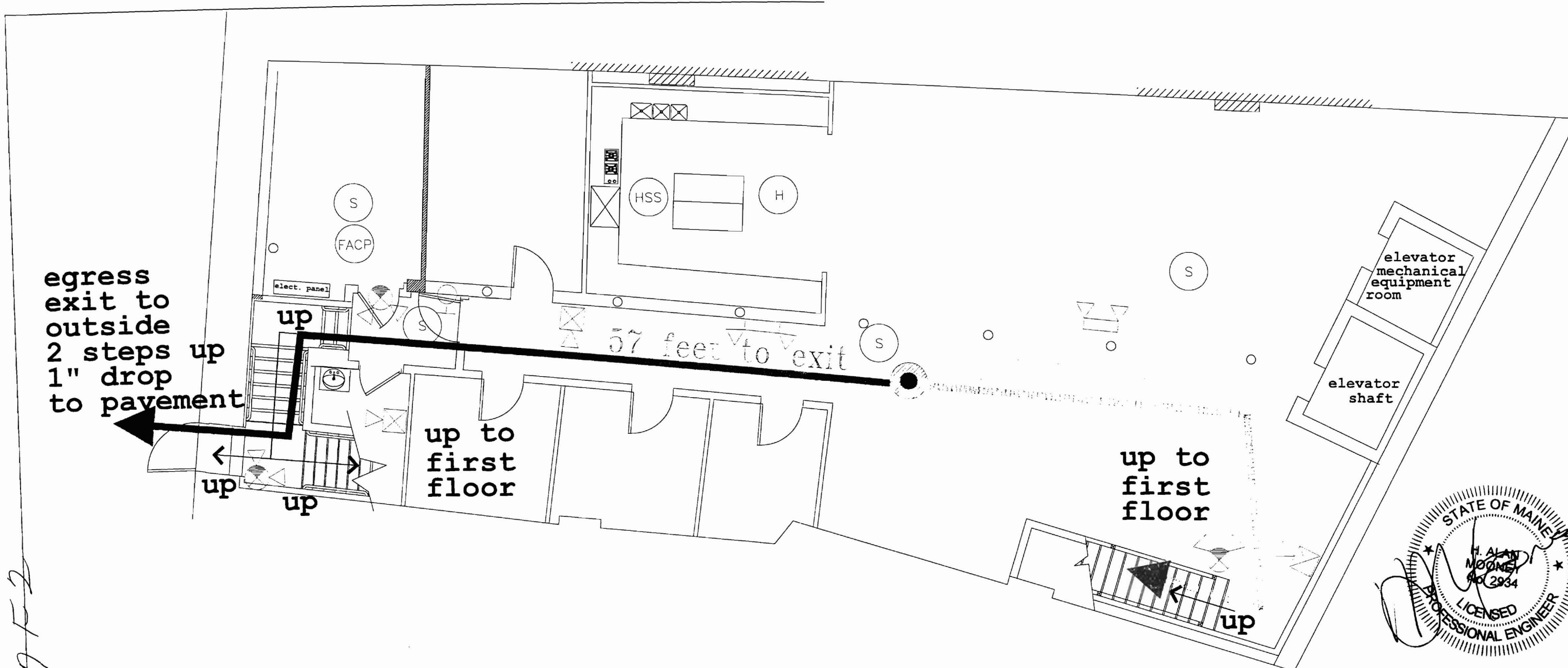

2972

- You Are Standing Here
- Primary Evacuation Route
- Secondary Evacuation Route
- Exits
- Emergency Lights

APR 10 2009

FIRE ALARM LEGEND

- SMOKE DETECTOR
- AIR HORN LIGHT
- MANUAL PULL
- HOOD SUPPRESSION SYSTEM
- DOOR HOLDER
- ELEVATOR SMOKE RECALL
- STROBE
- MOTION
- KEY PAD
- FIRE ALARM
- HEAT DETECTOR

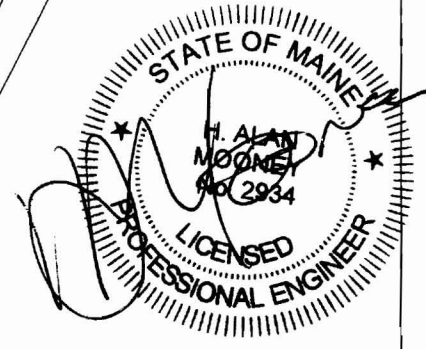

# BASEMENT PLAN

	CURRENT ISSUE STATUS: ISSUED FOR REVIEW 03-25-09	Emerson Clapp Building 28 Monument Square Portland, Maine Phase I Renovation	<b>CRITERIUM</b> <small>MECHANICAL ENGINEERS</small> 22 MONUMENT SQUARE TEL 207-775-1969 SUITE 300 800-922-1969 PORTLAND, ME 04101 FAX 207-775-4415	SHEET TITLE: BASEMENT FLOOR PLAN FIRE EXITS	SCALE: AS NOTED PROJECT MANAGER: HAM ENGINEER OF RECORD: HAM PROJECT No. -	DATE: 08-04-06 SHEET No. EG-1.1
--	---	---	---	---	---	---------------------------------------

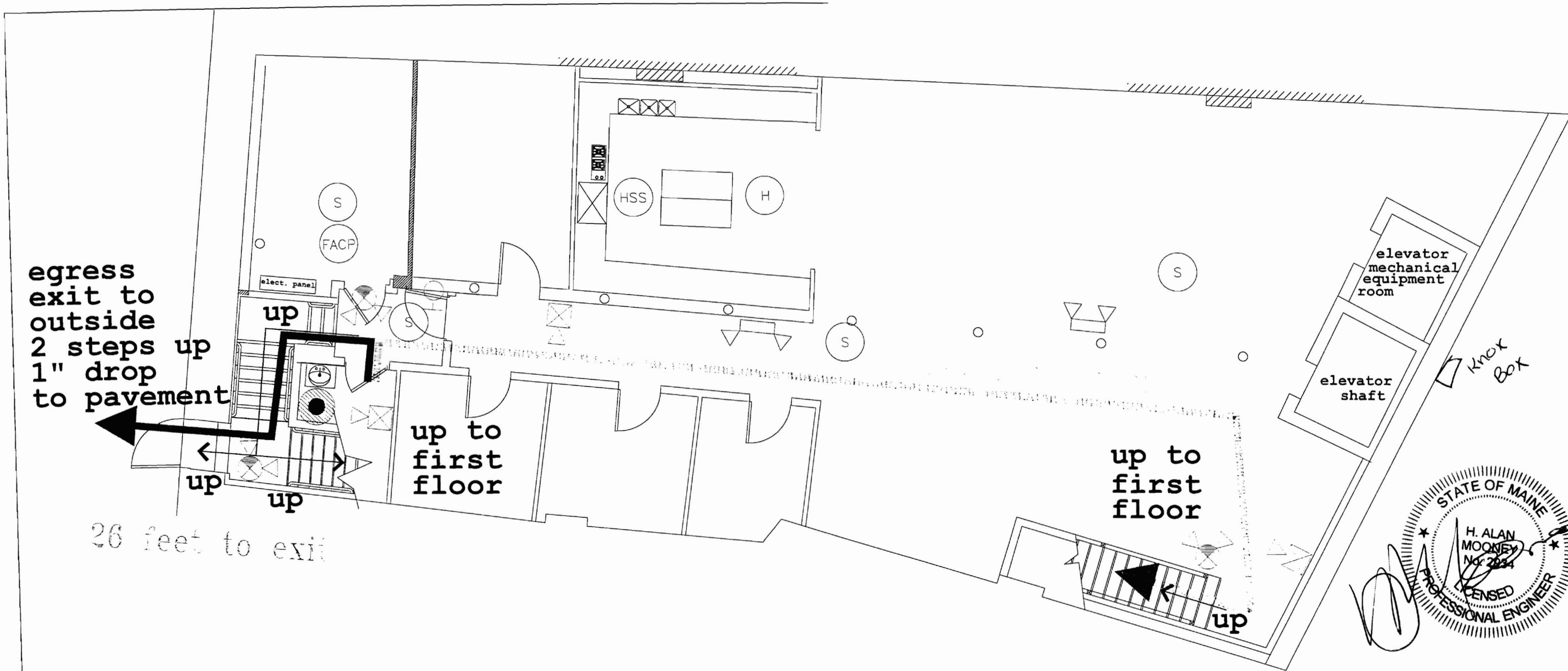

egress  
exit to  
outside  
2 steps up  
1" drop  
to pavement

26 feet to exit

- You Are Standing Here
- Primary Evacuation Route
- Secondary Evacuation Route
- Exits
- Emergency Lights

FIRE ALARM LEGEND

- SMOKE DETECTOR
- HEAT DETECTOR
- MANUAL PULL
- HOOD SUPPRESSION SYSTEM
- ELEVATOR SMOKE RECALL
- STROBE
- DOOR-HOLDER
- KEY PAD
- FIRE ALARM
- KNOX BOX
- MOTION

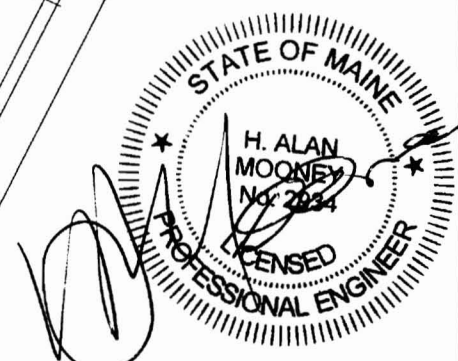

# BASEMENT PLAN

	CURRENT ISSUE STATUS: ISSUED FOR REVIEW 03-25-09	Emerson Clapp Building 28 Monument Square Portland, Maine Phase I Renovation	<b>CRITERIUM</b> <small>MECHANICAL ENGINEERS</small> 22 MONUMENT SQUARE TEL 207-775-1969 SUITE 300 800-922-1969 PORTLAND, ME 04101 FAX 207-775-4415
			SHEET TITLE: <b>BASEMENT FLOOR PLAN FIRE EXITS</b>
			SCALE: AS NOTED PROJECT MANAGER: HAM ENGINEER OF RECORD: HAM PROJECT No. -
			DATE: 08-04-06 SHEET No. <b>EG-1.2</b>

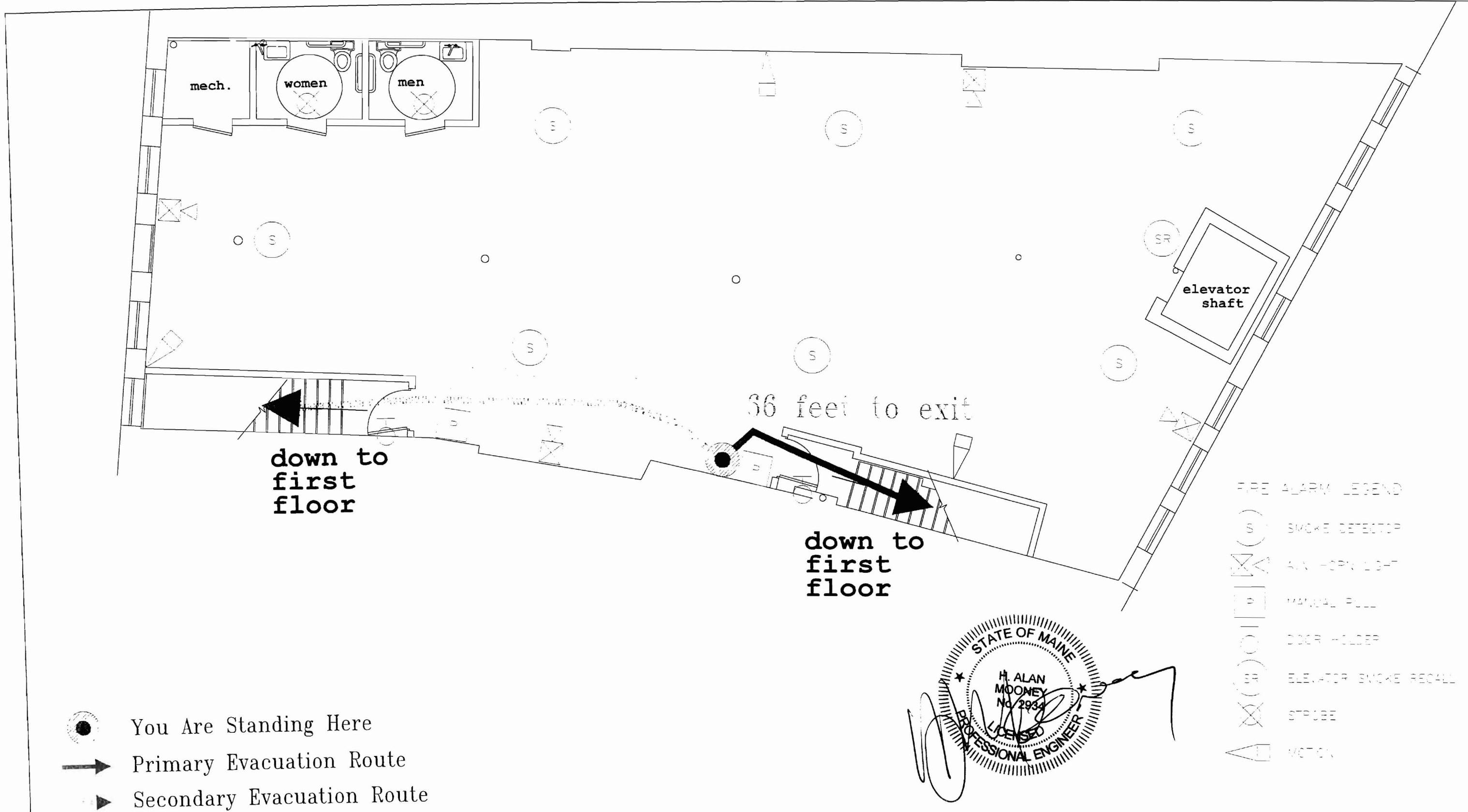

- FIRE ALARM LEGEND
- (S) SMOKE DETECTOR
  - (X) AIR HORN LIGHT
  - (P) MANUAL PULL
  - (H) DOOR HOLDER
  - (SR) ELEVATOR SMOKE RECALL
  - (X) STROBE
  - (A) MOTION

- (●) You Are Standing Here
- (→) Primary Evacuation Route
- (→) Secondary Evacuation Route
- (⊗) Exits
- (—) Emergency Lights

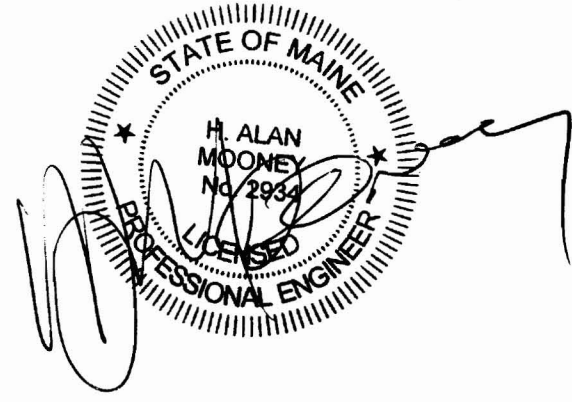

# SECOND FLOOR PLAN

		CURRENT ISSUE STATUS:	Emerson Clapp Building	<b>CRITERIUM</b> ENGINEERS 22 MONUMENT SQUARE TEL. 207-775-1969 SUITE 300 800-922-1969 PORTLAND, ME 04101 FAX 207-775-4415	SHEET TITLE:	SCALE: AS NOTED	DATE: 02-08-09
		ISSUED FOR REVIEW 03-25-09	28 Monument Square Portland, Maine Phase I Renovation		SECOND FLOOR PLAN FIRE EXITS	PROJECT MANAGER: HAM	SHEET No.
					ENGINEER OF RECORD: HAM		EG-2.1
					PROJECT No. -		

egress  
exit to  
outside  
2 steps up  
1" drop to  
pavement

41 feet to exit

egress  
exit to  
outside

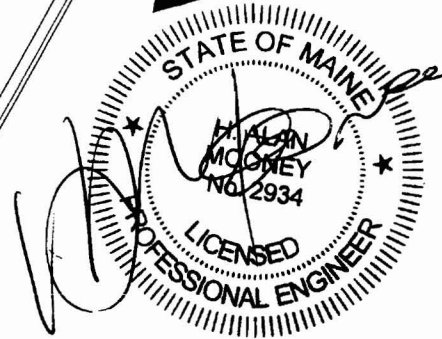

- You Are Standing Here
- Primary Evacuation Route
- Secondary Evacuation Route
- Exits
- Emergency Lights

- FIRE ALARM LEGEND
- SMOKE DETECTOR
  - ELEVATOR SMOKE RECALL
  - STRIKE
  - A/V HORN/LIGHT
  - MANUAL PULL
  - CUP HOLDER
  - VEST PAC
  - MOTION

# FIRST FLOOR PLAN

CURRENT ISSUE STATUS:		Emerson Clapp Building	<b>CRITERIUM</b> ENGINEERS 22 MONUMENT SQUARE TEL 207-775-1969 SUITE 300 800-922-1989 PORTLAND, ME 04101 FAX 207-775-4415	SHEET TITLE:	SCALE: AS NOTED	DATE: 08-04-06
ISSUED FOR REVIEW 03-25-09		28 Monument Square Portland, Maine Phase I Renovation		FIRST FLOOR PLAN FIRE EXITS	PROJECT MANAGER: HAM	SHEET No.
				ENGINEER OF RECORD: HAM		
				PROJECT No. -		EG-2.2



egress  
exit to  
outside  
2 steps up  
1" drop to  
pavement

egress  
exit to  
outside

7 feet to exit

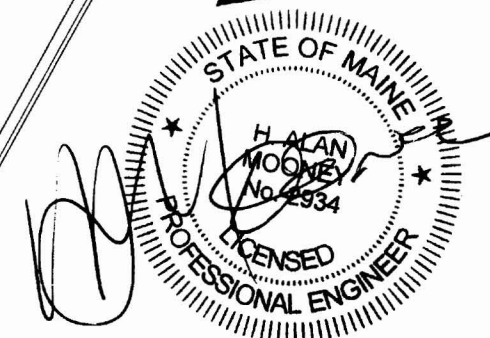

- You Are Standing Here
- Primary Evacuation Route
- Secondary Evacuation Route
- Exits
- Emergency Lights

FIRE ALARM LEGEND

- SMOKE DETECTOR
- HOOP HOLDER
- ELEVATOR SMOKE RECALL
- VEST
- EXIT HORN/LIGHT
- MANUAL PULL
- STROBE
- KEY PAD

# FIRST FLOOR PLAN

		CURRENT ISSUE STATUS:	Emerson Clapp Building	<b>CRITERUM</b> <small>ENGINEERS</small> 22 MONUMENT SQUARE TEL 207-775-1969 SUITE 300 800-922-1969 PORTLAND, ME 04101 FAX 207-775-4415	SHEET TITLE:	SCALE: AS NOTED	DATE: 08-04-06
		ISSUED FOR REVIEW 03-25-09	28 Monument Square Portland, Maine Phase I Renovation		FIRST FLOOR PLAN FIRE EXITS	PROJECT MANAGER: HAM	SHEET No.
					ENGINEER OF RECORD: HAM		EG-2.3
					PROJECT No. -		