

Existing First Floor Plan

New exit stair constructed inside existing building shell, with new one-hour fire separation walls between stair and interior spaces. 22 equal risers @ 6.86"; 11" treads. See SK6 for details.

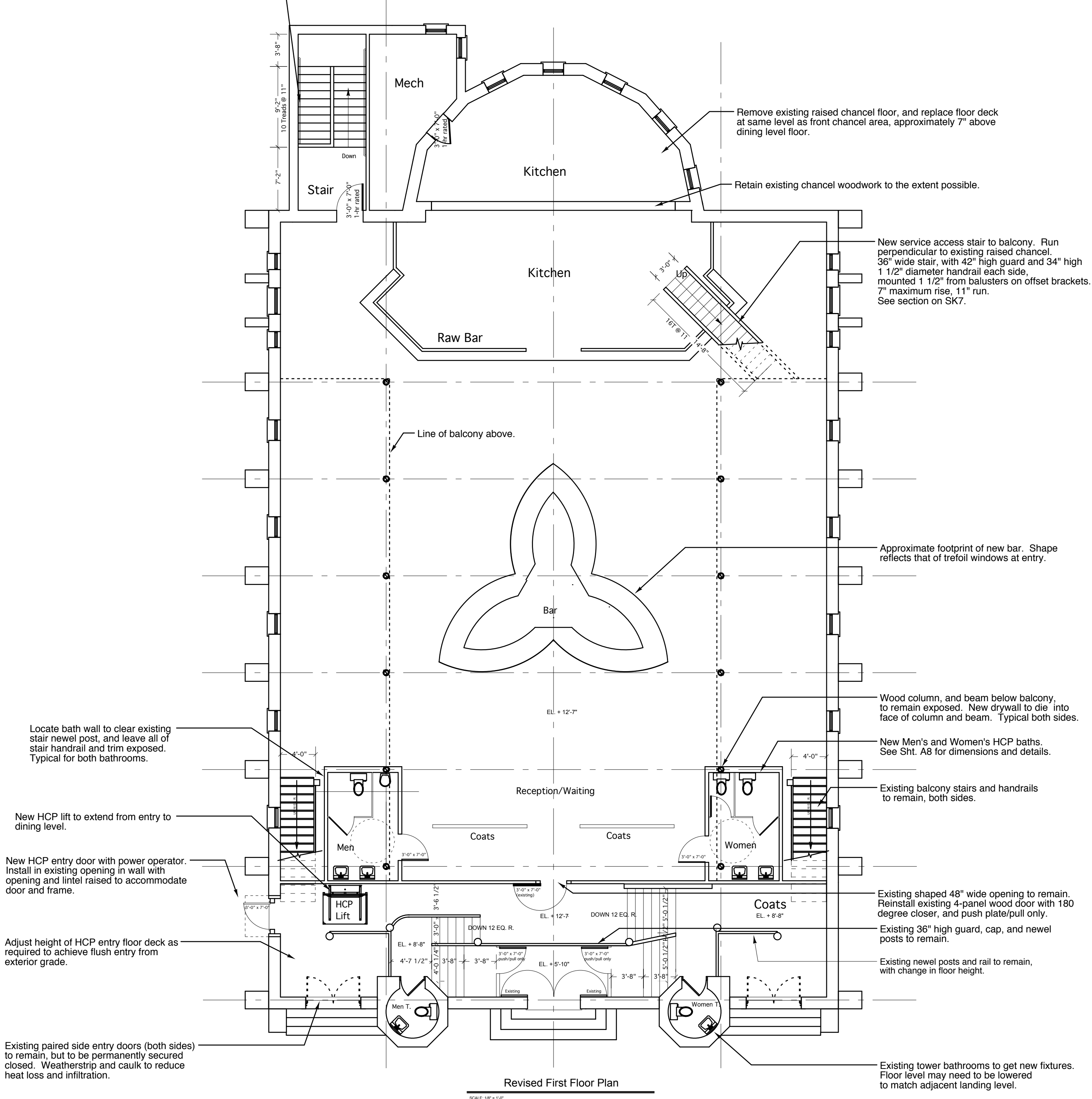

Revised First Floor Plan

Locate bath wall to clear existing stair newel post, and leave all of stair handrail and trim exposed. Typical for both bathrooms.

New HCP lift to extend from entry to dining level.

New HCP entry door with power operator. Install in existing opening in wall with opening and lintel raised to accommodate door and frame.

Adjust height of HCP entry floor deck as required to achieve flush entry from exterior grade.

Existing paired side entry doors (both sides) to remain, but to be permanently secured closed. Weatherstrip and caulk to reduce heat loss and infiltration.

Remove existing raised chancel floor, and replace floor deck at same level as front chancel area, approximately 7" above dining level floor.

Retain existing chancel woodwork to the extent possible.

New service access stair to balcony. Run perpendicular to existing raised chancel. 36" wide stair, with 42" high guard and 34" high 1 1/2" diameter handrail each side, mounted 1 1/2" from balusters on offset brackets. 7" maximum rise, 11" run. See section on SK7.

Approximate footprint of new bar. Shape reflects that of trefoil windows at entry.

Wood column, and beam below balcony, to remain exposed. New drywall to tie into face of column and beam. Typical both sides.

New Men's and Women's HCP baths. See Sht. A6 for dimensions and details.

Existing balcony stairs and handrails to remain, both sides.

Existing shaped 48" wide opening to remain. Reinstall existing 4-panel wood door with 180 degree closer, and push plate/pull only.

Existing 36" high guard, cap, and newel posts to remain.

Existing newel posts and rail to remain, with change in floor height.

Existing tower bathrooms to get new fixtures. Floor level may need to be lowered to match adjacent landing level.

- Notes:
- All stairs to have handrails both sides: 1 1/2" diameter, wood or metal, spaced 1 1/2" from wall or balusters, and mounted on offset brackets at 34" above nosing. Return ends to wall.
 - Stair handrails to extend minimum 12" beyond first riser at top, and continue sloping beyond the bottom riser by the width of one tread, with a level transition at 34" high to extend another 12".
 - Handrails on inside stair wall to extend continuously around center dividing wall.
 - New stairs to have 11" treads with sloping risers, creating a 12" total tread depth. Construct with 5/4" treads and 3/4" risers with radiused nosing. Finish with full depth and width rubber stair tread with adjustable sloping nosing.