

First Floor Plan of New Stair @ NW Corner

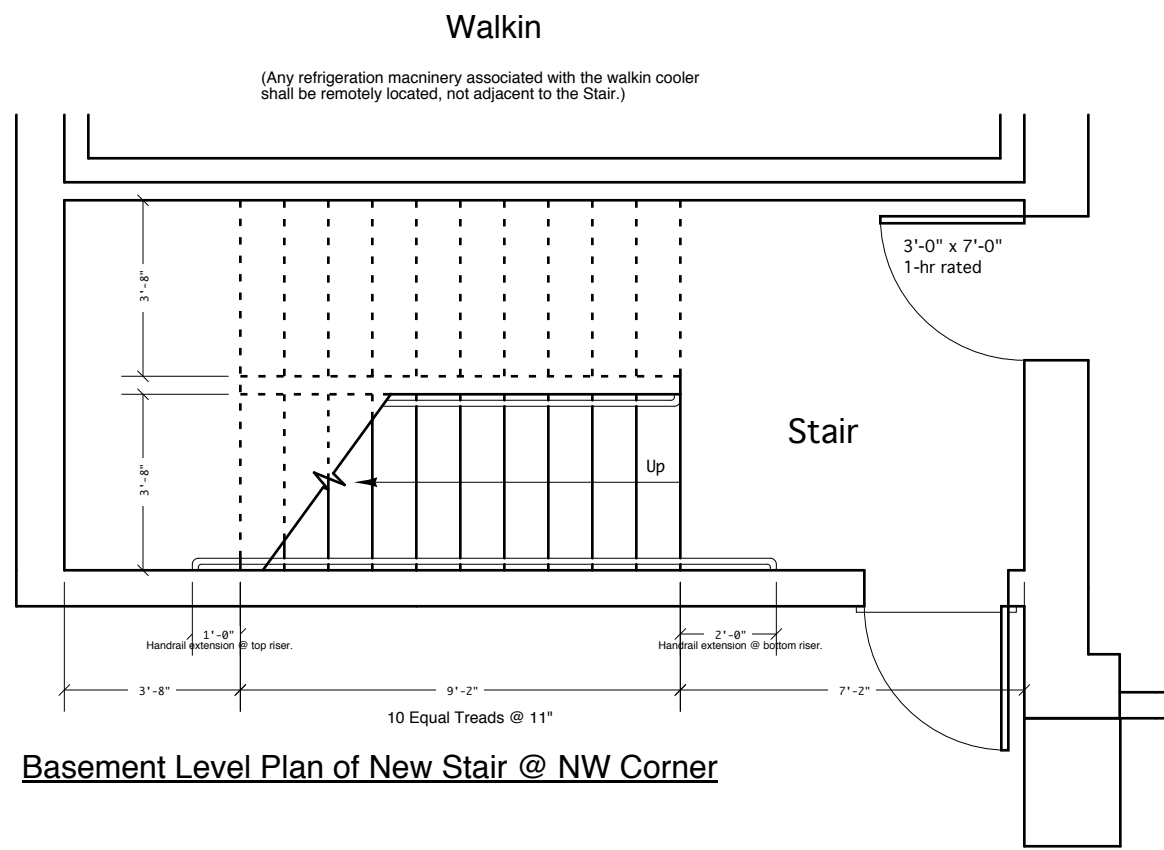

Basement Level Plan of New Stair @ NW Corner

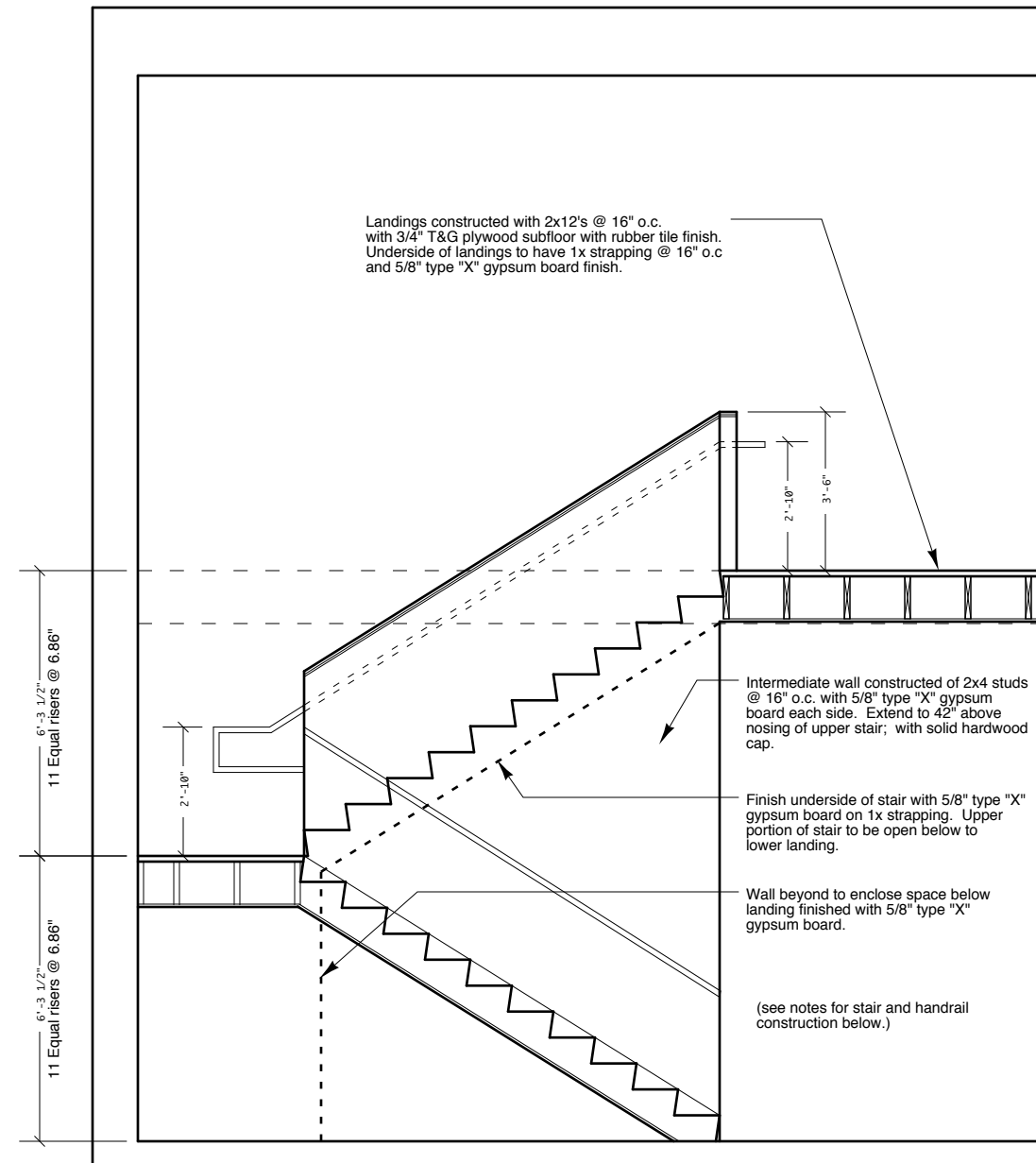

Section Through New Stair @ NW Corner

Notes:

1. All stairs to have handrails both sides: 1 1/2" diameter, wood or metal, spaced 1 1/2" from wall or balusters, and mounted on offset brackets at 34" above nosing. Return ends to wall.
2. Stair handrails to extend minimum 12" beyond first riser at top, and continue sloping beyond the bottom riser by the width of one tread, with a level transition at 34" high to extend another 13".
3. Handrails on inside stair wall to extend continuously around center dividing wall.
4. New stairs to have 11" treads with sloping risers, creating a 12" total tread depth. Construct with 5/4" treads and 3/4" risers with radiused nosing. Finish with full depth and width rubber stair tread with adjustable sloping nosing.

R. Dean Bingham / Architect
55 Roberts Street
Portland, ME 04102
207-774-7779

Grace
Chestnut Street Church
Chestnut Street
Portland, ME

Scale:
1/4" = 1'-0"

7/31/08

Exit Stair
Plans &
Section

SK6