

© 2005 TFH ARCHITECTS

CHESTNUT STREET LOFTS

URBAN REVITALIZATION PROJECT
BY CHESTNUT STREET LLC,
PORTLAND, MAINE

TFH ARCHITECTS
100 COMMERCIAL STREET
PORTLAND MAINE 04101
TELEPHONE 207 775 6141
ARCHITECTURE PLANNING

CONSULTANTS:
CIVIL:
Land Use Consultants
955 Rowley Street
Portland, ME 04103
207-678-3313
STRUCTURAL:
Structural Energy Consulting
22 Oatmont Drive
Old Orchard Beach, ME 04064
207-934-8038
MECHANICAL:
Whitney Engineering
10 Danforth Street
Portland, ME 04101
207-874-7449
ELECTRICAL:
Brenneke Engineering
7 Bennett Road
Fryeburg, ME 04032
207-855-9475

REVISIONS:
JAN 2, 2006 BID SET
FEB 9, 2006 PERMIT SET
FEB 23, 2006
CONSTRUCTION
DOCUMENTS
DATE:
PROJECT No. 0422
DRAWN BY: WSBJR SPD
CHECKED BY: CWA/WSBJR
SCALE: AS NOTED

SHEET TITLE:
BASEMENT &
FIRST FLOOR
ELECTRICAL
PLANS

E1.1

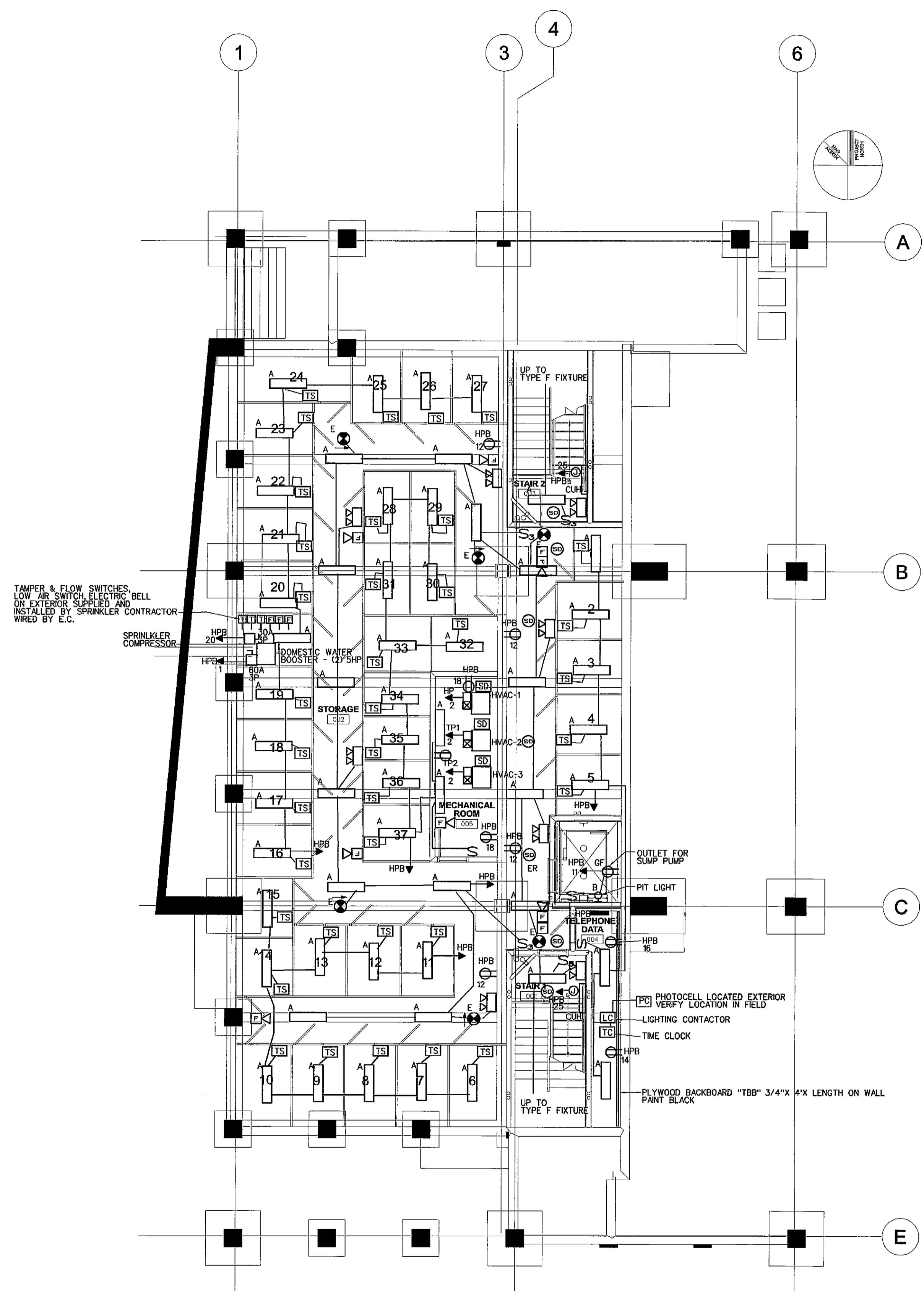

BASEMENT ELECTRICAL PLAN
SCALE: 1/8"=1'-0"

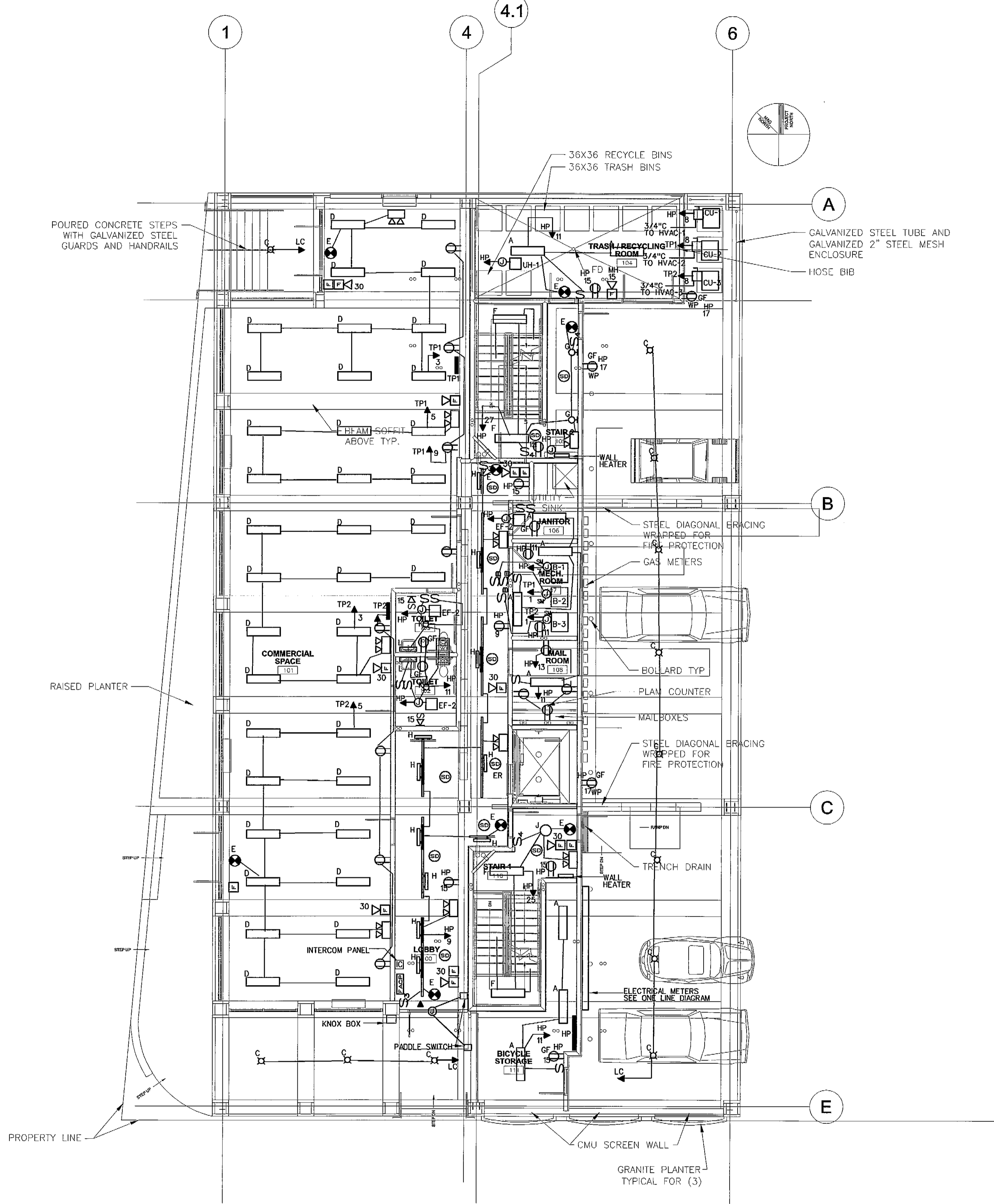

FIRST FLOOR ELECTRICAL PLAN
SCALE: 1/8"=1'-0"